



"Little Wonder"



DIVISION OF SCHILLER-PFEIFFER, INCORPORATED

1028 STREET ROAD

AREA CODE 215-357-5110

SOUTHAMPTON, PA. 18966 U.S.A.

AREA CODE 215-464-5300

INSTRUCTIONS AND REPAIR PARTS FOR THE LITTLE WONDER ELECTRIC HEDGE TRIMMER

Cat. No. D1000 - 16", 110V Hedge Trimmer
Cat. No. D1000A - 16", 240V Hedge Trimmer
Cat. No. 1001 - 16", 12V Hedge Trimmer

Cat. No. D2000 - 30", 110V Hedge Trimmer
Cat. No. D2000A - 30", 240V Hedge Trimmer
Cat. No. 2001 - 30", 12V Hedge Trimmer

WARNING: TO GUARD AGAINST INJURY, BASIC SAFETY PRECAUTIONS SHOULD BE OBSERVED, INCLUDING THE FOLLOWING:

ASSEMBLY INSTRUCTIONS

Remove handle and hedge trimmer from carton. On 16" models, screw handle into side of gear housing in threaded hole provided. On 30" models, screw handle into handle adapter located on frame bar in threaded hole provided. Handle should be sufficiently tightened to insure that at least three or four clicks are felt on locking notches.

CARE AND SAFETY

READ AND FOLLOW ALL INSTRUCTIONS.

2. DRESS PROPERLY — Do not wear loose clothing or jewelry. They can be caught in moving parts. Use of sturdy gloves, non-skid foot-wear and safety glasses is recommended.

STAY ALERT — Watch what you are doing and use common sense. Do not operate trimmer when fatigued.

4. DANGER — CUT HAZARD — KEEP HANDS AWAY FROM BLADES — Keep both hands on handles when power is on. Do not attempt to remove cut material nor hold material to be cut when blades are moving. Make sure trimmer switch is off (not depressed) when clearing jammed material from blades. Do not grasp the exposed cutting blades on cutting edges of trimmer.

WARNING — GUARD AGAINST ELECTRIC SHOCK HAZARD — Don't use trimmer in rain, in wet locations, or on wet hedges or shrubbery. Use only extension cords marked "suitable for use with outdoor appliances" having electrical rating not less than rating of trimmer. Examine cord regularly; if damaged, replace immediately. Do not use damaged extension cords. Inspect cords periodically and replace if damaged. Do not abuse cord. Never carry trimmer by cord. Do not yank cord to disconnect from receptacles. Keep cord away from heat, oil and sharp edges.

6. KEEP CHILDREN AWAY — Do not permit children to contact trimmer or extension cord. Keep children a safe distance from work area.

USE TRIMMER PROPERLY — Use only for trimming the type of shrub, growth, etc. described in the operating instructions. Do not abuse trimmer.

8. DON'T OVERREACH OR STAND ON UNSTABLE SUPPORT — Keep good footing and balance at all times.

9. AVOID UNINTENTIONAL STARTING OF TRIMMER — Before plugging in trimmer, be sure trimmer switch is off (not depressed). Don't carry trimmer with fingers or thumb on switch.
10. DISCONNECT (UNPLUG) TRIMMER FROM POWER SUPPLY — When not in use or before servicing, cleaning, etc.
11. MAINTAIN TRIMMER WITH CARE — Follow maintenance instructions given in manual.
12. STORE TRIMMER INDOORS — When not in use store trimmers indoors in a dry place where not accessible to children as illustrated in Fig. #1, Little Wonder Storage Sheath (Cat. No. 1100) filled with a mixture of half kerosene and half oil.
13. DO NOT ATTEMPT TO REPAIR TRIMMER — Have repairs made by qualified dealer or repairman. See that only identical replacement parts are used.

LUBRICATION AND MAINTENANCE

1. A few drops of oil should be placed at each adjusting screw approximately every four hours of normal operation.
2. To obtain trouble free trimming, it is necessary to remove gum that collects on the blades. This is best done by keeping trimmer in storage sheath filled with a mixture of 1/2 kerosene and 1/2 machine oil, after each cutting. Blades must be clean before they can be adjusted.
3. A few drops of light machine oil should be put in the hole indicated on the bottom cover plate. This is only necessary at the beginning of a day's operation.
4. Gear housing and motor bearings have been permanently lubricated with a special grease which should last for the life of the trimmer. When blades are replaced, or any other time that the bottom cover plate is removed, the grease should be checked for proper amount and a new gasket should be used to insure proper seating of cover plate. Use only Lubrico M3-3K-9K grease in the gear housing. Lubrico M24M is to be used on the motor bearings. (See Accessory Items.)

IMPORTANT (Turn to Page 4)

**WHEN ORDERING REPLACEMENT PARTS - SPECIFY PART NUMBER
DO NOT ORDER BY KEY NUMBER**

**PARTS LIST
FOR 30" HEDGE TRIMMER CATALOG #D2000**

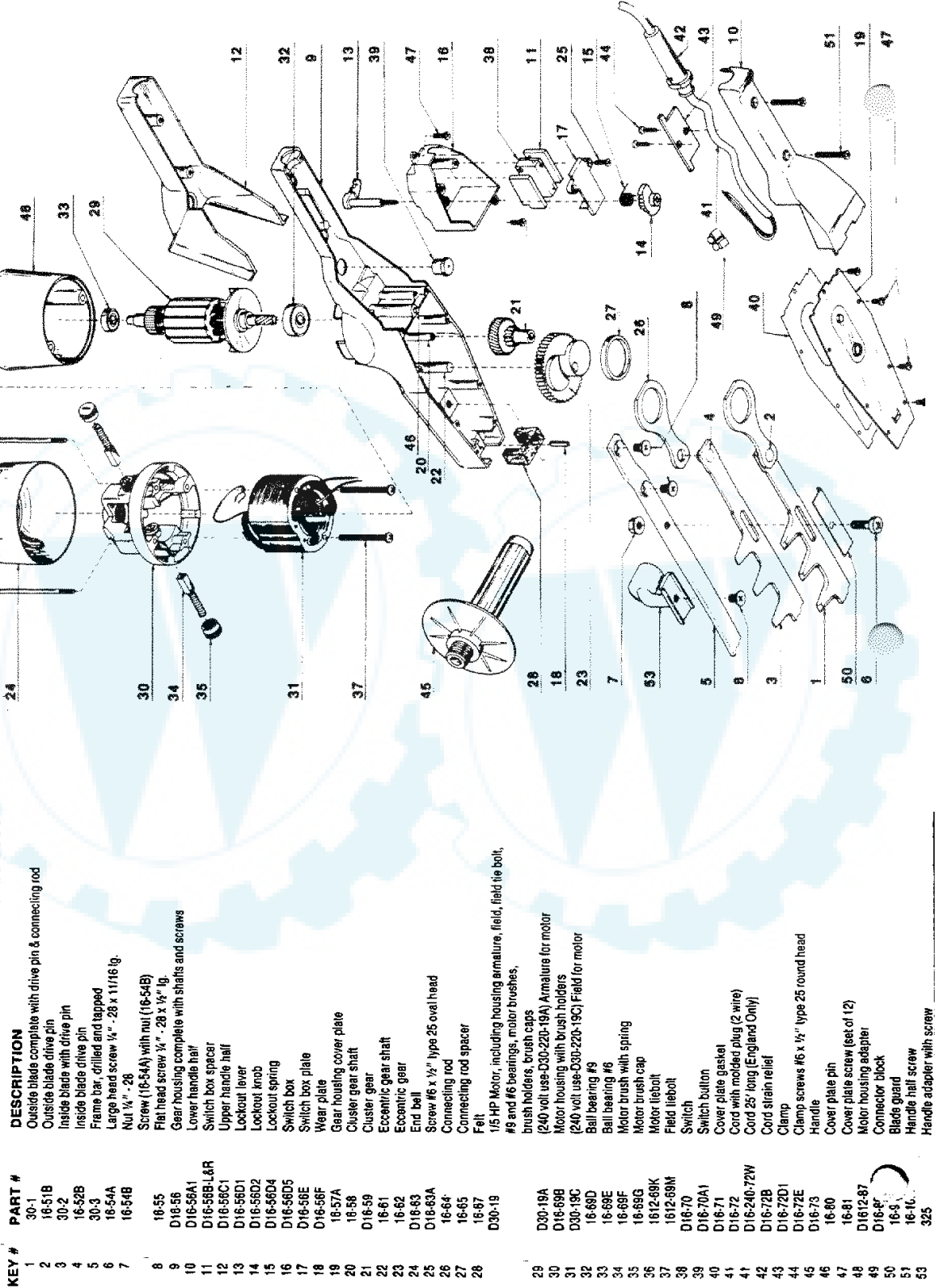

KEY #	PART #	DESCRIPTION
1	30-1	Outside blade complete with drive pin & connecting rod
2	16-51B	Outside blade drive pin
3	30-2	Inside blade with drive pin
4	16-52B	Inside blade drive pin
5	30-3	Frame bar, drilled and tapped
6	16-54A	Large head screw 1/4" - 28 x 11/16 lg.
7	16-54B	Nut 1/4" - 28
8	16-55	Screw (16-54A) with nut (16-54B)
9	D16-56	Flat head screw 1/4" - 28 x 1/2" lg.
10	D16-56A1	Gear housing complete with shafts and screws
11	D16-56B-L&R	Lower handle half
12	D16-56C1	Switch box spacer
13	D16-56D1	Upper handle half
14	D16-56D2	Lockout lever
15	D16-56D4	Lockout knob
16	D16-56D5	Lockout spring
17	D16-56E	Switch box
18	D16-56F	Switch box plate
19	16-57A	Wear plate
20	16-58	Gear housing cover plate
21	D16-59	Cluster gear shaft
22	16-61	Eccentric gear shaft
23	16-62	Eccentric gear
24	D16-63	End ball
25	D16-63A	Screw #6 x 1/2" type 25 oval head
26	16-64	Connecting rod
27	16-65	Connecting rod spacer
28	16-67	Felt
29	D30-19	1/5 HP Motor, including housing armature, field, field tie bolt, brush holders, motor brushes, (240 volt use D30-220-19A) Armature for motor
30	D30-19A	Motor housing with brush holders
31	D30-19C	Ball bearing #9
32	16-68D	Motor brush with spring
33	16-69E	Motor brush cap
34	16-69F	Motor tiebolt
35	16-69G	Field tiebolt
36	1612-69K	Switch
37	1612-69M	Switch button
38	D16-70	Cover plate gasket
39	D16-70A1	Cord with molded plug (2 wire)
40	D16-71	Cord 25' long (England Only)
41	D16-72	Cord strain relief
42	D16-72B	Clamp
43	D16-72D1	Clamp screws #6 x 1/2" type 25 round head
44	D16-72E	Handle
45	D16-73	Cover plate pin
46	16-80	Cover plate screw (set of 2)
47	16-81	Motor housing adapter
48	D1612-87	Connector block
49	D16-87	Blade guard
50	16-83	Blade half screw
51	16-16	Handle adapter with screw
53	325	

12 Volt Hedge Trimmer Motor Parts Description

12 volt DC motor including housing, armature, field, field tie bolt, No. 9 and No. 6 bearings, motor brushes, brush holders, brush caps
Armature for motor

- * 1612-68D
- * 1612-68AD
- 1612-68B
- 1612-68C
- 16-68D
- 16-68E
- 1612-68F
- 1612-68G
- 1612-68H
- 1612-68K
- 1612-68M
- 16-68N
- 1612-70
- 1612-72
- 1612-74
- 1612-72B
- D16-72C
- 16-81
- 1612-87
- 1612-88

* Effective with Serial No. 72-08001, armature and cluster gear changed from straight to helical tooth.

- 30-1 Outside blade complete with drive pin & connecting rod
- 16-51B Outside blade drive pin (not illustrated)
- 30-2 Inside blade with drive pin
- 16-52B Inside blade drive pin (not illustrated)
- 30-3 Frame bar, drilled and lapped
- 16-54A&B Large head screw for frame bar 1/4" x 11/16" (16-54A) with nut (16-54B)
- 16-55 Flat head screw 1/4" - 28 x 1 1/2" lg.
- D16-56 Gear housing complete with shafts and screws
- D16-56A Lower handle half
- D16-56B Switch box spacer
- D16-56C Upper handle half
- D16-56D Switch box
- D16-56E Switch box plate
- D16-56F Wear plate
- 16-57A Gear housing cover plate
- 16-58 Cluster gear shaft (not illustrated)
- D16-59 Cluster gear
- 16-61 Eccentric gear shaft (not illustrated)
- 16-62 Eccentric gear
- D16-63 End bell
- D16-63A End bell screw
- 16-64 Connecting rod
- 16-65 Connecting rod spacer
- 16-67 Felt
- D30-19 (240 volt use-D30-220-19) 1/5 HP Motor, including housing, armature, field, tie bolt #9 and #6 bearings, motor brushes, brush holders, brush caps

- D30-19A (240 volt use-D30-220-19A) Armature for motor
- D16-68B Motor housing with brush holders
- D30-19C (240 V volt use-D30-220-19C) Field for motor
- 16-69D Ball bearing # 9
- 16-69E Ball bearing # 6
- 16-69F Motor brush with spring
- 16-69G Motor brush cap
- 1612-68K Motor tiebolt
- 1612-68M Field tiebolt
- D16-70 Switch
- D16-70A Switch button
- D16-71 Cover plate gasket
- D16-72 (240 volt use-D16-220-72) Cord with molded plug-(2 wire)
- D16-72A Cord with Molded Plug (Australia, New Zealand ONLY)
- D16-240-72W Cord 25' long (not shown)
- D16-72B Cord strain relief
- D16-72D Clamp
- D16-72E Clamp screws
- D16-73 Handle
- 16-80 Cover plate pin (not illustrated)
- 16-81 Cover plate screw (set of 12)
- D1612-87 Motor housing adaptor
- D16-88 Connector block
- 16-83 Blade guard
- 16-103 Handle half screw
- 325 Handle adaptor with screw

Instruction For Removing Cover Plate
In order to remove cover plate, turn hedge trimmer upside down. Remove the eight cover plate screws. Put a flat instrument (example - heavy putty knife or flat screwdriver) under both sides of cover plate, between the center pin area and gear housing. Pry near instrument handles lifting cover plate from pins.

All parts listed may be ordered through your local dealer or distributor. When ordering repair parts always specify the catalog number of the product.

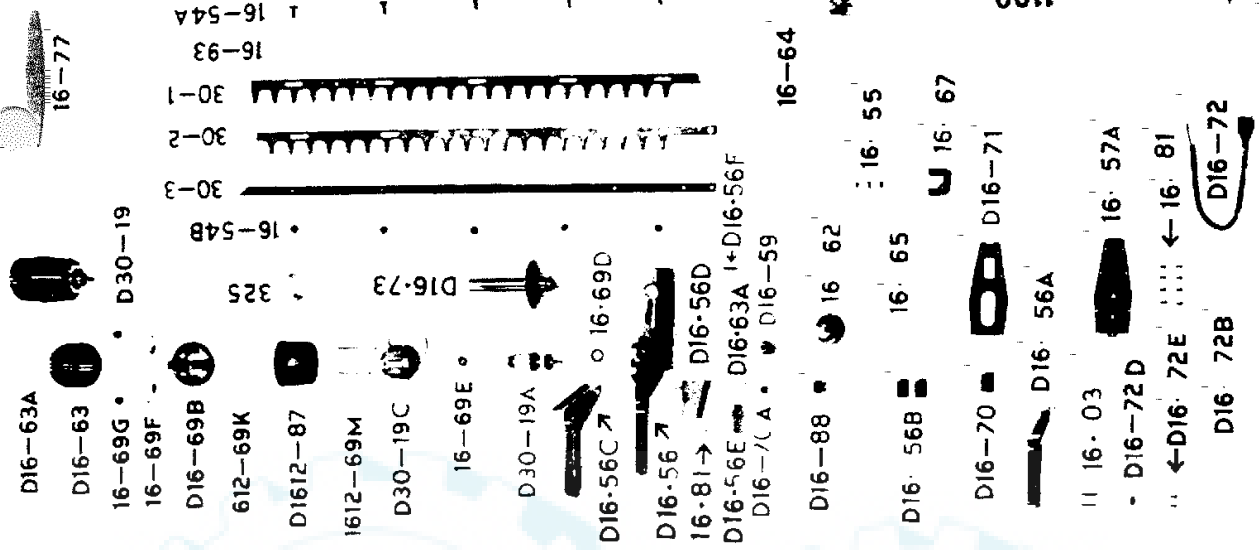

5. Check motor brushes periodically. They are readily accessible by unscrewing brush cap (see figure 2). In general, brushes should be replaced when they are worn to about 1/4" length. To renew, order set of two complete assemblies, and be sure to replace brushes with radius fitting the contour of the armature as shown in figure 2. Then tightly screw on brush cap.



Figure 1
LITTLE WONDER
STORAGE SHEATH
Cat. # 1100

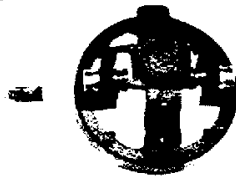

Figure 2
Brush and Cap
Assembly

INSTRUCTIONS FOR SAFE OPERATION

READ CARE AND SAFETY INSTRUCTIONS CAREFULLY.

2. Before plugging into an electric circuit, be sure that the voltage supply is as specified on name plate.
3. Be sure the switch is in the "OFF" (not depressed) position before connecting unit to the applicable current. (**110V AC or 240V AC or 12V DC.**)
4. Place cord over shoulder and tuck cord under belt as illustrated in Figure #3. Keep extension cord behind trimmer. Never drape extension cord over hedge being trimmed. On 110V units, use 16 gauge wire extension cord at all times (Little Wonder Part No. D16-97). Extension cord available from distributor or dealer. The use of light gauge lamp cords or sizes lighter than those specified above will result in loss of power and possible motor failure. However, it is not advisable to use an extension cord on 12 volt products.
5. Knot extension cord as shown in Figure #3 to prevent a disconnection when cord is pulled along the ground.

Hold trimmer firmly, depress switch, tilt trimmer so cutting tooth is angled slightly toward the hedge or shrub and proceed to cut. The unit is designed to cut any type of hedge or shrub; however, **THICKNESS OF CUT SHOULD NOT EXCEED 1/4 INCH IN DIAMETER.**

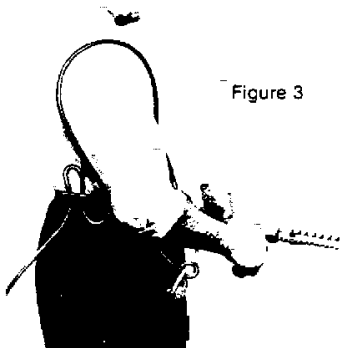

Figure 3

7. **BE CAREFUL OF HIDDEN METALLIC OBJECTS** in the hedge or shrubbery which may damage trimmer.

ADJUSTMENT FOR HEDGE TRIMMER BLADES

The care and adjustment of the blades is most important to the efficient operation of the trimmer and especially to the long life of the motor.

Place trimmer in vise as shown in figure 4, clamping on

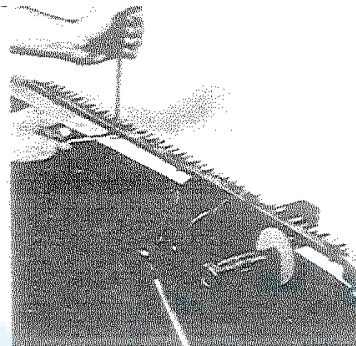

Figure 4
Adjusting
Blades
on
Trimmer

frame bar with blades pointing away from you. Support motor housing as shown.

2. Check that nothing is in the way of the cutting blades during the process of adjustment.
3. Using 7/16 wrench, loosen all jam nuts. Next using screw driver, loosen all large head screws, two turns. Then snug all nuts to keep screws from tightening by themselves.
4. Switch on trimmer
5. **STARTING WITH THE SCREW NEAREST THE GEAR HOUSING**, hold the hex nut in the snug position and tighten large head screw slowly until the motor begins to slow down. Now loosen head screw 1/4 turn and tighten the jam nut.
6. Repeat step #5 on each screw and nut until all are adjusted.

LIMITED SERVICE & WARRANTY POLICY

All "Little Wonder" products are guaranteed against defects in material and workmanship for a period of **ONE YEAR** when used for **RESIDENTIAL SERVICE**, **NINETY DAYS** for **COMMERCIAL SERVICE**. Any "Little Wonder" products or part found to be defective within the warranty period is to be returned to our factory at Southampton, Pennsylvania.

Transportation charges on parts and units submitted for replacement under this warranty must be borne by the purchaser.

THIS WARRANTY shall not be effective if the product has been the subject of misuse, negligence or accident or if the product has been repaired or altered outside of our Southampton factory in any respect which affects its condition or operation.

"Little Wonder" shall not be liable for any special indirect or consequential damages arising from defective equipment. Any implied warranty, including merchantability or fitness for a particular purpose shall not extend beyond the written warranty period.

THIS WARRANTY shall be effective only providing attached card is properly filled out and returned to "Little Wonder, Div. of Schiller-Pfeiffer, Inc." at time of purchase.



"Little Wonder"



DIVISION OF SCHILLER-PFEIFFER, INCORPORATED

1028 STREET ROAD

AREA CODE 215-357-5110

SOUTHAMPTON, PA. 18966 U.S.A.

AREA CODE 215-464-5300

INSTRUCTIONS AND REPAIR PARTS FOR THE LITTLE WONDER ELECTRIC HEDGE TRIMMER

Cat. No. D1000 - 16", 110V Hedge Trimmer
Cat. No. D1000A - 16", 220/240V Hedge Trimmer

Cat. No. D2000 - 30", 110V Hedge Trimmer
Cat. No. D2000A - 30", 220/240V Hedge Trimmer

WARNING — TO GUARD AGAINST INJURY, BASIC SAFETY PRECAUTIONS SHOULD BE OBSERVED, INCLUDING THE FOLLOWING:

CARE AND SAFETY

1. READ AND FOLLOW ALL INSTRUCTIONS.
2. DRESS PROPERLY — Do not wear loose clothing or jewelry. They can be caught in moving parts. Use of sturdy gloves, non-skid footwear and safety glasses is recommended.
3. STAY ALERT — Watch what you are doing and use common sense. Do not operate trimmer when fatigued.
4. DANGER — CUT HAZARD — KEEP HANDS AWAY FROM BLADES — Keep both hands on handles when power is on. Do not attempt to remove cut material nor hold material to be cut when blades are moving. Make sure trimmer switch is off (not depressed) when clearing jammed material from blades. Do not grasp the exposed cutting blades on cutting edges of trimmer.
CAUTION — BLADES COAST AFTER TURN OFF.
5. WARNING — GUARD AGAINST ELECTRIC SHOCK HAZARD — Don't use trimmer in rain, in wet locations, or on wet hedges or shrubbery. Use only extension cords marked "suitable for use with outdoor appliances" having electrical rating not less than rating of trimmer. Examine cord regularly; if damaged, replace immediately. Do not use damaged extension cords. Inspect cords periodically and replace if damaged. Do not abuse cord. Never carry trimmer by cord. Do not yank cord to disconnect from receptacles. Keep cord away from heat, oil and sharp edges.
6. KEEP CHILDREN AWAY — Do not permit children to contact trimmer or extension cord. Keep children a safe distance from work area.
7. USE TRIMMER PROPERLY — Use only for trimming the type of shrub, growth, etc., described in the operating instructions. Do not abuse trimmer.
8. DON'T OVERREACH OR STAND ON UNSTABLE SUPPORT — Keep good footing and balance at all times.
9. AVOID UNINTENTIONAL STARTING OF TRIMMER — Before plugging in trimmer, be sure trimmer switch is off (not depressed). Don't carry trimmer with fingers or thumb on switch or switch lockout mechanism.
10. DISCONNECT (UNPLUG) TRIMMER FROM POWER SUPPLY — When not in use or before servicing, cleaning, etc.
11. MAINTAIN TRIMMER WITH CARE — Follow maintenance instructions given in manual.
12. STORE TRIMMER INDOORS — When not in use, store trimmers indoors in a dry place where not accessible to

children as illustrated in Fig. #1, Little Wonder Storage Sheath (Cat. No. 1100) filled with a mixture of half kerosene and half oil.

13. DO NOT ATTEMPT TO REPAIR TRIMMER — Have repairs made by qualified dealer or repairman. See that only identical replacement parts are used.
14. Inspect to be sure handles, guards, and fasteners are secure and in place.

INSTRUCTIONS FOR PROPER OPERATION

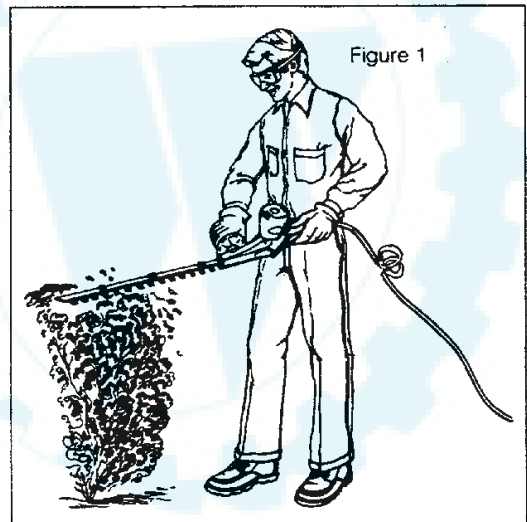

1. READ CARE AND SAFETY INSTRUCTIONS CAREFULLY.
2. Before plugging into an electric circuit, be sure that the voltage supply is as specified on name plate.
3. Be sure the switch is in the "OFF" (not depressed) position before connecting unit to the applicable current. (110V AC or 240V AC.)
4. Knot extension cord as shown in Figure #1 to prevent a disconnection when cord is pulled along the ground.
5. Keep extension cord behind trimmer. Never drape extension cord over hedge being trimmed. On 110V units, use 16 gauge wire extension cord at all times (Little Wonder Part No. D-16-97). Extension cord available from distributor or dealer. The use of light gauge lamp cords or sizes lighter than those specified above will result in loss of power and possible motor failure.

DO NOT ATTEMPT TO REPAIR TRIMMER — Have repairs made by qualified repairman. See that only identical replacement parts are used.

Page 4

All parts listed may be ordered through your local dealer or distributor. When ordering repair parts, always specify the catalog number of the product.

- In order to depress the switch button which starts the hedge trimmer, you must first unlock the switch.

PROCEDURE:

- Grasp rear handle portion of hedge trimmer with left hand.
 - Grasp side handle of hedge trimmer with right hand.
 - Place thumb of left hand on button, and index finger of left hand on lockout knob located below and to the left of button on side of unit.
 - Gently slide lockout knob toward rear of unit unlocking switch. Simultaneously depress switch button and power is ON, and will STAY ON until switch button is released.
- Hold trimmer firmly, unlock switch, depress button, tilt trimmer so cutting tooth is angled slightly toward the hedge or shrub and proceed to cut. The unit is designed to cut any type of hedge or shrub; however, **THICKNESS OF CUT SHOULD NOT EXCEED 1/4 INCH IN DIAMETER**.



- BE CAREFUL OF HIDDEN METALLIC OBJECTS in the hedge or shrubbery which may damage trimmer.

ASSEMBLY INSTRUCTIONS

Remove handle and hedge trimmer from carton. On 16" models, screw handle into side of gear housing in threaded hole provided. On 30" models, screw handle into handle adapter located on frame bar in threaded hole provided. Handle should be tightened by hand, then, using pliers, tighten until at least 4 additional clicks are felt on locking notches.

WARNING — DO NOT USE WITHOUT HANDLE AND GUARD

LUBRICATION AND MAINTENANCE

- A few drops of oil should be placed at each adjusting screw approximately every four hours of normal operation.
- To obtain trouble free trimming, it is necessary to remove gum that collects on the blades. This is best done by keeping trimmer in storage sheath filled with a mixture of 1/2 kerosene and 1/2 machine oil, after each cutting. (Fig. 2) Blades must be clean before they can be adjusted.
- A few drops of light machine oil should be put in the hole indicated on the bottom cover plate. This is only necessary at the beginning of a day's operation.
- Gear housing and motor bearings have been permanently lubricated with a special grease which should last for the life of the trimmer. When blades are replaced, or any other time that the bottom cover plate is removed, the grease should be checked for proper amount and a new gasket should be used to insure proper seating of cover plate. Use only Lubrico M3-3K-9K grease in the gear housing. Lubrico M24M is to be used on the motor bearings. (See Accessory Items.)

Inspect to be sure handles, guards, and fasteners are secure and in place.



Figure 2
LITTLE WONDER
STORAGE SHEATH
Cat. #1100

ADJUSTMENT FOR HEDGE TRIMMER BLADES

CAUTION:

ALWAYS disconnect the plug from the power source before starting work.

The care and adjustment of the blades is most important to the efficient operation of the trimmer and especially to the long life of the motor.

- Place trimmer in vise as shown in Figure #3, clamping on frame bar with blades pointing away from you. Support motor housing as shown.

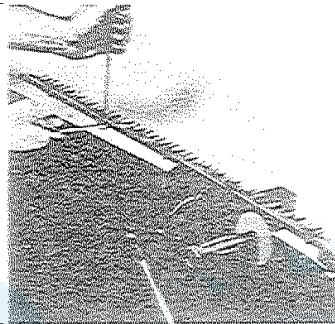

Figure 3

Adjusting
Blades
on
Trimmer

- Using a 7/16" wrench, loosen all blade locknuts and unscrew the large head screws by two turns.
- Starting with the screw nearest the gear housing, tighten the screw until the blade guard can just be moved with finger pressure and a 0.0015" (1 1/2 thou.) feeler blade just slips under the blade guard. Tighten the locknuts while holding the screw stationary in its correctly adjusted position.
- Repeat step 3 on the screws in turn until all are correctly adjusted.

NOTE — Correct blade adjustment can only be achieved on clean, oiled blades.

LIMITED SERVICE & WARRANTY POLICY

All "Little Wonder" products are guaranteed against defects in material and workmanship for a period of ONE YEAR when used for RESIDENTIAL SERVICE; NINETY DAYS for COMMERCIAL SERVICE. Any "Little Wonder" products or parts found to be defective within the warranty period are to be returned to our factory in Southampton, Pennsylvania.

Transportation charges on parts and units submitted for replacement under this warranty must be borne by the purchaser.

THIS WARRANTY shall not be effective if the product has been the subject of misuse, negligence or accident or if the product has been repaired or altered outside of our Southampton factory in any respect which affects its condition or operation.

"Little Wonder" shall not be liable for any special indirect or consequential damages arising from defective equipment. Any implied warranty, including merchantability or fitness for a particular purpose shall not extend beyond the written warranty period.

THIS WARRANTY shall be effective only providing attached card is properly filled out and returned to "Little Wonder, Div. of Schiller-Pfeiffer, Inc." at time of purchase.

**WHEN ORDERING REPLACEMENT PARTS - SPECIFY PART NUMBER
DO NOT ORDER BY KEY NUMBER**

**PARTS LIST
FOR 16" HEDGE TRIMMER CATALOG #D1000**

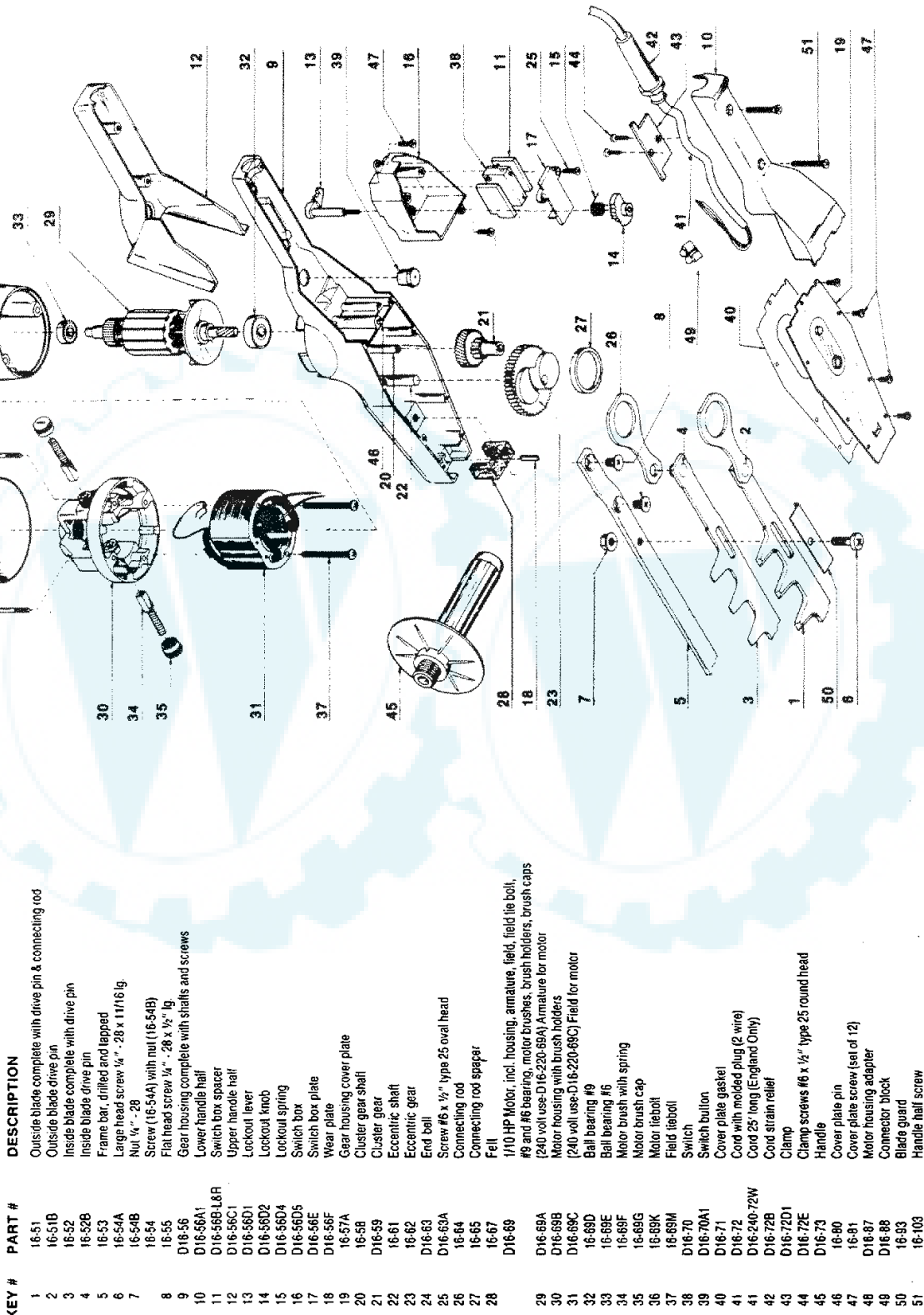

KEY #	PART #	DESCRIPTION
1	16-S1	Outside blade complete with drive pin & connecting rod
2	16-S1B	Outside blade drive pin
3	16-S2	Inside blade complete with drive pin
4	16-S2B	Inside blade drive pin
5	16-S3	Frame bar, drilled and tapped
6	16-S4A	Large head screw 1/4" - 28 x 1 1/16 lg.
7	16-S4B	Nut 1/4" - 28
8	16-S4	Screw (16-54A) with nut (16-54B)
9	16-S5	Flat head screw 1/4" - 28 x 1/2" lg.
10	D16-56	Gear housing complete with shafts and screws
11	D16-56A1	Lower handle half
12	D16-56B1	Switch box spacer
13	D16-56C1	Upper handle half
14	D16-56D1	Lockout lever
15	D16-56D2	Lockout knob
16	D16-56D4	Lockout spring
17	D16-56D5	Switch box
18	D16-56E	Switch box plate
19	D16-56F	Wear plate
20	16-S7A	Gear housing cover plate
21	16-S8	Cluster gear shaft
22	D16-59	Eccentric gear
23	16-61	Eccentric shaft
24	D16-63	Eccentric gear
25	D16-63A	Screw #6 x 1/2" type 25 oval head
26	16-64	End ball
27	16-65	Connecting rod
28	D16-67	Fill
29	D16-68A	1/10 HP Motor, incl. housing, armature, field, field tie bolt, #9 and #6 bearing, motor brushes, brush holders, brush caps (240 volt use D16-220-68A) Armature for motor
30	D16-68B	Motor housing with brush holders
31	D16-68C	[240 volt use D16-220-68C] Field for motor
32	16-69D	Ball bearing #9
33	16-69E	Ball bearing #6
34	16-69F	Motor brush with spring
35	16-69G	Motor brush cap
36	16-69K	Motor tiebolt
37	16-69M	Field tiebolt
38	D16-70	Switch
39	D16-70A1	Switch button
40	D16-71	Cover plate gasket
41	D16-72	Cord with molded plug (2 wire)
42	D16-240-72W	Cord 25' long (England Only)
43	D16-72B	Cord strain relief
44	D16-72D1	Clamp
45	D16-72E	Clamp screws #6 x 1/2" type 25 round head
46	16-90	Handle
47	16-81	Cover plate screw (set of 12)
48	D16-87	Motor housing adapter
49	D16-88	Connector block
50	16-93	Blade guard
51	16-103	Handle nail screw

DO NOT ATTEMPT TO REPAIR TRIMMER — Have repairs made by qualified dealer or repairman. See that only identical replacement parts are used.

PARTS LIST FOR ALL 16" HEDGE TRIMMERS

PART # DESCRIPTION

- 16-51 Outside blade complete with drive pin & connecting rod
- 16-51B Outside blade drive pin (not illustrated)
- 16-52 Inside blade complete with drive pin
- 16-52B Inside blade drive pin (not illustrated)
- 16-53 Frame bar, drilled and tapped
- 16-54A&B Large head screw for frame bar 1/4" x 1 1/16 (16-54A) with nut (16-54B)
- 16-55 Flat head screw 1/4" - 28 x 1/2" lg.
- D16-56 Gear housing complete with shafts and screws
- D16-56A Lower handle half
- D16-56B Switch box spacer
- D16-56C Upper handle half
- D16-56D Switch box
- D16-56E Switch box plate
- D16-56F Wear plate
- 16-57A Gear housing cover plate
- 16-58 Cluster gear shaft (not illustrated)
- D16-59 Cluster gear
- 16-61 Eccentric shaft (not illustrated)
- 16-62 Eccentric gear
- D16-63 End Bell
- D16-63A End bell screw
- 16-64 Connecting rod
- 16-65 Connecting rod spacer
- 16-67 Felt
- D16-69 (240 volt use-D16-220-69) 1/10 HP Motor, incl. housing, armature, field, field tie bolt, # 9 and # 6 bearing, motor brushes, brush holders, brush caps (240 volt use-D16-220-69A) Armature for motor
- D16-69B Motor housing with brush holders
- D16-69C (240 volt use-D16-220-69C) Field for motor
- 16-69D Ball bearing # 9
- 16-69E Ball bearing # 6
- 16-69F Motor brush with spring
- 16-69G Motor brush cap
- 16-69K Motor tiebolt
- 16-69M Field tiebolt
- D16-70 Switch
- D16-70A Switch button
- D16-71 Cover plate gasket
- D16-72 (240 volt use-D16-220-72) Cord with molded plug (2 wire)
- D16-72A Cord with Molded Plug (Australia, New Zealand ONLY)
- D16-240-72W Cord 25' long (not shown)
- D16-723 Cord strain relief
- D16-72D Clamp
- D16-72E Clamp screws
- D16-73 Handle
- 16-80 Cover plate pin (not illustrated)
- 16-81 Cover plate screw (set of 12)
- D16-87 Motor housing adapter
- 16-93 Blade guard
- 16-103 Handle half screw
- D16-88 Connector block

12 VOLT HEDGE TRIMMER MOTOR PARTS

1612-69D
16-69N
1612-69B
1612-69H
1612-69G
1612-69F
1612-69K
1612-87
1612-69M
1612-69C
16-69E
1612-69AD
1612-70
1612-72B
1612-72
- D16-72C
.. ← 16-81

D16-63A
D16-63
16-69G
16-69F
D16-69B
16-69K
D16-87
16-69M
D16-69C
16-69E
D16-69A
D16-56C
D16-56
16-81
D16-56E
D16-70A
D16-59
D16-88
16-62
16-65
D16-56B
D16-70
D16-56A
16-03
- D16-72D
.. ← D16-72E
D16-72B
D16-72C
D16-77
16-77
16-51
16-52
16-53
16-54B
16-54A
16-64
16-55
16-67
16-69
16-71
16-72
16-73
16-77
16-81
16-87
16-93
16-103
1100

ACC DRY ITEMS AVAILABLE
 D16-88 50' 1612 Extension Cord
 16-77 Carbonium sharpening stone