

ACTUAL PARTS  
 MAY NOT APPEAR  
 AS SHOWN

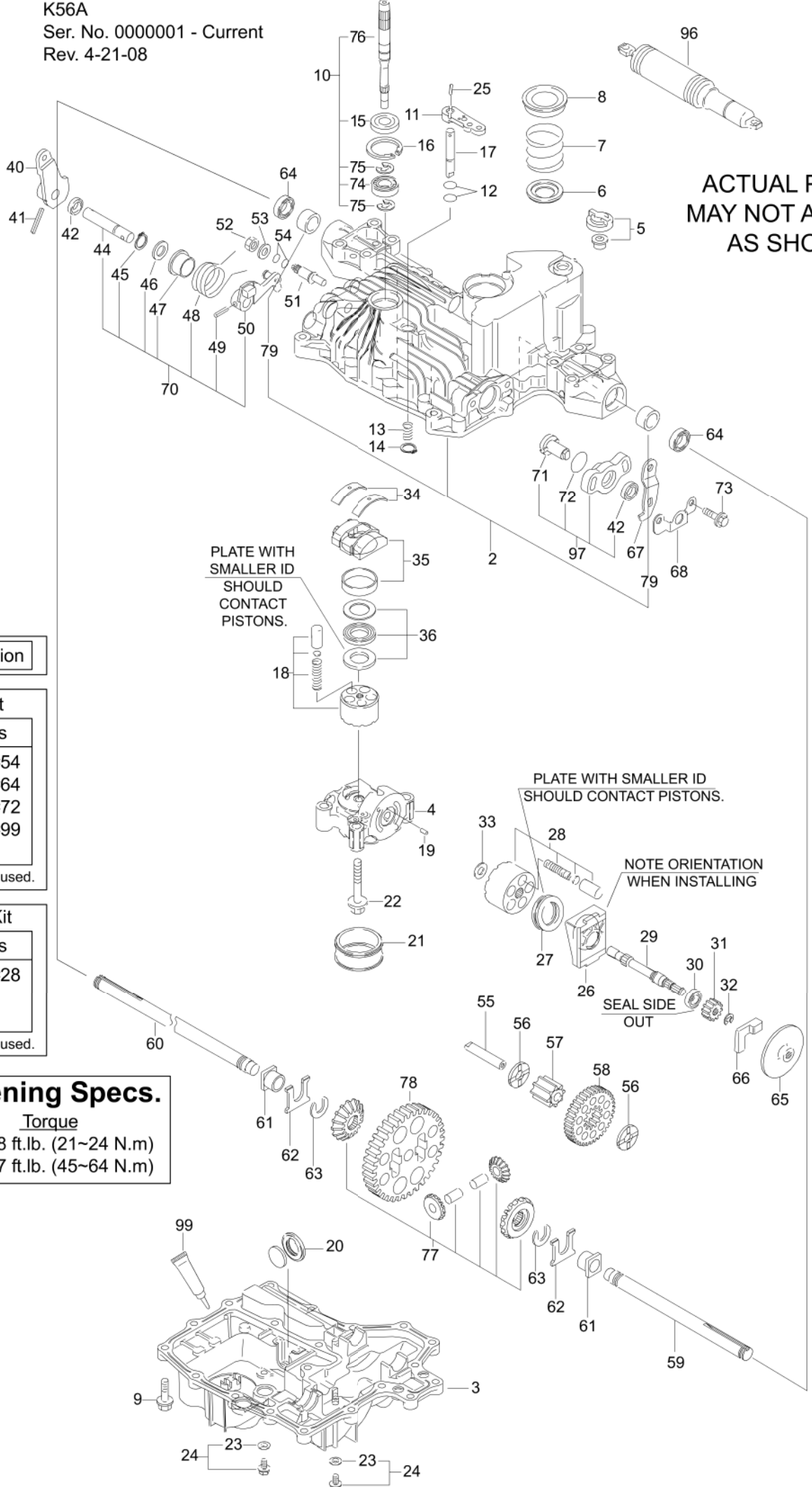

1- K56A Transmission

200- K56A Seal Kit

Kit Includes

#12	#54
#15	#64
#21	#72
#23	#99
#42	

All parts may not be used.

201- K56A Repair Kit

Kit Includes

#4	#28
#18	
#200 - Seal Kit	

All parts may not be used.

**Bolt Tightening Specs.**

Bolt Size	Torque
M8	16~18 ft.lb. (21~24 N.m)
M10	33~47 ft.lb. (45~64 N.m)

**K56A 000001-999999**  
(K56A-SIMPLICITY / 79216884010 & 11)

ITEM No.	TUFF TORQ P/N	DESCRIPTION
	1115	5W50 SYNTHETIC OIL
2	19216824100	UPPER CASE KIT
3	19216884161	LOWER CASE
4	19216824550	CENTER CASE B
5	168T2024250	VENT VALVE
6	19216824330	FILTER
7	19216824320	SPRING
8	19215735270	SEALING CAP 50
9	26476080302	TAPPING SCREW 8 * 30
10	19216899500	PUMP/BEARING KIT (K51C,D,F)SEE
11	19216829520	BYPASS ARM
13	19216829560	DISK SPRING
14	19216829570	SNAP RING 10
16	22252000350	SNAP RING C 35
17	19216829511	BYPASS SHAFT
18	168T2025090	CYLINDER BLOCK (PUMP) KIT
19	19216824760	PIN 3 * 9.8
20	19216324350	MAGNET
21	1A646088211	FILTER
22	26106100602	BOLT 10 * 60
24	187Q0399940	DRAIN BOLT KIT
26	19216824210	MOTOR HOUSING
27	19216324240	THRUST BEARING 51106
28	168T2025080	CYLINDER BLOCK KIT (MOTOR)
29	19216825270	MOTOR SHAFT
30	168T2025280	BEARING 6202
32	19216825350	Q-RING
33	19216825230	WASHER 12 * 24 * 1
34	19216327051	THRUST METAL
35	19216827100	SWASH PLATE
36	19216399000	THRUST BEARING (PUMP) KIT
40	19216889820	CONTROL LEVER
41	22351060040	ROLL PIN 6 * 40
45	22242000160	SNAP RING
46	19215489420	WASHER 17 0 * 30 * 1
47	19216899370	CONTROL COLLAR
48	19216829722	TORSION SPRING STANDARD
49	22351060025	SPRING PIN 6 * 25
51	19216829701	FULCRUM
52	26776120002	NUT 12

55	19216833410	REDUCTION SHAFT
56	19216833420	WASHER 12 * 32 * 3.2
57	19216833510	FINAL PINION GEAR (10T)
59	19216834111	AXLE SHAFT, LEFT
60	19216834120	AXLE SHAFT, RIGHT
61	19216834350	BUSHING 19 * 25
62	19216334261	THRUST WASHER
63	19216834270	RING 17
65	19216836110	BRAKE DISK
66	19216836122	BRAKE SHOE
67	19216836160	BRAKE ARM
68	19216836191	BRAKE PLATE
70	19216829950	SHAFT ASSEMBLY KIT
71	19216836170	BRAKE SHAFT
73	26106080302	TAPPING BOLT 8 * 30
74	24101062020	BEARING 6202C3
75	19215485310	E-RING 15
77	1A646031570	DIFFERENTIAL GEAR KIT
78	19216833520	FINAL GEAR (52T)
96	19215489150	SHOCK ABSORBER K65
97	19216899410	BRAKE CAM KIT
99	1A646099500	SEALANT
200	19216899440	SEAL KIT (K51 & K56)
201	19216899460	REPAIR KIT (K51B,C,F K56A, B)