



Spare Parts List

File: 0020100921ZA

Version: 1.0

Date: 9th Sep,2010

Petrol tiller ----TDS40 (Old model:TL40B)

Pos. No	Part code	Part Description	QTY	losable	damage-able	Consum-able	FOB Unit Price (USD)	Remark
1	921200	pin & clip	2	Y				
2	921201R9005	tiller assy	2			Y		
3	B124009W014	Hexagon head bolts M8x30	3					
4	B500007W014	Single coil spring lock washers 8	13					
5	B501008W014	Plain washers 8	13					
6	B701403W014	woodruff key 4x6.5x16	2					
7	921203R9005	draw bar	1			Y		
8	921204	pins& clamp spring	1					
9	921900	cable-belt tension	1					
10	921300	soft grip	2					
11	921205R9005	right handle bar	1					
12	921206	pin 6	1					
13	921004R3000	control lever	1					
14	B400068FW014	Cross recessed pan head tapping screws ST4.2x12	2					
15	921001R3000	face plate	1					
16	921207R9005	left handle bar	1					
17	B217004W014	Prevailing torque type hexagon nuts M6	11					
18	B501007W014	Plain washers 6	2					
19	921002R3000	throttle lever	1					
20	B124006W014	Hexagon head bolts M6x40	1					
21	921901	cable-throttle control	1					
22	921208	washer 8.5x30x3	5					
23	B124009W014	Hexagon head bolts M8x30	6					
24	B217005W014	Prevailing torque type hexagon nuts M8	9					
25	B131002W014	Hexagon flange bolts M6x16	1					
26	921209R3000	handle bar support	1					
27	B124008W014	Hexagon head bolts M8x20	6					
28	921902	tie	2					
29	921003	tension pulley	1					
30	921210	sleeve	1					
31	921211	lever-tension pulley	1					
32	921212	pivot-pulley lever	1					
33	921500	spring-pulley lever	1					
34	921213R3000	guard	1					
35	921501	spring-wheel	1					
36	921214	pivot-wheel	1					
37	921301	wheel	1			Y		
38	921215	washer 14.2x20x0.4	2					

39	921216R3000	wheel arm	1				
40	B501009W014	Plain washers 10	1				
41	B124011W014	Hexagon head bolts M10x70	1				
42	B217006W014	Prevailing torque type hexagon nuts M10	2				
43	921217R3000	main plate	1				
44	B131003W014	Hexagon flange bolts M5x8	2				
45	921218R3000	front cover	1				
46	921219	bolt 3/8-24UNFx25	1				
47	B500008W014	Single coil spring lock washers 10	1				
48	921220	washer D10/30	2				
49	921221	driving pulley	1				
50	921222	top plate	2				
51	921223R9005	engine plate	1				
52	921224	boss of driven pulley	1				
53	921302	"V"belt Z729	1		Y		
54	921225	driven pulley	1				
55	B131004W014	Hexagon flange bolts M6x14	8				
56	B131005W014	Hexagon flange bolts M8x35	3				
57	00919ZA	engine assy	1				Engine:118cc
58	921903	warning label	1				
59	921904	label-belt tension	1				
60	921905	label-throttle control	1				
61	921100	gear cases assy	1				assembly 80~98,3,4,5,6
80	921101	gear cases sets	1				
81	921907	oil seal 20x32x6	3				
82	B700464W014	Deep groove ball bearing 6204-2RS	1				
83	921226	worm	1				
84	B700465W014	Tapered roller bearing 30203	1				
85	B700463W014	Deep groove ball bearing 6004	2				
86	B278018W014	Circlips for shaft 20	2				
87	921227	worm wheel	1				
88	921906	gasket-gear case	1				
89	921228	washer 10x16x1 -aluminium	2				
90	921229	bolt G1/8x8mm	2				
91	B217004W014	Prevailing torque type hexagon nuts M6	8				
92	B304038W014	Hexagon socket head cap screws M6x38	2				
93	B304037W014	Hexagon socket head cap screws M6x28	6				
94	921230	tiller shaft	1				
95	B701404W014	woodruff key 5x7.5x19	1				
96	921231	flat washer 20.5x35x0.3	2				
97	B524006W014	Serrated lock washers external teeth 6	8				
98	921232	cover-oil seal	2				

REMARKS:

1. The above quotations are based on RMB/USD=6.7280.
- If RMB value increase over 5%, the prices should be adjustable.
- 2.If main material fluctuated more than 5%,the prices should be adjustable
3. Prices normally valid for one year from the day we offer,except the case we consider it invalid.
- 4.All prices should be subject to our final confirmation.



EXPLOSIVE L

Petrol tiller ----TDS40 (

File: 0020100921ZA

Version: 1.0

Model: TDS40&TDS40A

Apply to :

00921ZA(TDS40)

00921AA(TDS40A)

2010.4.21

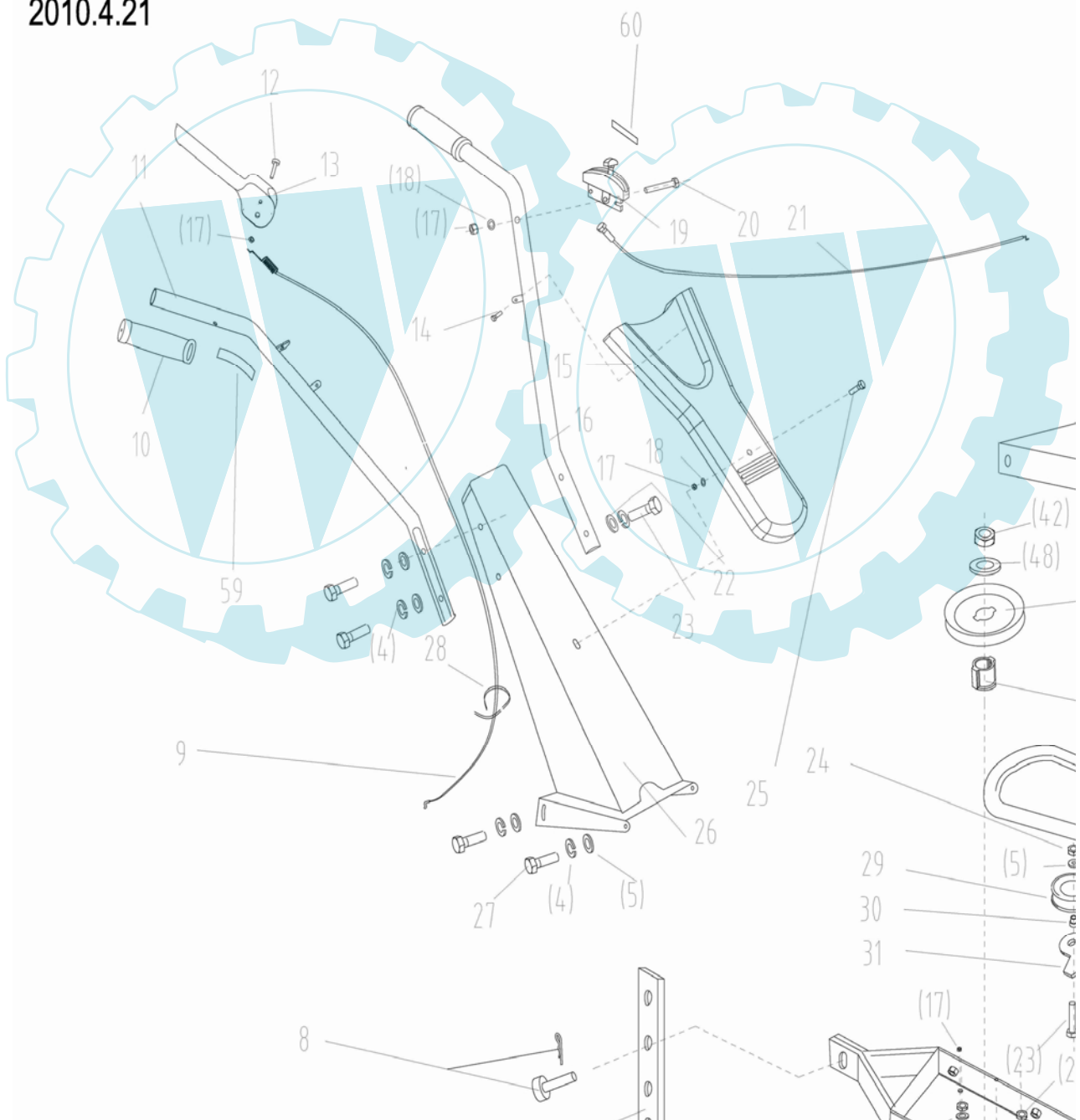

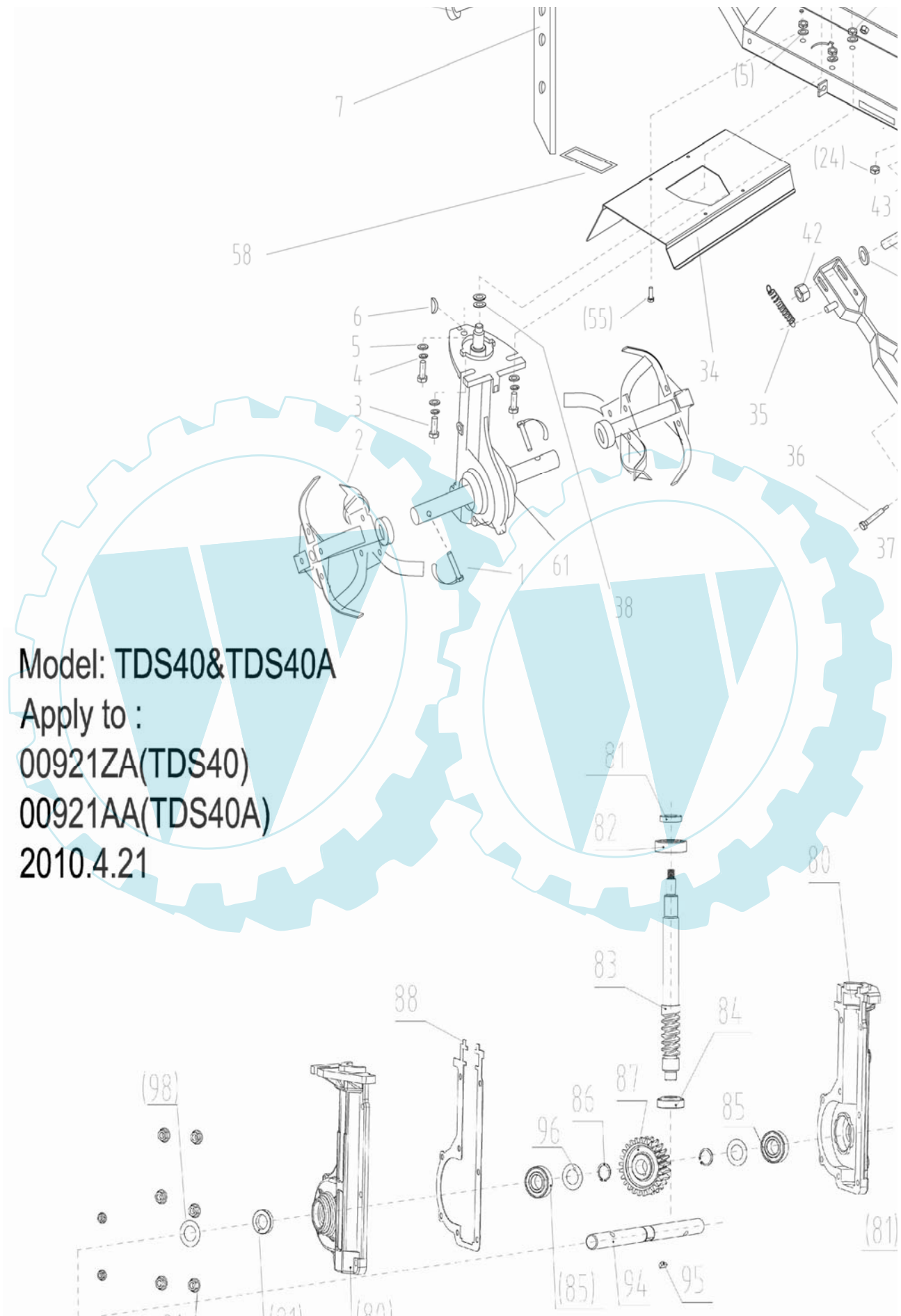

Model: TDS40&TDS40A

Apply to :

00921ZA(TDS40)

00921AA(TDS40A)

2010.4.21

DRAWING

Old model: TL40B)

Date: 9th Sep,2010

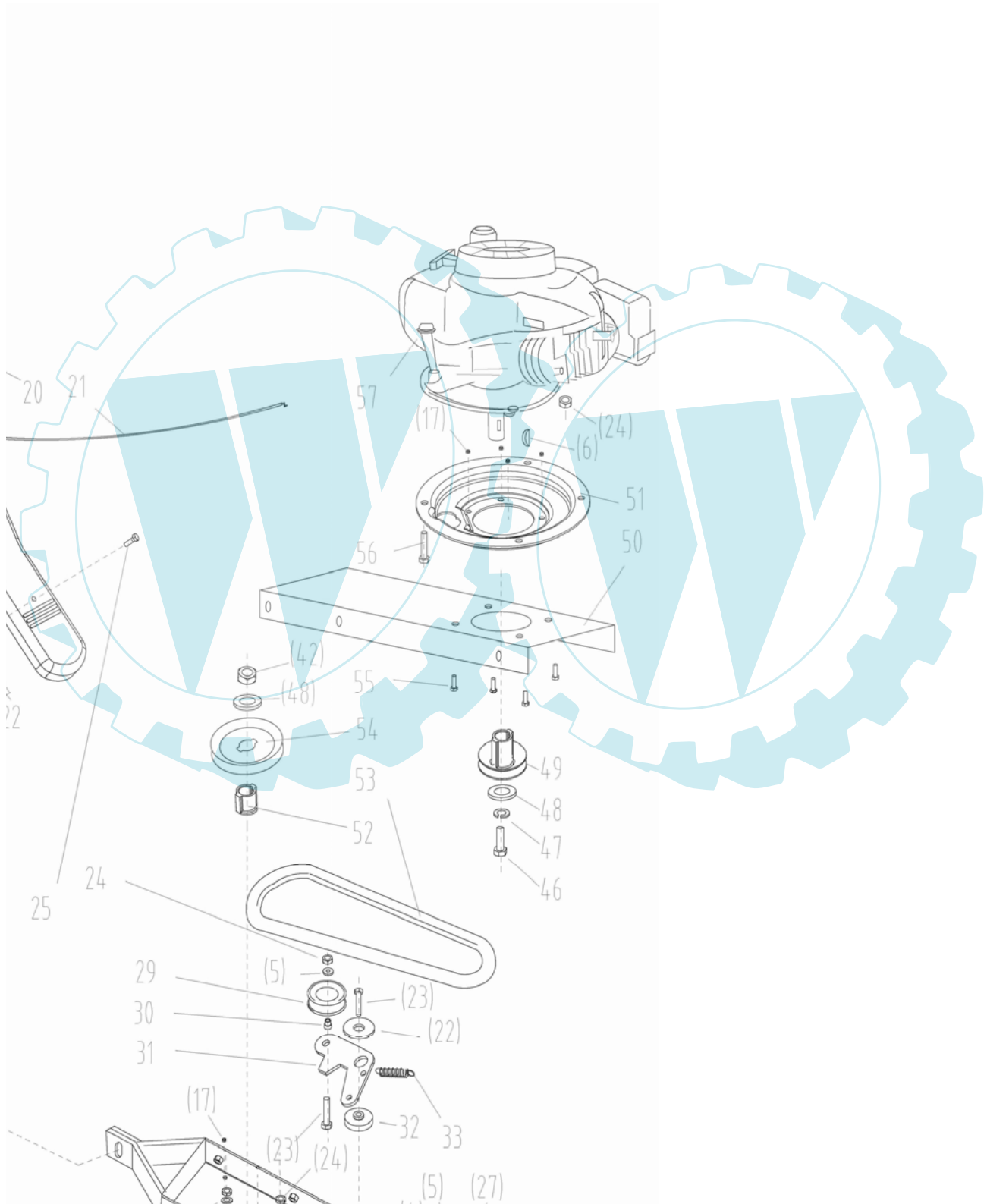

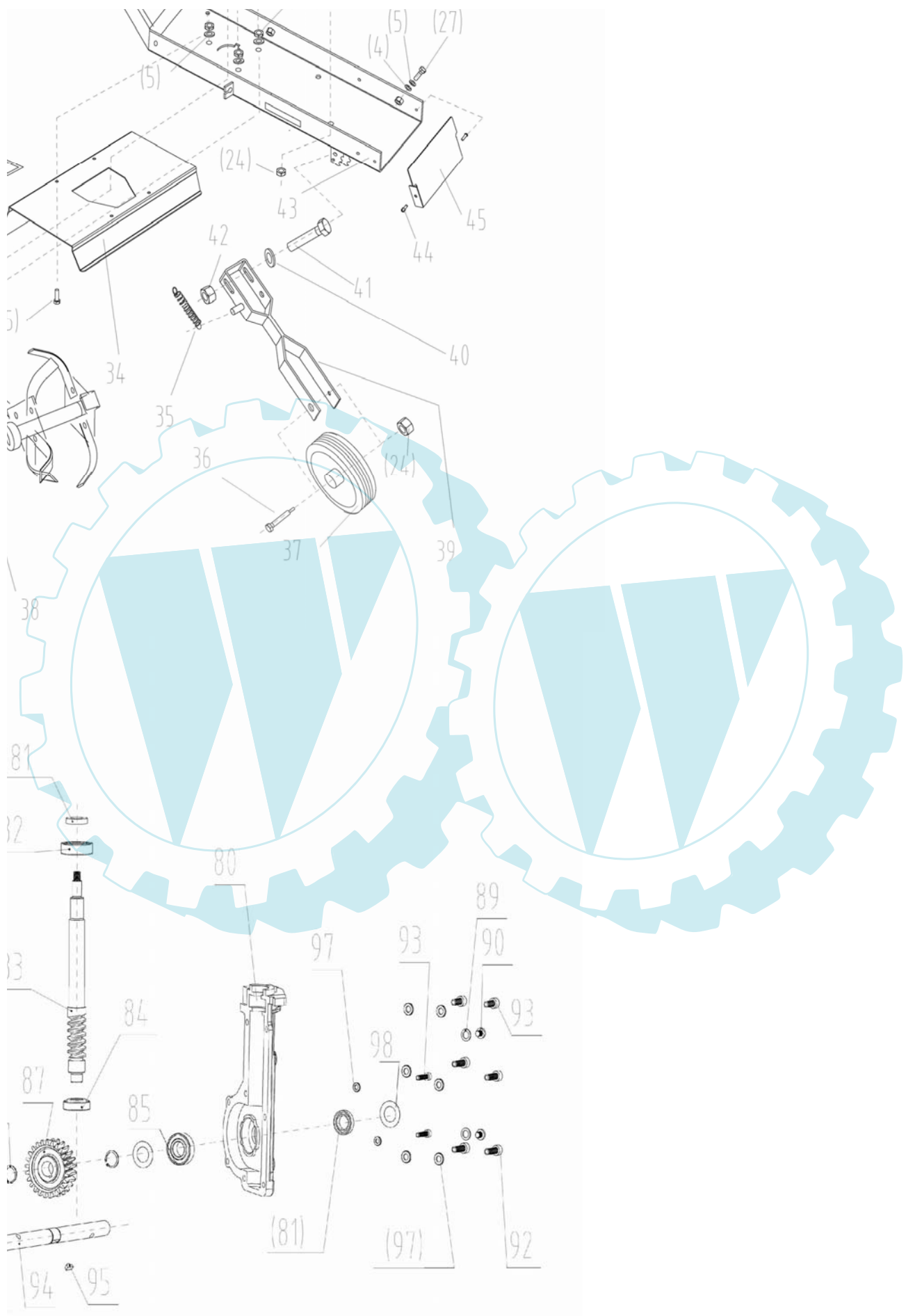



Spare Parts List

Engine-SP160FV(for TDS40)

Pos. No	Part code	Part Description	QTY	losable	damage-able	Consum-able	FOB Unit Price (USD)	Remark
1	B131014W012	Hexagon flange bolts M6x30	5					
2	B131008W012	Hexagon flange bolts M6x25	2					
3	919307	oil seal 25x38x6	1					
4	919100	cover-crankcase	1					
5	919200	pin	2					
6	919201	clamp	1					
7	B131001W012	Hexagon flange boltss M6x12	1					
8	919202	governor gear	1					
9	919900	gasket-cover	1					
10	919203	camshaft assy	1					
11	919204	tappet	2					
12	919205	drive gear	1					
13	919206	crankshaft	1					
14	919101	cover-connecting rod	1					
15	919207	screw	2					
16	B701403W012	woodruff key 4x6.5x16	1	Y				
17	919500	spring	2					
18	919208	board	1					
19	919209	board-governor system	1					
20	B131019W012	Hexagon flange bolts M6x35	1	Y				
21	B131008W012	Hexagon flange bolts M6x25	1	Y				
22	919210	clamp	1	Y				
23	B320038W012	Cross recessed pan head screws M6x25	1					
24	919300	vent pipe	2					
25	919211	support boss A	1					
26	919212	governor lever	1					
27	919309	oil seal 6x11x4	1					
28	B509007W012	Plain washers 6	1	Y				
29	919501	retainer ring	1					
30	919213	square neck bolt	1					
31	B228001W012	Hexagon nuts with flange M6	1					
32	919301	fuel pipe	1					

33	919214	clip b-fuel pipe	1				
34	919901	fuel filter	1				
35	919001	fuel tank	1				
36	919215	screw	1	Y			
37	919216	cushion	1	Y			
38	919302	dumping cushion	2	Y			
39	919002	cap assy-fuel tank	1				
40	919217	governor rocker	1				
41	919218	fuel tank support	1				
42	B131001W012	Hexagon flange bolts M6x12	2				
43	919902	filter	1				
44	919903	gasket	1				
45	919904	respirometer clapboard	1				
46	919219	respirometer cover assy	1				
47	B131001W012	Hexagon flange bolts M6X12	2	Y			
48	919220	flywheel assy	1				
49	919003	fan	1				
50	919221	starting bowl	1				
51	919222	flywheel nut	1				
52	B131006W012	Hexagon flange bolts M6X10	1				
53	919004	air director	1		Y		
54	919223	starter	1		Y		
55	B131013W012	Hexagon flange bolts M6X8	4	Y			
56	B320033W012	Cross recessed pan head screws M4X12	1	Y			
57	919700	switch	1				
58	B131001W012	Hexagon flange bolts M6X12	1				
59	B131008W012	Hexagon flange bolts M6X25	1				
60	919224	brake equip assy	1				
61	B131006W012	Hexagon flange bolts M6X10	1				
62	919308	oil seal 22X35X6	1				
63	B700466W012	Deep groove ball bearing 6205/DF	1				
64	B131008W012	Hexagon flange bolts M6X25	2				
65	919701	ignition coil	1				
66	B228001W012	Hexagon nuts with flange 6	2				
67	919005	case comp.	1				
68	919905	filter element assy	1			Y	
69	919303	packing	2				
70	919006	cover	1		Y		
71	919225	nut	2				
72	919906	washer	1				
73	919226	muffler assy	1				
74	919227	muffler protection	1				
75	B228001W012	Hexagon nuts with flange M6	2				
76	B131001W012	Hexagon flange bolts M6X12	2				
77	B131002W012	Hexagon flange bolts M6X16	2				
78	919228	cylinder head cover	1				
79	919304	gasket	1				
80	919229	nuts	2				
81	919230	rocker fixing nut	2				
82	919231	rockers	2				
83	919232	rocker fixing bolts	2				
84	919233	valve spring keepers	2				
85	919502	valve spring	2				
86	919234	push rod holder	1				

87	919235	push rod	2				
88	B131016W012	Hexagon flange bolts M8X45	4				
89	919102	cylinder head	1				
90	919236	intake valve	1				
91	919237	exhaust valve	1				
92	919238	parallels pins	2				
93	919907	gasket	1				
94	919103	cylinder assy	1				
95	919908	carburetor gasket	1				
96	919909	carburetor gasket	1				
97	919910	carburetor gasket	1				
98	919911	carburetor assy	1				
99	919912	gasket	1				
100	919239	stud bolt	2				
101	919240	chock lever	1				
102	919503	governor spring	1				
103	919504	lever	1				
104	919241	piston ring set	1				
105	919242	piston assy	1				
106	919244	piston kit	1				
107	919245	piston	1				
108	919505	clip	2				
109	919246	piston pin	1				
110	919007	oil deep stick	1				
111	919104	connecting rod	1				
112	919247	cushion	1				
113	B131015W012	Hexagon flange bolts M6X45	1				
114	919305	o ring	1				
115	919008	oil deep stick kit	1				
116	919306	o ring	1				
117	919248	oil drain plug A	1				
118	919249	oil drain plug B	1				
119	919506	fuel pipe clip	1				
120	919250	support dowel B	1				
121	919251	bolt	2				
122	919507	fuel line clip A	1				
123	919702	flameout wire	1				
124	919009	air filter assy.	1				
125	919703	spark plug F6RTC	1		Y		F6RTC
126	919105	connection rod assy	1				



EXPLOSIVE DRAWING

Petrol tiller ----Engine

