

TABLE N°:

07 01673 001

DESCRIPTION:

SHERPER LION 8000 II HB PRT

EXPLODED VIEW

DATE:

29.04.98

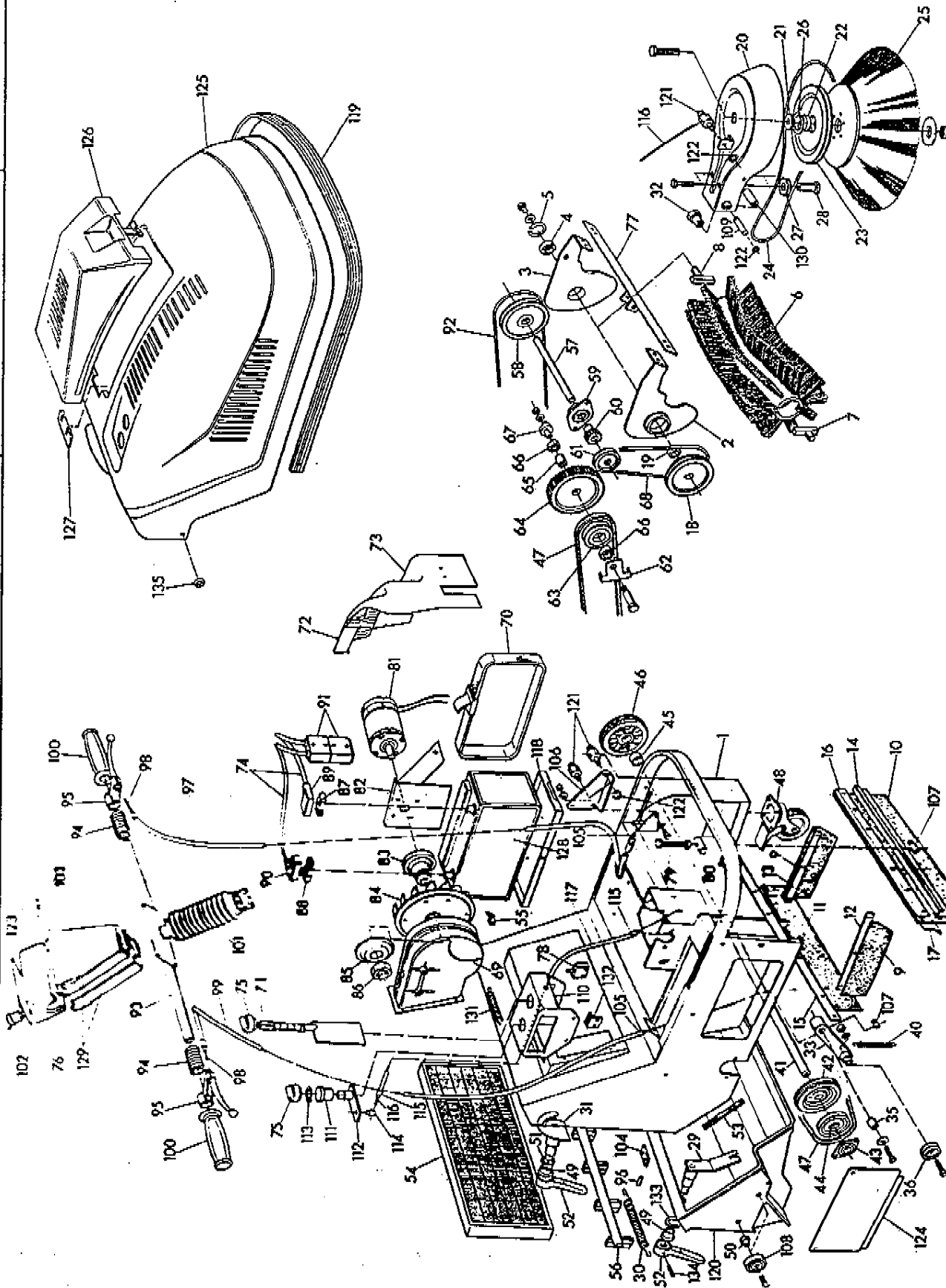

TABLE N° :		DESCRIPTION :					SPARE PARTS LIST		DATE :	
07 01673 001		SWEEPER LION 8000 II ME PRT							29.04.98	
REF.	CODE KIT	Q.TY	DESCRIPTION	DENOMINATION	BESCHREIBUNG	DESCRIPCION	DESCRIZIONE	TECHNICAL FEATURES	NOTES	
1	34969	1	BODY	COQUE	KAROSSERIEKORP.	CUERPO	SCocca	LION 8000 2.V		
2	34931	1	BRACKET	ETRIER	BUGEL	GRAPA	STAFFA	L.8000 DX 2.V		
3	34929	1	BRACKET	ETRIER	BUGEL	GRAPA	STAFFA	L.8000 SX 2.V		
4	19847	2	BALL BEARING	ROULEM.A BILLES	KUGELLAGER	COJINE.DE BOLAS	CUSCIN.A SFERE	6203 2R91		
5	32479	2	CIRCLIP	BAGUE D'ARRET	DRAHTSPRENGRING	ARANDELA MUELLE	ANELLO ELASTICO	D. 40 UNI 7437		
6	35380	1	CENTRAL BRUSH	BROSSE CENTRALE	ZENTRAL BURSTE	CEPILLO CENTRAL	SPAZZOLA CENTR.	D.255X600 PPL CUC. 80/60		
7	37106	1	DRIVE DISK	DISQUE D'ENTR.	MITNEHMERSCHEIB	DISCO ARRASP.	TRASCINATORE	L.8000 DX XF.N		
8	37107	1	DRIVE DISK	DISQUE D'ENTR.	MITNEHMERSCHEIB	DISCO ARRASP.	TRASCINATORE	L.8000 SX XF.N		
9	34999	2	RUBBER FLAP	CAOUTCHOUC FLAP	GUMMISCHL.FLAP	GOMA FLAP	GOMMA FLAP	L.8000 IT. 2.V		
10	34997	1	RUBBER FLAP	CAOUTCHOUC FLAP	GUMMISCHL.FLAP	GOMA FLAP	GOMMA FLAP	L.8000 3.V		
11	34996	1	RUBBER FLAP	CAOUTCHOUC FLAP	GUMMISCHL.FLAP	GOMA FLAP	GOMMA FLAP	L.8000 2.V		
12	34950	1	HOSE CLIP	AGRAFE P.TUYAU	SCHL.HALTERUNG	SUJECCION MANG.	FERMAGOMMA L.DX	L.8000 2.V INX		
13	34951	1	HOSE CLIP	AGRAFE P.TUYAU	SCHL.HALTERUNG	SUJECCION MANG.	FERMAGOMMA L.SX	L.8000 2.V INX		
14	34952	1	HOSE CLIP	AGRAFE P.TUYAU	SCHL.HALTERUNG	SUJECCION MANG.	FERMAGOMMA	L.8000 2.V INX EST.		
15	34949	1	HOSE CLIP	AGRAFE P.TUYAU	SCHL.HALTERUNG	SUJECCION MANG.	FERMAGOMMA	L.8000 2.V INX PST.		
16	34954	1	HOSE CLIP	AGRAFE P.TUYAU	SCHL.HALTERUNG	SUJECCION MANG.	FERMAGOMMA	L.8000 2.V INX FLAP		
17	34953	1	HOSE CLIP	AGRAFE P.TUYAU	SCHL.HALTERUNG	SUJECCION MANG.	FERMAGOMMA	L.8000 3.V INX INT.		
18	31822	1	PULLEY	POULIE	RIEMENSCHREIBE	POLEA	PULEGGIA	148-60 GT		
19	32120	1	SPACER	ENTRETOISE	DISTANZSTOCK	SEPARADOR	DISTANZIALE	D.1/2X 7 L.8000		
20	34957	1	SUPPORT	SUPPORT	HALTER	SOPORTE	SUPPORTO	L.8000 2.V		
21	32128	1	SPACER	ENTRETOISE	DISTANZSTOCK	SEPARADOR	DISTANZIALE	L.8000		
22	31731	1	BALL BEARING	ROULEM.A BILLES	KUGELLAGER	COJINE.DE BOLAS	CUSCIN.A SFERE	6201-2R91		
23	31829	1	PULLEY	POULIE	RIEMENSCHREIBE	POLEA	PULEGGIA	170-12		
24	31823	1	BELT	COURROIE	RIEMEN	CORREA	CINGHIA	8X1100		
25	31673	1	SIDE-BRUSH	BROSSE LATERAL	SEITLICH BURSTE	CEPILLO LATERAL	SPAZZOLA LATER.	D. 400		
26	32478	1	CIRCLIP	BAGUE D'ARRET	DRAHTSPRENGRING	ARANDELA MUELLE	ANELLO ELASTICO	D. 32 UNI 7437		
27	31826	2	PULLEY	POULIE	RIEMENSCHREIBE	POLEA	PULEGGIA	PCM 35 GT		
28	33935	2	PIN	PIVOT	ZAPFEN	PERNO	PERNO	SPZ.L.		
29	34941	1	CONTROL LEVER	LEVIER CONTROLE	STEUERUNG HEBEL	PALANCA MANDO	LEVA COMANDO	L.8000 2.V		
30	12055	1	SPRING	RESSORT	FEDER	MUELLE	MOLLA	TR144 D. 12 X41 F.1.5		
31	34961	1	ECCENTRIC CAM	CAME	NOCKEN	CAMMA	CAMMA	L.8000 2.V		
32	32118	2	BRUSH PIN	PIVOT BROSSE	BURSTENZAPFEN	PERNO CEPILLO	PERNO SPAZZOLA	L.8000		

TABLE N° :		DESCRIPTION :					SPARE PARTS LIST		DATE :	
07 01673 001		SWEEPER LION 8000 II ME PRT							29.04.98	
REF.	CODE KIT	Q.TY	DESCRIPTION	DENOMINATION	BESCHREIBUNG	DESCRIPCION	DESCRIZIONE	TECHNICAL FEATURES	NOTES	
33	37108	1	BELT-STRETCHER	TENDEUR COURB.	RIEMENSPELLER	TENSOR	TENDICINGHIA	L.8000 2.V-XF.N.		
35	32124	1	SOLID BOX	FOURREAU	HULSE	BRUJULA	BUSSOLA	L.8000		
36	31814	1	PULLEY	POULIE	RIEMENSCHREIBE	POLEA	PULEGGIA	PCM 70 GP + 6201 2R91		
40	12055	1	SPRING	RESSORT	FEDER	MUELLE	MOLLA	TR144 D. 12 X41 F.1.5		
41	31748	1	TRACTION AXLE	AXE	ACHSE	EJE	ASSE TRAZIONE	8.28 L.8000		
42	31915	1	WHEEL	ROUE	RAD	RUOTA	RUOTA	D.180-8.20 LNK180 60 SX		
43	33790	2	SUPPORT	SUPPORT	HALTER	SOPORTE	SUPPORTO	LEG HPFL 203 L.8000		
44	31750	1	PULLEY	POULIE	RIEMENSCHREIBE	POLEA	PULEGGIA	110-11		
45	32120	1	SPACER	ENTRETOISE	DISTANZSTOCK	SEPARADOR	DISTANZIALE	D.1/2X 7 L.8000		
46	31751	1	WHEEL	ROUE	RAD	RUOTA	RUOTA	D.180-8.20 LNK180 65 SX		
47	00358	1	BELT	COURROIE	RIEMEN	CORREA	CINGHIA	1 39		
48	13708	1	TURNING WHEEL	ROUE PIVOTANTE	DREHBARES RAD	RUEDA PIV.	RUOTA PIVOTTAN.	D.125 88M/FN/125		
49	34944	2	BUSHING	DOUILLE	BUCHSE	MANGUITO	BOCOLA	D. 20X16X26 NYL		
50	36619	4	SPACER	ENTRETOISE	DISTANZSTOCK	SEPARADOR	DISTANZIALE	D. 5-12 L-17 L.8 0T.		
51	34979	1	WASHER	RONDELLE	SCHREIBE	ARANDELA	ROSETTA	D.21.2X34 XI.5 NYL		
52	34947	2	HANDLE	POIGNEE	GRIFF	TIRADOR	MANGILIA	M12 F L=115 L.8 2.V		
53	00409	4	JOINT	GARNITURE	RUBAN	CIENRE	FETTUCCIA ADE.	15X3		
54	31669	1	FILTER	FILTRE	FILTER	FILTRO	FILTRO	600X250X55 14MM		
55	20127	6	CLIP	AGRAFE	KRAMPE	GRAPA	CLIP	KSM		
56	34939	1	FILTER SHAKER	MOTEUR SECOURS	FILTERSCHUTTLER	BATEFILTRO	SBATTIFILTRO	L.8000 2.V CMP.		
57	31799	1	TRACTION AXLE	AXE	ACHSE	EJE	ASSE TRAZIONE	L.8000 D.15 X225.		
58	31802	1	PULLEY	POULIE	RIEMENSCHREIBE	POLEA	PULEGGIA	130-1A		
59	06196	2	SUPPORT	SUPPORT	HALTER	SOPORTE	SUPPORTO	LEG HPFL 202		
60	31738	1	GEAR	ENGRENAGE	ZAHNRAD	ENGRANAJE	INGRANAGGIO	Z 15 M. 2		
61	31804	1	PULLEY	POULIE	RIEMENSCHREIBE	POLEA	PULEGGIA	50 G.T. L.8		
62	31806	1	BRACKET	ETRIER	BUGEL	GRAPA	STAFFA	L.8000 INX		
63	32167	1	PULLEY	POULIE	RIEMENSCHREIBE	POLEA	PULEGGIA	55-1A TR.		
64	31722	1	GEAR	ENGRENAGE	ZAHNRAD	ENGRANAJE	INGRANAGGIO	Z 70 M. 2		
65	32126	1	SPACER	ENTRETOISE	DISTANZSTOCK	SEPARADOR	DISTANZIALE	L.8000		
66	15159	2	BALL BEARING	ROULEM.A BILLES	KUGELLAGER	COJINE.DE BOLAS	CUSCIN.A SFERE	6001-2R91		
67	31816	1	SPACER	ENTRETOISE	DISTANZSTOCK	SEPARADOR	DISTANZIALE	D. 12-20 L=16		
68	31805	1	BELT	COURROIE	RIEMEN	CORREA	CINGHIA	10X 759		

TABLE N° : 07 01673 001		DESCRIPTION : SWEEPER LION 8000 II ME PRT		SPARE PARTS LIST			DATE : 09.04.98	
REF. CODE	KIT Q.TY	DESCRIPTION	DENOMINATION	BESCHREIBUNG	DESCRIPCION	DESCRIZIONE	TECHNICAL FEATURES	NOTES
69	31773	1	CONVEYOR	TAPIS DE TRANS.	FORDERER	ENROLLADOR	CONVOGLIATORE	L.8000 CPL. PP
70	35547	1	BELT	COUROIE	RIEMEN	CORREA	CINGHIA	PP. 25 L=1000 L.8
71	32556	1	THROTTLE	CONVOYEUR	KLAPPE	MARIPOSA	FARFALLA	LION PA
72	36612	1	PROTECTION	PROTECTION	SCHUTZ	PROTECCION	PROTEZIONE	L.8E 3.V ABS PST.
73	36611	1	PROTECTION	PROTECTION	SCHUTZ	PROTECCION	PROTEZIONE	L.8E 3.V ABS ANT.
74	33422	1	CABLE	CABLE	KABEL	CABLE	CAVO	SG 1X6 L= 650/ 400
75	10084	2	SWITCH	POIGNEE INT.	VERSTELLGRIF	MANOPLA INT.	MANOPIOLA INT.	O.K.A.
76	33114	1	INSTR.PANEL	TAB.DE BORD	ARM.BRETT	CRUSCOTTO	CRUSCOTTO	L.8000 - LAVAK. PP
77	34935	1	CROSS PIECE	BARRE TRANSVER.	KREUZSTANGE	TRAVESANO	TRAVERSA	L.8000 2.V
78	33679	1	SWITCH	INTERRUPTEUR	SCHALTER	INTERRUPTOR	INTERRUTTORE	XP52
79	35293	1	SCREW	VIS	SCHRAUBE	TORNILLO	VITE	TE M 12X120 L.8000
80	32114	1	CONTROL PIN	GOUJON CONTROLE	STEUERUNGZAPFEN	PERNO DE MANDO	PERNO COMANDO	L.8000
81	31585	1	TRACTION MOTOR	MOTEUR TRACTION	TRAKTION MOTOR	MOTOR TRACCION	MOTORE TRAZIONE	12V 400W
82	34916	1	MOTOR PLATE	PLAQUE P.MOTEUR	MOTORPLATTE	SOPORTE MOTOR	PIASTRA P.MOT.	L.8000 ME 2.V
83	31771	1	PULLEY	POULIE	RIEMENSCHREIBE	POLEA	PULEGGIA	L.8000 ME
84	32152	1	IMPELLER	HELICE	LUFTERRAD	TURBINA	VENTOLA	90/1004 L.8000
85	32110	1	COPEL	COUPELLE	SCHROFFKOPF	COPA	COPELLA	L.8000
86	32103	1	RING NUT	FRETTE	NUTMUTTER	CASQUILLO	GRIERA	L.8000
87	00281	1	CLAMP	BORNE	KLEMME	PRENS. SUJECION	MORSETTO	POS. FORD
88	02880	1	CLAMP	BORNE	KLEMME	PRENS. SUJECION	MORSETTO	GRIS. MQ016
89	09359	1	COUPLING	COIFFE	KLEINE HAUBE	COFIA	CUFFIETTA	GRIS. RS8
90	17888	1	COUPLING	COIFFE	KLEINE HAUBE	COFIA	CUFFIETTA	GRIS. BLEU
91	07039	1	PLUG	GOUPILLE	STIFT	PASADOR	SPINA	E120
92	31772	1	BELT	COUROIE	RIEMEN	CORREA	CINGHIA	10X 640
93	34965	1	UP STEERING	TUBE DE DIRECT.	LENKSAULE	PLANTON SUP.	PIANTONE SUP.	L.8000 2.V
94	31720	2	PROTECTOR	PROTECTION	ROHRSCHUTZ	PROTECCION	SOFFIETTO	22 X 44
95	33525	2	LEVER	LEVIER	HEBEL	PALANCA	LEVA	D.22 NYL
96	34921	1	PLUG	GOUPILLE	STIFT	PASADOR	SPINA	5X45 INX C40 1707
97	25585	1	SHEATH	GAINE	MANTEL	VAINA	GUAINA	VIPLAST 2,5X4,5X5,2 LI420
98	13173	2	CABLE	CABLE	SEIL	CUERDA	FUNE	D. 1.9 L=1.600
99	32214	1	SHEATH	GAINE	MANTEL	VAINA	GUAINA	2,5 X 4,5 X 1070
100	31584	2	KNOB	POIGNEE	VERSTELLGRIF	MANOPLA	MANOPIOLA	D.22

TABLE N° : 07 01673 001		DESCRIPTION : SWEEPER LION 8000 II ME PRT		SPARE PARTS LIST			DATE : 09.04.98	
REF. CODE	KIT Q.TY	DESCRIPTION	DENOMINATION	BESCHREIBUNG	DESCRIPCION	DESCRIZIONE	TECHNICAL FEATURES	NOTES
101	31719	1	PROTECTOR	PROTECTION	ROHRSCHUTZ	PROTECCION	SOFFIETTO	55 - 50 x 215
102	30416	1	SWITCH	INTERRUPTEUR	SCHALTER	INTERRUPTOR	INTERRUTTORE	ZADI 8328
103	34008	1	ELEC. CIRCUIT	CIRCUIT. ELECT.	ELEKTR. STROM.	CIRCUITO ELECT.	SCHEMA ELETTR.	LED L.8E 12V. 2.V
104	34924	1	BRACKET	BRIDE	BOGEL	GRAPA	STAFFA FISS.	L.8000 2.V
105	02396	2	REGISTER	REGLEUR	KLAPPE	REGISTRO	REGISTRO	CH. EX GR130
106	34955	1	LEVER	LEVIER	HEBEL	PALANCA	LEVA	FLAP L.8000 2.V INI
107	13590	2	CLAMP	BORNE	KLEMME	PRENS. SUJECION	MORSETTO	VT 8X11,MS L047 700
108	34920	4	WHEEL	ROUE	LAUFRAD	RUEDA	RUOTA LIBERA	D. 40-8. 7 STL L.8
109	36272	1	BELT PIN	PIVOT COUROIE	HEBELNAPFEN	PERNO CORREA	PERNO CINGHIA	D. 8X64 L.8 2V. INI
110	34971	1	SUPPORT BRACKET	ETRIER SUPPORT	KALTER BOGEL	GRAPA SOPORTE	STAFFA SUPPORTO	L.8000 2.V
111	34948	1	BUSHING	DOUILLE	BUCHSE	MANGUITO	BUCCHIA	L.8000 P16
112	32122	1	CONTROL LEVER	LEVIER CONTROLE	STEUERUNG HEBEL	PALANCA MANDO	LEVA COMANDO	L.8000
113	27064	1	CIRCLIP	BAGUE D'ARRET	DRAHTSPRENGRING	ARANDELA MUELLE	ANELLO ELASTICO	D. 14 UNI 7435
114	32233	1	CLAMP	BORNE	KLEMME	PRENS. SUJECION	MORSETTO	VT10 X 16 M 6
115	28891	2	SOLID BOX	FOURREAU	HULSE	BRIJULA	BUSSOLA	D. 9.7X15 - D.5F D.3
116	32216	1	CORD	CORDE	KLEINS	CUERDA	CORDA	D.2,5 X 900
117	32215	1	SHEATH	GAINE	MANTEL	VAINA	GUAINA	3,5X6X7X425
118	35548	1	BATTERY SUPPORT	SUPPORTBATTERIE	HALTER BATTERIE	PORTABATERIA	PORTABATTERIA	L.8000 ME 2.V PST
119	33901	1	BUMPER	PARE-CHOC	STOSSDAMPFER	PARACHOQUES	PARAURTI	43X15 NYL L8 EPDM
120	31752	1	DRAWER	TIROIR	SCHIEBENKASTEN	CAJON	CASSETTO	L.8000 PP
121	34027	3	BARREL	BARICAUT	AUSGLEICHBEL.	BARRILETE	BARILOTTO	CH.14X17 M5
122	36062	5	WASHER	RONDELLE	SCHREIB	ARANDELA	ROSETTA	D. 8 CM
123	32174	1	LABEL	ETICHETTE	ETICHETTE	ETIQUETA	ETICHETTA	LION 8000ME POLIC
124	34914	1	THROTTLE	GUICHET	KLAPPE	VENTANILLA	SPORTELLO	L.8000 IT. 2.V
125	34874	1	RED COVER	COUVERTURE ROUC	ROTARBECKUNG	CUBIERTA ROJO	COPERTURA ROSSA	L. 8000 2.V PP
126	34876	1	RED THROTTLE	GUICHET ROUC	ROTABKLAPPE	VENTANILLA ROJO	SPORTELLO ROSSO	L. 8000 PP
127	34981	2	BLACK CAP	BOUCHON NOIR	SCHWARTZVERSCH.	TAPON NEGRO	TAPPO NERO	L.8000 PA6
128	31308	1	BATTERY	BATTERIE	BATTERIE	PILETTA	BATTERIA	150 AH 12V
129	33116	2	HALF BEARING	DEMI-COQUE	HALBSCHALE	SEMIFUNDA	SEMIGUSCIO	PP 2.V
130	36271	1	PIPE	TUYAU	ROHR	TUBO	TUBETTO	D.14X50 L.8 2V. PVC
131	34379	1	SPRING	RESSORT	FEDER	MUELLE	MOLLA	TR T17 D. 8 X45 SP.1
132	33998	1	SUPPORT BRACKET	ETRIER SUPPORT	HALTER BOGEL	GRAPA SOPORTE	STAFFA SUPPORTO	L.9000 ME

TABLE N° :		DESCRIPTION :				SPARE PARTS LIST			DATE :	
07 01673 001		SWEEPER LION 8000 II ME P&T							29.04.98	
REF. CODE KIT	Q.TY	DESCRIPTION	DENOMINATION	BESCHREIBUNG	DESCRIPCION	DESCRIZIONE	TECHNICAL FEATURES	NOTES		
133	00536	1	WASHER	RONDELLE	SCHLEIBE	ARANDELA	ROSETTA	D.16	X22 XI FB.	
134	35779	2	ELASTIC PLUG	PRISE ELASTIQUE	SPANNEHULSE	PASADOR ELAST.	SPINA ELASTICA	5X30	QMI 6873	
135	14911	8	UND.SCREW FLAN.	BOARD SOUS-VIS	UNT.SCHRAUBE B.	BORDE	ORLI SOTTOVITE	D. 6		

400-435-D 2 000- 2 000

TABLE N° :		DESCRIPTION :				SPARE PARTS LIST			DATE :	
REF. CODE KIT	Q.TY	DESCRIPTION	DENOMINATION	BESCHREIBUNG	DESCRIPCION	DESCRIZIONE	TECHNICAL FEATURES	NOTES		

400-435-D 2 000- 2 000