

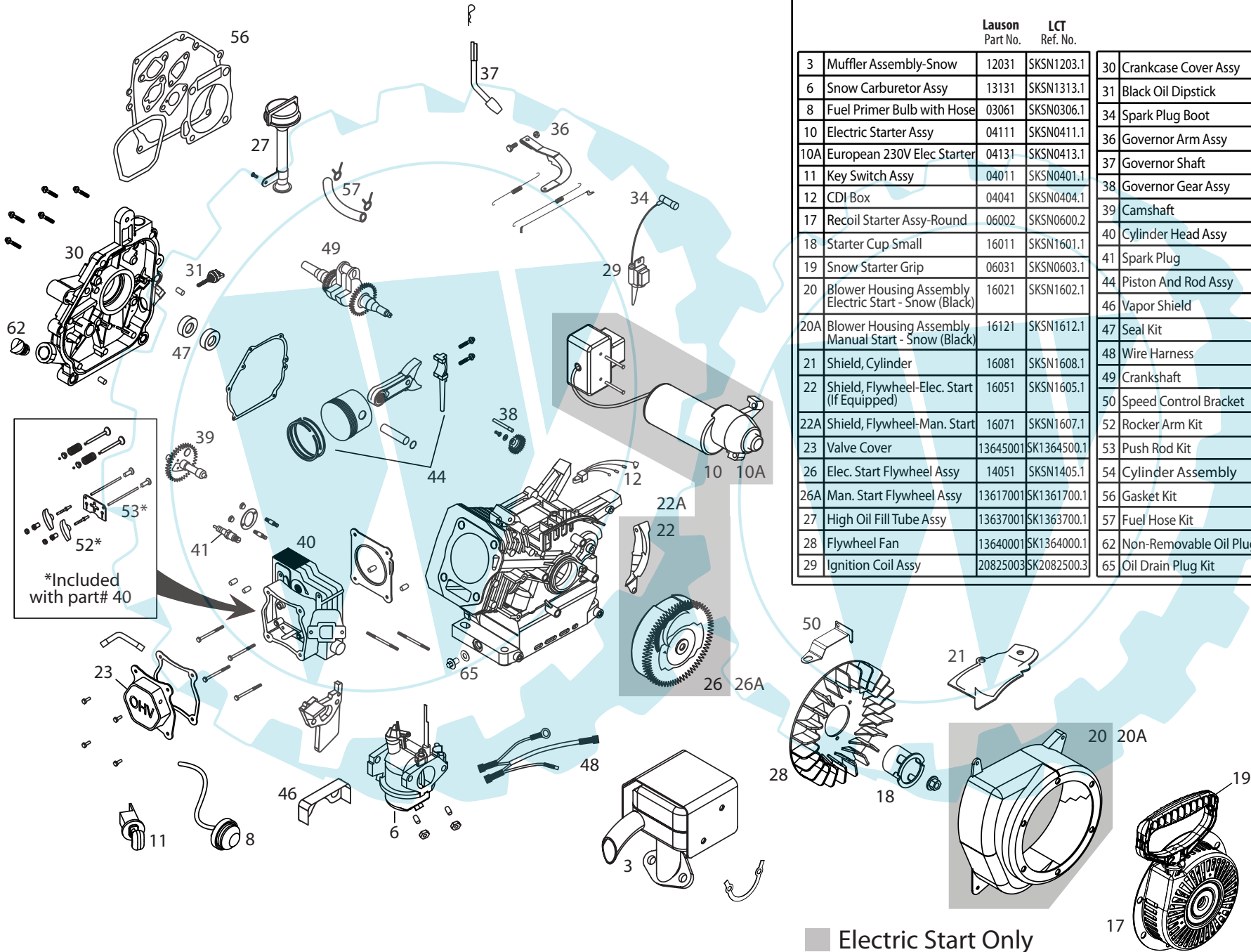

**136CC SINGLE STAGE SNOW ENGINE
SERVICE PARTS FOR MODEL NUMBERS
PW3HK1840018P-ABFGOQTUVZE1M
PW3HK1840018E-ABFGOQTUVZE1M**



		Lauson Part No.	LCT Ref. No.		Lauson Part No.	LCT Ref. No.
3	Muffler Assembly-Snow	12031	SKSN1203.1	30	Crankcase Cover Assy	13636001 SK1363600.1
6	Snow Carburetor Assy	13131	SKSN1313.1	31	Black Oil Dipstick	20837111 SK2083711.1
8	Fuel Primer Bulb with Hose	03061	SKSN0306.1	34	Spark Plug Boot	469111 SKSN4691.1
10	Electric Starter Assy	04111	SKSN0411.1	36	Governor Arm Assy	13630001 SK1363000.1
10A	European 230V Elec Starter	04131	SKSN0413.1	37	Governor Shaft	13631001 SK1363100.1
11	Key Switch Assy	04011	SKSN0401.1	38	Governor Gear Assy	20829001 SK2082900.1
12	CDI Box	04041	SKSN0404.1	39	Camshaft	13616001 SK1361600.1
17	Recoil Starter Assy-Round	06002	SKSN0600.2	40	Cylinder Head Assy	13610001 SK1361000.1
18	Starter Cup Small	16011	SKSN1601.1	41	Spark Plug	20838101 SK2083810.1
19	Snow Starter Grip	06031	SKSN0603.1	44	Piston And Rod Assy	13614001 SK1361400.1
20	Blower Housing Assembly Electric Start - Snow (Black)	16021	SKSN1602.1	46	Vapor Shield	01551 SKSN0155.1
20A	Blower Housing Assembly Manual Start - Snow (Black)	16121	SKSN1612.1	47	Seal Kit	13639001 SK1363900.1
21	Shield, Cylinder	16081	SKSN1608.1	48	Wire Harness	01611 SKSN0161.1
22	Shield, Flywheel-Elec. Start (If Equipped)	16051	SKSN1605.1	49	Crankshaft	10001 SKSN1000.1
22A	Shield, Flywheel-Man. Start	16071	SKSN1607.1	50	Speed Control Bracket	01501 SKSN0150.1
23	Valve Cover	13645001	SK1364500.1	52	Rocker Arm Kit	13611001 SK1361100.1
26	Elec. Start Flywheel Assy	14051	SKSN1405.1	53	Push Rod Kit	13610011 SK1361001.1
26A	Man. Start Flywheel Assy	13617001	SK1361700.1	54	Cylinder Assembly	10011 SKSN1001.1
27	High Oil Fill Tube Assy	13637001	SK1363700.1	56	Gasket Kit	13643001 SK1364300.1
28	Flywheel Fan	13640001	SK1364000.1	57	Fuel Hose Kit	20860011 SK2086001.1
29	Ignition Coil Assy	20825003	SK2082500.3	62	Non-Removable Oil Plug	20837051 SK2083705.1
				65	Oil Drain Plug Kit	20899111 SK2089911.1

rev. 1/11/11

■ Electric Start Only