

# TC-ECCY-CCCY-E4BX

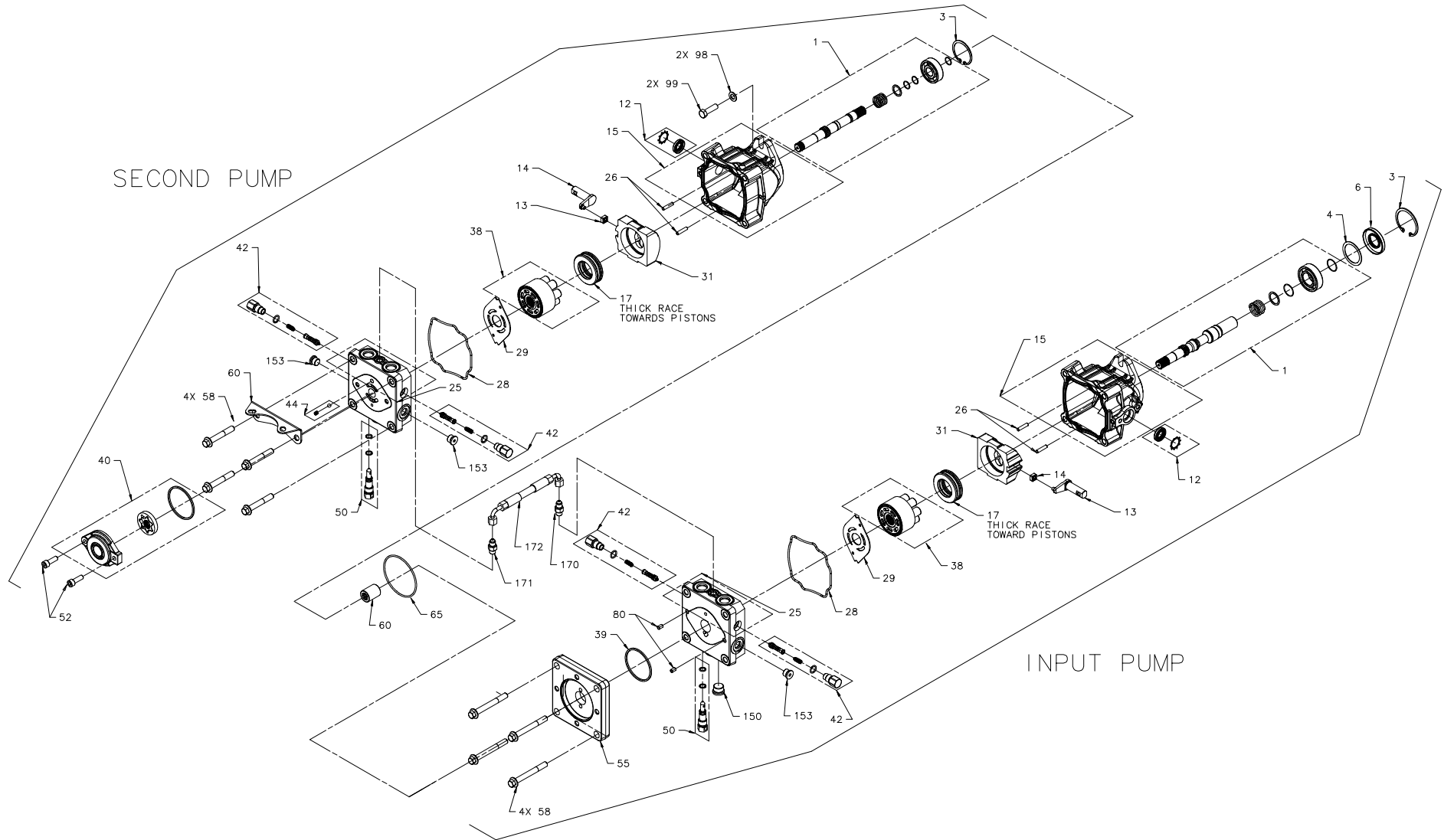

OVERHAUL SEAL KIT 70941

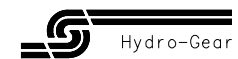

# TC-ECCY-CCCY-E4BX

## INPUT PUMP

ITEM	PART #	QTY	DESCRIPTION
1	71284	1	KIT, AXLE (7/8" KEYED)
		1	INPUT SHAFT - 7/8" KEYED
		2	RETAINING RING - WIRE
		1	BEARING, BALL
		1	WASHER, THRUST
		1	SPRING, HELICAL COMPRESSION
3	50859	1	RETAINING RING - 52mm
4	51279	1	SPACER
6	51280	1	SEAL, LIP 25 x 52 x 7 PTC
12	70739	1	KIT, TRUNNION SEAL
		1	RETAINING RING - TRUNNION SEAL
		1	SEAL, LIP 15 X 27 X 5
13	2000014	1	TRUNNION ARM (DOUBLE D)
14	2000015	1	SLOT GUIDE
15	70965	1	KIT, HOUSING
		1	HOUSING - MACHINED
		2	BEARING, CRADLE
		1	BEARING, JOURNAL
17	51462	1	BEARING, THRUST
25	70967	1	KIT, END CAP (TANDEM)
		1	END CAP (TANDEM)
		1	BEARING, NEEDLE (SHAFT)
		1	PLUG - 5/16-24 STEEL
26	50641	2	PIN, HEADLESS
28	51437	1	GASKET, HOUSING
29	52371	1	VALVE PLATE
31	51436	1	SWASHPLATE
38	70735	1	KIT, CYLINDER BLOCK - MOTOR
		1	CYLINDER BLOCK - MOTOR
		7	SPRING, PISTON
		7	PISTON
		7	PISTON SPRING SEAT
39	51016	1	O-RING
42	70743	2	KIT, SHOCK VALVE (200 BAR, .031 ORIFICE)
		1	SHOCK VALVE
		1	PLUG, SHOCK VALVE
		1	SPRING, COMPRESSION (SHOCK-CHECK)
		2	O-RING
50	2513030	1	BYPASS VALVE KIT
		1	BYPASS VALVE (NO ORIFICE)
		1	O-RING
		1	RING, BACK-UP
55	51560	1	PLATE, ADAPTER (TANDEM)
58	51826	4	HEX SCREW, FH M10
80	9004800-2506	2	PIN, HEADLESS
150	9005110-7500	1	PLUG - 3/4-16 STEEL
153	9005110-5600	1	PLUG - 9/16-18 STEEL

## SECOND PUMP

ITEM	PART #	QTY	DESCRIPTION
1	70607	1	KIT, AXLE (20T 32/64 TO 20T 32/64, CHG AUX)
		1	INPUT SHAFT - 20T 32/64 TO 20T 32/64 (CHG AUX)
		3	RETAINING RING - WIRE
		1	BEARING, BALL
		1	WASHER, THRUST
		1	SPRING, HELICAL COMPRESSION
3	2000038	1	RETAINING RING - 47mm
12	70739	1	KIT, TRUNNION SEAL
		1	RETAINING RING - TRUNNION SEAL
		1	SEAL, LIP 15 X 27 X 5
13	2000014	1	TRUNNION ARM (DOUBLE D)
14	2000015	1	SLOT GUIDE
15	70966	1	KIT, HOUSING
		1	HOUSING - MACHINED
		2	BEARING, CRADLE
		1	BEARING, JOURNAL
17	51462	1	BEARING, THRUST
25	70736	1	KIT, END CAP (TANDEM)
		1	END CAP (TANDEM)
		1	BEARING, NEEDLE (SHAFT)
		1	PLUG - 5/16-24 STEEL
26	50641	2	PIN, HEADLESS
28	51437	1	GASKET, HOUSING
29	52371	1	VALVE PLATE
31	51436	1	SWASHPLATE
38	70735	1	KIT, CYLINDER BLOCK - MOTOR
		1	CYLINDER BLOCK - MOTOR
		7	SPRING, PISTON
		7	PISTON
		7	PISTON SPRING SEAT
40	2510071	1	KIT, CHARGE PUMP
		1	CHARGE PUMP HOUSING
		1	GEROTOR ASSY .19 CI/REV
		1	R-RING - 144 (STD CHARGE)
42	70743	2	KIT, SHOCK VALVE (200 BAR, .031 ORIFICE)
		1	SHOCK VALVE
		1	PLUG, SHOCK VALVE
		1	SPRING, COMPRESSION (SHOCK-CHECK)
		2	O-RING
44	70402	1	KIT, CHARGE RELIEF
		1	SPRING, CHARGE RELIEF
		1	BALL, CHECK RELIEF
50	2513030	1	BYPASS VALVE KIT
		1	BYPASS VALVE (NO ORIFICE)
		1	O-RING
		1	RING, BACK-UP
52	50173	2	SCREW, M8 X 1.25 X 25mm LONG
58	51826	4	HEX SCREW, FH M10
60	51593	1	TORQUE BRACKET
153	9005110-5600	2	PLUG - 9/16-18 STEEL

## MISC. COMPONENTS

ITEM	PART #	QTY	DESCRIPTION
60	51275	1	COUPLING 20T 32/64
65	51509	1	O-RING, .103 X 3.237 ID
98	51506	2	WASHER, .734 X .406 X .063
99	51765	2	SHCS 3/8-16 X 1
100	70941	1	OVERHAUL SEAL KIT
170	51310	1	FITTING, 7/16 SAE ST-JIC
171	51310	1	FITTING, 7/16 SAE ST-JIC
172	51311	1	HOSE ASSY - 7.1 LONG