

K1211-1111A
312-3000

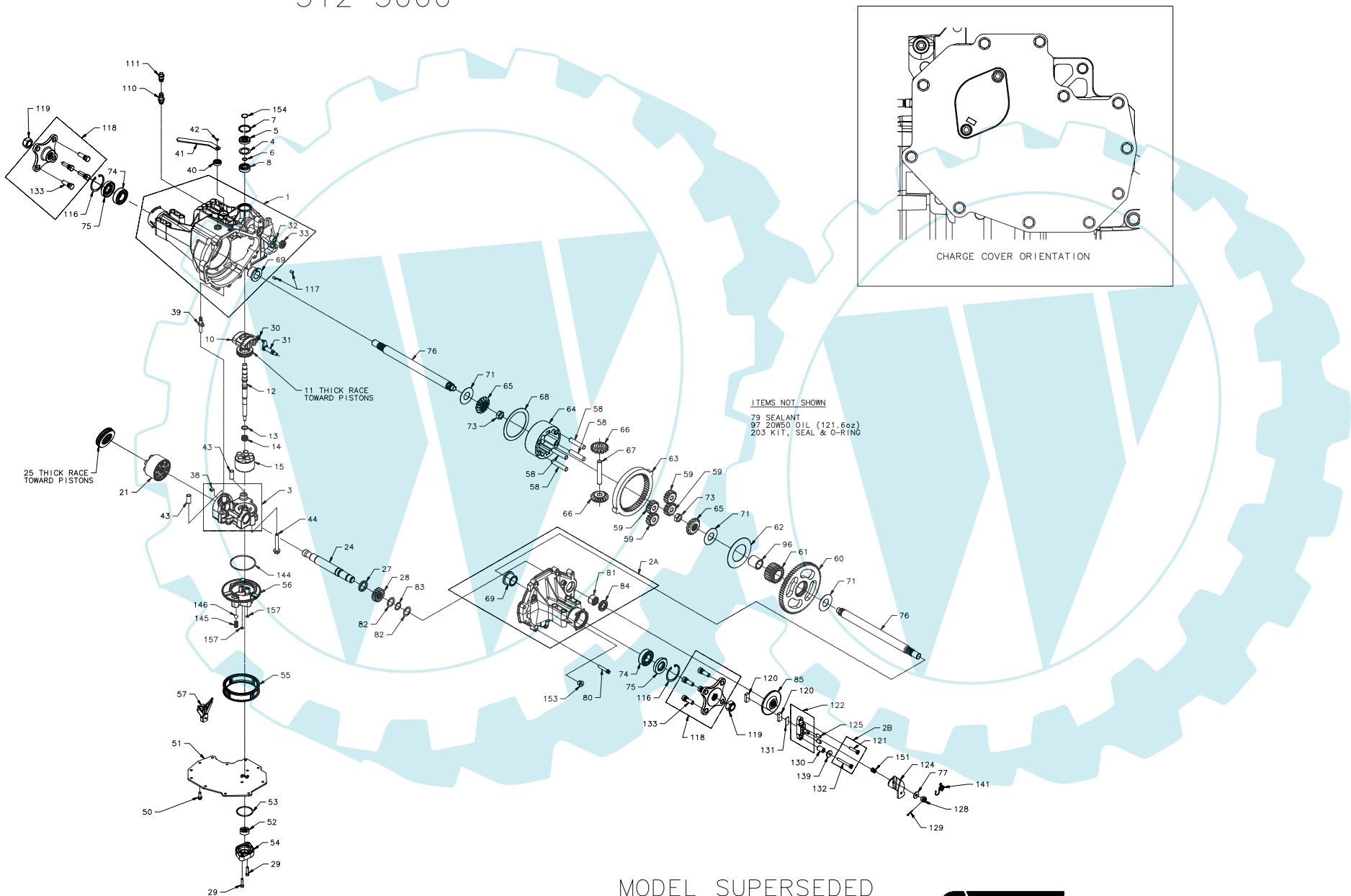

MODEL SUPERSEDED

FOR ENTIRE MODEL REPLACEMENT
REFERENCE K1211-11121 (323-3000)



K1211-1111A
312-3000

ITEM#	PART #	QTY	DESCRIPTION	ITEM#	PART #	QTY	DESCRIPTION	ITEM#	PART #	QTY	DESCRIPTION
1	70297	1	ASSEMBLY, MAIN HOUSING	50	50752	11	SCREW, HEX FLANGE 1/4-20 X .75	132	51928	1	BOLT, HEX HD 1/4-20 X 2.25 W/PATCH
		1	HOUSING, MAIN	51	50972	1	COVER, LOWER W/ 2 KIDNEYS	133	44431	8	STUD, 1/2-20 X 1.55 (RIB NECK)
		1	SEAL, LIP 12 X 25 X 7	52	50273	1	GEROTOR	139	44278	1	WASHER, .27 X .88 X .12
		1	BEARING, FLANGE 1.0 X 1.376 X .99	53	9004101-1340	1	O-RING, 1.862 X 2.068	141	50884	1	SPRING, BRAKE ARM BIAS
		1	BEARING, TRUNNION	54	50260	1	HOUSING, CHARGE PUMP	144	50974	1	O RING, 2.987 X 3.09
		2	BEARING, CRADLE	55	70538	1	KIT, FILTER	145	51157	1	SPRING, RELIEF
2A	71120	1	ASSEMBLY, RIGHT HAND HOUSING			2	GASKET, 4.24 X 4.40 X .10	146	9001214-4400	1	BALL, 7/16 IN
		1	HOUSING, RIGHT HAND			1	FILTER, STD CHARGE	151	50919	1	SPRING, COMP. BRAKE ANTI-DRAG
		1	BEARING, FLANGE 1.0 X 1.376 X .99	56	51156	1	MANIFOLD, CHARGE	153	9005110-5600	2	PLUG, 9/16-18 (METAL)
		1	BEARING, NEEDLE .875 X 1.125 X .75	57	50796	1	RETAINER, MOTOR BEARING	157	50977	2	O-RING, .239 X .309
		1	SEAL, LIP .875 X 1.375 X .250	58	50776	4	PIN, CARRIER	203	70492	1	KIT, SEAL & O-RING
2B	71139	1	KIT, BRAKE BOLT	59	50763	4	GEAR, 15T PLANET			1	SEAL, LIP 15 X 35 X 7
		1	BOLT, HEX HD 1/4-20 X 1.25 W/PATCH	60	50646	1	GEAR, 67T SPUR			1	SEAL, LIP 12 X 25 X 7
		1	BOLT, HEX HD 1/4-20 X 2.25 W/PATCH	61	50645	1	GEAR, 21T SUN			1	SEAL, LIP 10 X 25 X 7
3	70683	1	ASSEMBLY, CENTER SECTION	62	50769	1	WASHER, THRUST 2.32 X 4.10 X .05			1	O-RING, 1.862 X 2.068
		1	CENTER SECTION	63	50764	1	GEAR, 51T RING			1	O-RING, .468 X .624
		1	BEARING, JOURNAL .50 X .59 X .50	64	50765	1	CARRIER, PLANETARY			4	SEAL, LIP, .875 X 1.375 X .250
		1	BEARING, .90 X 1.0 X .75	65	50647	2	GEAR, 14T MITER (SPLINED)			1	O-RING, .239 X .309
		1	PLATE, BYPASS	66	50648	2	GEAR, 14T MITER (UNSPLINED)			1	KIT, O-RING MANIFOLD
		2	CHECK PLUG ASSEMBLY, .027 BLEED	67	50766	1	SHAFT, DIFFERENTIAL				
4	2003018	1	SPACER, .98 X 1.37 X .04	68	50767	1	WASHER, THRUST 3.46 X 4.39 X .05				
5	9008000-0128	1	SEAL, LIP 15 X 35 X 7	69	50768	2	BEARING, FLANGE 1.0 X 1.376 X .99				
6	2003016	1	RING, RETAINING	71	50788	3	WASHER, 1.0 X 2.25 X .04				
7	2003052	1	RING, RETAINING	73	50791	2	NUT, HEX 5/8-18 W/ PATCH				
8	2003043	1	BEARING, BALL .59 X 1.38 X .43	74	50771	2	BEARING, BALL 25.4 X 52 X 15				
10	2003087	1	SWASHPLATE, VARIABLE	75	50772	2	SEAL, LIP 1.0 X 2.049 X .375				
11	50551	1	BEARING, THRUST 30 X 52 X 13	76	50825	2	SHAFT, AXLE 1.0 X 13.84 (30° SPLINED)				
12	50795	1	SHAFT, INPUT (STD CHARGE)	77	44130	1	WASHER, .34 X .88 X .06				
13	2003017	1	WASHER, THRUST .59 X .79 X .04	79	50928	10,10z	SEALANT				
14	2003014	1	SPRING, BLOCK	80	50868	9	SCREW, TORX HD 5/16-18 X 1.5				
15	70331	1	ASSEMBLY, BLOCK	81	44752	1	BEARING, NEEDLE .875 X 1.125 X .75				
		1	BLOCK, CYLINDER	82	50777	2	WASHER, FLAT .88 X 1.25 X .04				
		5	PISTON	83	50775	1	RING, RETAINING				
		5	SPRING, COMPRESSION	84	50773	1	SEAL, LIP .875 X 1.375 X .250				
		5	WASHER, THRUST	85	50779	1	DISK, BRAKE				
21	70082	1	ASSEMBLY, BLOCK	96	50866	1	BUSHING, SLEEVE 1.0 X 1.3 X 1.34				
		1	BLOCK, CYLINDER	97		21,60z	OIL, 20W50				
		7	PISTON	110	70110	1	ASSEMBLY, O-RING & FITTING				
		7	SPRING, COMPRESSION			1	O-RING, .468 X .624				
		7	WASHER, THRUST	111	70109	1	FITTING, PLASTIC STRAIGHT				
24	50662	1	SHAFT, MOTOR			1	ASSEMBLY, CAP-VENT				
25	50552	1	BEARING, THRUST 42 X 68 X 16			1	CAP, VENT				
27	50774	1	SPACER, 1.03 X 1.38 X .184	116	50859	2	VENT, PLASTIC				
28	50661	1	GEAR, 16T PINION	117	9004800-2506	2	RING, RETAINING				
29	50975	2	SCREW, CAP M6 X 1 X 25	118	70314	2	PIN, STANDARD HEADLESS				
30	2000015	1	GUIDE, SLOT			2	ASSEMBLY, HUB				
31	2003005	1	ARM, TRUNNION THRU HOLE			1	HUB, 4 STUD (PAINTED)				
32	2003009	1	BEARING, TRUNNION			4	STUD, 1/2-20 X 1.55 (RIB NECK)				
33	9008000-0126	1	SEAL, LIP 12 X 25 X 7	119	50863	2	NUT, HEX LOCK 3/4-16				
38	70680	1	KIT, BYPASS PLATE	120	44132	2	PUCK, BRAKE				
39	2003555	1	ACTUATOR, BYPASS	121	51927	1	BOLT, HEX HD 1/4-20 X 1.25 W/PATCH				
40	45074	1	SEAL, LIP 10 X 25 X 7	122	70633	1	ASSEMBLY, BRAKE YOKE				
41	50929	1	ARM, BYPASS	124	50936	1	ARM, BRAKE				
42	44870	1	RING, RETAINING	125	44127	2	PIN, BRAKE ACTUATING				
43	50002	2	PIN, HOLLOW .39 X .50 X 1.12	128	44142	1	NUT, CASTLE 5/16-24				
44	50016	3	SCREW, HEX FLANGE 3/8-24 X 2.5	129	44101	1	PIN, COTTER 3/32 X 3/4				
				130	23711	1	SPACER, .26 X .57 X .87				
				131	44134	1	PLATE, PUCK				

MODEL SUPERSEDED

FOR ENTIRE MODEL REPLACEMENT
REFERENCE K1211-11121 (323-3000) P. 2 of 2. P9 70295

