

618-0438
316-2400L

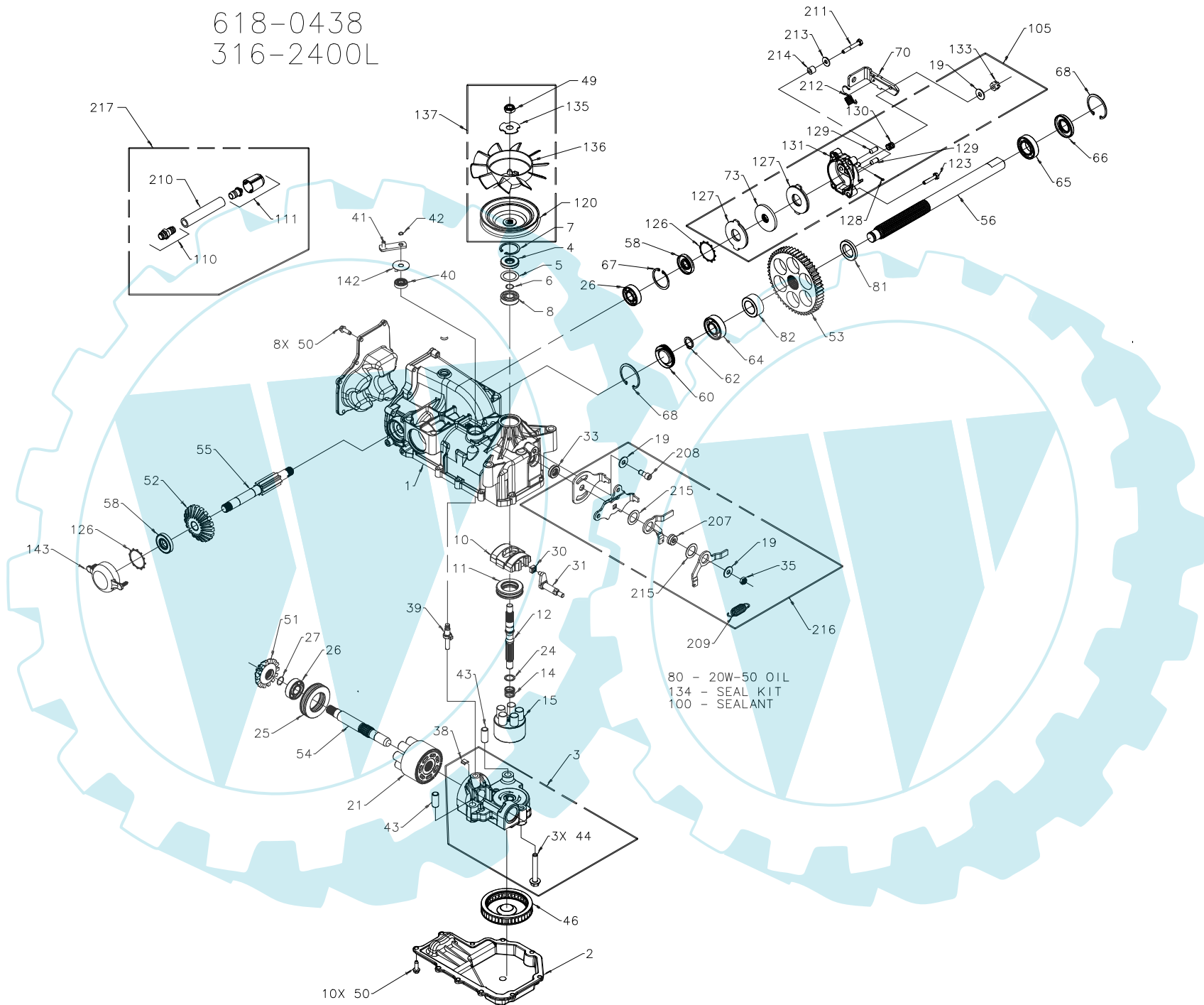

618-0438
316-2400L

ITEM NO.	HYDRO-GEAR PART NO.	QTY.	DESCRIPTION	ITEM NO.	HYDRO-GEAR PART NO.	QTY.	DESCRIPTION	ITEM NO.	HYDRO-GEAR PART NO.	QTY.	DESCRIPTION
1	70627	1	KIT, HOUSING-MAIN	52	50745	1	19T BEVEL GEAR	134	70553	1	KIT, SEAL
		1	HOUSING, MAIN	53	50746	1	53T SPUR GEAR	1		1	SEAL, LIP 15 X 35 X 7
		2	CRADLE BEARING	54	50757	1	MOTOR SHAFT	1		1	RING, RETAINING
		1	LIP SEAL	55	51335	1	BRAKE SHAFT	1		1	SEAL, LIP 12 X 25 X 7
		1	TRUNNION BUSHING	56	51388	1	SHAFT, AXLE 25mm X 14 (D.D)	1		1	SEAL, LIP 10 X 25 X 7
2	50890RM	1	LOWER HOUSING	58	51161	2	SEAL, LIP 17 X 40 X 7	1		1	RING, RETAINING
3	70667	1	KIT, CENTER SECTION	60	50995	1	SEAL PLUG - SIDE	2		2	SEAL, LIP 17 X 40 X 7
		1	CENTER SECTION	62	50759	1	RETAINING RING - AXLE	1		1	SEAL, LIP 1.85 X .32
		1	BUSHING .67 X 1.03 X .75	64	50743	1	BEARING-BALL 20X47X14(6204)	1		1	RING, RETAINING
		1	PLATE, BYPASS	65	50740	1	BEARING-BALL 25X47X12(6005)	1		1	RING, RETAINING .440 EXTERNAL
		3	SCREW 3/8-24 X 2.5	66	50751	1	SEAL	1		1	SEAL, LIP .98 X 1.85 X .276
		3	CHECK PLUG ASSEMBLY, .027	67	50329	1	RETAINING RING	1		1	RING, RETAINING
4	9008000-0128	1	LIP SEAL	68	50760	2	RETAINING RING-AXLE	2		2	RING, RETAINING
5	2003018	1	SPACER	70	51395	1	ARM, BRAKE	2		2	RING, RETAINING
6	2003016	1	WIRE RETAINING RING	73	44855	1	ROTOR, BRAKE	2		2	SEAL, LIP 17 X 40 X 5
7	2003052	1	RETAINING RING	80		79oz	20W-50 OIL	135	51523	1	WASHER, OD SLOTTED, .53 X 1.63 X .06
8	2003043	1	BALL BEARING	81	51939	1	WASHER, AXLE 1.04 X 1.65 X .22	136	51364	1	FAN, 6", 10 BLADE
10	2003087	1	VARIABLE SWASHPLATE	82	51940	1	WASHER, AXLE 1.04 X 1.65 X .70	137	70600	1	KIT, FAN-PULLEY
11	50551	1	THRUST BEARING 30 X 52 X 13							1	WASHER, OD SLOTTED, .53 X 1.63 X .06
12	50005	1	INPUT SHAFT	100	50928	1	SEALANT			1	FAN, 6", 10 BLADE
13	50891RM	1	COVER-BACK	105	70561	1	KIT, BRAKE			1	HEX LOCK NUT 1/2-20 (NYLON INSERT)
14	2003014	1	SPRING, BLOCK				WASHER			1	PULLEY, 4.5
15	70331	1	10cc CYLINDER BLOCK ASS'Y				ROTOR, BRAKE	142	51813	1	WASHER, 0.39 X 1.27 X .05
		1	10cc CYLINDER BLOCK				STATOR, BRAKE FRICTION	143	51774	1	BRAKE COVER, PLASTIC
		5	10cc PISTON SPRING				COTTER PIN 3/32 X 3/4	207	51604	1	SPACER, RTN
		5	PISTON SEAT WASHER				BRAKE ACTUATING PIN	208	51400	1	SCREW, 5/16-24 X .75 (PATCH)
		5	10cc PISTON				COMPRESSION SPRING ANTI DRAG	209	52401	1	SPRING, EXTENSION
19	44130	3	WASHER				KIT, YOKE-BRAKE	210	51401	1	HOSE, .5 X 4.00
21	70082	1	21cc CYLINDER BLOCK ASS'Y	110	70110	1	FITTING O-RING ASSEMBLY	211	51402	1	SCREW, HEX HEAD 1/4-28 X 1.75 W/PATCH
		1	21cc CYLINDER BLOCK				PLASTIC HOSE FITTING	212	50884	1	SPRING, BRAKE ARM BIAS
		7	21cc PISTON SPRING				O-RING	213	51403	1	WASHER, FLAT .28 X .73 X .063
		7	PISTON SEAT WASHER				CAP VENT ASSEMBLY	214	23770	1	BRAKE ASS'Y SPACER
		7	21cc PISTON	111	70921	1	CAP, PLASTIC	215	51408	2	WASHER, NYLON
24	2003017	1	WASHER, BLOCK THRUST				VENT, PLASTIC	216	70609	1	RTN, KIT
25	50552	1	THRUST BEARING 42 X 68 X 16	120	51363	1	PULLEY, 4.5			2	WASHER
26	50315	2	BALL BEARING	123	51341	2	SCREW, 1/4-28 X 1.25 W/PATCH			1	HEX LOCK NUT, 5/16-24 UNJF (NYLON INSERT)
27	2000022	1	WIRE RETAINING RING	126	51316	2	RING, RETAINING			1	SPACER, RTN
30	2000015	1	SLOT GUIDE	127	51340	2	STATOR, BRAKE FRICTION			1	SCREW, 5/16-24 X .75 (PATCH)
31	50807	1	TRUNNION ARM	128	44101	1	COTTER PIN 3/32 X 3/4			1	SPRING, EXTENSION
33	9008000-0126	1	LIP SEAL	129	44127	2	BRAKE ACTUATING PIN			2	WASHER, NYLON
34	51394	1	CONTROL ARM	130	50919	1	COMPRESSION SPRING BRAKE ANTI DRAG			1	CONTROL ARM
35	50108	1	HEX LOCK NUT, 5/16-24 UNJF (NYLON INSERT)	131	70560	1	KIT, YOKE-BRAKE			1	ARM, RTN SCISSOR, OUTER
38	70680	1	KIT, BYPASS PLATE				SQ HD BOLT 5/16-24 RIBBED			1	ARM, RTN SCISSOR, INNER
39	2003555	1	BYPASS ACTUATOR				YOKE, BRAKE			1	ARM, RETURN
40	45074	1	LIP SEAL	133	44142	1	SLOTTED HEX NUT 5/16-24	217	71004	1	KIT, BREATHER ASSEMBLY
41	50270	1	BYPASS ARM							1	CAP, VENT ASSEMBLY
42	44870	1	RETAINING RING							1	FITTING, O-RING ASSEMBLY
43	50002	2	PIN							1	HOSE, .5 X 4.00
44	50016	3	SCREW								
46	50990	1	FILTER								
49	51244	1	HEX LOCK NUT 1/2-20 (NYLON INSERT)								
50	50752	18	SCREW, 1/4-20 X .75 LONG								
51	50744	1	14T BEVEL GEAR								