

618-04329
345-3000

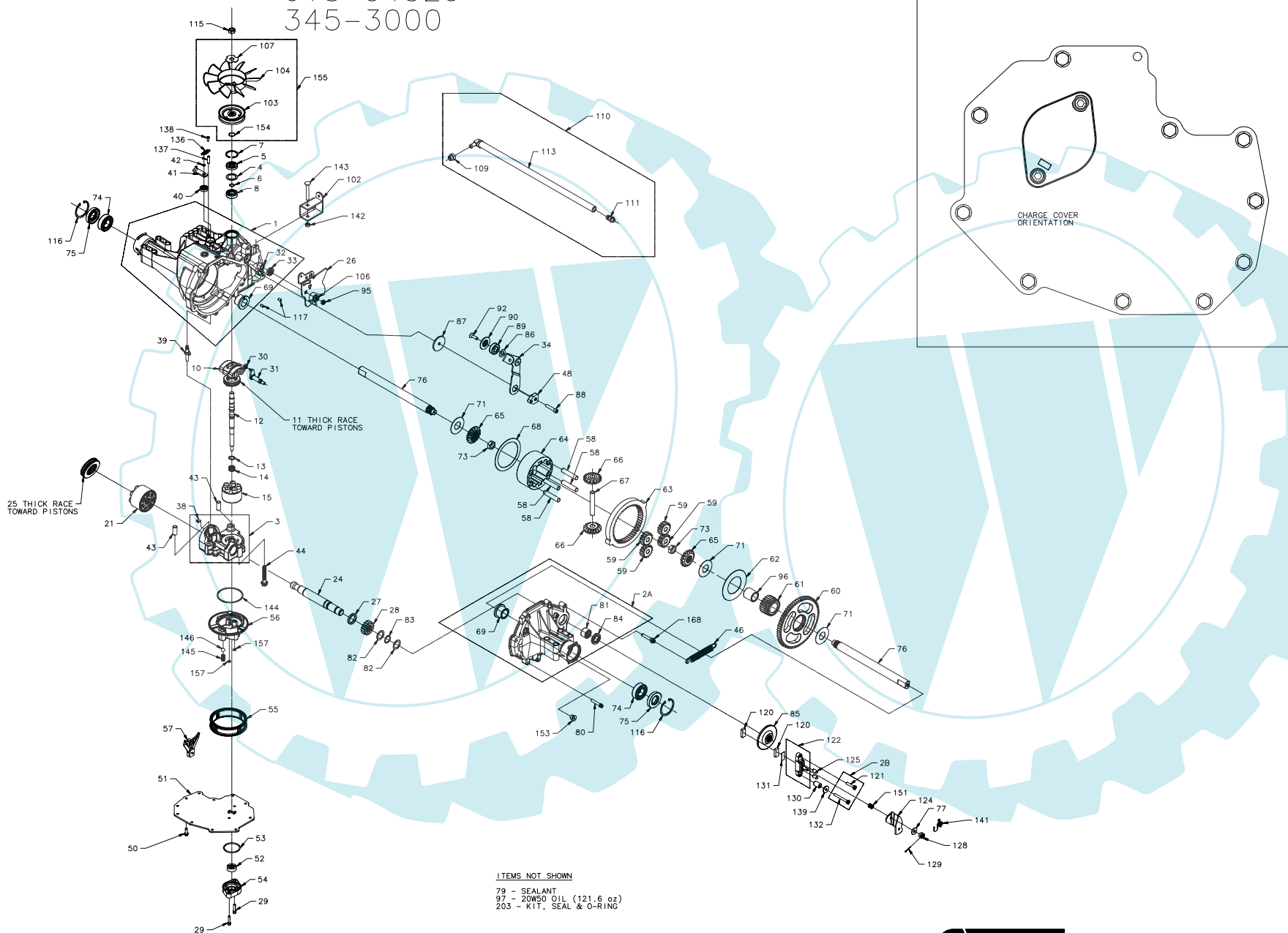

ITEMS NOT SHOWN
79 - SEALANT
97 - 20W50 OIL (121.6 oz)
203 - KIT, SEAL & O-RING

Ⓢ SEE THE INSTRUCTIONS
FOR THE
REPAIR KIT
FOR THE
REPAIR KIT
FOR THE
REPAIR KIT

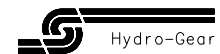

618-04329
345-3000

ITEM#	PART #	QTY	DESCRIPTION	ITEM#	PART #	QTY	DESCRIPTION	ITEM#	PART #	QTY	DESCRIPTION
1	70297	1	ASSEMBLY, MAIN HOUSING	46	51153	1	SPRING, 5 IN RETURN (MEDIUM)	113	70301	1	KIT, 90° FITTING & HOSE ASS'Y
		1	HOUSING, MAIN	48	51097	1	PUCK, ADJUSTING			1	FITTING, 90° METAL VENT
		1	SEAL, LIP 12 X 25 X 7	50	50752	11	SCREW, HEX FLANGE 1/4-20 X .75			1	CLAMP, PINCH
		1	BEARING, FLANGE 1.0 X 1.376 X .99	51	50972	1	COVER, LOWER W/ 2 KIDNEYS			1	HOSE, 0.5 X 20
		1	BEARING, TRUNNION	52	50273	1	GEROTOR	115	44133	1	NUT, HEX 1/2-20 W/ PATCH
2A	71120	2	BEARING, CRADLE	53	9004101-1340	1	O-RING, 1.862 X 2.068	116	50859	2	RING, RETAINING
		1	ASSEMBLY, RIGHT HAND HOUSING	54	50260	1	HOUSING, CHARGE PUMP	117	9004800-2506	2	PIN, STANDARD HEADLESS
		1	HOUSING, RIGHT HAND	55	70538	1	KIT, FILTER	120	44132	2	PUCK, BRAKE
		1	BEARING, FLANGE 1.0 X 1.376 X .99			2	GASKET, 4.24 X 4.40 X .10	121	51927	1	BOLT, HEX HD 1/4-20 X 1.25 W/PATCH
		1	NEEDLE BEARING .875 X 1.125 X 1.5			1	FILTER, STD CHARGE	122	70633	1	ASSEMBLY, BRAKE YOKE
		1	SEAL, LIP .875 X 1.375 X .250	56	51156	1	MANIFOLD, CHARGE	124	50936	1	ARM, BRAKE
2B	71139	1	KIT, BRAKE BOLT	57	50796	1	RETAINER, MOTOR BEARING	125	44127	2	PIN, BRAKE ACTUATING
		1	BOLT, HEX HD 1/4-20 X 1.25 W/PATCH	58	50776	4	PIN, CARRIER	128	44142	1	NUT, CASTLE 5/16-24
		1	BOLT, HEX HD 1/4-20 X 2.25 W/PATCH	59	50763	4	GEAR, 15T PLANET	129	44101	1	PIN, COTTER 3/32 X 3/4
3	70683	1	ASSEMBLY, CENTER SECTION	60	50646	1	GEAR, 67T SPUR	130	23711	1	SPACER, .26 X .57 X .87
		1	CENTER SECTION	61	50645	1	GEAR, 21T SUN	131	44134	1	PLATE, PUCK
		1	BEARING, JOURNAL .50 X .59 X .50	62	50769	1	WASHER, THRUST 2.32 X 4.10 X .05	132	51928	1	BOLT, HEX HD 1/4-20 X 2.25 W/PATCH
		1	BEARING, .90 X 1.0 X .75	63	50764	1	GEAR, 51T RING	136	50384	1	SPRING, BYPASS 1.33 IN EXTENSION
		1	PLATE, BYPASS	64	50765	1	CARRIER, PLANETARY	137	50882	1	PIN, SPRING .26 X 1
		2	CHECK PLUG ASSEMBLY, .027 BLEED	65	50647	2	GEAR, 14T MITER (SPLINED)	138	50653	1	BOLT, SELF TAPPING 10-32 X .5
4	2003018	1	SPACER, .98 X 1.37 X .04	66	50648	2	GEAR, 14T MITER (UNSPLINED)	139	44278	1	WASHER, .27 X .88 X .12
5	9008000-0128	1	SEAL, LIP 15 X 35 X 7	67	50766	1	SHAFT, DIFFERENTIAL	141	50884	1	SPRING, BRAKE ARM BIAS
6	2003016	1	RING, RETAINING	68	50767	1	WASHER, THRUST 3.46 X 4.39 X .05	142	43064	1	NUT, HEX LOCK 5/16-18
7	2003052	1	RING, RETAINING	69	50768	2	BEARING, FLANGE 1.0 X 1.376 X .99	143	50886	1	BOLT, 5/16-18 X 2.5
8	2003043	1	BEARING, BALL .59 X 1.38 X .43	71	50788	3	WASHER 1.0 X 2.25 X .04	144	50974	1	O-RING, 2.987 X 3.09
10	2003087	1	SWASHPLATE, VARIABLE	73	50791	2	NUT, HEX 5/8-18 W/ PATCH	145	51157	1	SPRING, RELIEF
11	50551	1	BEARING, THRUST 30 X 52 X 13	74	50771	2	BEARING, BALL 25.4 X 52 X 15	146	9001214-4400	1	BALL, 7/16 IN
12	50795	1	SHAFT, INPUT (STD CHARGE)	75	50772	2	SEAL, LIP 1.0 X 2.049 X .375	151	50919	1	SPRING, COMP. BRAKE ANTI-DRAG
13	2003017	1	WASHER, THRUST .59 X .79 X .04	76	52339	2	SHAFT, AXLE 1 X 12.69 (DD)	153	9005110-5600	1	PLUG, 9/16-18 (METAL)
14	2003014	1	SPRING, BLOCK	77	44130	1	WASHER .34 X .88 X .06	154	50920	1	RING, RETAINING
15	70331	1	ASSEMBLY, BLOCK	79	50928	10.1oz	SEALANT	155	70311	1	KIT, FAN/PULLEY
		1	BLOCK, CYLINDER	80	50868	8	SCREW, TORX HD 5/16-18 X 1.5			1	NUT, HEX 1/2-20 W/ PATCH
		5	PISTON	81	44752	1	BEARING, NEEDLE .875 X 1.125 X 1.5			1	WASHER, O.D SLOTTED .53 X 1.63 X .06
		5	SPRING, COMPRESSION	82	50777	2	WASHER, FLAT .88 X 1.25 X .04			1	FAN 7.0 IN (10 BLADE)
		5	WASHER, THRUST	83	50775	1	RING, RETAINING			1	PULLEY, 3.6 IN
21	70082	1	ASSEMBLY, BLOCK	84	50773	1	SEAL, LIP .875 X 1.375 X .250			1	RING, RETAINING
		1	BLOCK, CYLINDER	85	50779	1	DISK, BRAKE	157	50977	2	O-RING, .239 X .379
		7	PISTON	86	50132	1	WASHER, .51 X 1.0 X .03	168	51151	1	SCREW, TORX HD SHOULDERED 5/16-18 X 1.81
		7	SPRING, COMPRESSION	87	50836	1	SPACER, .32 X 1.96 X .15	203	70492	1	KIT, SEAL & O-RING
		7	WASHER, THRUST	88	50837	1	SCREW, SOCKET HD CAP 5/16-24 X 1.5			1	SEAL, LIP 15 X 35 X 7
24	50662	1	SHAFT, MOTOR	89	44147	1	BEARING, BALL .62 X 1.38 X .44			1	SEAL, LIP 12 X 25 X 7
25	50552	1	BEARING, THRUST 42 X 68 X 16	90	51200	1	SPACER, LOCATING			1	SEAL, LIP 10 X 25 X 7
26	51125	1	ARM, CONTROL	92	50870	1	SCREW, COUNTERSUNK 5/16-18 X 1.0			1	O-RING, 1.862 X 2.068
27	50774	1	SPACER, 1.03 X 1.38 X .184	95	50108	1	NUT, HEX LOCK 5/16-24			2	SEAL, LIP 1.0 X 2.049 X .375
28	50661	1	GEAR, 16T PINION	96	50866	1	BUSHING, SLEEVE 1.0 X 1.3 X 1.34			1	SEAL, LIP .875 X 1.375 X .250
29	50975	2	SCREW, CAP M6 X 1 X 25	97		121.6oz	OIL, 20W50			1	PIN, SPRING .26 X 1
30	2000015	1	GUIDE, SLOT	102	50813	1	BRACKET, TORQUE			1	KIT, MANIFOLD O-RING
31	50807	1	ARM, TRUNNION TAPERED SQUARE	103	50818	1	PULLEY, 3.6 IN			2	O-RING, .239 X .379
32	2003009	1	BEARING, TRUNNION	104	51862	1	FAN, 7.0 IN (10 BLADE)				
33	9008000-0126	1	SEAL, LIP 12 X 25 X 7	106	51604	1	SPACER, TRUNNION				
34	51127	1	ARM, RETURN	107	51523	1	WASHER, OD SLOTTED 53 X 1.63 X .06				
38	70680	1	KIT, BYPASS PLATE	109	50133	1	BUSHING, VENT (RUBBER)				
39	2003555	1	ACTUATOR, BYPASS	110	70302	1	KIT, FITTING				
40	45074	1	SEAL, LIP 10 X 25 X 7			1	BUSHING, VENT (RUBBER)				
41	50270	1	ARM, BYPASS			1	ASSEMBLY, CAP-VENT				
42	44870	1	RING, RETAINING			1	KIT, 90° FITTING & HOSE ASS'Y				
43	50002	2	PIN, HOLLOW .39 X .50 X 1.12	111	70109	1	ASSEMBLY, CAP-VENT				
44	50016	3	SCREW, HEX FLANGE 3/8-24 X 2.5			1	CAP, VENT				
						1	VENT, PLASTIC				

