

3601  
330-2400L

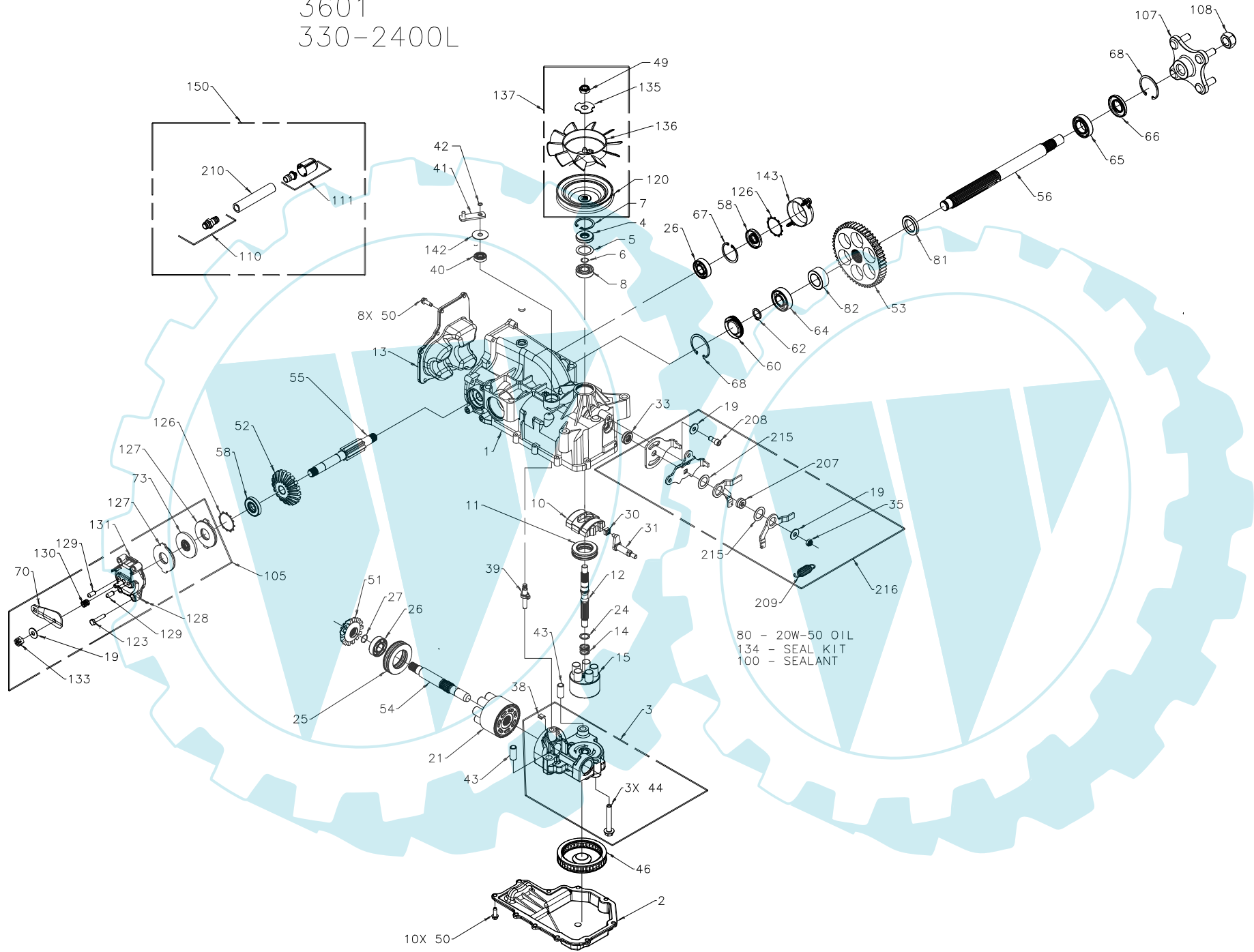

80 - 20W-50 OIL  
134 - SEAL KIT  
100 - SEALANT

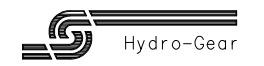

3601  
330-2400L

ITEM NO.	HYDRO-GEAR PART NO.	QTY.	DESCRIPTION	ITEM NO.	HYDRO-GEAR PART NO.	QTY.	DESCRIPTION	ITEM NO.	HYDRO-GEAR PART NO.	QTY.	DESCRIPTION
1	70627	1	KIT, HOUSING-MAIN	50	50752	18	SCREW, 1/4-20 X .75 LONG	131	70560	1	KIT, YOKE-BRAKE
		1	HOUSING, MAIN	51	50744	1	14T BEVEL GEAR			1	SQUARE HEAD BOLT, 5/16-24 RIBBED
		2	CRADLE BEARING	52	50745	1	19T BEVEL GEAR			1	YOKE, BRAKE
		1	LIP SEAL	53	50746	1	53T SPUR GEAR	133	44142	1	SLOTTED HEX NUT 5/16-24
		1	TRUNNION BUSHING	54	50757	1	MOTOR SHAFT	134	70553	1	KIT, SEAL
2	50890RM	1	LOWER HOUSING	55	51335	1	BRAKE SHAFT			1	SEAL, LIP 15 X 35 X 7
3	70679	1	KIT, CENTER SECTION	56	50748	1	SHAFT, AXLE 1.0 X 12.3			1	RING, RETAINING
		1	CENTER SECTION	58	51161	2	SEAL, LIP 17 X 40 X 7			1	SEAL, LIP 12 X 25 X 7
		1	BUSHING .67 X 1.03 X .75	60	50995	1	SEAL PLUG - SIDE			1	SEAL, LIP 10 X 25 X 7
		1	PLATE, BYPASS	62	50759	1	RETAINING RING - AXLE			1	RING, RETAINING
		3	SCREW 3/8-24 X 2.5	64	50743	1	BEARING-BALL 20X47X14(6204)			2	SEAL, LIP 17 X 40 X 7
		2	CHECK PLUG ASSEMBLY, .044	65	50740	1	BEARING-BALL 25X47X12(6005)			1	SEAL, LIP 1.85 X .32
4	9008000-0128	1	LIP SEAL	66	50751	1	SEAL			1	RING, RETAINING
5	2003018	1	SPACER	67	50329	1	RETAINING RING			1	RING, RETAINING .440 EXTERNAL
6	2003016	1	WIRE RETAINING RING	68	50760	2	RETAINING RING-AXLE			1	SEAL, LIP .98 X 1.85 X .276
7	2003052	1	RETAINING RING	70	51349	1	ARM, BRAKE			1	RING, RETAINING
8	2003043	1	BALL BEARING	73	44855	1	ROTOR, BRAKE			2	RING, RETAINING
10	2003087	1	VARIABLE SWASHPLATE	80		79oz	20W-50 OIL			2	RING, RETAINING
11	50551	1	THRUST BEARING 30 X 52 X 13	81	51939	1	SPACER, AXLE 1.04 X 1.65 X .22			2	SEAL, LIP 17 X 40 X 5
12	50005	1	INPUT SHAFT	82	51940	1	SPACER, AXLE 1.04 X 1.65 X .70	135	51523	1	WASHER, OD SLOTTED, .53 X 1.63 X .06
13	50891RM	1	COVER-BACK	100	50928	1	SEALANT	136	51364	1	FAN, 6", 10 BLADE
14	2003014	1	SPRING, BLOCK	105	70561	1	KIT, BRAKE	137	70600	1	KIT, FAN-PULLEY
15	70331	1	10cc CYLINDER BLOCK ASS'Y			1	WASHER			1	WASHER, OD SLOTTED, .53 X 1.63 X .06
		1	10cc CYLINDER BLOCK			1	ARM, BRAKE			1	FAN, 6", 10 BLADE
		5	10cc PISTON SPRING			1	ROTOR, BRAKE			1	HEX LOCK NUT 1/2-20 (NYLON INSERT)
		5	PISTON SEAT WASHER			3	SCREW, 1/4-28 X 1.25 W/PATCH	142	51813	1	PULLEY, 4.5
		5	10cc PISTON			2	STATOR, BRAKE FRICTION	143	51774	1	WASHER, .39 X 1.27 X .05
19	44130	3	WASHER			1	COTTER PIN 3/32 X 3/4	150	71004	1	CAP, BRAKE
21	70082	1	21cc CYLINDER BLOCK ASS'Y			2	BRAKE ACTUATING PIN			1	KIT, BREATHER
		1	21cc CYLINDER BLOCK			1	COMPRESSION SPRING ANTI DRAG			1	VENT, PLASTIC
		7	21cc PISTON SPRING			1	KIT, YOKE-BRAKE			1	FITTING, PLASTIC HOSE
		7	PISTON SEAT WASHER			1	SLOTTED HEX NUT 5/16-24			1	HOSE, .5 X 4.00
		7	21cc PISTON	107	70314	1	HUB ASSEMBLY			1	O-RING
24	2003017	1	WASHER, BLOCK THRUST			1	HUB			1	CAP, PLASTIC
25	50552	1	THRUST BEARING 42 X 68 X 16			4	BOLT, LUG	207	51604	1	SPACER, RTN
26	50315	2	BALL BEARING	108	50863	1	NUT, HEX 3/4-16	208	51400	1	SCREW, 5/16-24 X .75 (PATCH)
27	2000022	1	WIRE RETAINING RING	110	70110	1	FITTING, O-RING ASSEMBLY	209	52401	1	SPRING, EXTENSION
30	2000015	1	SLOT GUIDE			1	O-RING	210	51401	1	HOSE, .5 X 4.00
31	50807	1	TRUNNION ARM			1	FITTING, PLASTIC HOSE	215	51408	2	WASHER, NYLON
33	9008000-0126	1	LIP SEAL	111	70921	1	VENT CAP ASSEMBLY	216	70609	1	RTN, KIT
35	50108	1	HEX LOCK NUT, 5/16-24 UNJF (NYLON INSERT)			1	CAP, PLASTIC			2	WASHER
38	70680	1	KIT, BYPASS PLATE			1	VENT, PLASTIC			1	HEX LOCK NUT, 5/16-24 UNJF (NYLON INSERT)
39	2003555	1	BYPASS ACTUATOR	120	51363	1	PULLEY, 4.5			1	SPACER, RTN
40	45074	1	LIP SEAL	123	51341	3	SCREW, 1/4-28 X 1.25 W/PATCH			1	SCREW, 5/16-24 X .75 (PATCH)
41	50270	1	BYPASS ARM	126	51316	2	RING, RETAINING			1	SPRING, EXTENSION
42	44870	1	RETAINING RING	127	51340	2	STATOR, BRAKE FRICTION			2	WASHER, NYLON
43	50002	2	PIN	128	44101	1	COTTER PIN 3/32 X 3/4			1	CONTROL ARM
44	50016	3	SCREW	129	44127	2	BRAKE ACTUATING PIN			1	ARM, RTN SCISSOR, OUTER
46	50990	1	FILTER	130	50919	1	COMPRESSION SPRING BRAKE ANTI DRAG			1	ARM, RTN SCISSOR, INNER
49	51244	1	HEX LOCK NUT 1/2-20 (NYLON INSERT)							1	ARM, RETURN