

3600CB  
347-2400R

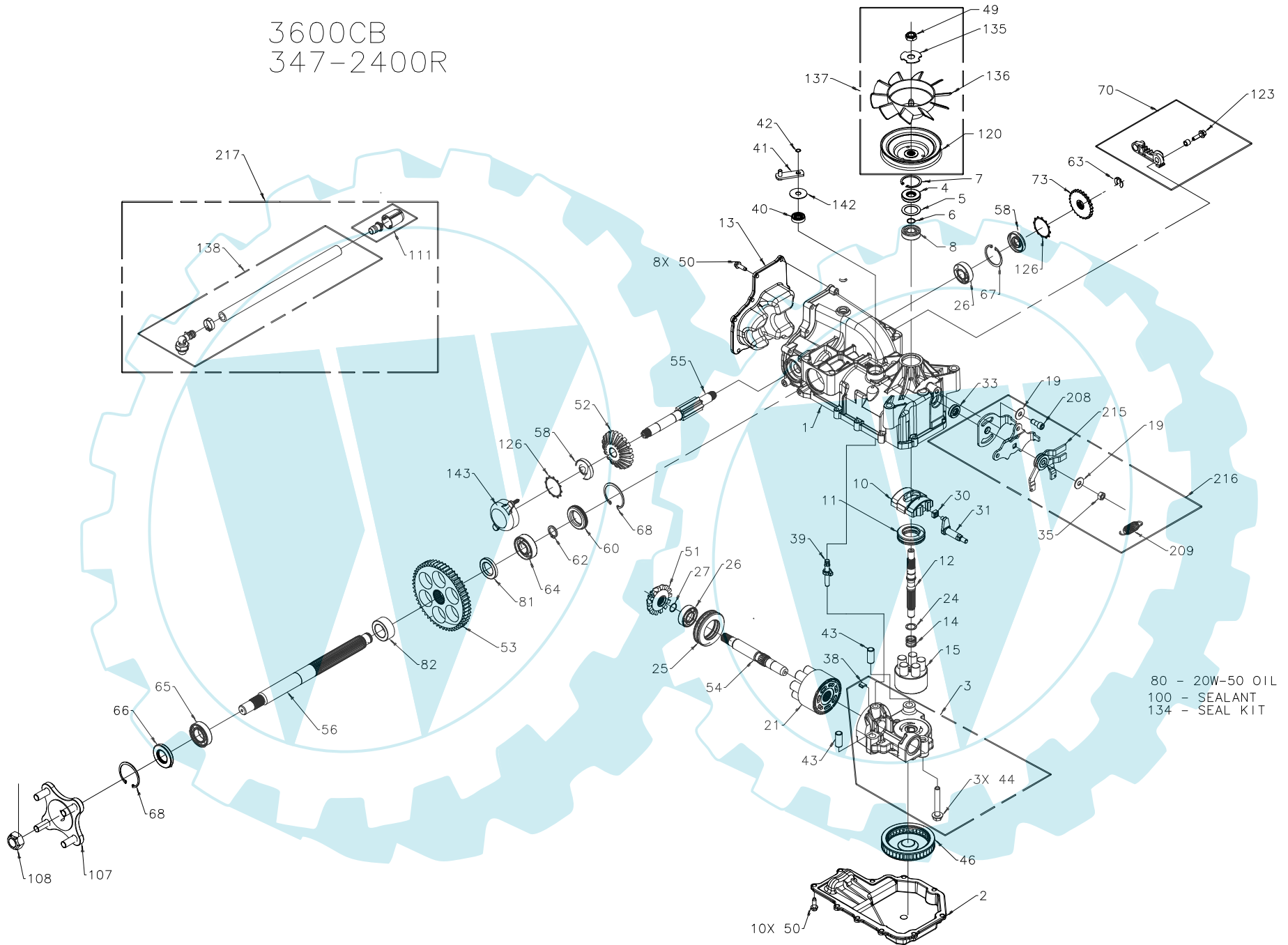

80 - 20W-50 OIL  
100 - SEALANT  
134 - SEAL KIT

3600CB  
347-2400R

ITEM NO.	HYDRO-GEAR PART NO.	QTY.	DESCRIPTION	ITEM NO.	HYDRO-GEAR PART NO.	QTY.	DESCRIPTION	ITEM NO.	HYDRO-GEAR PART NO.
1	70627	1	KIT, HOUSING-MAIN	50	50752	18	SCREW, 1/4-20 X .75 LONG	135	51523
		1	HOUSING, MAIN	51	50744	1	14T BEVEL GEAR	136	51364
		2	CRADLE BEARING	52	50745	1	19T BEVEL GEAR	137	70600
		1	LIP SEAL	53	50746	1	53T SPUR GEAR		
		1	TRUNNION BUSHING	54	50757	1	MOTOR SHAFT		
2	5089ORM	1	LOWER HOUSING	55	51298	1	BRAKE SHAFT		
3	70679	1	KIT, CENTER SECTION	56	50748	1	SHAFT, AXLE 1.0 x 12.3	138	70923
		1	CENTER SECTION	58	51161	2			
		1	BUSHING .67 X 1.03 X .75	60	50995	1	SEAL PLUG - SIDE		
		1	PLATE, BYPASS	62	50759	1	RETAINING RING - AXLE		
		3	SCREW, 3/8-24 X 2.5	63	51109	1	RETAINING RING		
		2	CHECK PLUG ASSEMBLY, .044	64	50743	1	BEARING-BALL 20X47X14(6204)	142	51813
4	9008000-0128	1	LIP SEAL	65	50740	1	BEARING-BALL 25X47X12(6005)	143	51774
5	2003018	1	SPACER	66	50751	1	SEAL	208	51400
6	2003016	1	WIRE RETAINING RING	67	50329	1	RETAINING RING	209	52401
7	2003052	1	RETAINING RING	68	50760	2	RETAINING RING-AXLE	210	50632
8	2003043	1	BALL BEARING	70	70392	1	RH BRAKE ARM SERVICE ASSEMBLY	215	52411
10	2003087	1	VARIABLE SWASHPLATE			1	BRAKE ARM	216	70609
11	50551	1	THRUST BEARING 30 X 52 X 13			1	CLEVIS PIN		
12	50005	1	INPUT SHAFT			1	BUSHING .255 X .381 X .330		
13	50891RM	1	COVER-BACK			1	HEX WASHER HEAD SCREW, 1/4-20 X 7/8		
14	2003014	1	SPRING, BLOCK	73	50754	1	BRAKE, COG		
15	70331	1	10cc CYLINDER BLOCK ASS'Y	80		79oz	20W-50 OIL		
		1	10cc CYLINDER BLOCK	81	51939	1	WASHER, AXLE 1.04 X 1.65 X .22		
		5	10cc PISTON SPRING	82	51940	1	WASHER, AXLE 1.04 X 1.65 X .70		
		5	PISTON SEAT WASHER	100	50928	1	SEALANT	217	70922
		5	10cc PISTON	107	70314	1	HUB ASSEMBLY		
19	44130	2	WASHER			1	HUB		
21	70082	1	21cc CYLINDER BLOCK ASS'Y			4	BOLT, LUG		
		1	21cc CYLINDER BLOCK	108	50863	1	NUT, HEX 3/4-16		
		7	21cc PISTON SPRING	111	70921	1	CAP VENT ASSEMBLY		
		7	PISTON SEAT WASHER			1	CAP, PLASTIC		
		7	21cc PISTON			1	VENT, PLASTIC		
24	2003017	1	WASHER, BLOCK THRUST	120	51363	1	PULLEY, 4.5		
25	50552	1	THRUST BEARING 42 X 68 X 16	123	51076	1	SCREW, HFHC 1/4-28 X 7/8 (PATCH)		
26	50315	2	BALL BEARING	126	51316	2	RING, RETAINING		
27	2000022	1	WIRE RETAINING RING	134	70553	1	KIT, SEAL		
30	2000015	1	SLOT GUIDE			1	SEAL, LIP 15 X 35 X 7		
31	50807	1	TRUNNION ARM			1	RING, RETAINING		
33	9008000-0126	1	LIP SEAL			1	SEAL, LIP 12 X 25 X 7		
35	52506	1	NUT, LOCK, 5/16-24 UNF			1	SEAL, LIP 10 X 25 X 7		
38	70680	1	KIT, BYPASS PLATE			1	RING, RETAINING		
39	2003555	1	BYPASS ACTUATOR			2	SEAL, LIP 17 X 40 X 7		
40	45074	1	LIP SEAL			1	SEAL, LIP 1.85 X .32		
41	50270	1	BYPASS ARM			1	RING, RETAINING		
42	44870	1	RETAINING RING			1	RING, RETAINING .440 EXTERNAL		
43	50002	2	PIN			1	SEAL, LIP .98 X 1.85 X .276		
44	50016	3	SCREW			1	RING, RETAINING		
46	50990	1	FILTER			2	RING, RETAINING		
49	51244	1	HEX LOCK NUT 1/2-20 (NYLON INSERT)			2	RING, RETAINING		
						2	SEAL, LIP 17 X 40 X 5		

P5

ADDED NEW FRAME  
REV'D ITEM 35, P/N 50108  
TO P/N 52506  
REMOVED ITEM 204, P/N 51393,  
QTY 1, DESC ARM, RTN SCISSOR, OUTER  
REMOVED ITEM 205, P/N 51392,  
QTY 1, DESC ARM, RTN SCISSOR, INNER  
REMOVED ITEM 207, P/N 51604,  
QTY 1, DESC SPACER, RTN  
REV'D ITEM 215, P/N 51408,  
QTY 2, DESC WASHER, RTN TO  
P/N 52411, QTY 1, DESC ASSEMBLY, RTN  
ECN #19694  
09/28/06 R.GAGNON