

349-2400L

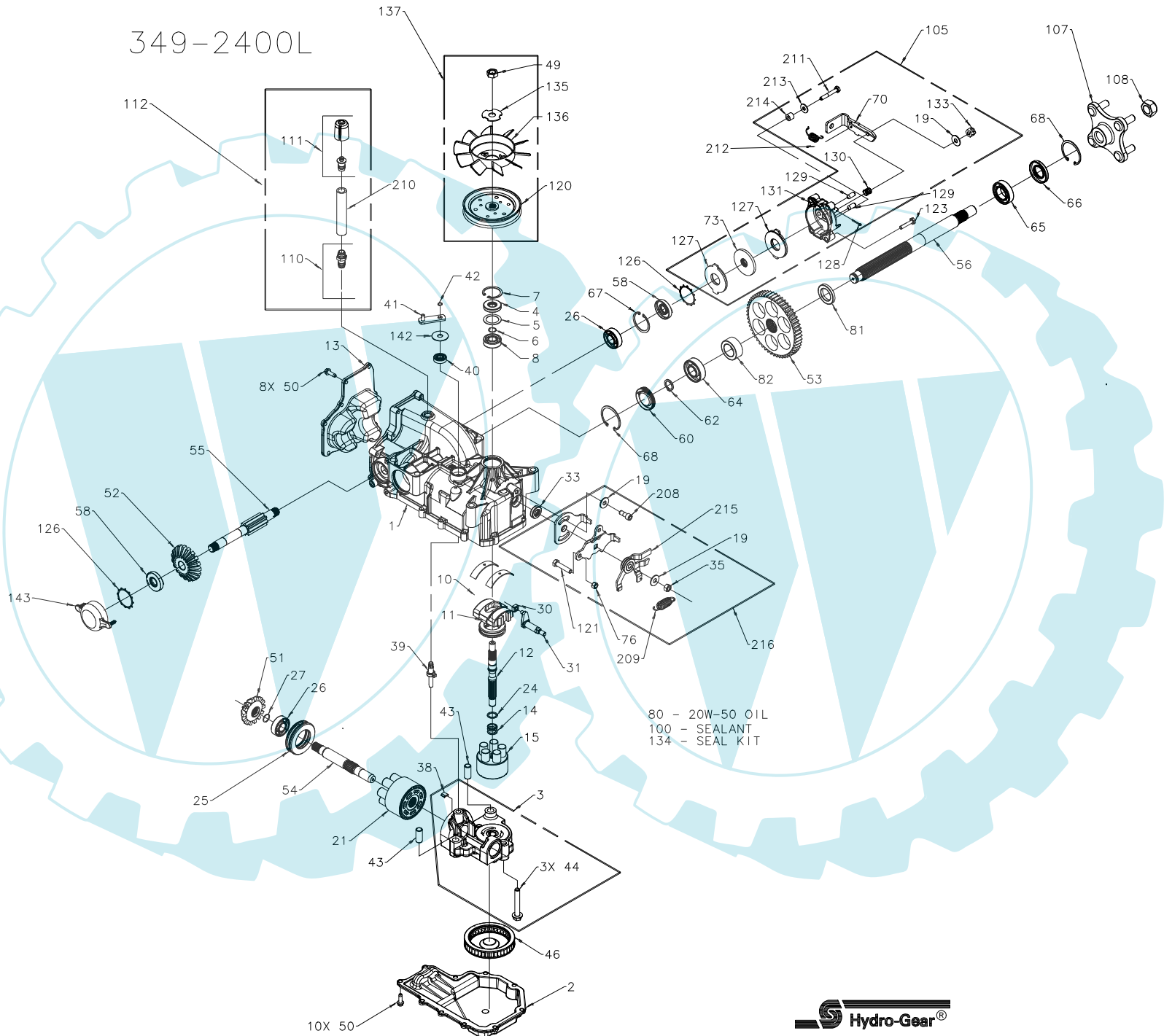

349-2400L

ITEM NO.	HYDRO-GEAR PART NO.	QTY.	DESCRIPTION	ITEM NO.	HYDRO-GEAR PART NO.	QTY.	DESCRIPTION	ITEM NO.	HYDRO-GEAR PART NO.	QTY.	DESCRIPTION
1	70627	1	KIT, HOUSING-MAIN	52	50745	1	19T BEVEL GEAR	130	50919	1	COMPRESSION SPRING BRAKE ANTI DRAG
		1	HOUSING, MAIN	53	50746	1	53T SPUR GEAR	131	70560	1	KIT, YOKE-BRAKE
		2	CRADLE BEARING	54	50757	1	MOTOR SHAFT			1	SQ HD BOLT 5/16-24 RIBBED
		1	LIP SEAL	55	51335	1	BRAKE SHAFT			1	YOKE, BRAKE
		1	TRUNNION BUSHING	56	50748	1	SHAFT, AXLE 1.00 X 11.04 (KEY)	133	44142	1	SLOTTED HEX NUT 5/16-24
2	50890RM	1	LOWER HOUSING	58	51161	2	SEAL, LIP 70 X 40 X 7	134	70553	1	KIT, SEAL
3	70667	1	KIT, CENTER SECTION	60	50995	1	SEAL PLUG - SIDE			1	SEAL, LIP 15 X 35 X 7
		1	CENTER SECTION	62	50759	1	RETAINING RING - AXLE			1	RING, RETAINING
		1	BUSHING .67 X 1.03 X .75	64	50743	1	BEARING-BALL 20X47X14(6204)			1	SEAL, LIP 12 X 25 X 7
		1	PLATE, BYPASS	65	50740	1	BEARING-BALL 25X47X12(6005)			1	SEAL, LIP 10 X 25 X 7
		3	SCREW 3/8-24 X 2.5	66	50751	1	SEAL			1	RING, RETAINING
		2	CHECK PLUG ASSEMBLY, .027	67	50329	1	RETAINING RING			2	SEAL, LIP 17 X 40 X 7
4	9008000-0128	1	LIP SEAL	68	50760	2	RETAINING RING-AXLE			1	SEAL, LIP 1.85 X .32
5	2003018	1	SPACER	70	51395	1	ARM, BRAKE			1	RING, RETAINING
6	2003016	1	WIRE RETAINING RING	73	44855	1	ROTOR, BRAKE			1	RING, RETAINING .440 EXTERNAL
7	2003052	1	RETAINING RING	76	43083	1	NUT, HEX, 5/16-18 NC			1	SEAL, LIP .98 X 1.85 X .276
8	2003043	1	BALL BEARING	80		79oz	20W-50 OIL			1	RING, RETAINING
10	2003087	1	VARIABLE SWASHPLATE	81	51939	1	WASHER, AXLE 1.04 X 1.65 X .22			2	RING, RETAINING
11	50551	1	THRUST BEARING 30 X 52 X 13	82	51940	1	WASHER, AXLE 1.04 X 1.65 X .70			2	RING, RETAINING
12	50005	1	INPUT SHAFT	100	50928	1	SEALANT			2	RING, RETAINING
13	50891RM	1	COVER-BACK	105	70561	1	KIT, BRAKE			2	SEAL, LIP 17 X 40 X 5
14	2003014	1	SPRING, BLOCK			1	WASHER	135	51523	1	WASHER, SLOTTED
15	70331	1	10cc CYLINDER BLOCK ASS'Y			1	ROTOR, BRAKE	136	51362	1	FAN, 6", 10 BLADE
		1	10cc CYLINDER BLOCK			2	STATOR, BRAKE FRICTION	137	70418	1	KIT, FAN-PULLEY
		5	10cc PISTON SPRING			1	COTTER PIN 3/32 X 3/4			1	WASHER, SLOTTED
		5	PISTON SEAT WASHER			2	BRAKE ACTUATING PIN			1	FAN, 6", 10 BLADE
		5	10cc PISTON			1	COMPRESSION SPRING ANTI DRAG			1	HEX JAM NUT 1/4-20
19	44130	3	WASHER			1	KIT, YOKE-BRAKE			1	PULLEY, 4.5"
21	70082	1	21cc CYLINDER BLOCK ASS'Y	107	70314	1	HUB ASSEMBLY	142	51813	1	WASHER
		1	21cc CYLINDER BLOCK			1	HUB	143	51774	1	CAP, BRAKE
		7	21cc PISTON SPRING			4	BOLT, LUG	208	51400	1	SCREW, 5/16-24 X .75 (PATCH)
		7	PISTON SEAT WASHER	108	50863	1	NUT, HEX, 3/4-16	209	52401	1	SPRING, EXTENSION
		7	21cc PISTON	110	70110	1	KIT, FITTING O-RING ASSEMBLY	210	51401	1	HOSE
24	2003017	1	WASHER, BLOCK THRUST			1	PLASTIC HOSE FITTING	211	51402	1	SCREW, HEX HEAD 1/4-28 X 1.75 W/PATCH
25	50552	1	THRUST BEARING 42 X 68 X 16			1	O-RING	212	50884	1	SPRING, BRAKE ARM BIAS
26	50315	2	BALL BEARING	111	70921	1	CAP, VENT ASSEMBLY	213	51403	1	WASHER, FLAT .28 X .73 X .063
27	2000022	1	WIRE RETAINING RING			1	CAP, PLASTIC	214	23770	1	BRAKE ASS'Y SPACER
30	2000015	1	SLOT GUIDE			1	VENT, PLASTIC	215	52413	1	ASSEMBLY, RTN
31	50807	1	TRUNNION ARM	112	71004	1	KIT, BREATHER	216	70845	1	RTN, KIT
33	9008000-0126	1	LIP SEAL			1	KIT, FITTING O-RING ASSEMBLY			2	WASHER
35	52506	1	NUT, LOCK, 5/16-24 UNF			1	CAP, VENT ASSEMBLY			1	NUT, LOCK, 5/16-24 UNF
38	70680	1	KIT, BYPASS PLATE			1	HOSE			1	SCREW, 5/16-24 X .75 (PATCH)
39	2003555	1	BYPASS ACTUATOR	120	51173	1	PULLEY, 4.5"			1	SPRING, EXTENSION
40	45074	1	LIP SEAL			1	HUB, PULLEY, .60"			1	CONTROL ARM
41	50270	1	BYPASS ARM			1	DISC, PULLEY, 4.5"			1	ARM, RETURN
42	44870	1	RETAINING RING	121	51753	1	BOLT, 5/16-18			1	ASSEMBLY, RTN
43	50002	2	PIN	123	51341	2	SCREW, 1/4-28 X 1.25 W/PATCH				
44	50016	3	SCREW	126	51316	2	RING, RETAINING				
46	50990	1	FILTER	127	51340	2	STATOR, BRAKE FRICTION				
49	44133	1	HEX JAM NUT 1/2-20	128	44101	1	COTTER PIN 3/32 X 3/4				
50	50752	18	SCREW, 1/4-20 X .75 LONG	129	44127	2	BRAKE ACTUATING PIN				
51	50744	1	14T BEVEL GEAR								



01/13/06 C. GOONAN

P3

ADDED NEW FRAME

REV'D ITEM 35, P/N 50108,
TO P/N 52506

REMOVED ITEM 204, P/N 51723,
QTY 1, DESC ARM, RTN SCISSOR, OUTER

REMOVED ITEM 205, P/N 51392,
QTY 1, DESC ARM, RTN SCISSOR, INNER

REMOVED ITEM 207, P/N 51604,
QTY 1, DESC SPACER, RTN

REV'D ITEM 215, P/N 51408,
QTY 2, DESC WASHER, NYLON TO

P/N 52413, QTY 1, DESC ASSEMBLY, RTN
ECN #19696

09/29/06 R. GAGNON