

346-3000

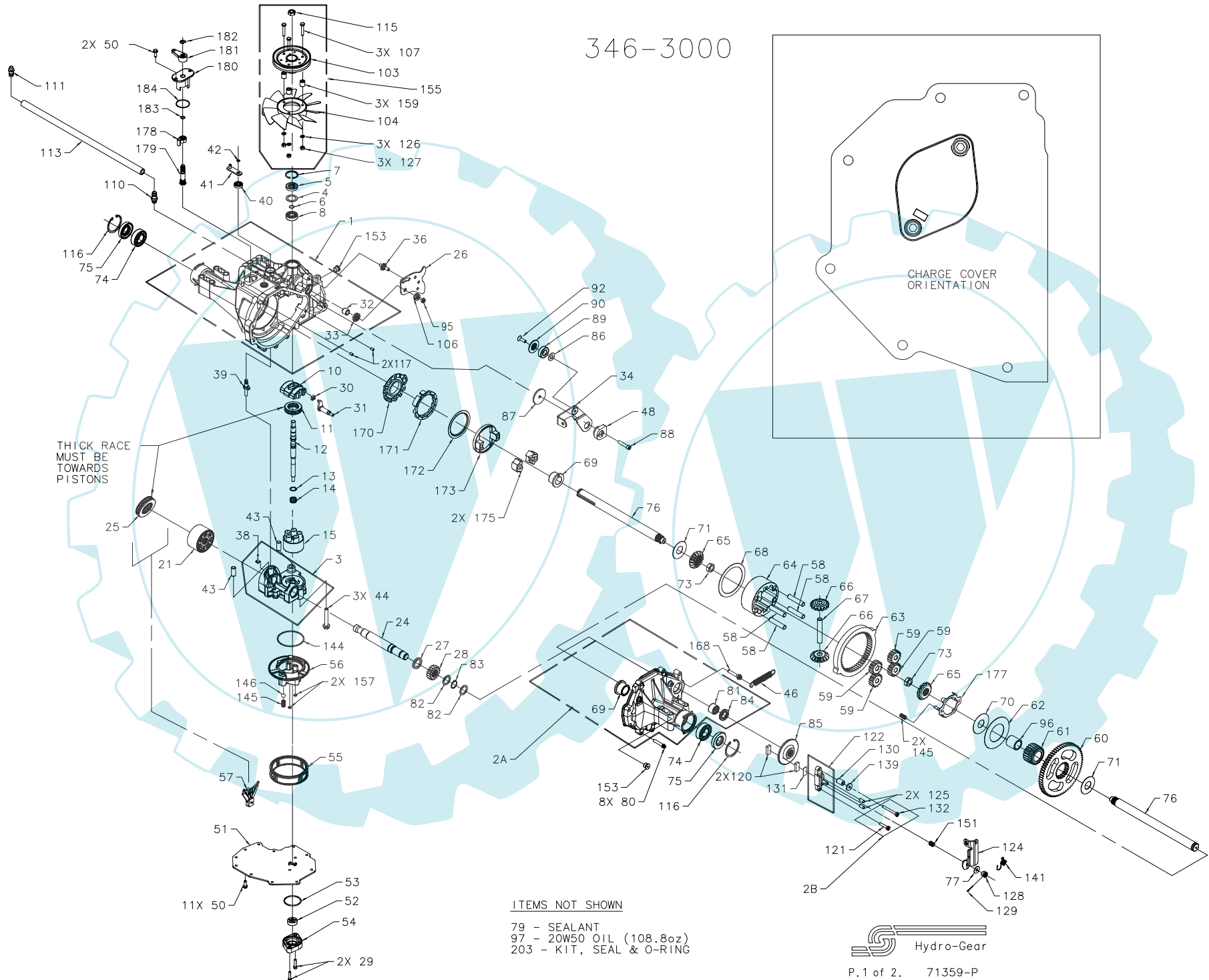

346-3000

ITEM#	PART #	QTY	DESCRIPTION	ITEM#	PART #	QTY	DESCRIPTION	ITEM#	PART #	QTY	DESCRIPTION
1	70876	1	ASSEMBLY, MAIN HOUSING	46	51199	1	SPRING, 4 IN RETURN (MEDIUM)	117	9004800-2506	2	PIN, STANDARD HEADLESS
		1	HOUSING, MAIN, DIFF, CASE DRAIN	48	51097	1	PUCK, ADJUSTING	120	44132	2	PUCK, BRAKE
		1	SEAL, LIP 12 X 25 X 7	50	50752	13	SCREW, HEX FLANGE 1/4-20 X .75	121	51927	1	BOLT, HEX HD 1/4-20 X 1.25 W/PATCH
		1	BEARING, FLANGE 1.0 X 1.376 X .99	51	50972	1	COVER, LOWER W/ 2 KIDNEYS	122	70633	1	ASSEMBLY, BRAKE YOKE
		1	BEARING, TRUNNION	52	50273	1	GEROTOR	124	50911	1	ARM, BRAKE
		2	BEARING, CRADLE	53	9004101-1340	1	O-RING, 1.862 X 2.068	125	44127	2	PIN, BRAKE ACTUATING
2A	71120	1	ASSEMBLY, RIGHT HAND HOUSING	54	50260	1	HOUSING, CHARGE PUMP	126	43177	3	WASHER, LOCK .489 X .258 X .062
		1	HOUSING, RIGHT HAND	55	70538	1	KIT, FILTER	127	43178	3	NUT, HEX 1/4-20
		1	BEARING, FLANGE 1.0 X 1.376 X .99			2	GASKET, 4.24 X 4.40 X .10	128	44142	1	NUT, CASTLE 5/16-24
		1	BEARING, NEEDLE .875 X 1.125 X 1.5			1	FILTER, STD CHARGE	129	44101	1	PIN, COTTER 3/32 X 3/4
		1	SEAL, LIP .875 X 1.375 X .250	56	51156	1	MANIFOLD, CHARGE	130	23711	1	SPACER, .26 X .57 X .87
2B	71139	1	KIT, BRAKE BOLT	57	50796	1	BEARING, MOTOR RETAINER	131	44134	1	PLATE, PUCK
		1	BOLT, HEX HD 1/4-20 X 1.25 W/PATCH	58	50776	4	PIN, CARRIER	132	51928	1	BOLT, HEX HD 1/4-20 X 2.25 W/PATCH
		1	BOLT, HEX HD 1/4-20 X 2.25 W/PATCH	59	50763	4	GEAR, 15T PLANET	139	44278	1	WASHER, .27 X .88 X .12
3	71363	1	ASSEMBLY, CENTER SECTION	60	50646	1	GEAR, 67T SPUR	141	50884	1	SPRING, BRAKE ARM BIAS
		1	CENTER SECTION	61	50645	1	GEAR, 21T SUN	144	50974	1	O-RING, 2.987 X 3.09
		1	BEARING, JOURNAL .50 X .59 X .50	62	50769	1	WASHER, THRUST 2.32 X 4.10 X .05	145	51157	3	SPRING, RELIEF
		1	BEARING, .90 X 1.0 X .75	63	50764	1	GEAR, 51T RING	146	9001214-4400	1	BALL, 7/16 IN
		1	PLATE, BYPASS	64	50765	1	CARRIER, PLANETARY	151	50919	1	SPRING, COMP. BRAKE ANTI-DRAG
		2	SHOCK VALVE ASSEMBLY, NO BLEED, SPRING	65	50647	2	GEAR, 14T MITER (SPLINED)	153	9005110-5600	2	PLUG, 9/16-18 (METAL)
4	2003018	1	SPACER, .98 X 1.37 X .04	66	50648	2	GEAR, 14T MITER (UNSPLINED)	155	70243	1	KIT, FAN/PULLEY
5	9008000-0128	1	SEAL, LIP 15 X 35 X 7	67	50766	1	SHAFT, DIFFERENTIAL			1	NUT, HEX 1/2-20 W/ PATCH
6	2003016	1	RING, RETAINING	68	50767	1	WASHER, THRUST 3.46 X 4.39 X .05			3	BOLT, 1/4-20 W/PATCH
7	2003052	1	RING, RETAINING	69	50768	2	BEARING, FLANGE 1.0 X 1.376 X .99			1	PULLEY, 4.5 IN
8	2003043	1	BEARING, BALL .59 X 1.38 X .43	70	51642	2	WASHER, 1.008 X 2.60 X .038			3	SPACER, .571 X .260 X .618
10	2003087	1	SWASHPLATE, VARIABLE	71	50788	2	WASHER, 1.0 X 2.25 X .04			3	FAN, 7.0 IN (10 BLADE)
11	50551	1	BEARING, THRUST 30 X 52 X 13	73	50791	2	NUT, HEX 5/8-18 W/ PATCH			3	WASHER, LOCK .489 X .258 X .062
12	50795	1	SHAFT, INPUT (STD CHARGE)	74	50771	2	BEARING, BALL 25.4 X 52 X 15			3	NUT, HEX 1/4-20
13	2003017	1	WASHER, THRUST .59 X .79 X .04	75	50772	2	SEAL, LIP 1.0 X 2.049 X .375	157	50977	2	O-RING, .239 X .379
14	2003014	1	SPRING, BLOCK	76	50663	2	SHAFT, AXLE, 1.0 X 13.80 (KEY)	159	50259	3	SPACER, .571 X .260 X .618
15	70331	1	ASSEMBLY, BLOCK	77	44130	1	WASHER, .34 X .88 X .06	168	51151	1	SCREW, TORX HD SHOULDERED 5/16-18 X 1.81
		1	BLOCK, CYLINDER	79	50928	10.1oz	SEALANT	170	51644	1	CAM, STATIONARY
		5	PISTON	80	50868	8	SCREW, TORX HD 5/16-18 X 1.5	171	51645	1	CAM, ROTATING
		5	SPRING, COMPRESSION	81	44752	1	BEARING, NEEDLE .875 X 1.125 X 1.5	172	51646	1	WASHER, THRUST 2.78 X 3.60 X .036
		5	WASHER, THRUST	82	50777	2	WASHER, FLAT .88 X 1.25 X .04	173	51647	1	PLATE, LOAD
21	70082	1	ASSEMBLY, BLOCK	83	50775	1	RING, RETAINING	175	51648	2	DOG, ENGAGEMENT
		1	BLOCK, CYLINDER	84	50773	1	SEAL, LIP .875 1.375 X .250	177	51649	1	PLATE, GUIDE
		7	PISTON	85	50779	1	DISK, BRAKE	178	51650	1	CAM, DIFF LOCK ACTUATING
		7	SPRING, COMPRESSION	86	50132	1	WASHER, .51 X 1.0 X .03	179	51651	1	SHAFT, DIFF LOCK ACTUATING
		7	WASHER, THRUST	87	50836	1	SPACER, .32 X 1.96 X .15	180	51613	1	SLEEVE, DIFF LOCK ACTUATING
24	50662	1	SHAFT, MOTOR	88	50837	1	SCREW, SOCKET HD CAP 5/16-24 X 1.5	181	51652	1	ARM, DIFF LOCK ACTUATING
25	50552	1	BEARING, THRUST 42 X 68 X 16	89	44147	1	BEARING, BALL .62 X 1.38 X .44	182	51628	1	RING, RETAINING
26	51692	1	ARM, CONTROL	90	51200	1	SPACER, LOCATING	183	9004101-0120	1	O-RING, .364 X .504
27	50774	1	SPACER, 1.03 X 1.38 X .184	92	50870	1	SCREW, COUNTERSUNK 5/16-18 X 1.0	184	51654	1	O-RING, 1.489 X 1.629
28	50661	1	GEAR, 16T PINION	95	50108	1	NUT, HEX LOCK 5/16-24	203	70492	1	KIT, SEAL & O-RING
29	50975	2	SCREW, CAP M6 X 1 X 25	96	50866	1	BUSHING, SLEEVE 1.0 X 1.3 X 1.34			1	SEAL, LIP 15 X 35 X 7
30	2000015	1	GUIDE, SLOT	97		108.8oz	OIL, 20W50			1	SEAL, LIP 12 X 25 X 7
31	50807	1	ARM, TRUNNION TAPERED SQUARE	103	50302	1	PULLEY, 4.5 IN			1	SEAL, LIP 10 X 25 X 7
32	2003009	1	BEARING, TRUNNION	104	50307	1	FAN, 7.0 IN (10 BLADE)			1	O-RING, 1.862 X 2.068
33	9008000-0126	1	SEAL, LIP 12 X 25 X 7	106	51604	1	SPACER, TRUNNION			2	SEAL, LIP 1.0 X 2.049 X .375
34	51127	1	ARM, RETURN	107	44276	3	BOLT, HEX HD 1/4-20 X 1.50 W/PATCH			1	SEAL, LIP .875 X 1.375 X .250
36	50426	1	STUD, SHORT 5/16-24	110	70110	1	ASSEMBLY, O-RING & FITTING			2	O-RING, .239 X .309
38	70680	1	KIT, BYPASS PLATE			1	O-RING, .468 X .624			1	KIT, O-RING, MANIFOLD
39	2003555	1	ACTUATOR, BYPASS			1	FITTING, PLASTIC STRAIGHT			1	O-RING, .304 X .504
40	45074	1	SEAL, LIP 10 X 25 X 7	111	70109	1	ASSEMBLY, CAP-VENT			1	O-RING, 1.489 X 1.629
41	50126	1	ARM, BYPASS			1	CAP, VENT				
42	44870	1	RING, RETAINING			1	VENT, PLASTIC				
43	50002	2	PIN, HOLLOW .39 X .50 X 1.12	113	50838	1	HOSE, 0.5 X 20				
44	50016	3	SCREW, HEX FLANGE 3/8-24 X 2.5	115	44133	1	NUT, HEX 1/2-20 W/ PATCH				
				116	50859	2	RING, RETAINING				

