

343121  
328-2400L

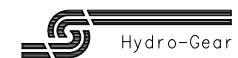

343121  
328-2400L

ITEM NO.	HYDRO-GEAR PART NO.	QTY.	DESCRIPTION	ITEM NO.	HYDRO-GEAR PART NO.	QTY.	DESCRIPTION	ITEM NO.	HYDRO-GEAR PART NO.	QTY.	DESCRIPTION
1	70627	1	KIT, HOUSING-MAIN	40	45074	1	LIP SEAL	129	44127	2	BRAKE ACTUATING PIN
		1	HOUSING, MAIN	41	50270	1	BYPASS ARM	130	50919	1	COMPRESSION SPRING BRAKE ANTI DRAG
		2	CRADLE BEARING	42	44870	1	RETAINING RING	131	70560	1	KIT, YOKE-BRAKE
		1	LIP SEAL	43	50002	2	PIN			1	SQ HD BOLT 5/16-24 RIBBED
		1	TRUNNION BUSHING	44	50016	3	SCREW			1	YOKE, BRAKE
2	5089ORM	1	LOWER HOUSING	46	50990	1	FILTER	133	44142	1	SLOTTED HEX NUT 5/16-24
3	70667	1	KIT, CENTER SECTION	49	51244	1	HEX LOCK NUT 1/2-20 (NYLON INSERT)	134	70553	1	KIT, SEAL
		1	CENTER SECTION	50	50752	18	SCREW, 1/4-20 X .75 LONG			1	SEAL, LIP 15 X 35 X 7
		1	BUSHING .67 X 1.03 X .75	51	50744	1	14T BEVEL GEAR			1	RING, RETAINING
		1	PLATE, BYPASS	52	50745	1	19T BEVEL GEAR			1	SEAL, LIP 12 X 25 X 7
		3	SCREW 3/8-24 X 2.5	53	50746	1	53T SPUR GEAR			1	SEAL, LIP 10 X 25 X 7
		2	CHECK PLUG ASSEMBLY, .027	54	50757	1	MOTOR SHAFT			1	RING, RETAINING
4	9008000-0128	1	LIP SEAL	55	51335	1	BRAKE SHAFT			2	SEAL, LIP 17 X 40 X 7
5	2003018	1	SPACER	56	50748	1	SHAFT, AXLE			1	SEAL, LIP 1.85 X .32
6	2003016	1	WIRE RETAINING RING	58	51161	2	SEAL, LIP 17 X 40 X 7			1	RING, RETAINING
7	2003052	1	RETAINING RING	60	50995	1	SEAL PLUG - SIDE			1	RING, RETAINING .440 EXTERNAL
8	2003043	1	BALL BEARING	62	50759	1	RETAINING RING - AXLE			1	SEAL, LIP .98 X 1.85 X .276
10	2003087	1	VARIABLE SWASHPLATE	64	50743	1	BEARING-BALL 20X47X14(6204)			1	RING, RETAINING
11	50551	1	THRUST BEARING 30 X 52 X 13	65	50740	1	BEARING-BALL 25X47X12(6005)			2	RING, RETAINING
12	50005	1	INPUT SHAFT	66	50751	1	SEAL			2	RING, RETAINING
13	50891RM	1	COVER-BACK	67	50329	1	RETAINING RING			2	SEAL, LIP 17 X 40 X 5
14	2003014	1	SPRING, BLOCK	68	50760	2	RETAINING RING-AXLE	135	51523	1	WASHER, OD SLOTTED, .53 X 1.63 X .06
15	70331	1	10cc CYLINDER BLOCK ASS'Y	70	51481	1	ARM, BRAKE	136	51362	1	FAN, 6", 10 BLADE
		1	10cc CYLINDER BLOCK	73	44855	1	ROTOR, BRAKE	137	70671	1	KIT, FAN-PULLEY
		5	10cc PISTON SPRING	80		79oz	20W-50 OIL			1	WASHER, OD SLOTTED, .53 X 1.63 X .06
		5	PISTON SEAT WASHER	81	51939	1	WASHER, AXLE 1.04 X 1.65 X .22			1	FAN, 6", 10 BLADE
		5	10cc PISTON	82	51940	1	WASHER, AXLE 1.04 X 1.65 X .70			1	HEX LOCK NUT 1/2-20 (NYLON INSERT)
19	44130	3	WASHER	83	70109	1	CAP VENT ASSEMBLY			1	PULLEY, 4.5
21	70082	1	21cc CYLINDER BLOCK ASS'Y			1	CAP-POPPET VALVE	142	51813	1	WASHER, BYPASS
		1	21cc CYLINDER BLOCK			1	PLASTIC VENT	143	51774	1	CAP, BRAKE
		7	21cc PISTON SPRING	99	70923	1	KIT, BREATHER	207	51604	1	SPACER, RTN
		7	PISTON SEAT WASHER			1	CLAMP, PINCH 13/16	208	51400	1	SCREW, 5/16-24 X .75 (PATCH)
		7	21cc PISTON			1	HOSE, .5 X 12	209	52401	1	SPRING, EXTENSION
24	2003017	1	WASHER, BLOCK THRUST	100	50928	1	FITTING, 9/16 90 DEG	215	51408	2	WASHER, NYLON
25	50552	1	THRUST BEARING 42 X 68 X 16	105	70561	1	SEALANT	216	70609	1	RTN, KIT
26	50315	2	BALL BEARING			1	KIT, BRAKE			2	WASHER
27	2000022	1	WIRE RETAINING RING			1	WASHER			1	HEX LOCK NUT, 5/16-24 UNJF (NYLON INSERT)
30	2000015	1	SLOT GUIDE			1	ROTOR, BRAKE			1	SPACER, RTN
31	50807	1	TRUNNION ARM			2	STATOR, BRAKE FRICTION			1	SCREW, 5/16-24 X .75 (PATCH)
33	9008000-0126	1	LIP SEAL			1	COTTER PIN 3/32 X 3/4			1	SPRING, EXTENSION
35	50108	1	HEX LOCK NUT, 5/16-24 UNJF (NYLON INSERT)			2	BRAKE ACTUATING PIN			2	WASHER, NYLON
38	70680	1	KIT, BYPASS PLATE			1	COMPRESSION SPRING ANTI DRAG			1	CONTROL ARM
39	2003555	1	BYPASS ACTUATOR	107	70314	1	KIT, YOKE-BRAKE			1	ARM, RTN SCISSOR, OUTER
						4	HUB ASSEMBLY			1	ARM, RTN SCISSOR, INNER
						1	LUG BOLT			1	ARM, RETURN
						1	HUB				
				108	50863	1	NUT, HEX 3/4-16				
				120	51875	1	PULLEY, 4.5				
				123	51341	3	SCREW, 1/4-28 X 1.25 W/PATCH				
				126	51316	2	RING, RETAINING				
				127	51340	2	STATOR, BRAKE FRICTION				
				128	44101	1	COTTER PIN 3/32 X 3/4				

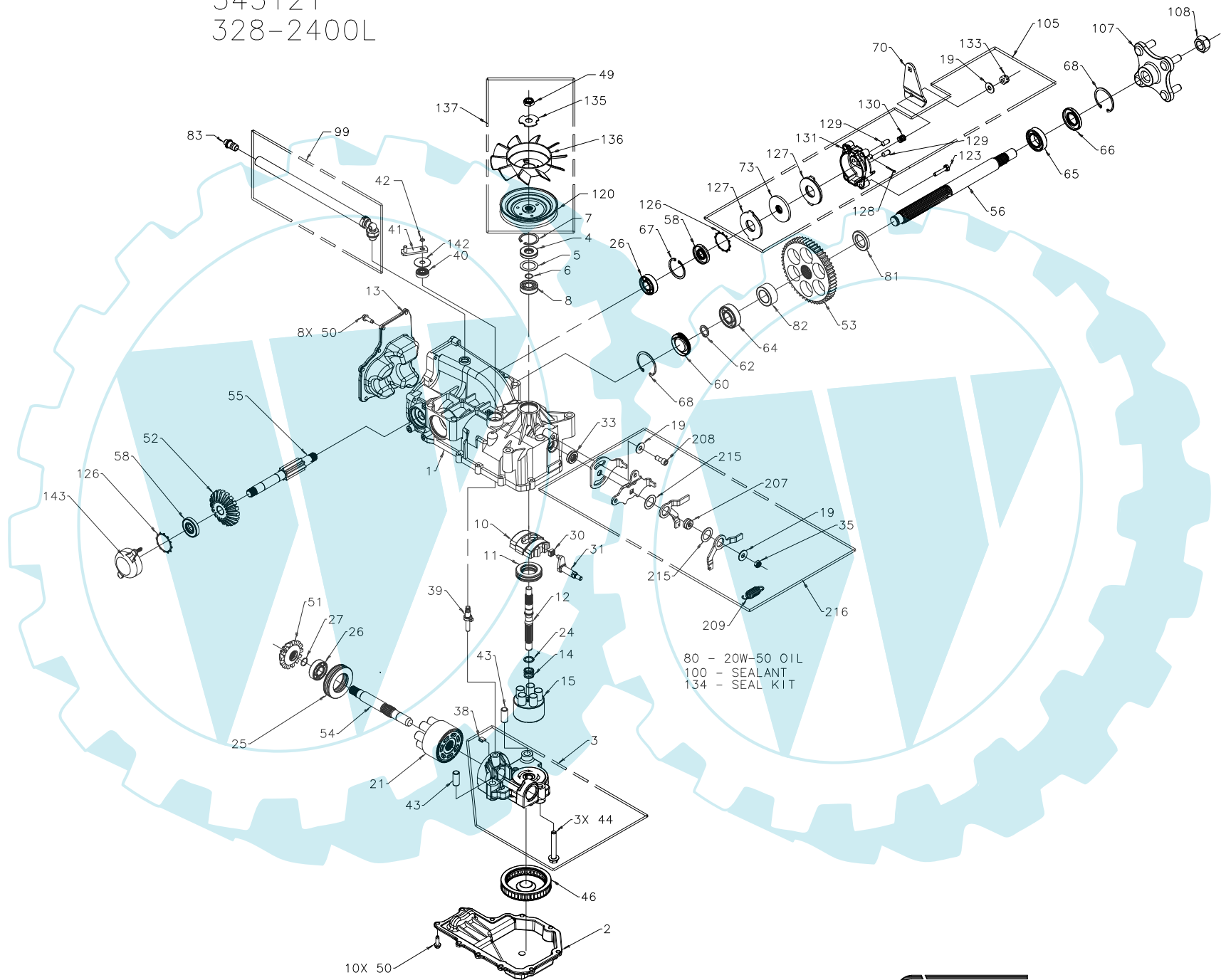