

337-3000

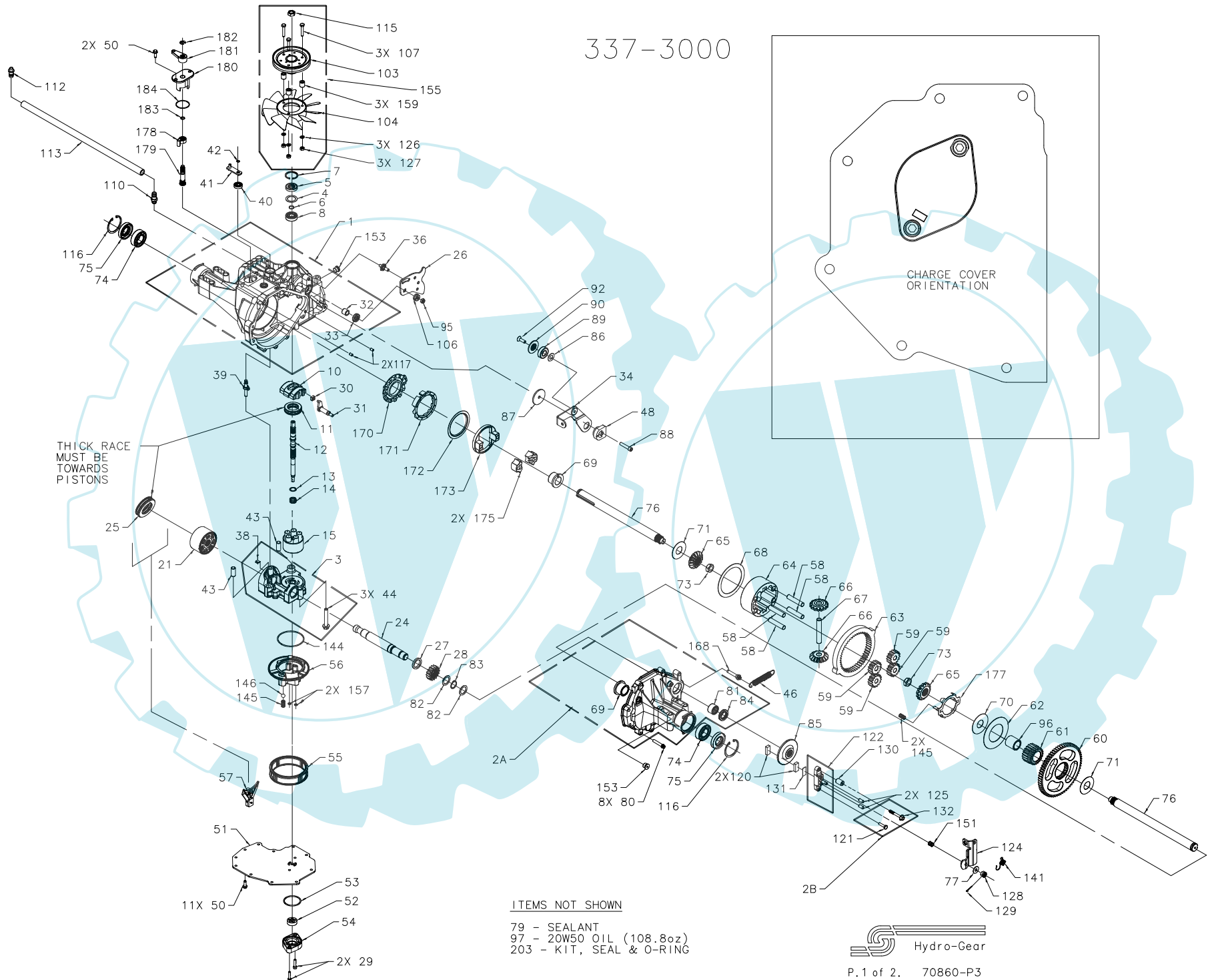

337-3000

ITEM#	PART #	QTY	DESCRIPTION	ITEM#	PART #	QTY	DESCRIPTION	ITEM#	PART #	QTY	DESCRIPTION
1	70876	1	ASSEMBLY, MAIN HOUSING	46	51199	1	SPRING, 4 IN RETURN (MEDIUM)	117	9004800-2506	2	PIN, STANDARD HEADLESS
		1	HOUSING, MAIN, DIFF, CASE DRAIN	48	51097	1	PUCK, ADJUSTING	120	44132	2	PUCK, BRAKE
		1	SEAL, LIP 12 X 25 X 7	50	50752	13	SCREW, HEX FLANGE 1/4-20 X .75	121	44433	1	BOLT, HEX HD 1/4-20 X 1 W/PATCH
		1	BEARING, FLANGE 1.0 X 1.376 X .99	51	50972	1	COVER, LOWER W/ 2 KIDNEYS	122	70633	1	ASSEMBLY, BRAKE YOKE
		1	BEARING, TRUNNION	52	50273	1	GEROTOR	124	50911	1	ARM, BRAKE
		2	BEARING, CRADLE	53	9004101-1340	1	O-RING, 1.862 X 2.068	125	44127	2	PIN, BRAKE ACTUATING
2A	71120	1	ASSEMBLY, RIGHT HAND HOUSING	54	50260	1	HOUSING, CHARGE PUMP	126	43177	3	WASHER, LOCK .489 X .258 X .062
		1	HOUSING, RIGHT HAND	55	70538	1	KIT, FILTER	127	43178	3	NUT, HEX 1/4-20
		1	BEARING, FLANGE 1.0 X 1.376 X .99	56	51156	1	MANIFOLD, CHARGE	128	44142	1	NUT, CASTLE 5/16-24
		1	BEARING, NEEDLE .875 X 1.125 X .75	57	50796	1	BEARING, MOTOR RETAINER	129	44101	1	PIN, COTTER 3/32 X 3/4
		1	SEAL, LIP .875 X 1.375 X .250	58	50776	4	PIN, CARRIER	130	23711	1	SPACER, .26 X .57 X .87
2B	71139	1	KIT, BRAKE BOLT	59	50763	4	GEAR, 15T PLANET	131	44134	1	PLATE, PUCK
		1	BOLT, HEX HD 1/4-20 X 1 W/PATCH	60	50646	1	GEAR, 67T SPUR	132	51146	1	BOLT, HEX HD 1/4-20 X 2 W/PATCH
		1	BOLT, HEX HD 1/4-20 X 2 W/PATCH	61	50645	1	GEAR, 21T SUN	141	50884	1	SPRING, BRAKE ARM BIAS
3	70683	1	ASSEMBLY, CENTER SECTION	62	50769	1	WASHER, THRUST 2.32 X 4.10 X .05	144	50974	1	O-RING, 2.987 X 3.09
		1	CENTER SECTION	63	50764	1	GEAR, 51T RING	145	51157	3	SPRING, RELIEF
		1	BEARING, JOURNAL .50 X .59 X .50	64	50765	1	CARRIER, PLANETARY	146	9001214-4400	1	BALL, 7/16 IN
		1	BEARING, .90 X 1.0 X .75	65	50647	2	GEAR, 14T MITER (SPLINED)	151	50919	1	SPRING, COMP. BRAKE ANTI-DRAG
		1	PLATE, BYPASS	66	50648	2	GEAR, 14T MITER (UNSPLINED)	153	9005110-5600	2	PLUG, 9/16-18 (METAL)
		2	CHECK PLUG ASSEMBLY, .027 BLEED	67	50766	1	SHAFT, DIFFERENTIAL	155	70243	1	KIT, FAN/PULLEY
		3	SCREW, HEX FLANGE 3/8-24 X 2.5	68	50767	1	WASHER, THRUST 3.46 X 4.39 X .05			1	NUT, HEX 1/2-20 W/ PATCH
4	2003018	1	SPACER, .98 X 1.37 X .04	69	50768	2	BEARING, FLANGE 1.0 X 1.376 X .99			3	BOLT, 1/4-20 W/PATCH
5	9008000-0128	1	SEAL, LIP 15 X 35 X 7	70	51642	1	WASHER, 1.008 X 2.60 X .038			1	PULLEY, 4.5 IN
6	2003016	1	RING, RETAINING	71	50788	2	WASHER, 1.0 X 2.25 X .04			3	SPACER, .571 X .260 X .618
7	2003052	1	RING, RETAINING	73	50791	2	NUT, HEX 5/8-18 W/ PATCH			1	FAN, 7.0 IN (10 BLADE)
8	2003043	1	BEARING, BALL .59 X 1.38 X .43	74	50771	2	BEARING, BALL 25.4 X 52 X 15			3	WASHER, LOCK .489 X .258 X .062
10	2003087	1	SWASHPLATE, VARIABLE	75	50772	2	SEAL, LIP 1.0 X 2.049 X .375			2	NUT, HEX 1/4-20
11	50551	1	BEARING, THRUST 30 X 52 X 13	76	50663	2	SHAFT, AXLE, 1.0 X 13.80 (KEY)	157	50977	2	O-RING, .239 X .379
12	50795	1	SHAFT, INPUT (STD CHARGE)	77	44130	1	WASHER, .34 X .88 X .06	159	50259	3	SPACER, .571 X .260 X .618
13	2003017	1	WASHER, THRUST .59 X .79 X .04	79	50928	10, 1oz	SEALANT	168	51151	1	SCREW, TORX HD SHOULDERED 5/16-18 X 1.81
14	2003014	1	SPRING, BLOCK	80	50868	8	SCREW, TORX HD 5/16-18 X 1.5	170	51644	1	CAM, STATIONARY
15	70331	1	ASSEMBLY, BLOCK	81	44752	1	BEARING, NEEDLE .875 X 1.125 X .75	171	51645	1	CAM, ROTATING
		1	BLOCK, CYLINDER	82	50777	2	WASHER, FLAT .88 X 1.25 X .04	172	51646	1	WASHER, THRUST 2.78 X 3.60 X .036
		5	PISTON	83	50775	1	RING, RETAINING	173	51647	1	PLATE, LOAD
		5	SPRING, COMPRESSION	84	50773	1	SEAL, LIP .875 1.375 X .250	175	51648	2	DOG, ENGAGEMENT
		5	WASHER, THRUST	85	50779	1	DISK, BRAKE	177	51649	1	PLATE, GUIDE
21	70082	1	ASSEMBLY, BLOCK	86	50132	1	WASHER, .51 X 1.0 X .03	178	51650	1	CAM, DIFF LOCK ACTUATING
		1	BLOCK, CYLINDER	87	50836	1	SPACER, .32 X 1.96 X .15	179	51651	1	SHAFT, DIFF LOCK ACTUATING
		7	PISTON	88	50837	1	SCREW, SOCKET HD CAP 5/16-24 X 1.5	180	51613	1	SLEEVE, DIFF LOCK ACTUATING
		7	SPRING, COMPRESSION	89	44147	1	BEARING, BALL .62 X 1.38 X .44	181	51652	1	ARM, DIFF LOCK ACTUATING
		7	WASHER, THRUST	90	51200	1	SPACER, LOCATING	182	51628	1	RING, RETAINING
24	50662	1	SHAFT, MOTOR	92	50870	1	SCREW, COUNTERSUNK 5/16-18 X 1.0	183	9004101-0120	1	O-RING, .364 X .504
25	50552	1	BEARING, THRUST 42 X 68 X 16	95	50108	1	NUT, HEX LOCK 5/16-24	184	51654	1	O-RING, 1.489 X 1.629
26	51692	1	ARM, CONTROL	96	50866	1	BUSHING, SLEEVE 1.0 X 1.3 X 1.34	203	70492	1	KIT, SEAL & O-RING
27	50774	1	SPACER, 1.03 X 1.38 X .184	103	50302	08, 8oz	OIL, 20W50			1	SEAL, LIP 15 X 35 X 7
28	50661	1	GEAR, 16T PINION	104	50307	1	PULLEY, 4.5 IN			1	SEAL, LIP 12 X 25 X 7
29	50975	2	SCREW, CAP M6 X 1 X 25	106	51604	1	FAN, 7.0 IN (10 BLADE)			1	SEAL, LIP 10 X 25 X 7
30	2000015	1	GUIDE, SLOT	107	44276	3	SPACER, TRUNNION			1	O-RING, 1.862 X 2.068
31	50807	1	ARM, TRUNNION TAPERED SQUARE	110	70110	1	BOLT, HEX HD 1/4-20 X 1.50 W/PATCH			2	SEAL, LIP 1.0 X 2.049 X .375
32	2003009	1	BEARING, TRUNNION	112	70109	1	ASSEMBLY, FITTING O-RING			1	SEAL, LIP .875 X 1.375 X .250
33	9008000-0126	1	SEAL, LIP 12 X 25 X 7	113	50838	1	ASSEMBLY, CAP-VENT			2	O-RING, .239 X .309
34	51127	1	ARM, RETURN	115	44133	1	HOSE, 0.5 X 20			1	KIT, O-RING, MANIFOLD
36	50426	1	STUD, SHORT 5/16-24	116	50859	2	NUT, HEX 1/2-20 W/ PATCH			1	O-RING, .304 X .504
38	70680	1	KIT, BYPASS PLATE				RING, RETAINING			1	O-RING, 1.489 X 1.629
39	2003555	1	ACTUATOR, BYPASS								
40	45074	1	SEAL, LIP 10 X 25 X 7								
41	50126	1	ARM, BYPASS								
42	44870	1	RING, RETAINING								
43	50002	2	PIN, HOLLOW .39 X .50 X 1.12								
44	50016	3	SCREW, HEX FLANGE 3/8-24 X 2.5								

