

328-3000

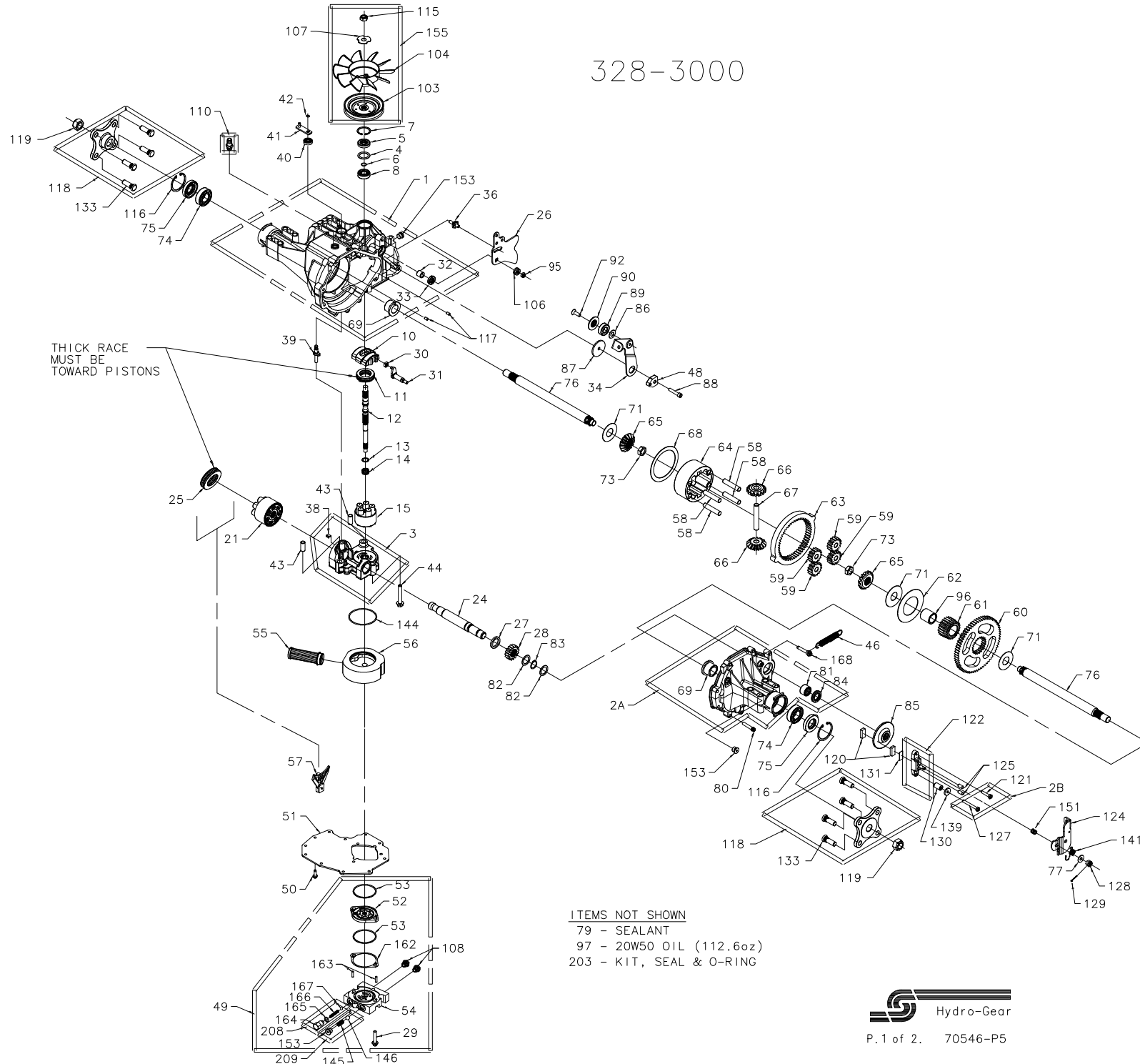

328-3000

ITEM#	PART #	QTY	DESCRIPTION
1	70433	1	ASSEMBLY, MAIN HOUSING
		1	HOUSING, MAIN, CASE DRAIN
		1	SEAL, LIP 12 X 25 X 7
		1	BEARING, FLANGE 1.0 X 1.376 X .99
		1	BEARING, TRUNNION
		2	BEARING, CRADLE
2A	71120	1	ASSEMBLY, RIGHT HAND HOUSING
		1	HOUSING, RIGHT HAND
		1	BEARING, FLANGE 1.0 X 1.376 X .99
		1	BEARING, NEEDLE .875 X 1.125 X 1.5
		1	SEAL, LIP .875 X 1.375 X .250
2B	71139	1	KIT, BRAKE BOLT
		1	BOLT, HEX HD 1/4-20 X 1.25 W/PATCH
		1	BOLT, HEX HD 1/4-20 X 2.25 W/PATCH
3	70686	1	ASSEMBLY, CENTER SECTION
		1	CENTER SECTION
		1	BEARING, JOURNAL .50 X .59 X .50
		1	BEARING .90 X 1.0 X .75
		1	PLATE, BYPASS
		1	CHECK PLUG ASSEMBLY, NO BLEED
		1	CHECK PLUG ASSEMBLY, .027 BLEED
4	2003018	1	SPACER, .98 X 1.37 X .04
5	9008000-0128	1	SEAL, LIP 15 X 35 X 7
6	2003016	1	RING, RETAINING
7	2003052	1	RING, RETAINING
8	2003043	1	BEARING, BALL .59 X 1.38 X .43
10	2003087	1	SWASHPLATE, VARIABLE
11	50551	1	BEARING, THRUST 30 X 52 X 13
12	50960	1	SHAFT, INPUT (AUX CHARGE)
13	2003017	1	WASHER, THRUST .59 X .79 X .04
14	2003014	1	SPRING, BLOCK
15	70331	1	ASSEMBLY, BLOCK
		1	BLOCK, CYLINDER
		5	PISTON
		5	SPRING, COMPRESSION
		5	WASHER, THRUST
21	70082	1	ASSEMBLY, BLOCK
		1	BLOCK, CYLINDER
		7	PISTON
		7	SPRING, COMPRESSION
		7	WASHER, THRUST
24	50662	1	SHAFT, MOTOR
25	50552	1	BEARING, THRUST 42 X 68 X 16
26	51250	1	ARM, CONTROL
27	50774	1	SPACER, 1.03 X 1.38 X .184
28	50661	1	GEAR, 16T PINION
29	51301	4	SCREW, CAP M8 X 1.25 X 40
30	2000015	1	GUIDE, SLOT
31	50807	1	ARM, TRUNNION TAPERED SQUARE
32	2003009	1	BEARING, TRUNNION
33	9008000-0126	1	SEAL, LIP 12 X 25 X 7
34	51127	1	ARM, RETURN
36	50426	1	STUD, SHORT 5/16-24
38	70680	1	KIT, BYPASS PLATE
39	2003555	1	ACTUATOR, BYPASS
40	45074	1	SEAL, LIP 10 X 25 X 7
41	50270	1	ARM, BYPASS
42	44870	1	RING, RETAINING
43	50002	2	PIN, HOLLOW .39 X .50 X 1.12
44	50016	3	SCREW, HEX FLANGE 3/8-24 X 2.5
46	51199	1	SPRING, 4 IN RETURN (MEDIUM)
48	51097	1	PUCK, ADJUSTING

ITEM#	PART #	QTY	DESCRIPTION
49	71201	1	KIT, AUX
		4	SCREW, CAP M8 X 1.25 X 40
		1	GEROTOR, AUX
		1	O-RING, 2.425 X 2.631
		1	HOUSING, CHARGE PUMP
		1	FILTER, AUX CHARGE
		2	PLUG, 9/16-18 (PLASTIC)
		1	O-RING, 2.987 X 3.09
		1	SPRING, RELIEF
		1	BALL, 7/16 IN
		1	PLUG, 9/16-18 (METAL)
		1	SHIM, AUX MANIFOLD (RED)
		2	PIN, .187 X .75
		1	VALVE BODY, AUX RELIEF
		1	O-RING, .468 X .624
		1	SPRING, AUX RELIEF
		1	BALL, 1/4 IN
50	50752	14	SCREW, HEX FLANGE 1/4-20 X .75
51	51302	1	COVER, LOWER W/ AUX
52	51049	1	GEROTOR, AUX
53	9004101-1430	2	O-RING, 2.425 X 2.631
54	70545	1	ASSEMBLY, AUX MANIFOLD
		1	MANIFOLD, AUX
		1	BUSHING, .394 X .472 X .394
		1	FILTER, AUX CHARGE
55	51308	1	MANIFOLD, AUX/FILTER
56	51303	1	RETAINER, MOTOR BEARING
57	50796	1	PIN, CARRIER
58	50776	4	GEAR, 15T PLANET
59	50763	1	GEAR, 67T SPUR
60	50646	1	GEAR, 21T SUN
61	50645	1	WASHER, THRUST 2.32 X 4.10 X .05
62	50769	1	GEAR, 51T RING
63	50764	1	CARRIER, PLANETARY
64	50765	2	GEAR, 14T MITER (SPLINED)
65	50647	2	GEAR, 14T MITER (UNSPLINED)
66	50648	1	SHAFT, DIFFERENTIAL
67	50766	1	WASHER, THRUST 3.46 X 4.39 X .05
68	50767	2	BEARING, FLANGE 1.0 X 1.376 X .99
69	50768	2	WASHER, 1.0 X 2.25 X .04
71	50788	2	NUT, HEX 5/8-18 W/ PATCH
73	50791	2	BEARING, BALL 25.4 X 52 X 15
74	50771	2	SEAL, LIP 1.0 X 2.049 X .375
75	50772	2	SHAFT, AXLE 1.0 X 13.84 (30° SPLINED)
76	50825	2	WASHER, .34 X .88 X .06
77	44130	1	SEALANT
79	50928	10.1oz	SCREW, TORX HD 5/16-18 X 1.5
80	50868	8	BEARING, NEEDLE .875 X 1.125 X 1.5
81	44752	1	WASHER, FLAT .88 X 1.25 X .04
82	50777	2	RING, RETAINING
83	50775	1	SEAL, LIP .875 X 1.375 X .250
84	50773	1	DISK, BRAKE
85	50779	1	WASHER, .51 X 1.0 X .03
86	50132	1	SPACER, .32 X 1.96 X .15
87	50836	1	SCREW, SOCKET HD CAP 5/16-24 X 1.5
88	50837	1	BEARING, BALL .62 X 1.38 X .44
89	44147	1	SPACER, LOCATING
90	51200	1	SCREW, COUNTERSUNK 5/16-18 X 1.0
92	50870	1	NUT, HEX LOCK 5/16-24
95	50108	1	BUSHING, SLEEVE 1.0 X 1.3 X 1.34
96	50866	1	OIL, 20W50
97		112.6oz	PULLEY, 4.5 IN
103	51875	1	

ITEM#	PART #	QTY	DESCRIPTION
104	51862	1	FAN, 7.0 IN (10 BLADE)
106	51604	1	SPACER, TRUNNION
107	51523	1	WASHER, OD SLOTTED .53 X 1.63 X .06
108	9005200-5600	2	PLUG, 9/16-18 (PLASTIC)
110	70110	1	ASSEMBLY, O-RING & FITTING
		1	O-RING, .468 X .624
		1	FITTING, PLASTIC STRAIGHT
115	44133	1	NUT, HEX 1/2-20 W/ PATCH
116	50859	2	RING, RETAINING
117	9004800-2506	2	PIN, STANDARD HEADLESS
118	70314	2	ASSEMBLY, HUB
		1	HUB, 4 STUD (PAINTED)
		4	STUD, 1/2-20 X 1.55 (RIB NECK)
119	50863	2	NUT, HEX LOCK 3/4-16
120	44132	2	PUCK, BRAKE
121	51927	1	BOLT, HEX HD 1/4-20 X 1.25 W/PATCH
122	70633	1	ASSEMBLY, BRAKE YOKE
124	50916	1	ARM, BRAKE
125	44127	2	PIN, BRAKE ACTUATING
128	44142	1	NUT, CASTLE 5/16-24
129	44101	1	PIN, COTTER 3/32 X 3/4
130	23711	1	SPACER, .26 X .57 X .87
131	44134	1	PLATE, PUCK
132	51928	1	BOLT, HEX HD 1/4-20 X 2.25 W/PATCH
133	44431	8	STUD, 1/2-20 X 1.55 (RIB NECK)
139	44278	1	WASHER, .27 X .88 X .12
141	50884	1	SPRING, BRAKE ARM BIAS
144	50974	1	O-RING, 2.987 X 3.09
145	51157	1	SPRING, RELIEF
146	9001214-4400	1	BALL, 7/16 IN
151	50919	1	SPRING, COMP. BRAKE ANTI-DRAW
153	9005110-5600	3	PLUG, 9/16-18 (METAL)
155	70489	1	KIT, FAN/PULLEY
		1	NUT, HEX 1/2-20 W/ PATCH
		1	WASHER, OD SLOTTED .53 X 1.63 X .06
		1	FAN, 7.0 IN (10 BLADE)
		1	PULLEY, 4.5 IN
162	51148	1	SHIM, AUX MANIFOLD (RED)
163	50408	2	PIN, .187 X .75
164	50967	1	VALVE BODY, AUX RELIEF
165	9004201-3700	1	O-RING, .468 X .624
166	50968	1	SPRING, AUX RELIEF
167	9001214-2500	1	BALL, 1/4 IN
168	51151	1	SCREW, TORX HD SHLDRD 5/16-18 X 1.81
203	70492	1	KIT, SEAL & O-RING
		1	SEAL, LIP 15 X 35 X 7
		1	SEAL, LIP 12 X 25 X 7
		1	SEAL, LIP 10 X 25 X 7
		2	O-RING, 2.425 X 2.631
		2	SEAL, LIP 1.0 X 2.049 X .375
		1	SEAL, LIP .875 X 1.375 X .250
		1	KIT, MANIFOLD O-RING
		1	SHIM, AUX MANIFOLD (RED)
208	2510082	1	KIT, AUX RELIEF VALVE
		1	VALVE, BODY, AUX RELIEF
		1	SPRING, AUX RELIEF
		1	BALL, 1/4 IN
		1	O-RING, .468 X .624
209	70544	1	KIT, CHARGE RELIEF
		1	SPRING, RELIEF
		1	BALL, 7/16 IN
		1	PLUG, 9/16-18 (METAL)