

315-1500

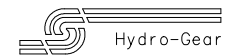

315-1500

| ITEM# | PART #       | QTY | DESCRIPTION                        | ITEM# | PART # | QTY      | DESCRIPTION                          | ITEM# | PART #       | QTY | DESCRIPTION                              |
|-------|--------------|-----|------------------------------------|-------|--------|----------|--------------------------------------|-------|--------------|-----|--|
| 1     | 70876        | 1   | ASSEMBLY, MAIN HOUSING             | 46    | 51199  | 1        | SPRING, 4 IN RETURN (MEDIUM)         | 117   | 9004800-2506 | 2   | PIN, STANDARD HEADLESS                   |
|       |              | 1   | HOUSING, MAIN, DIFF, CASE DRAIN    | 48    | 51097  | 1        | PUCK, ADJUSTING                      | 120   | 44132        | 2   | PUCK, BRAKE                              |
|       |              | 1   | SEAL, LIP 12 X 25 X 7              | 50    | 50752  | 13       | SCREW, HEX FLANGE 1/4-20 X .75       | 121   | 44433        | 1   | BOLT, HEX HD 1/4-20 X 1 W/PATCH          |
|       |              | 1   | BEARING, FLANGE 1.0 X 1.376 X .99  | 51    | 51128  | 1        | COVER, LOWER W/O KIDNEYS             | 122   | 70633        | 1   | ASSEMBLY, BRAKE YOKE                     |
|       |              | 1   | BEARING, TRUNNION                  | 55    | 50990  | 1        | FILTER, NO CHARGE                    | 124   | 50911        | 1   | ARM, BRAKE                               |
|       |              | 2   | BEARING, CRADLE                    | 57    | 50796  | 1        | RETAINER, MOTOR BEARING              | 125   | 44127        | 2   | PIN, BRAKE ACTUATING                     |
| 2A    | 71120        | 1   | ASSEMBLY, RIGHT HAND HOUSING       | 58    | 50776  | 4        | PIN, CARRIER                         | 126   | 43177        | 3   | WASHER, LOCK .489 X .258 X .062          |
|       |              | 1   | HOUSING, RIGHT HAND                | 59    | 50763  | 4        | GEAR, 15T PLANET                     | 127   | 43178        | 3   | NUT, HEX 1/4-20                          |
|       |              | 1   | BEARING, FLANGE 1.0 X 1.376 X .99  | 60    | 51599  | 1        | GEAR, 64T SPUR                       | 128   | 44142        | 1   | NUT, CASTLE 5/16-24                      |
|       |              | 1   | BEARING, NEEDLE .875 X 1.125 X .75 | 61    | 50645  | 1        | GEAR, 21T SUN                        | 129   | 44101        | 1   | PIN, COTTER 3/32 X 3/4                   |
|       |              | 1   | SEAL, LIP .875 X 1.375 X .250      | 62    | 50769  | 1        | WASHER, THRUST 2.32 X 4.10 X .05     | 130   | 23711        | 1   | SPACER, .26 X .57 X .87                  |
| 3     | 70682        | 1   | ASSEMBLY, CENTER SECTION           | 63    | 50764  | 1        | GEAR, 51T RING                       | 131   | 44134        | 1   | PLATE, PUCK                              |
|       |              | 1   | CENTER SECTION                     | 64    | 50765  | 1        | CARRIER, PLANETARY                   | 132   | 51146        | 1   | BOLT, HEX HD 1/4-20 X 2 W/PATCH          |
|       |              | 1   | BEARING, .90 X 1.0 X .75           | 65    | 50647  | 2        | GEAR, 14T MITER (SPLINED)            | 141   | 50884        | 1   | SPRING, BRAKE ARM BIAS                   |
|       |              | 1   | PLATE, BYPASS                      | 66    | 50648  | 2        | GEAR, 14T MITER (UNSPLINED)          | 145   | 51157        | 2   | SPRING, RELIEF                           |
|       |              | 2   | CHECK PLUG ASSEMBLY, .027 BLEED    | 67    | 50766  | 1        | SHAFT, DIFFERENTIAL                  | 151   | 50919        | 1   | SPRING, COMP. BRAKE ANTI-DRAG            |
|       |              | 3   | SCREW, HEX FLANGE 3/8-24 X 2.5     | 68    | 50767  | 1        | WASHER, THRUST 3.46 X 4.39 X .05     | 153   | 9005110-5600 | 2   | PLUG, 9/16-18 (METAL)                    |
| 4     | 2003018      | 1   | SPACER, .98 X 1.37 X .04           | 69    | 50768  | 2        | BEARING, FLANGE 1.0 X 1.376 X .99    | 155   | 70243        | 1   | KIT, FAN/PULLEY                          |
| 5     | 9008000-0128 | 1   | SEAL, LIP 15 X 35 X 7              | 70    | 51642  | 1        | WASHER, 1.008 X 2.60 X .038          | 1     |              | 1   | NUT, HEX 1/2-20 W/ PATCH                 |
| 6     | 2003016      | 1   | RING, RETAINING                    | 71    | 50788  | 2        | WASHER, 1.0 X 2.25 X .04             | 3     |              | 1   | BOLT, 1/4-20 X 1.5 W/PATCH               |
| 7     | 2003052      | 1   | RING, RETAINING                    | 73    | 50791  | 2        | NUT, HEX 5/8-18 W/ PATCH             | 1     |              | 1   | PULLEY, 4.5 IN                           |
| 8     | 2003043      | 1   | BEARING, BALL .59 X 1.38 X .43     | 74    | 50771  | 2        | BEARING, BALL 25.4 X 52 X .15        | 3     |              | 1   | SPACER, .571 X .260 X .618               |
| 10    | 2003087      | 1   | SWASHPLATE, VARIABLE               | 75    | 50772  | 2        | SEAL, LIP 1.0 X 2.049 X .375         | 1     |              | 1   | FAN, 7.0 IN (10 BLADE)                   |
| 11    | 50551        | 1   | BEARING, THRUST 30 X 52 X 13       | 76    | 50663  | 2        | SHAFT, AXLE, 1.0 X 13.80 (KEY)       | 3     |              | 1   | WASHER, LOCK .489 X .258 X .062          |
| 12    | 50005        | 1   | SHAFT, INPUT (NO CHARGE)           | 77    | 44130  | 1        | WASHER, .34 X .88 X .06              | 3     |              | 1   | NUT, HEX 1/4-20                          |
| 13    | 2003017      | 1   | WASHER, THRUST .59 X .79 X .04     | 79    | 50928  | 10, 1oz  | SEALANT                              | 159   | 50259        | 3   | SPACER, .571 X .260 X .618               |
| 14    | 2003014      | 1   | SPRING, BLOCK                      | 80    | 50868  | 8        | SCREW, TORX HD 5/16-18 X 1.5         | 168   | 51151        | 1   | SCREW, TORX HD SHOULDERED 5/16-18 X 1.81 |
| 15    | 70331        | 1   | ASSEMBLY, BLOCK                    | 81    | 44752  | 1        | BEARING, NEEDLE .875 X 1.125 X .75   | 170   | 51644        | 1   | CAM, STATIONARY                          |
|       |              | 1   | BLOCK, CYLINDER                    | 82    | 50777  | 2        | WASHER, FLAT .88 X 1.25 X .04        | 171   | 51645        | 1   | CAM, ROTATING                            |
|       |              | 5   | PISTON                             | 83    | 50775  | 1        | RING, RETAINING                      | 172   | 51646        | 1   | WASHER, THRUST 2.78 X 3.60 X .036        |
|       |              | 5   | SPRING, COMPRESSION                | 84    | 50773  | 1        | SEAL, LIP .875 1.375 X .250          | 173   | 51647        | 1   | PLATE, LOAD                              |
|       |              | 5   | WASHER, THRUST                     | 85    | 50779  | 1        | DISK, BRAKE                          | 175   | 51648        | 2   | DOG, ENGAGEMENT                          |
| 21    | 70082        | 1   | ASSEMBLY, BLOCK                    | 86    | 50132  | 1        | WASHER, .51 X 1.0 X .03              | 177   | 51649        | 1   | PLATE, GUIDE                             |
|       |              | 1   | BLOCK, CYLINDER                    | 87    | 50836  | 1        | SPACER, .32 X 1.96 X .15             | 178   | 51650        | 1   | CAM, DIFF LOCK ACTUATING                 |
|       |              | 7   | PISTON                             | 88    | 50837  | 1        | SCREW, SOCKET HD CAP 5/16-24 X 1.5   | 179   | 51651        | 1   | SHAFT, DIFF LOCK ACTUATING               |
|       |              | 7   | SPRING, COMPRESSION                | 89    | 44147  | 1        | BEARING, BALL .62 X 1.38 X .44       | 180   | 51613        | 1   | SLEEVE, DIFF LOCK ACTUATING              |
|       |              | 7   | WASHER, THRUST                     | 90    | 51200  | 1        | SPACER, LOCATING                     | 181   | 51652        | 1   | ARM, DIFF LOCK ACTUATING                 |
| 24    | 50662        | 1   | SHAFT, MOTOR                       | 92    | 50870  | 1        | SCREW, COUNTERSUNK 5/16-18 X 1.0     | 182   | 51628        | 1   | RING, RETAINING                          |
| 25    | 50552        | 1   | BEARING, THRUST 42 X 68 X 16       | 95    | 50108  | 1        | NUT, HEX LOCK 5/16-24 W/NYLON INSERT | 183   | 9004101-0120 | 1   | O-RING, .364 X .504                      |
| 26    | 51692        | 1   | ARM, CONTROL                       | 96    | 50866  | 1        | BUSHING, SLEEVE 1.0 X 1.3 X 1.34     | 184   | 51654        | 1   | O-RING, 1.489 X 1.629                    |
| 27    | 50774        | 1   | SPACER, 1.03 X 1.38 X .184         | 97    |        | 113, 9oz | OIL, 20W50                           | 203   | 70492        | 1   | KIT, SEAL & O-RING                       |
| 28    | 51600        | 1   | GEAR, 19T PINION                   | 103   | 50302  | 1        | PULLEY, 4.5 IN                       | 1     |              | 1   | SEAL, LIP 15 X 35 X 7                    |
| 30    | 2000015      | 1   | GUIDE, SLOT                        | 104   | 50307  | 1        | FAN, 7.0 IN (10 BLADE)               | 1     |              | 1   | SEAL, LIP 12 X 25 X 7                    |
| 31    | 50807        | 1   | ARM, TRUNNION TAPERED SQUARE       | 106   | 51604  | 1        | SPACER, TRUNNION                     | 1     |              | 1   | SEAL, LIP 10 X 25 X 7                    |
| 32    | 2003009      | 1   | BEARING, TRUNNION                  | 107   | 44276  | 3        | BOLT, HEX HD 1/4-20 X 1.50 W/PATCH   | 2     |              | 1   | SEAL, LIP 1.0 X 2.049 X .375             |
| 33    | 9008000-0126 | 1   | SEAL, LIP 12 X 25 X 7              | 110   | 70110  | 1        | ASSEMBLY, FITTING O-RING             | 1     |              | 1   | SEAL, LIP .875 X 1.375 X .250            |
| 34    | 51127        | 1   | ARM, RETURN                        | 112   | 70109  | 1        | ASSEMBLY, CAP-VENT                   | 1     |              | 1   | O-RING, .364 X .504                      |
| 36    | 50426        | 1   | STUD, SHORT 5/16-24                | 113   | 50838  | 1        | HOSE, 0.5 X 20                       | 1     |              | 1   | O-RING, 1.489 X 1.629                    |
| 38    | 70680        | 1   | KIT, BYPASS PLATE                  | 115   | 44133  | 1        | NUT, HEX 1/2-20 W/ PATCH             |       |              |     |  |
| 39    | 2003555      | 1   | ACTUATOR, BYPASS                   | 116   | 50859  | 2        | RING, RETAINING                      |       |              |     |  |
| 40    | 45074        | 1   | SEAL, LIP 10 X 25 X 7              |       |        |          |                                      |       |              |     |  |
| 41    | 50126        | 1   | ARM, BYPASS                        |       |        |          |                                      |       |              |     |  |
| 42    | 44870        | 1   | RING, RETAINING                    |       |        |          |                                      |       |              |     |  |
| 43    | 50002        | 2   | PIN, HOLLOW .39 X .50 X 1.12       |       |        |          |                                      |       |              |     |  |
| 44    | 50016        | 3   | SCREW, HEX FLANGE 3/8-24 X 2.5     |       |        |          |                                      |       |              |     |  |

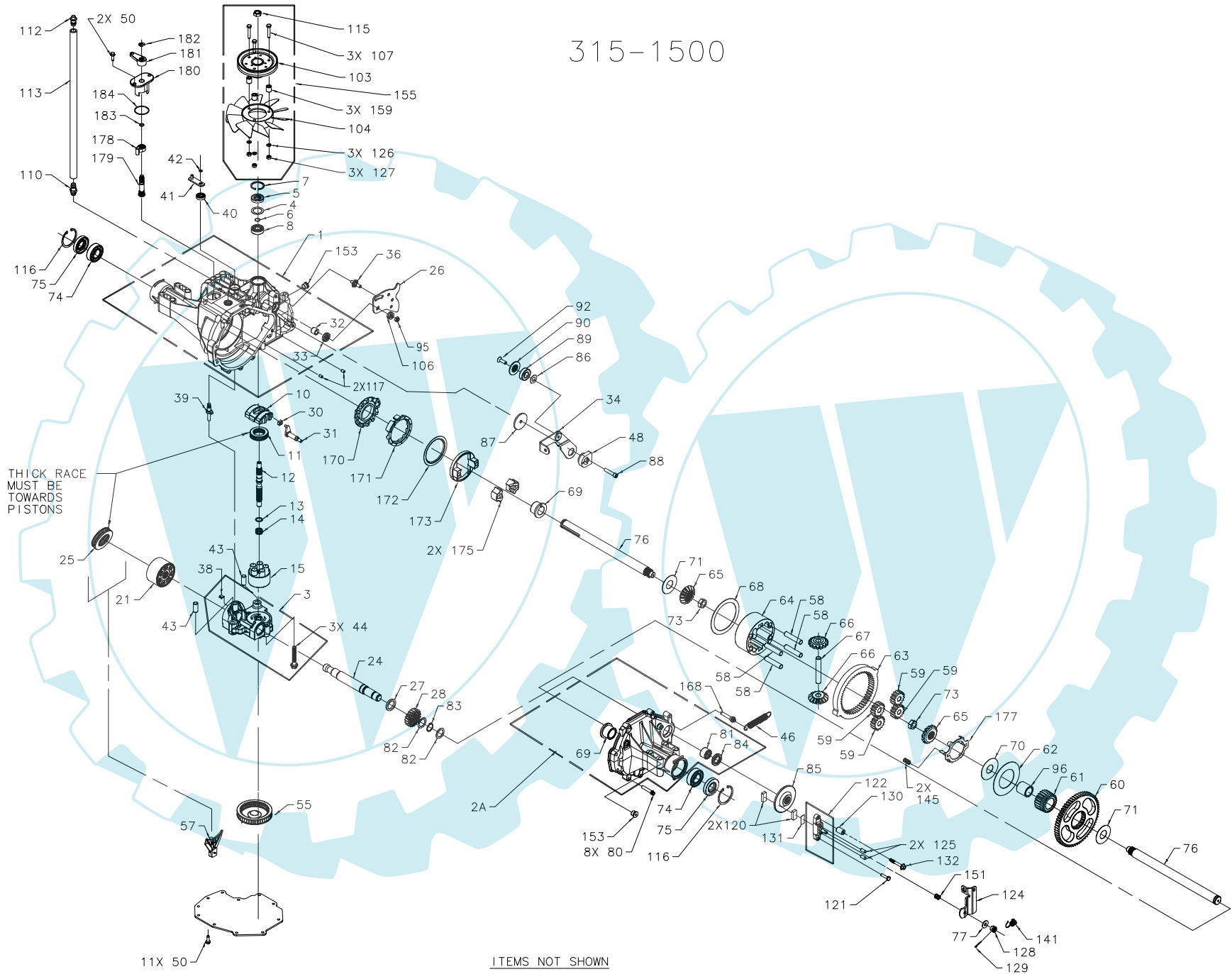