

199651
347-3000

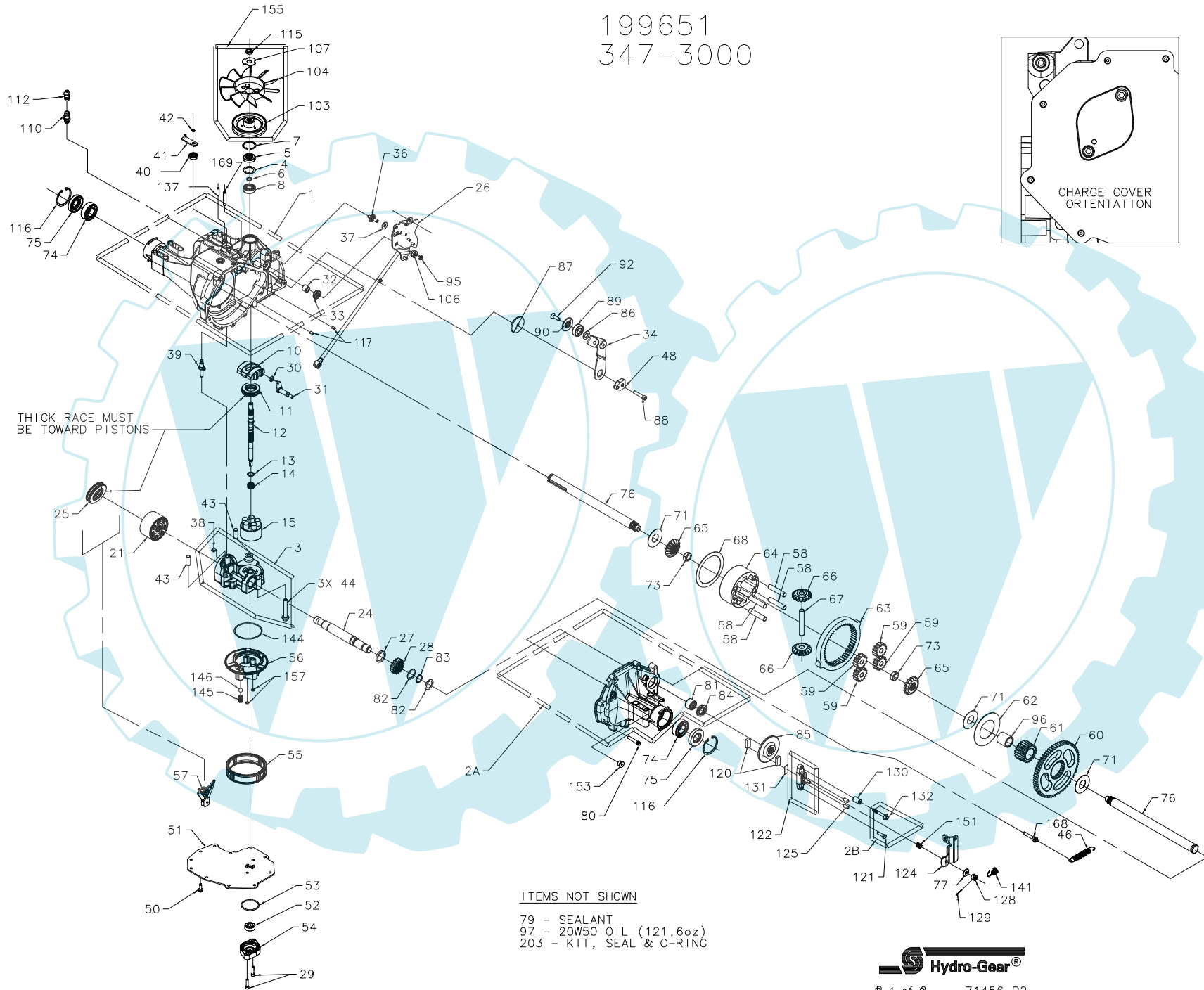

199651
347-3000

ITEM #	PART #	QTY	DESCRIPTION	ITEM #	PART #	QTY	DESCRIPTION	ITEM #	PART #	QTY	DESCRIPTION
1	70297	1	ASSEMBLY, MAIN HOUSING	46	52386	1	SPRING, 4IN RETURN (LIGHT)	128	44142	1	NUT, CASTLE 5/16-24
		1	HOUSING, MAIN	48	51097	1	PUCK, ADJUSTING	129	44101	1	PIN, COTTER 3/32 X 3/4
		1	SEAL, LIP 12 X 25 X 7	50	50752	11	SCREW, HEX FLANGE 1/4-20 X .75	130	23711	1	SPACER, .26 X .57 X .87
		1	BEARING, FLANGE 1.0 X 1.376 X .99	51	50972	1	COVER, LOWER W/ 2 KIDNEYS	131	44134	1	PLATE, PUCK
		1	BEARING, TRUNNION	52	50273	1	GEROTOR	132	51146	1	BOLT, HEX HD 1/4-20 X 2 W/PATCH
2A	71120	2	BEARING, CRADLE	53	9004101-1340	1	O-RING 1.862 X 2.068	137	50882	1	PIN, SPRING .26 X 1
		1	ASSEMBLY, RIGHT HAND HOUSING	54	52610	1	HOUSING, CHARGE PUMP	141	50884	1	SPRING, BRAKE ARM BIAS
		1	HOUSING, RIGHT HAND	55	70538	1	KIT, FILTER	144	50974	1	O-RING 2.987 X 3.09
		1	BEARING, FLANGE 1.0 X 1.376 X .99	56	51156	1	MANIFOLD, CHARGE	145	51157	1	SPRING, RELIEF
		1	BEARING, NEEDLE .875 X 1.125 X .75	57	50796	1	RETAINER, MOTOR BEARING	146	9001214-4400	1	BALL, 7/16 IN
		1	SEAL, LIP .875 X 1.375 X .250	58	50776	4	PIN, CARRIER	151	50919	1	SPRING, COMP. BRAKE ANTI-DRAG
2B	71139	1	KIT, BRAKE BOLT	59	50763	4	GEAR, 15T PLANET	153	9005110-5600	1	PLUG, 9/16-18 (METAL)
		1	BOLT, HEX HD 1/4-20 X 1 W/PATCH	60	50646	1	GEAR, 67T SPUR	155	70460	1	KIT, FAN/PULLEY
		1	BOLT, HEX HD 1/4-20 X 2 W/PATCH	61	50645	1	GEAR, 21T SUN			1	NUT, HEX LOCK 1/2-20 W/NYLON INSERT
3	70687	1	ASSEMBLY, CENTER SECTION	62	50769	1	WASHER, THRUST 2.32 X 4.10 X .05			1	WASHER, OD SLOTTED .53 X 1.63 X .06
		1	CENTER SECTION	63	50764	1	GEAR, 51T RING			1	FAN, 7.0 IN (10 BLADE)
		1	BEARING, JOURNAL .50 X .59 X .50	64	50765	1	CARRIER, PLANETARY			1	PULLEY, 3.86 IN
		1	BEARING .90 X 1.0 X .75	65	50647	2	GEAR, 14T MITER (SPLINED)	157	50977	2	O-RING .239 X .379
		1	PLATE, BYPASS	66	50648	2	GEAR, 14T MITER (UNSPLINED)	168	51151	1	SCREW, TORX HD SHOULDERED 5/16-18 X 1.81
		1	CHECK PLUG ASSEMBLY, .044	67	50766	1	SHAFT, DIFFERENTIAL	169	51463	1	PIN, SPRING .32 X 1.75
		1	CHECK PLUG ASSEMBLY, .027	68	50767	1	WASHER, THRUST 3.46 X 4.39 X .05	203	70492	1	KIT, SEAL & O-RING
4	2003018	3	SCREW, HEX FLANGE 3/8-24 X 2.5	71	50788	3	WASHER, 1.0 X 2.25 X .04			1	SEAL, LIP 15 X 35 X 7
5	9008000-0128	1	SPACER, .98 X 1.37 X .04	73	50791	2	NUT, HEX 5/8-18 W/ PATCH			1	SEAL, LIP 12 X 25 X 7
6	2003016	1	SEAL, LIP 15 X 35 X 7	74	50771	2	BEARING, BALL 25.4 X 52 X 15			1	SEAL, LIP 10 X 25 X 7
7	2003052	1	RING, RETAINING	75	50772	2	SEAL, LIP 1.0 X 2.049 X .375			1	O-RING, 1.862 X 2.068
8	2003043	1	RING, RETAINING	76	50663	2	SHAFT, AXLE 1.0 X 13.80 (KEY)			2	SEAL, LIP 1.0 X 2.049 X .375
10	2003087	1	BEARING, BALL .59 X 1.38 X .43	77	44130	1	WASHER, FLAT .34 X .88 X .06			1	SEAL, LIP .875 X 1.375 X .250
11	50551	1	SWASHPLATE, VARIABLE	79	50928	10.1oz	SEALANT			1	KIT, MANIFOLD O-RING
12	50795	1	BEARING, THRUST 30 X 52 X 13	80	50868	8	SCREW, TORX HD 5/16-18 X 1.5			2	O-RING, .239 X .379
13	2003017	1	SHAFT, INPUT (STD CHARGE)	81	44752	1	BEARING, NEEDLE .875 X 1.125 X .75				
14	2003014	1	WASHER, THRUST .59 X .79 X .04	82	50777	2	WASHER, FLAT .88 X 1.25 X .04				
15	70331	1	SPRING, BLOCK	83	50775	1	RING, RETAINING				
		1	ASSEMBLY, BLOCK	84	50773	1	SEAL, LIP .875 X 1.375 X .250				
		1	BLOCK, CYLINDER	85	50779	1	DISK, BRAKE				
		5	PISTON	86	50132	1	WASHER .5 X 1.0 X .03				
		5	SPRING, COMPRESSION	87	50836	1	SPACER, .32 X 1.96 X .15				
		5	WASHER, THRUST	88	50837	1	SCREW, SOCKET HD CAP 5/16-24 X 1.5				
21	70082	1	ASSEMBLY, BLOCK	89	44147	1	BEARING, BALL .62 X 1.38 X .44				
		1	BLOCK, CYLINDER	90	51200	1	SPACER, LOCATING				
		7	PISTON	92	50870	1	SCREW, COUNTERSUNK 5/16-18 X 1.0				
		7	SPRING, COMPRESSION	95	50108	1	NUT, HEX LOCK 5/16-24 W/NYLON INSERT				
		7	WASHER, THRUST	96	50866	1	BUSHING, SLEEVE 1.0 X 1.3 X 1.34				
		1	SHAFT, MOTOR	97		121.6oz	OIL 20W50				
24	50662	1	BEARING, THRUST 42 X 68 X 16	103	51231	1	PULLEY, 3.86 IN				
25	50552	1	ASSEMBLY, GT RCS	104	51230	1	FAN, 7.0 (10 BLADE)				
26	71457	1	BULLETIN, CONTROL ARM	106	51604	1	SPACER, TRUNNION				
27	50774	1	SPACER, 1.03 X 1.38 X .184	107	51523	1	WASHER, OD SLOTTED .53 X 1.63 X .06				
28	50661	1	GEAR, 16T PINION	110	70110	1	ASSEMBLY, FITTING O-RING				
29	50975	2	SCREW, CAP M6 X 1 X 25	112	70109	1	ASSEMBLY, CAP-VENT				
30	2000015	1	GUIDE, SLOT	115	51244	1	NUT, HEX LOCK 1/2-20 W/NYLON INSERT				
31	50807	1	ARM, TRUNNION TAPERED SQUARE	116	50859	2	RING, RETAINING				
32	2003009	1	BEARING, TRUNNION	117	9004800-2506	2	PIN, STANDARD HEADLESS				
33	9008000-0126	1	SEAL, LIP 12 X 25 X 7	120	44132	2	PUCK, BRAKE				
34	51127	1	ARM, RETURN	121	44433	1	BOLT, HEX HD 1/4-20 X 1 W/PATCH				
36	50426	1	STUD, SHORT 5/16-24	122	70633	1	ASSEMBLY, BRAKE YOKE				
37	50281	1	PUCK, .798 X .319 X .097	124	50911	1	ARM, BRAKE				
38	70680	1	KIT, BYPASS PLATE	125	44127	2	PIN, BRAKE ACTUATOR				
39	2003555	1	ACTUATOR, BYPASS								
40	45074	1	SEAL, LIP 10 X 25 X 7								
41	50270	1	ARM, BYPASS								
42	44870	1	RING, RETAINING								
43	50002	2	PIN, HOLLOW .39 X .50 X 1.12								