

181403  
314-3500

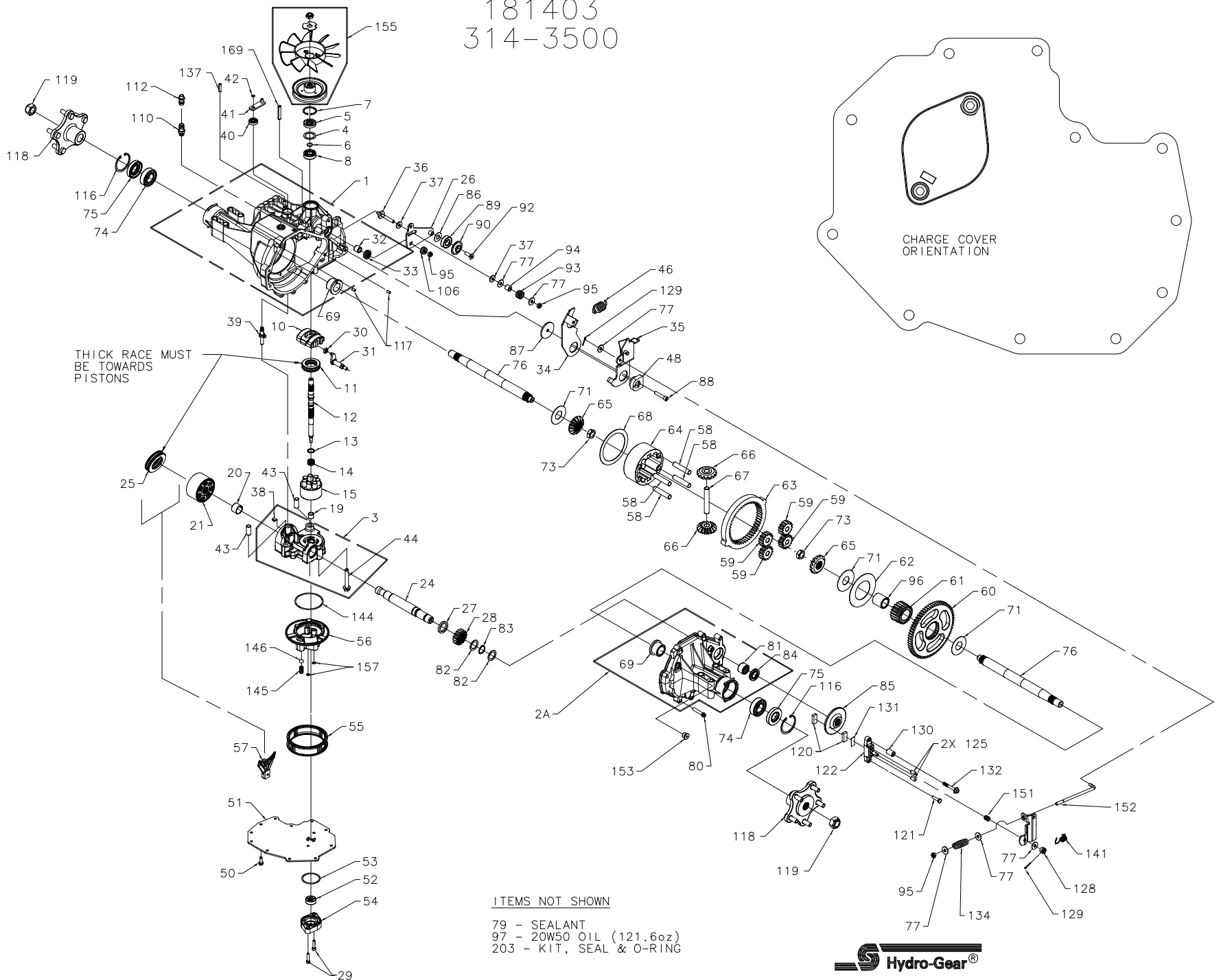

181403  
314-3500

ITEM #	PART #	QTY	DESCRIPTION
1	70297	1	ASSEMBLY, MAIN HOUSING
		1	HOUSING, MAIN
		1	SEAL, LIP 12 X 25 X 7
		1	BEARING, FLANGE 1.0 X 1.376 X .99
		1	BEARING, TRUNNION
		2	BEARING, CRADLE
2A	71120	1	ASSEMBLY, RIGHT HAND HOUSING
		1	HOUSING, RIGHT HAND
		1	BEARING, FLANGE 1.0 X 1.376 X .99
		1	BEARING, NEEDLE .875 X 1.125 X 1.5
		1	SEAL, LIP .875 X 1.375 X .250
3	70780	1	ASSEMBLY, CENTER SECTION
		1	CENTER SECTION
		1	BEARING, JOURNAL .50 X .59 X .50
		1	BEARING, .90 X 1.0 X .75
		1	PLATE, BYPASS
		1	CHECK PLUG ASSEMBLY, .044 BLEED
		1	CHECK PLUG ASSEMBLY, NO BLEED
		3	SCREW, HEX FLANGE 3/8-24 X 2.5
4	2003018	1	SPACER, .98 X 1.37 X .04
5	9008000-0128	1	SEAL, LIP 15 X 35 X 7
6	2003016	1	RING, RETAINING
7	2003052	1	RING, RETAINING
8	2003043	1	BEARING, BALL .59 X 1.38 X .43
10	2003087	1	SWASHPLATE, VARIABLE
11	50551	1	BEARING, THRUST 30 X 52 X 13
12	50795	1	SHAFT, INPUT (STD CHARGE)
13	2003017	1	WASHER, THRUST .59 X .79 X .04
14	2003014	1	SPRING, BLOCK
15	70723	1	ASSEMBLY, BLOCK
		1	BLOCK, CYLINDER
		7	PISTON
		7	SPRING, COMPRESSION
		7	WASHER, THRUST
21	70082	1	ASSEMBLY, BLOCK
		1	BLOCK, CYLINDER
		7	PISTON
		7	SPRING, COMPRESSION
		7	WASHER, THRUST
24	50662	1	SHAFT, MOTOR
25	50552	1	BEARING, THRUST 42 X 68 X 16
26	50857	1	ARM, CONTROL
27	50774	1	SPACER, 1.03 X 1.38 X .184
28	50661	1	GEAR, 16T PINION
29	50975	2	SCREW, CAP M6 X 1 X 25
30	2000015	1	GUIDE, SLOT
31	50807	1	ARM, TRUNNION TAPERED SQUARE
32	2003009	1	BEARING, TRUNNION
33	9008000-0126	1	SEAL, LIP 12 X 25 X 7
34	50831	1	ARM, RETURN
35	51512	1	ARM, ACTUATING
36	50284	1	STUD, LONG 5/16-24
37	50281	2	PUCK, .798 X .319 X .097

ITEM #	PART #	QTY	DESCRIPTION
38	70680	1	KIT, PLATE BYPASS
39	2003555	1	ACTUATOR, BYPASS
40	45074	1	SEAL, LIP 10 X 25 X 7
41	50270	1	ARM, BYPASS
42	44870	1	RING, RETAINING
43	50002	2	PIN, HOLLOW .39 X .50 X 1.12
44	50016	3	SCREW, HEX FLANGE 3/8-24 X 2.5
46	50833	1	SPRING, 2.09 IN RETURN
48	50835	1	PUCK, ADJUSTING
50	50752	11	SCREW, HEX FLANGE 1/4-20 X .75
51	50972	1	COVER, LOWER W/2 KIDNEYS
52	50273	1	GEROTOR
53	9004101-1340	1	O-RING, 1.862 X 2.068
54	50260	1	HOUSING, CHARGE PUMP
55	51315	1	FILTER STD CHARGE
56	51156	1	MANIFOLD, CHARGE
57	50796	1	RETAINER, MOTOR BEARING
58	50776	4	PIN, CARRIER
59	50763	4	GEAR, 15T PLANET
60	50646	1	GEAR, 67T SPUR
61	50645	1	GEAR, 21T SUN
62	50769	1	WASHER, THRUST 2.32 X 4.10 X .05
63	50764	1	GEAR, 51T RING
64	50765	1	CARRIER, PLANETARY
65	51431	2	GEAR, 14T STEEL MITER (SPLINED)
66	51432	2	GEAR, 14T STEEL MITER (UNSPLINED)
67	50766	1	SHAFT, DIFFERENTIAL
68	50767	1	WASHER, THRUST 3.46 X 4.39 X .05
69	50768	2	BEARING, FLANGE 1.0 X 1.376 X .99
71	50788	3	WASHER, 1.0 X 2.25 X .04
73	50791	2	NUT, HEX 5/8-18 W/PATCH
74	50771	2	BEARING, BALL 25.4 X 52 X 15
75	50772	2	SEAL, LIP 1.0 X 2.049 X .375
76	51659	2	SHAFT, AXLE 1.0 X 12.57 (3.6° TAPER)
77	44130	6	WASHER, .34 X .88 X .06
79	50928	10.1oz	SEALANT
80	50868	9	SCREW, TORX HD 5/16-18
81	44752	1	BEARING, NEEDLE .875 X 1.125 X .75
82	50777	2	WASHER, FLAT .88 X 1.25 X .04
83	50775	1	RING, RETAINING
84	50773	1	SEAL, LIP .875 X 1.375 X .250
85	50779	1	DISK, BRAKE
86	50132	1	WASHER, .51 X 1.0 X .03
87	50836	1	SPACER, .32 X 1.96 X .15
88	50837	1	SCREW, SOCKET HD CAP 5/16-24 X 1.5
89	44147	1	BEARING, BALL .62 X 1.38 X .44
90	51200	1	SPACER, LOCATING
92	50870	1	SCREW, COUNTERSUNK 5/16-18 X 1.0
93	50277	1	SPRING, HELICAL COMP
94	50278	1	SPACER, .587 X .319 X .500
95	50108	3	NUT, HEX LOCK 5/16-24 (NYLON INSERT)
96	50866	1	BUSHING, SLEEVE 1.0 X 1.3 X 1.34
97		121.6oz	OIL, 20w50

ITEM #	PART #	QTY	DESCRIPTION
106	51604	1	SPACER, TRUNNION
110	70110	1	ASSEMBLY, O-RING & FITTING
		1	O-RING, .468 X .624
		1	FITTING, PLASTIC STRAIGHT
112	70109	1	ASSEMBLY, CAP-VENT
		1	CAP, VENT
		1	VENT, PLASTIC
116	50859	2	RING, RETAINING
117	9004800-2506	2	PIN, STANDARD HEADLESS
118	70778	2	ASSEMBLY, HUB
		1	HUB, 5 STUD (3.6° TAPER)
		5	STUD, 7/16-14 X 1.35 (RIB NECK)
		2	NUT, HEX 3/4-16
		2	PUCK, BRAKE
		1	BOLT, HEX HD 1/4-20 X 1 W/PATCH
		1	ASSEMBLY, BRAKE YOKE
		1	ARM, BRAKE
		2	PIN, BRAKE ACTUATING
		1	NUT, CASTLE 5/16-24
		2	PIN, COTTER 3/32 X 3/4
		1	SPACER, .26 X .57 X .87
		1	PLATE, PUCK
		1	BOLT, HEX HD 1/4-20 X 2 W/PATCH
		1	SPRING, COMPRESSION BRAKE ANTI-DRAG
		1	PIN, SPRING .26 X 1
		1	WASHER, .27 X .88 X .12
		1	SPRING, BRAKE ARM BIAS
		1	O-RING, 2.987 X 3.09
		1	SPRING, RELIEF
		1	BALL, 7/16 IN
		1	SPRING, COMP. BRAKE ANTI-DRAG
		1	ROD, BRAKE PULL
		1	PLUG, 9/16-18 (METAL)
		1	KIT, FAN/PULLEY
		1	NUT, HEX LOCK 1/2-20 W/NYLON INSERT
		1	WASHER, OD SLOTTED .53 X 1.63 X .06
		1	FAN, 7.0 IN (10 BLADE)
		1	PULLEY, 3.86 IN
		2	O-RING, .239 X .379
		1	PIN, SPRING .32 X 1.75
		1	KIT, SEAL & O-RING
		1	SEAL, LIP 15 X 35 X 7
		1	SEAL, LIP 12 X 25 X 7
		1	SEAL, LIP 10 X 25 X 7
		1	O-RING, 1.862 X 2.068
		2	SEAL, LIP 1.0 X 20.49 X .375
		1	SEAL, LIP .875 X 1.375 X .250
		2	O-RING, .239 X .379
		1	KIT, O-RING, MANIFOLD
		1	PIN, SPRING .32 X 1.75
		1	PIN, SPRING .26 X 1
157	50977	1	SCREW, TORX HD 5/16-18
169	51463	1	BEARING, NEEDLE .875 X 1.125 X .75
203	70492	1	WASHER, FLAT .88 X 1.25 X .04



08/22/05 C. GOONAN  
08/31/05 C. GOONAN

P3

REV'D ITEM #111 TO BE #112

ADD'D (QTY 3) 50016 TO ITEM #3 C/S KIT

DEL'D ITEM #2B 71139 KIT, BRAKE BOLT

REV'D ITEM #121 51927 TO 44433

REV'D ITEM #132 51928 TO 51146

REV'D ITEM #55 70538 TO 51315

04/19/06 K. RAWSKI

REV'D ITEM #65 51411 TO 51431

REV'D ITEM #66 51410 TO 51432

08/24/06 J PROBST

ECN #18431