

107606  
345-2400R

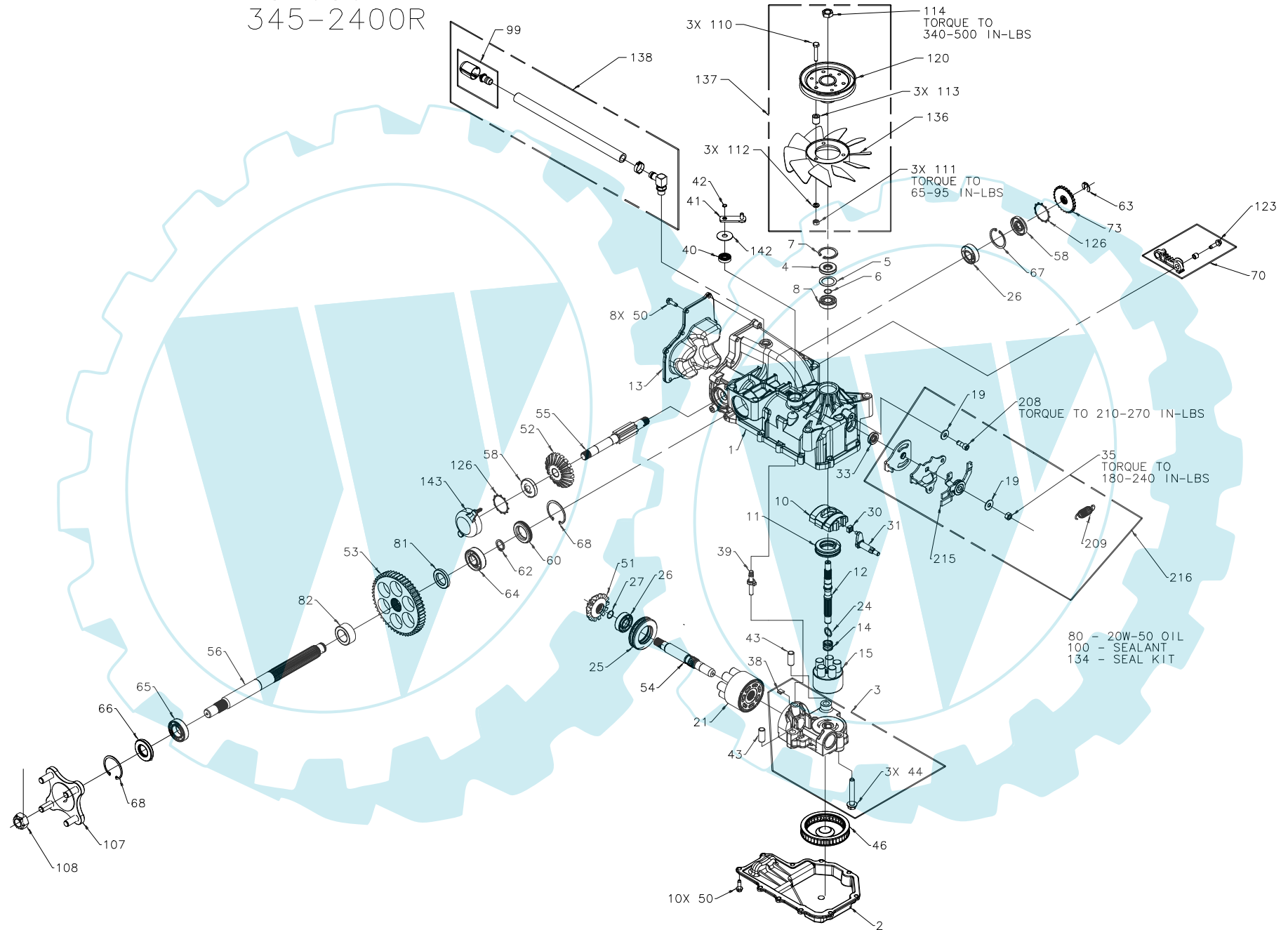

107606  
345-2400R

| ITEM NO. | HYDRO-GEAR PART NO. | QTY. | DESCRIPTION                      |
|----------|---------------------|------|----------------------------------|
| 1        | 70627               | 1    | KIT, HOUSING-MAIN                |
|          |                     | 1    | HOUSING, MAIN                    |
|          |                     | 2    | CRADLE BEARING                   |
|          |                     | 1    | SEAL, LIP 12 X 25 X 7            |
|          |                     | 1    | TRUNNION BUSHING                 |
|          |                     | 1    | SCREW, HFHC 1/4-28 X 7/8 (PATCH) |
| 2        | 50890RM             | 1    | LOWER HOUSING                    |
| 3        | 70679               | 1    | KIT, CENTER SECTION              |
|          |                     | 1    | CENTER SECTION                   |
|          |                     | 1    | BUSHING .67 X 1.03 X .75         |
|          |                     | 1    | PLATE, BYPASS                    |
|          |                     | 3    | SCREW 3/8-24 X 2.5               |
|          |                     | 2    | CHECK PLUG ASSEMBLY, .044        |
| 4        | 9008000-0128        | 1    | LIP SEAL                         |
| 5        | 2003018             | 1    | SPACER                           |
| 6        | 2003016             | 1    | WIRE RETAINING RING              |
| 7        | 2003052             | 1    | RETAINING RING                   |
| 8        | 2003043             | 1    | BALL BEARING                     |
| 10       | 2003087             | 1    | VARIABLE SWASHPLATE              |
| 11       | 50551               | 1    | THRUST BEARING 30 X 52 X 13      |
| 12       | 50005               | 1    | INPUT SHAFT                      |
| 13       | 50891RM             | 1    | COVER-BACK                       |
| 14       | 2003014             | 1    | SPRING, BLOCK                    |
| 15       | 70331               | 1    | 10cc CYLINDER BLOCK ASS'Y        |
|          |                     | 1    | 10cc CYLINDER BLOCK              |
|          |                     | 5    | 10cc PISTON SPRING               |
|          |                     | 5    | PISTON SEAT WASHER               |
|          |                     | 5    | 10cc PISTON                      |
| 19       | 44130               | 2    | WASHER                           |
| 21       | 70082               | 1    | 21cc CYLINDER BLOCK ASS'Y        |
|          |                     | 1    | 21cc CYLINDER BLOCK              |
|          |                     | 7    | 21cc PISTON SPRING               |
|          |                     | 7    | PISTON SEAT WASHER               |
|          |                     | 7    | 10cc PISTON                      |
| 24       | 2003017             | 1    | WASHER, BLOCK THRUST             |
| 25       | 50552               | 1    | THRUST BEARING 42 X 68 X 16      |
| 26       | 50315               | 2    | BALL BEARING                     |
| 27       | 2000022             | 1    | WIRE RETAINING RING              |
| 30       | 2000015             | 1    | SLOT GUIDE                       |
| 31       | 50807               | 1    | TRUNNION ARM                     |
| 33       | 9008000-0126        | 1    | LIP SEAL                         |
| 35       | 52506               | 1    | NUT, LOCK, 5/16-24 UNF           |
| 38       | 70680               | 1    | KIT, BYPASS PLATE                |
| 39       | 2003555             | 1    | BYPASS ACTUATOR                  |
| 40       | 45074               | 1    | LIP SEAL                         |
| 41       | 50270               | 1    | BYPASS ARM                       |
| 42       | 44870               | 1    | RETAINING RING                   |
| 43       | 50002               | 2    | PIN                              |
| 44       | 50016               | 3    | SCREW                            |
| 46       | 50990               | 1    | FILTER                           |
| 50       | 50752               | 18   | SCREW, 1/4-20 X .75 LONG         |
| 51       | 50744               | 1    | 14T BEVEL GEAR                   |
| 52       | 50745               | 1    | 19T BEVEL GEAR                   |

| ITEM NO. | HYDRO-GEAR PART NO. | QTY. | DESCRIPTION                         |
|----------|---------------------|------|-------------------------------------|
| 53       | 50746               | 1    | 53T SPUR GEAR                       |
| 54       | 50757               | 1    | MOTOR SHAFT                         |
| 55       | 51298               | 1    | BRAKE SHAFT                         |
| 56       | 50748               | 1    | AXLE SHAFT                          |
| 58       | 51161               | 2    | SEAL, LIP 70 X 40 X 7               |
| 60       | 50995               | 1    | SEAL PLUG - SIDE                    |
| 62       | 50759               | 1    | RETAINING RING - AXLE               |
| 63       | 51109               | 1    | RING, RETAINING                     |
| 64       | 50743               | 1    | BEARING-BALL 20X47X14(6204)         |
| 65       | 50740               | 1    | BEARING-BALL 25X47X12(6005)         |
| 66       | 50751               | 1    | SEAL                                |
| 67       | 50329               | 1    | RETAINING RING                      |
| 68       | 50760               | 2    | RETAINING RING-AXLE                 |
| 70       | 70392               | 1    | RH, BRAKE ARM SERVICE ASSEMBLY      |
|          |                     | 1    | BRAKE ARM                           |
|          |                     | 1    | CLEVIS PIN                          |
|          |                     | 1    | BUSHING 0.255X0.381X0.330           |
|          |                     | 1    | HEX WASHER HEAD SCREW, 1/4-20 X 7/8 |
| 73       | 50754               | 1    | BRAKE DISC                          |
| 80       |                     | 79oz | 20W-50 OIL                          |
| 81       | 51939               | 1    | WASHER, AXLE 1.04 X 1.65 X .22      |
| 82       | 51940               | 1    | WASHER, AXLE 1.04 X 1.65 X .70      |
| 99       | 70921               | 1    | CAP VENT ASSEMBLY                   |
|          |                     | 1    | CAP, PLASTIC                        |
|          |                     | 1    | VENT, PLASTIC                       |
| 100      | 50928               | 1    | SEALANT                             |
| 107      | 70314               | 1    | HUB ASSEMBLY                        |
|          |                     | 1    | HUB                                 |
|          |                     | 4    | LUG BOLT                            |
| 108      | 50863               | 1    | NUT, HEX 3/4-16                     |
| 110      | 44276               | 3    | SCREW, 1/4-20 X 1-1/2               |
| 111      | 43178               | 3    | NUT, 1/4-20                         |
| 112      | 43177               | 3    | LOCKWASHER                          |
| 113      | 50259               | 3    | SPACER                              |
| 114      | 44133               | 1    | NUT, 1/2-20                         |
| 120      | 50302               | 1    | PULLEY, Ø4.50 X 1.625               |
| 123      | 51576               | 1    | SCREW, HFHC 1/4-28 X 7/8 (PATCH)    |
| 126      | 51316               | 2    | RING, RETAINING                     |
| 134      | 70553               | 1    | KIT, SEAL                           |
|          |                     | 1    | SEAL, LIP 15 X 35 X 7               |
|          |                     | 1    | RING, RETAINING                     |
|          |                     | 1    | SEAL, LIP 12 X 25 X 7               |
|          |                     | 1    | SEAL, LIP 10 X 25 X 7               |
|          |                     | 1    | RING, RETAINING                     |
|          |                     | 2    | SEAL, LIP 17 X 40 X 7               |
|          |                     | 1    | SEAL, LIP 1.85 X .32                |
|          |                     | 1    | RING, RETAINING                     |
|          |                     | 1    | RING, RETAINING .440 EXTERNAL       |
|          |                     | 1    | SEAL, LIP .98 X 1.85 X .276         |
|          |                     | 1    | RING, RETAINING                     |
|          |                     | 2    | RING, RETAINING                     |
|          |                     | 2    | RING, RETAINING                     |

| ITEM NO. | HYDRO-GEAR PART NO. | QTY. | DESCRIPTION                               |
|----------|---------------------|------|---|
| 136      | 50307               | 1    | FAN, 7 INCH, 10 BLADE                     |
| 137      | 70243               | 1    | KIT,FAN/PULLEY                            |
| 138      | 71301               | 1    | KIT, BREATHER                             |
|          |                     | 1    | VENT PLASTIC                              |
|          |                     | 1    | HOSE, .5 X 12                             |
|          |                     | 1    | CLAMP, PINCH 13/16                        |
|          |                     | 1    | 90 9/16 SAE .5 BEAD (METAL)               |
|          |                     | 1    | CAP, PLASTIC                              |
| 142      | 51813               | 1    | WASHER, .39 X 1.27 X .05                  |
| 143      | 51774               | 1    | CAP, BRAKE                                |
| 208      | 51400               | 1    | SCREW, 5/16-24 X (PATCH)                  |
| 209      | 52401               | 1    | SPRING, EXTENSION                         |
| 215      | 52411               | 1    | ASSEMBLY, RTN                             |
| 216      | 70609               | 1    | KIT, RTN                                  |
|          |                     | 2    | WASHER                                    |
|          |                     | 1    | HEX LOCK NUT, 5/16-24 UNJF (NYLON INSERT) |
|          |                     | 1    | SCREW, 5/16-24 X .75 (PATCH)              |
|          |                     | 1    | SPRING EXTENSION                          |
|          |                     | 1    | CONTROL ARM                               |
|          |                     | 1    | ARM RETURN                                |
|          |                     | 1    | ASSEMBLY, RTN                             |



01/12/06 C. GOONAN

P6

ADDED NEW FRAME  
REV'D ITEM 35, P/N 50108  
TO P/N 52506  
REMOVED ITEM 204, P/N 51393,  
QTY 1, DESC ARM, RTN SCISSOR, OUTER  
REMOVED ITEM 205, P/N 51392,  
QTY 1, DESC ARM, RTN SCISSOR, INNER  
REMOVED ITEM 207, P/N 51604,  
QTY 1, DESC SPACER, RTN  
REV'D ITEM 215, P/N 51408,  
QTY 2, DESC WASHER, NYLON TO  
P/N 52411, QTY 1, DESC ASSEMBLY, RTN  
ECN #19694  
09/28/06 R. GAGNON