

033629  
319-3000

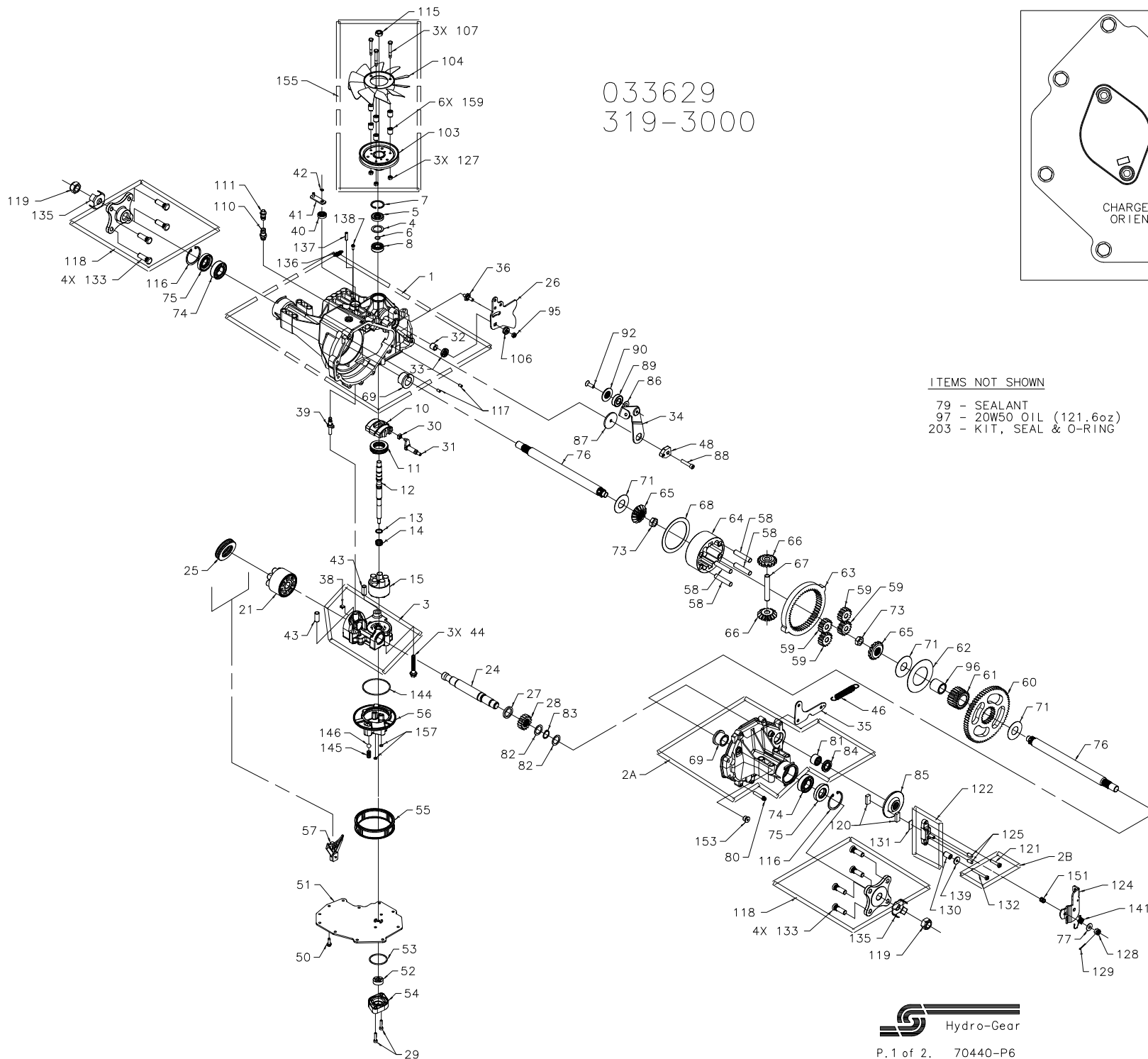
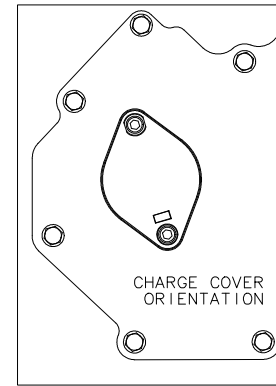

ITEMS NOT SHOWN

- 79 - SEALANT
- 97 - 20W50 OIL (121.6oz)
- 203 - KIT, SEAL & O-RING

033629  
319-3000

ITEM#	PART #	QTY	DESCRIPTION
1	70297	1	ASSEMBLY, MAIN HOUSING
		1	HOUSING, MAIN
		1	SEAL, LIP 12 X 25 X 7
		1	BEARING, FLANGE 1.0 X 1.376 X .99
		1	BEARING, TRUNNION
		2	BEARING, CRADLE
2A	71120	1	ASSEMBLY, RIGHT HAND HOUSING
		1	HOUSING, RIGHT HAND
		1	BEARING, FLANGE 1.0 X 1.376 X .99
		1	BEARING, NEEDLE .875 X 1.125 X 1.5
		1	SEAL, LIP .875 X 1.375 X .250
2B	71139	1	KIT, BRAKE BOLT
		1	BOLT, HEX HD 1/4-20 X 1.25 W/PATCH
		1	BOLT, HEX HD 1/4-20 X 2.25 W/PATCH
3	70687	1	ASSEMBLY, CENTER SECTION
		1	CENTER SECTION
		1	BEARING, JOURNAL .50 X .59 X .50
		1	BEARING, .90 X 1.0 X .75
		1	PLATE, BYPASS
		1	CHECK PLUG ASSEMBLY, .044 BLEED
		1	CHECK PLUG ASSEMBLY, .027 BLEED
		1	SPACER, .98 X 1.37 X .04
4	2003018	1	SEAL, LIP 15 X 35 X 7
5	9008000-0128	1	RING, RETAINING
6	2003016	1	RING, RETAINING
7	2003052	1	RING, RETAINING
8	2003043	1	BEARING, BALL .59 X 1.38 X .43
10	2003087	1	SWASHPLATE, VARIABLE
11	50551	1	BEARING, THRUST 30 X 52 X 13
12	50795	1	SHAFT, INPUT (STD CHARGE)
13	2003017	1	WASHER, THRUST .59 X .79 X .04
14	2003014	1	SPRING, BLOCK
15	70331	1	ASSEMBLY, BLOCK
		1	BLOCK, CYLINDER
		5	PISTON
		5	SPRING, COMPRESSION
		5	WASHER, THRUST
21	70082	1	ASSEMBLY, BLOCK
		1	BLOCK, CYLINDER
		7	PISTON
		7	SPRING, COMPRESSION
		7	WASHER, THRUST
24	50662	1	SHAFT, MOTOR
25	50552	1	BEARING, THRUST 42 X 68 X 16
26	51250	1	ARM, CONTROL
27	50774	1	SPACER, 1.03 X 1.38 X .184
28	50661	1	GEAR, 16T PINION
29	50975	2	SCREW, CAP M6 X 1 X 25
30	2000015	1	GUIDE, SLOT
31	50807	1	ARM, TRUNNION TAPERED SQUARE
32	2003009	1	BEARING, TRUNNION
33	9008000-0126	1	SEAL, LIP 12 X 25 X 7
34	51127	1	ARM, RETURN
35	51183	1	BRACKET, DAMPER
36	50426	1	STUD, SHORT 5/16-24
38	70680	1	KIT, BYPASS PLATE
39	2003555	1	ACTUATOR, BYPASS

ITEM#	PART #	QTY	DESCRIPTION
40	45074	1	SEAL, LIP 10 X 25 X 7
41	50270	1	ARM, BYPASS
42	44870	1	RING, RETAINING
43	50002	2	PIN, HOLLOW .39 X .50 X 1.12
44	50016	3	SCREW, HEX FLANGE 3/8-24 X 2.5
46	51199	1	SPRING, 4 IN RETURN (MEDIUM)
48	51097	1	PUCK, ADJUSTING
50	50752	11	SCREW, HEX FLANGE 1/4-20 X .75
51	50972	1	COVER, LOWER W/ 2 KIDNEYS
52	50273	1	GEROTOR
53	9004101-1340	1	O-RING, 1.862 X 2.068
54	50260	1	HOUSING, CHARGE PUMP
55	70538	1	KIT, FILTER
		2	GASKET, 4.24 X 4.40 X .10
		1	FILTER, STD CHARGE
		1	MANIFOLD, CHARGE
56	51156	1	BEARING, MOTOR RETAINER
57	50796	1	PIN, CARRIER
58	50776	4	GEAR, 15T PLANET
59	50763	4	GEAR, 67T SPUR
60	50646	1	GEAR, 21T SUN
61	50645	1	WASHER, THRUST 2.32 X 4.10 X .05
62	50769	1	GEAR, 51T RING
63	50764	1	CARRIER, PLANETARY
64	50765	1	GEAR, 14T MITER (SPLINED)
65	50647	2	GEAR, 14T MITER (UNSPLINED)
66	50648	2	SHAFT, DIFFERENTIAL
67	50766	1	WASHER, THRUST 3.46 X 4.39 X .05
68	50767	2	BEARING, FLANGE 1.0 X 1.376 X .99
69	50768	3	WASHER, 1.0 X 2.25 X .04
70	50769	2	NUT, HEX 5/8-18 W/ PATCH
71	50771	2	BEARING, BALL 25.4 X 52 X 15
72	50772	2	SEAL, LIP 1.0 X 2.049 X .375
73	50773	2	SHAFT, AXLE, 1.0 X 13.84 (30° SPLINED)
74	50774	1	WASHER, .34 X .88 X .06
75	50825	10, 10z	SEALANT
76	50825	9	SCREW, TORX HD 5/16-18 X 1.5
77	44130	1	BEARING, NEEDLE .875 X 1.125 X 1.5
78	50928	2	WASHER, FLAT .88 X 1.25 X .04
79	50928	1	RING, RETAINING
80	50868	1	SEAL, LIP .875 X 1.375 X .250
81	44752	1	DISK, BRAKE
82	50777	1	WASHER, .51 X 1.0 X .03
83	50775	1	SPACER, .32 X 1.96 X .15
84	50773	1	SCREW, SOCKET HD CAP 5/16-24 X 1.5
85	50779	1	BEARING, BALL .62 X 1.38 X .44
86	50132	1	SPACER, LOCATING
87	50836	1	SCREW, COUNTERSUNK 5/16-18 X 1.0
88	50837	1	NUT, HEX LOCK 5/16-24
89	44147	1	BEARING, SLEEVE 1.0 X 1.3 X 1.34
90	51200	1	OIL, 20W50
91	50870	121, 60z	PULLEY, 4.5 IN
92	50108	1	FAN, 7.0 IN (10 BLADE)
93	50866	1	SPACER, TRUNNION
94	50302	3	BOLT, HEX HD 1/4-20 X 2.00 W/ PATCH
95	50108	1	ASSEMBLY, O-RING & FITTING
96	50866	1	O-RING, .468 X .624
97	50302	1	FITTING, PLASTIC STRAIGHT
98	103	1	
99	104	1	
100	106	1	
101	107	1	
102	110	1	

ITEM#	PART #	QTY	DESCRIPTION
111	70109	1	ASSEMBLY, CAP-VENT
		1	CAP, VENT
		1	VENT, PLASTIC
115	44133	1	HEX NUT 1/2-20 W/ PATCH
116	50859	2	RING, RETAINING
117	9004800-2506	2	PIN, STANDARD HEADLESS
118	70314	2	ASSEMBLY, HUB
		1	HUB, 4 STUD (PAINTED)
		4	STUD, 1/2-20 X 1.55 (RIB NECK)
		2	NUT, HEX LOCK 3/4-16
119	50863	2	PUCK, BRAKE
120	44132	1	BOLT, HEX HD 1/4-20 X 1.25 W/PATCH
121	51927	1	ASSEMBLY, BRAKE YOKE
122	70633	1	ARM, BRAKE
124	50916	2	PIN, BRAKE ACTUATING
125	44127	3	NUT, HEX 1/4-20
127	43178	1	NUT, CASTLE 5/16-24
128	44142	1	PIN, COTTER 3/32 X 3/4
129	44101	1	SPACER, .26 X .57 X .87
130	23711	1	PLATE, PUCK
131	44134	1	BOLT, HEX HD 1/4-20 X 2.25 W/PATCH
132	51928	8	STUD, 1/2-20 X 1.55 (RIB NECK)
133	44431	2	SPINDLE CUP
135	51197	1	SPRING, BYPASS 1.33 IN EXTENSION
136	50384	1	PIN, SPRING .26 X 1
137	50882	1	BOLT, SELF TAPPING 10-32 X .5
138	50853	1	WASHER, .27 X .88 X .12
139	44278	1	SPRING, BRAKE ARM BIAS
141	50884	1	O RING, 2.987 X 3.09
144	50974	1	SPRING, RELIEF
145	51157	1	BALL, 7/16 IN
146	9001214-4400	1	SPRING, COMP. BRAKE ANTI-DRAG
151	50919	1	PLUG, 9/16-18 (METAL)
153	9005110-5600	1	O-RING, .239 X .309
157	50977	2	KIT, FAN/PULLEY
155	70488	1	NUT, HEX 1/2-20 W/ PATCH
		3	BOLT, HEX HD 1/4-20 X 2.00 W/PATCH
		1	FAN, 7.0 IN (10 BLADE)
		6	SPACER, .571 X .260 X .618
		1	PULLEY, 4.5 IN
		3	NUT, 1/4-20
		1	KIT, SEAL & O-RING
203	70492	1	SEAL, LIP 15 X 35 X 7
		1	SEAL, LIP 12 X 25 X 7
		1	SEAL, LIP 10 X 25 X 7
		1	O-RING, 1.862 X 2.068
		2	SEAL, LIP 1.0 X 2.049 X .375
		1	SEAL, LIP .875 X 1.375 X .250
		2	O-RING, .239 X .309
		2	O-RING, .408 X .624
		1	KIT, MANIFOLD O-RING