

015679
329-2400L

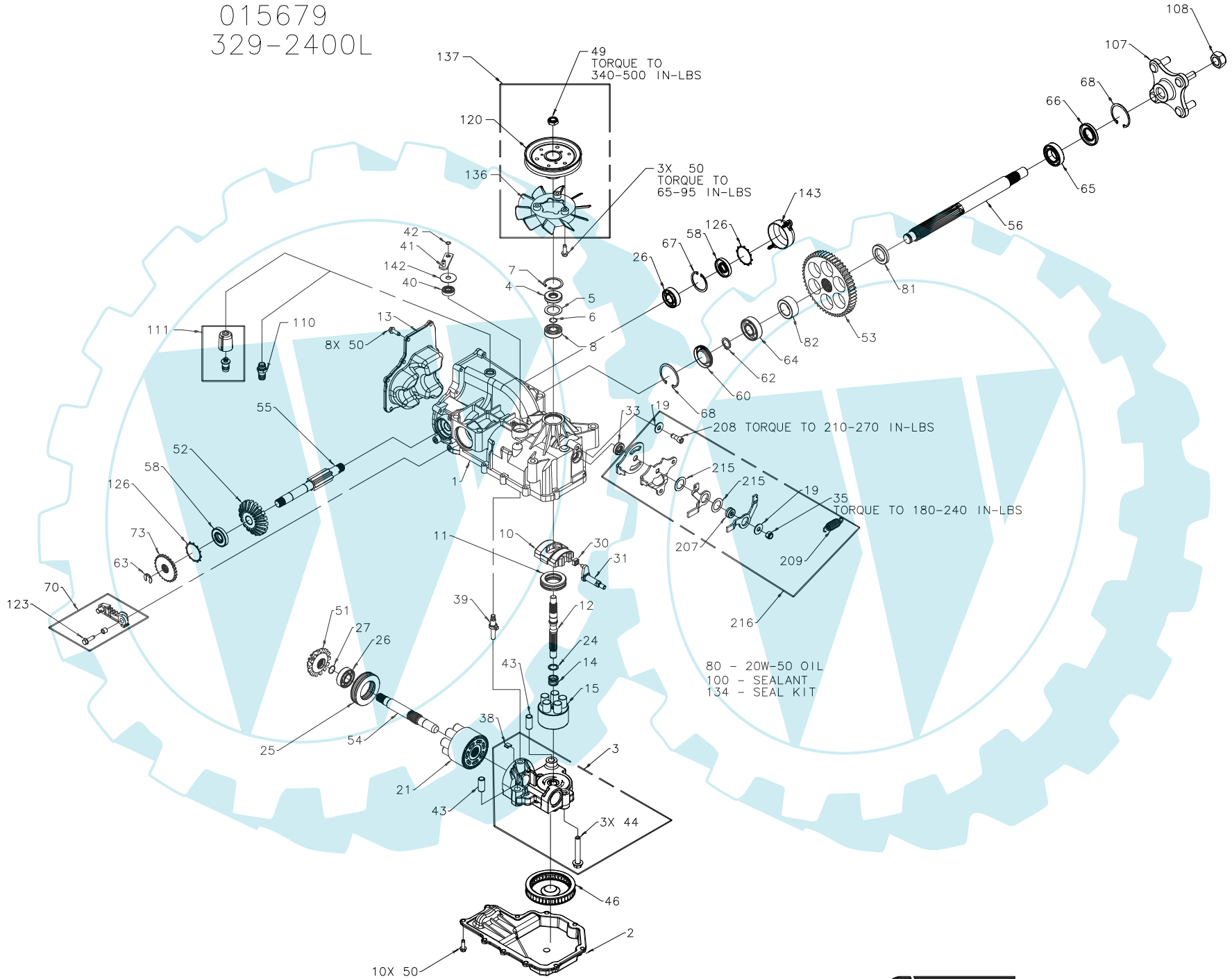

015679
329-2400L

ITEM NO.	HYDRO-GEAR PART NO.	QTY.	DESCRIPTION	ITEM NO.	HYDRO-GEAR PART NO.	QTY.	DESCRIPTION	ITEM NO.	HYDRO-GEAR PART NO.	QTY.	DESCRIPTION
1	70627	1	KIT, HOUSING-MAIN	62	50759	1	RETAINING RING - AXLE	142	51813	1	WASHER, .39 X 1.27 X .05
		1	HOUSING, MAIN	63	51109	1	RING, RETAINING	143	51774	1	CAP, BRAKE
		2	CRADLE BEARING	64	50743	1	BEARING-BALL 20X47X14(6204)	207	51604	1	SPACER, RTN
		1	SEAL, LIP 12 X 25 X 7	65	50740	1	BEARING-BALL 25X47X12(6005)	208	51400	1	SHCS 5/16-24 X .75 (PATCH)
		1	TRUNNION BUSHING	66	50751	1	SEAL	209	52401	1	SPRING, EXTENSION
		1	SCREW, HFHC 1/4-28 X 7/8 (PATCH)	67	50329	1	RETAINING RING	215	51408	2	WASHER, PLASTIC 1.19 X .7
2	50890RM	1	LOWER HOUSING	68	50760	2	RETAINING RING-AXLE	216	70609	1	KIT, RTN
3	70679	1	KIT, CENTER SECTION	70	70391	1	LH BRAKE ARM SERVICE ASSEMBLY			2	WASHER
		1	CENTER SECTION			1	BRAKE ARM			1	HEX LOCK NUT, 5/16-24 UNJF (NYLON INSERT)
		1	BUSHING .67 X 1.03 X .75			1	CLEVIS PIN			1	SPACER, RTN
		1	PLATE, BYPASS			1	BUSHING 0.255X0.381X0.330			1	SCREW, 5/16-24 X .75 (PATCH)
		3	SCREW 3/8-24 X 2.5	73	50754	1	HEX WASHER HEAD SCREW, 1/4-20 X 7/8			1	SPRING, EXTENSION
		2	CHECK PLUG ASSEMBLY, .044	80		79oz	BRAKE DISC			2	WASHER, NYLON
4	9008000-0128	1	LIP SEAL	81	51939	1	SPACER, 1.04 X 1.65 X .22			1	CONTROL ARM
5	2003018	1	SPACER	82	51940	1	SPACER, 1.04 X 1.65 X .70			1	ARM, RTN SCISSOR, OUTER
6	2003016	1	WIRE RETAINING RING	100	50928	1	SEALANT			1	ARM, RTN SCISSOR, INNER
7	2003052	1	RETAINING RING	107	70314	1	HUB ASSEMBLY			1	ARM, RETURN
8	2003043	1	BALL BEARING			1	HUB				
10	2003087	1	VARIABLE SWASHPLATE			4	LUG BOLT				
11	50551	1	THRUST BEARING 30 X 52 X 13	108	50863	1	NUT, HEX 3/4-16				
12	50005	1	INPUT SHAFT	110	70110	1	FITTING O-RING ASSEMBLY				
13	50891RM	1	COVER-BACK			1	VENT, PLASTIC				
14	2003014	1	SPRING, BLOCK			1	O-RING .08 X .468 70A				
15	70331	1	10cc CYLINDER BLOCK ASS'Y	111	70921	1	CAP VENT ASSEMBLY				
		1	10cc CYLINDER BLOCK			1	CAP, PLASTIC				
		5	10cc PISTON SPRING			1	CAP-POPPET VALVE				
		5	PISTON SEAT WASHER	120	50302	1	PULLEY, Ø4.50 X 1.625				
		5	10cc PISTON	123	51076	1	SCREW, HFHC 1/4-28 X 7/8 (PATCH)				
19	44130	2	WASHER	126	51316	2	RING, RETAINING				
21	70082	1	21cc CYLINDER BLOCK ASS'Y	134	70553	1	KIT, SEAL				
		1	21cc CYLINDER BLOCK			1	SEAL, LIP 15 X 35 X 7				
		7	21cc PISTON SPRING			1	RING, RETAINING				
		7	PISTON SEAT WASHER			1	SEAL, LIP 12 X 25 X 7				
		7	10cc PISTON			1	SEAL, LIP 10 X 25 X 7				
24	2003017	1	WASHER, BLOCK THRUST			1	RING, RETAINING				
25	50552	1	THRUST BEARING 42 X 68 X 16			2	SEAL, LIP 17 X 40 X 7				
26	50315	2	BALL BEARING			1	SEAL, LIP 1.85 X .32				
27	2000022	1	WIRE RETAINING RING			1	RING, RETAINING				
30	2000015	1	SLOT GUIDE			1	RING, RETAINING .440 EXTERNAL				
31	50807	1	TRUNNION ARM			1	SEAL, LIP .98 X 1.85 X .276				
33	9008000-0126	1	LIP SEAL			1	RING, RETAINING				
35	50317	1	NUT			2	RING, RETAINING				
38	70680	1	KIT, BYPASS PLATE			2	RING, RETAINING				
39	2003555	1	BYPASS ACTUATOR	136	51365	1	FAN, 6 INCH				
40	45074	1	LIP SEAL	137	70591	1	KIT, FAN/PULLEY				
41	50270	1	BYPASS ARM								
42	44870	1	RETAINING RING								
43	50002	2	PIN								
44	50016	3	SCREW								
46	50990	1	FILTER								
49	51244	1	HEX LOCK NUT, 1/2-20 (NYLON INSERT)								
50	50752	21	SCREW, 1/4-20 X .75 LONG								
51	50744	1	14T BEVEL GEAR								
52	50745	1	19T BEVEL GEAR								
53	50746	1	53T SPUR GEAR								
54	50757	1	MOTOR SHAFT								
55	51298	1	BRAKE SHAFT								
56	50748	1	AXLE SHAFT								
58	51161	2	SEAL, LIP 17 X 40 X 7								
60	50995	1	SEAL PLUG - SIDE								

