

01008192
344-2400L

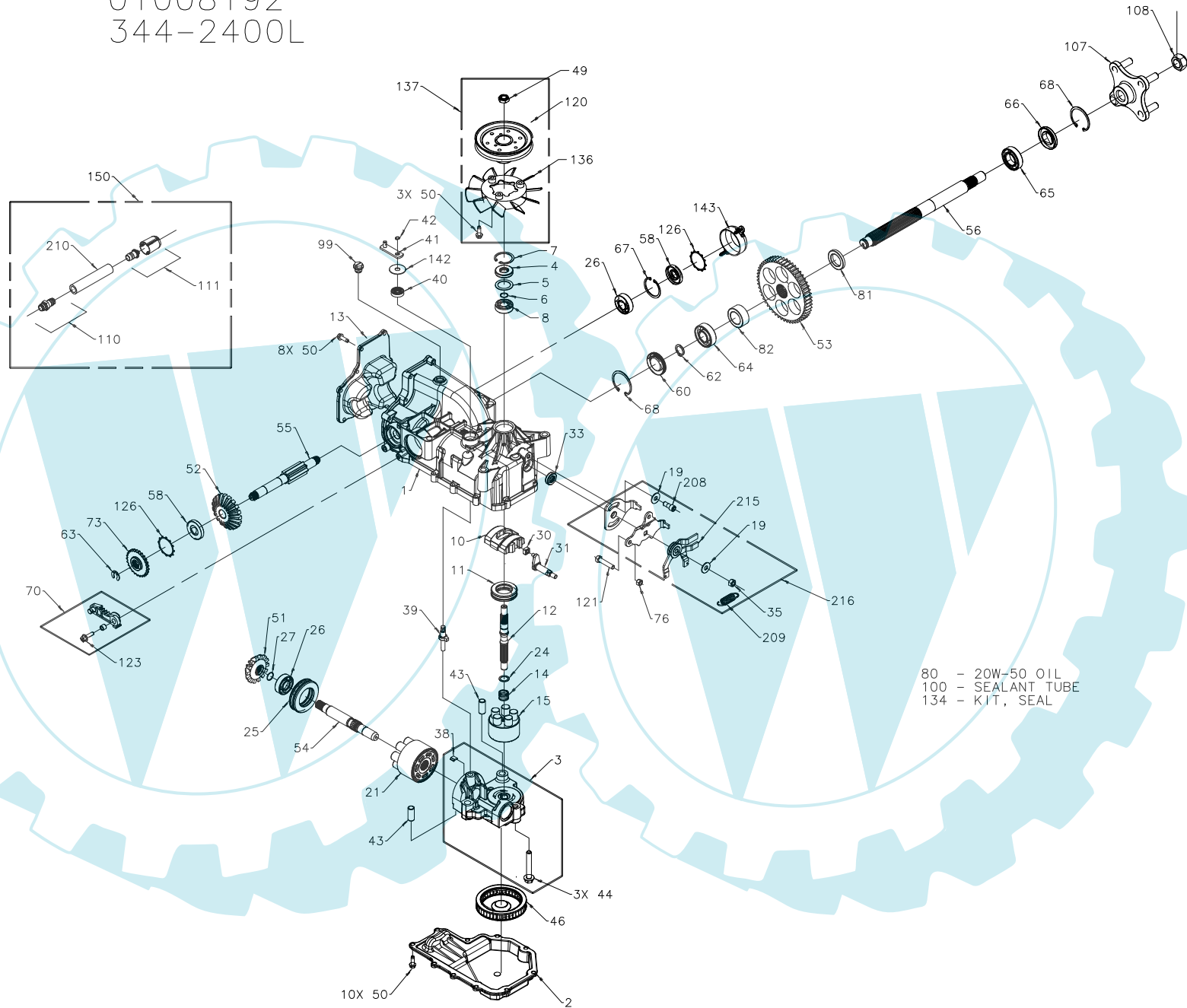

80 - 20W-50 OIL
100 - SEALANT TUBE
134 - KIT, SEAL

01008192
344-2400L

ITEM #	PART #	QTY	DESCRIPTION	ITEM #	PART #	QTY	DESCRIPTION	ITEM #	PART #	QTY	DESCRIPTION
1	70627	1	KIT, HOUSING-MAIN	43	50002	2	PIN, HOLLOW .39 X .5 X 1	126	51316	2	RING, RETAINING
		1	HOUSING, MAIN	44	50016	3	BOLT, HEX FLANGE 3/8-24 X 2.5	134	70553	1	KIT, SEAL
		2	CRADLE BEARING	46	50990	1	FILTER			1	SEAL, LIP 15 X 35 X 7
		1	TRUNNION BUSHING	49	51244	1	HEX LOCK NUT 1/2-20 (NYLON INSERT)			1	RING, RETAINING 37 INT
		1	SEAL, LIP 12 X 25 X 7	50	50752	21	SCREW, 1/4-20 X .75			1	SEAL, LIP 12 X 25 X 7
2	50890RM	1	SCREW, HFHC 1/4-28 X 7/8 (PATCH)	51	50744	1	14T BEVEL GEAR			1	SEAL, LIP 10 X 25 X 7
3	70667	1	LOWER HOUSING	52	50745	1	19T BEVEL GEAR			18	RING, RETAINING .31 EXT
		1	KIT, CENTER SECTION	53	50746	1	53T SPUR GEAR			1	HFCS 1/4-20 X .75
		1	CENTER SECTION	54	50757	1	SHAFT, MOTOR			1	SEAL PLUG
		1	BUSHING .67 X 1.03 X .75	55	51298	1	SHAFT, BRAKE			1	RING, RETAINING .75 EXT
		1	PLATE, BYPASS	56	50748	1	SHAFT, AXLE			1	RING, RETAINING .440 EXT
		3	BOLT,HEX FLANGE 3/8-24 X 2.5	58	51161	2	SEAL, LIP 70 X 40 X 7			1	SEAL, LIP 25 X 47 X 7
		2	CHECK PLUG ASSEMBLY, .027	60	50995	1	SEAL PLUG - SIDE			1	RING, RETAINING 1.56 INT
4	9008000-0128	1	SEAL, LIP 15 X 35 X 7	62	50759	1	RING, RETAINING - AXLE	136	51365	1	RING, RETAINING 1.87 INT
5	2003018	1	SPACER	63	51109	1	RING, RETAINING	137	70591	2	RING, RETAINING 1.43
6	2003016	1	RING, WIRE RETAINING	64	50743	1	BEARING-BALL 20X47X14(6204)				
7	2003052	1	RING, RETAINING	65	50740	1	BEARING-BALL 25X47X12(6005)				
8	2003043	1	BALL BEARING	66	50751	1	SEAL, LIP 25 X 47 X 7				
10	2003087	1	VARIABLE SWASHPLATE	67	50329	1	RING, RETAINING				
11	50551	1	THRUST BEARING 30 X 52 X 13	68	50760	2	RING,RETAINING -AXLE	142	51813	1	FAN, 6", 10 BLADE
12	50005	1	SHAFT, INPUT	70	70391	1	LH BRAKE ARM SERVICE ASSEMBLY	143	51774	1	KIT, FAN-PULLEY
13	50891RM	1	COVER-BACK			1	ARM, BRAKE ZINC	150	71004	3	SCREW, 1/4-20 X .75
14	2003014	1	SPRING, BLOCK			1	CLEVIS PIN			1	FAN, 6", 10 BLADE
15	70331	1	10cc CYLINDER BLOCK ASS'Y			1	BUSHING .255 X .394 X .330			1	HEX LOCK NUT 1/2-20 (NYLON INSERT)
		1	10cc CYLINDER BLOCK			1	SCREW, HFHC 1/4-28 X 7/8 (PATCH)			1	PULLEY, ø4.5 X 1.625
		5	10cc PISTON SPRING			1	SCREW, HFHC 1/4-28 X 7/8 (PATCH)			1	WASHER, .39 X 1.27 X .05
		5	PISTON SEAT WASHER			1	SCREW, HFHC 1/4-28 X 7/8 (PATCH)			1	CAP, BRAKE
		5	10cc PISTON			1	SCREW, HFHC 1/4-28 X 7/8 (PATCH)			1	KIT, BREATHER
19	44130	2	WASHER, .34 X .88 X .06			1	SCREW, HFHC 1/4-28 X 7/8 (PATCH)			1	VENT, PLASTIC
21	70082	1	21cc CYLINDER BLOCK ASS'Y	73	50754	1	SCREW, HFHC 1/4-28 X 7/8 (PATCH)	208	51400	1	O-RING .08 X .468 70A
		1	21cc CYLINDER BLOCK	76	43083	1	SCREW, HFHC 1/4-28 X 7/8 (PATCH)	209	51833	1	CAP-POPPET VALVE
		7	21cc PISTON SPRING			1	SCREW, HFHC 1/4-28 X 7/8 (PATCH)	210	51401	1	HOSE .5 X 4
		7	PISTON SEAT WASHER			1	SCREW, HFHC 1/4-28 X 7/8 (PATCH)	215	52411	2	ASSEMBLY, RTN
		7	21cc PISTON	80		79oz	20W-50 OIL	216	71465	1	KIT, RTN SCISSOR
				81	51939	1	SPACER, 1.04 X 1.65 X .22			2	WASHER, .34 X .88 X .06
				82	51940	1	SPACER, 1.04 X 1.65 X .70			1	NUT, LOCK 5/16-24 UNF
24	2003017	1	WASHER, BLOCK THRUST	99	9005200-5600	1	PLUG, PLASTIC			1	ARM, RTN
25	50552	1	THRUST BEARING 42 X 68 X 16	100	50928	1	SEALANT TUBE, 10.3 oz			1	ARM, CONTROL
26	50315	2	BALL BEARING	107	70314	1	HUB ASSEMBLY			1	SPRING, EXTENSION
27	2000022	1	RING, WIRE RETAINING			1	HUB			1	SHCS 5/16-24 X .75 (PATCH)
30	2000015	1	SLOT GUIDE			1	LUG BOLT			1	ASSEMBLY, RTN
31	50807	1	TRUNNION ARM			4	NUT, HEX 3/4-16				
33	9008000-0126	1	SEAL, LIP 12 X 25 X 7	108	50863	1	SCREW, HFHC 1/4-28 X 7/8 (PATCH)				
35	52506	1	NUT, LOCK 5/16-24 UNF	110	70110	1	SCREW, HFHC 1/4-28 X 7/8 (PATCH)				
38	70680	1	KIT, BYPASS PLATE			1	SCREW, HFHC 1/4-28 X 7/8 (PATCH)				
		1	PLATE, BYPASS (BREAD)			1	SCREW, HFHC 1/4-28 X 7/8 (PATCH)				
		1	PLATE, BYPASS	111	70921	1	SCREW, HFHC 1/4-28 X 7/8 (PATCH)				
39	2003555	1	BYPASS ACTUATOR			1	SCREW, HFHC 1/4-28 X 7/8 (PATCH)				
40	45074	1	SEAL, LIP 10 X 25 X 7			1	SCREW, HFHC 1/4-28 X 7/8 (PATCH)				
41	50270	1	ARM, BYPASS	120	50302	1	SCREW, HFHC 1/4-28 X 7/8 (PATCH)				
42	44870	1	RING, RETAINING	121	51753	1	SCREW, HFHC 1/4-28 X 7/8 (PATCH)				
				123	51576	1	SCREW, HFHC 1/4-28 X 7/8 (PATCH)				

P5

ADDED NEW FRAME

REMOVED ITEM 3, P/N 51392,
QTY 1, DESC ARM, RTN SCISSOR, INNER

REMOVED ITEM 4, P/N 51393,
QTY 1, DESC ARM, RTN SCISSOR, OUTER

REMOVED ITEM 207, P/N 51604,
QTY 1, DESC SPACER, RTN

REV'D ITEM 215, P/N 51408,
QTY 2, DESC WASHER, NYLON TO

P/N 52411, QTY 1, DESC ASSEMBLY, RTN

REV'D ITEM 35, P/N 50108
TO P/N 52506

ECN #19694

09/27/06 R.GAGNON

10/02/06 R.GAGNON