

# 42" Snow Blade Model No. LR010AR

## BRACKET ASSEMBLY

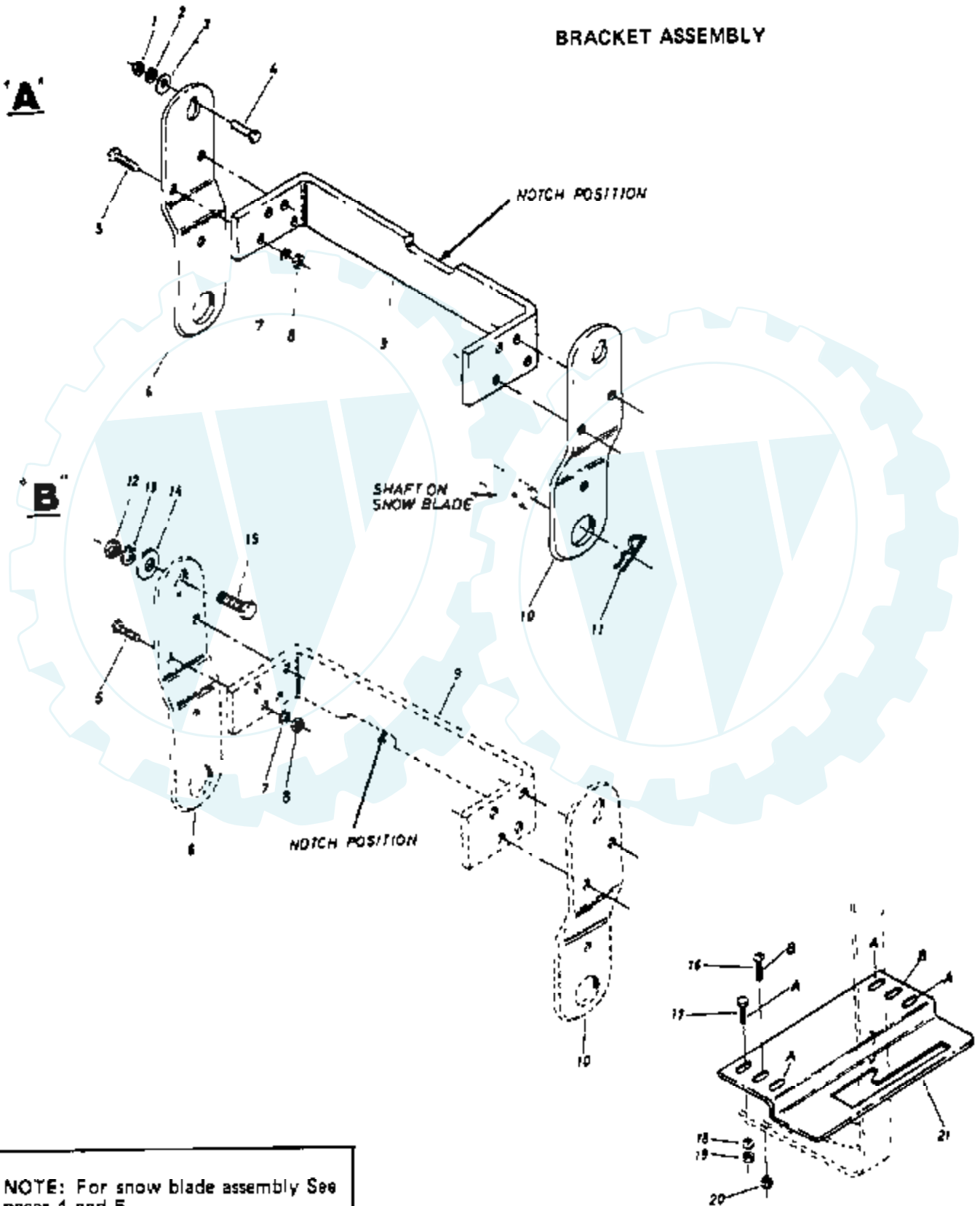

| Ref # | Part Number | Qty | Description     |
|-------|-------------|-----|-----------------|
| 1     | 43082       |     | LOCKNUT         |
| 2     | 43003       |     | WASHER          |
| 3     | 43070       |     | WASHER          |
| 4     | 43001       |     | BOLT            |
| 5     | 43063       |     | BOLT            |
| 6     | 23141       |     | MOUNTING BRKT   |
| 7     | 43086       |     | WASHER          |
| 8     | 43064       |     | NUT             |
| 9     | 23143       |     | CROSS TIE BRKT  |
| 10    | 23142       |     | MOUNTING BRKT   |
| 11    | 43343       |     | HAIR PIN COTTER |
| 12    | 43262       |     | NUT             |
| 13    | 43353       |     | LOCKWASHER      |
| 14    | 43352       |     | FLATWASHER      |
| 15    | 43351       |     | BOLT            |
| 16    | 43346       |     | BOLT            |
| 17    | 43012       |     | BOLT            |
| 18    | 43177       |     | LOCKWASHER      |
| 19    | 43178       |     | NUT             |
| 20    | 43347       |     | NUT             |
| 21    | 23127       |     | LIFT LOCK PLATE |
|       | 43776       |     | OWNER'S MANUAL  |

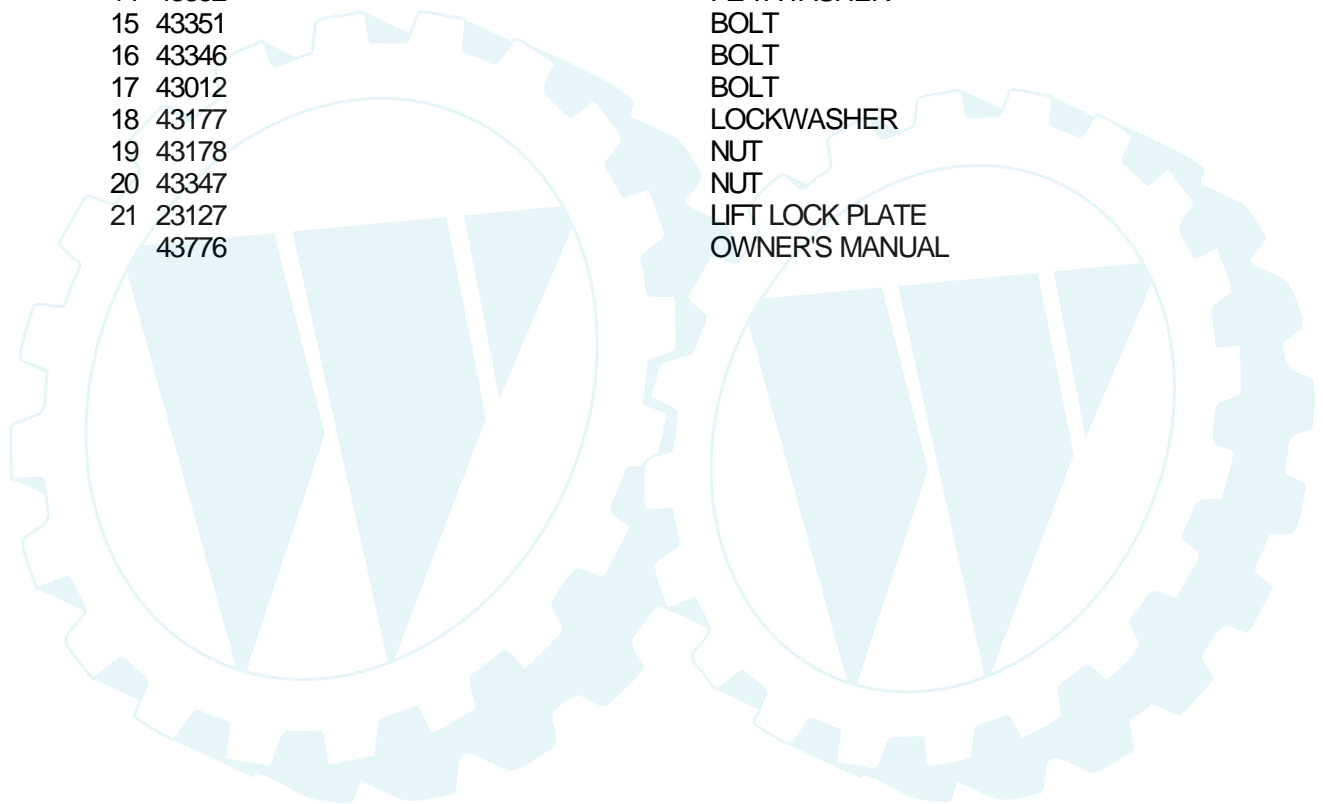

# SUPPLEMENT SHEET

Form No 44381 (10/88)

DATE October 1, 1988

SUBJECT Revisions on pages

12 and 13 42" Snow Blade

Attachment LR010BR

**USE THIS SUPPLEMENT SHEET INSTEAD OF YOUR OWNER'S MANUAL, FOR PAGES 12 AND 13, LINE 3 ON PAGE 9.**

Replace line 3 on page 9 of the LR010AR snow blade owner's manual with the following:

- 3 Remove eyebolt from right hand side of tractor. Use caution when loosening eyebolt as there is some spring tension. Discard eyebolt and hardware. Assemble left hand mounting bracket (B) to left side of lawn tractor frame using one 1/2" x 1.25" hex head bolt (E), one 1/2" flatwasher (F), one 1/2" lockwasher (G), and one 1/2" hex lock nut (H). Assemble one 3/8" hex lock nut (L) and one 1/2" flatwasher (F) to eyebolt (M). Hook eyebolt (M) to spring and assemble through the right hand side of lawn tractor frame and right hand mounting bracket. Assemble one 1/2" flatwasher (F), one 1/2" lockwasher (G), and one 3/8" hex lock nut (L). See Figures 6, 15, 15A (Below), 16, and parts drawing "B" on page 12 of this supplement sheet. **DO NOT TIGHTEN.**

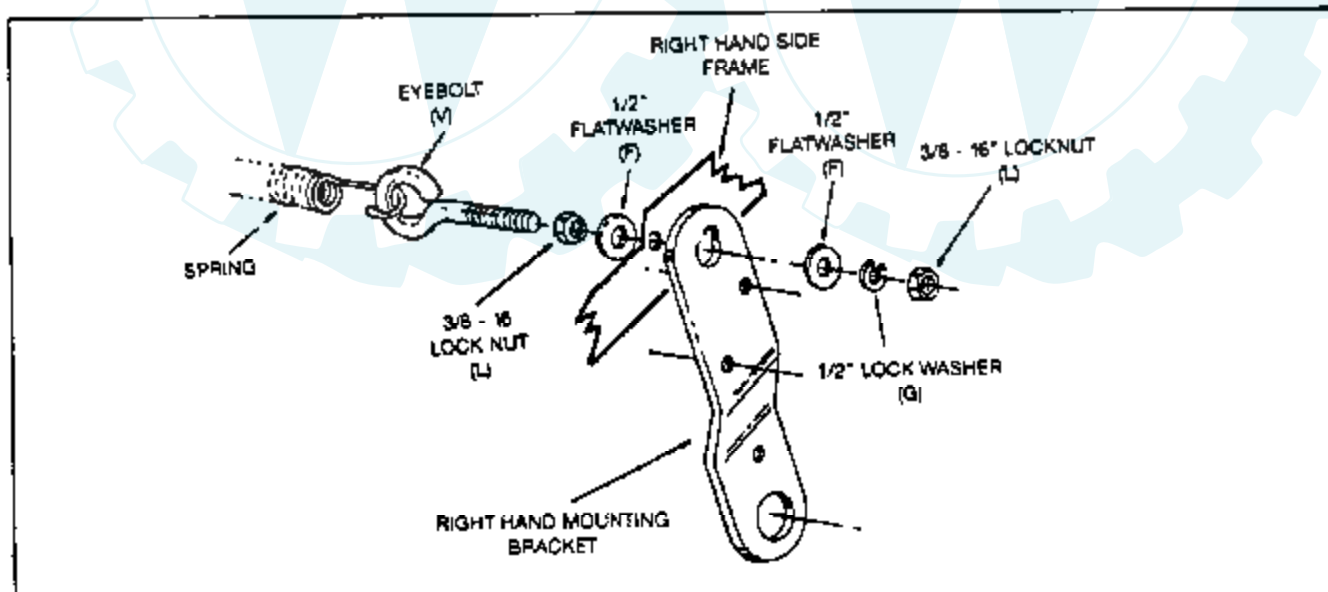

FIGURE 15A

**ROPER**

**OUTDOOR POWER PRODUCTS**  
DIVISION OF ROPER CORPORATION

---

| Ref # | Part Number | Qty | Description |
|-------|-------------|-----|-------------|
|-------|-------------|-----|-------------|

---

REFER TO IMAGE

