

ROPER LT 12 HYDROSTATIC LAWN TRACTOR--MODEL NUMBER LTH120AR CHASSIS AND ENCLOSURES

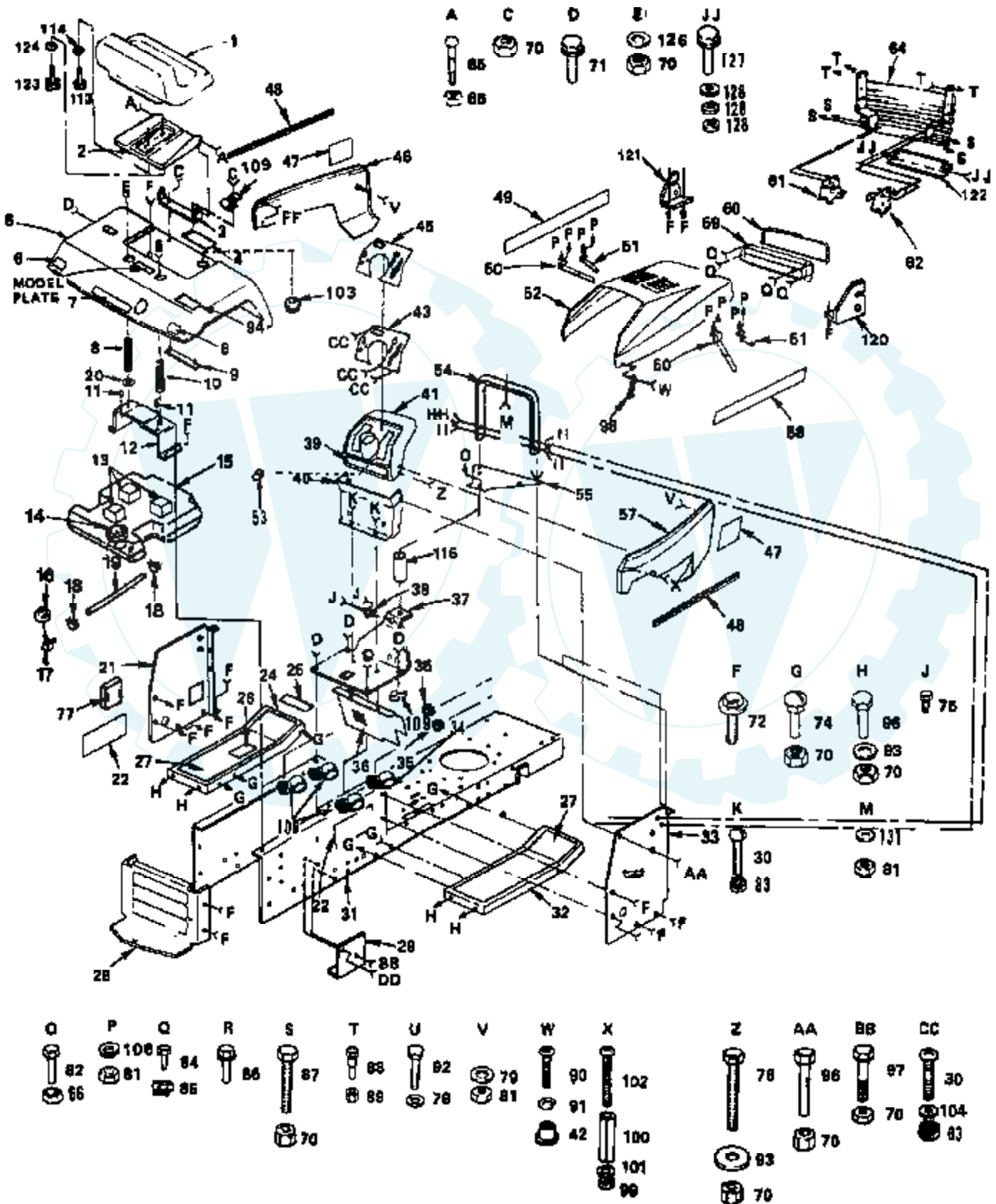

| Ref # | Part Number | Qty | Description |
|-------|-------------|-----|-------------------|
| 1 | 110839X | | SUB= 140119 |
| 2 | 121069X | | SUB= 155925 |
| 3 | 105513X | | SUB= 140551 |
| 4 | 106974X | | SUB= 133796 |
| 5 | 109593X388 | | SUB= 121642X417 |
| 6 | 106202X | | REFLECTOR-TAIL YT |
| 7 | 104810X | | NLA |
| 8 | 121068X | | SPRING T |
| 9 | 105511X | | SUB= 140675 |
| 10 | 121067X | | SPRING T |
| 11 | 105531X | | NUT-PUSH YT |
| 12 | 105509X | | SUB= 137113 |
| 13 | 6431J | | PAD-SPACER T |
| 14 | 109462X | | SUB= 158990 |
| 15 | 106020X | | SUB= 151346 |
| 16 | 3645J | | BUSHING OUTLET T |
| 17 | 8710J | | FUEL TANK STEM GT |
| 18 | 6999R | | SUB= 123487X |
| 19 | 5277J | | SUB= 8543R |
| 20 | 120609X | | SHIM WASHER T |
| 21 | 105523X | | DASH PANEL T |
| 22 | 104808X | | NLA |
| 24 | 105465X | | SUB= 145244X417 |
| 25 | 4900J | | DECAL T |
| 26 | 109069X | | NLA |
| 27 | 109864X | | SUB= 108256X |
| 28 | 102481X | | SUB= 145009 |
| 29 | 109219X | | DEFLECTOR HYT |
| 30 | 74180512 | | SCREW |
| 31 | 109512X | | CHASSIS T |
| 32 | 105464X | | SUB= 145243X417 |
| 33 | 110828X | | SUB= 133748 |
| 34 | 5320R | | INSUL CLIP T |
| 35 | 110436X | | SUB= 9151R |
| 36 | 109252X | | SHIELD HYT |
| 37 | 108106X | | SADDLE HYT |
| 38 | 1554J | | SUB= 155108 |
| 39 | 108635X | | NLA |
| 40 | 104805X | | LOWER DASH |
| 41 | 108396X | | SUB= 121312X |
| 42 | 2029J | | WELDNUT |
| 43 | 110846X | | PLATE - DASH |
| 45 | 120587X | | DECAL - DASH |
| 46 | 108372X388 | | SUB= 150302X505 |
| 47 | 120581X | | NLA |
| 48 | 106464X | | SUB= 108249X |
| 49 | 104643X | | NLA |
| 50 | 106784X | | SUB= 155013 |
| 51 | 104618X | | SUB= 155013 |
| 52 | 108370X388 | | SUB= 150301X505 |
| 53 | 5479J | | PLUG BUTTON T |
| 54 | 110829X | | SUB= 124130X |
| 55 | 106965X | | SUB= 140181 |
| 57 | 108371X388 | | SUB= 140679X505 |
| 58 | 104644X | | NLA |
| 59 | 104613X | | SUB= 147717 |
| 60 | 106395X | | LENS LT |
| 61 | 110855X | | SUPPORT LH YTH |

| Ref # | Part Number | Qty | Description |
|-------|-------------|-----|--------------------|
| 62 | 110854X | | SUPPORT RH YTH |
| 64 | 104628X | | GRILL GT |
| 65 | 105529X | | SUB= 139888 |
| 66 | 73680500 | | SUB= 73690500 |
| 70 | 73680600 | | SUB= 73690600 |
| 71 | 17490608 | | SCREW LT |
| 72 | 17490612 | | SCREW |
| 74 | 72140606 | | BOLT |
| 75 | 17431008 | | SUB= 98000165 |
| 76 | 74760616 | | BOLT |
| 77 | 105505X | | SUB= 121794X |
| 79 | 19091216 | | WASHER PM |
| 81 | 73220400 | | SUB= 50675 |
| 82 | 74760532 | | BOLT |
| 83 | 73510500 | | NUT |
| 84 | 17211010 | | SCREW LT |
| 85 | 104755X | | ""J"" FASTENER LT" |
| 86 | 17490512 | | SCREW |
| 88 | 7605J | | BOLT T |
| 89 | 73680400 | | SUB= 73690400 |
| 90 | 74191008 | | SCREW |
| 91 | 10071000 | | LOCKWASHER |
| 92 | 17490412 | | SCREW HEX CRT |
| 93 | 19131312 | | WASHER |
| 94 | 7178J | | DECAL-CAUTION |
| 96 | 74760612 | | SUB= 74780612 |
| 97 | 74760610 | | BOLT |
| 98 | 109808X | | HOOD LATCH T |
| 99 | 73731000 | | NUT |
| 100 | 7206J | | SPACER LT |
| 101 | 19070818 | | WASHER |
| 102 | 74981020 | | SCREW |
| 103 | 109641X | | GROMMET T |
| 104 | 19111116 | | WASHER |
| 106 | 10090400 | | SUB= 10040400 |
| 109 | 2751R | | CLIP T |
| 113 | 121094X | | BOLT T |
| 114 | 19151616 | | SUB= 19171616 |
| 116 | 102949X | | SPACER-SPLIT YTV |
| 120 | 110853X | | SUPPORT RH YTH |
| 121 | 110852X | | SUPPORT LH YTH |
| 122 | 104634X | | SUB= 105419X388 |
| 123 | 120068X | | "KNOB 1/2"" YT" |
| 124 | 19171912 | | WASHER |
| 126 | 19131614 | | WASHER |
| 127 | 17190412 | | SCREW |
| 128 | 19091216 | | WASHER PM |
| 131 | 11050400 | | LOCKWASHER |

**ROPER LT 12 HYDROSTATIC LAWN TRACTOR--MODEL NUMBER LTH120AR
DIFFERENTIAL AND PUMP ASSEMBLY**

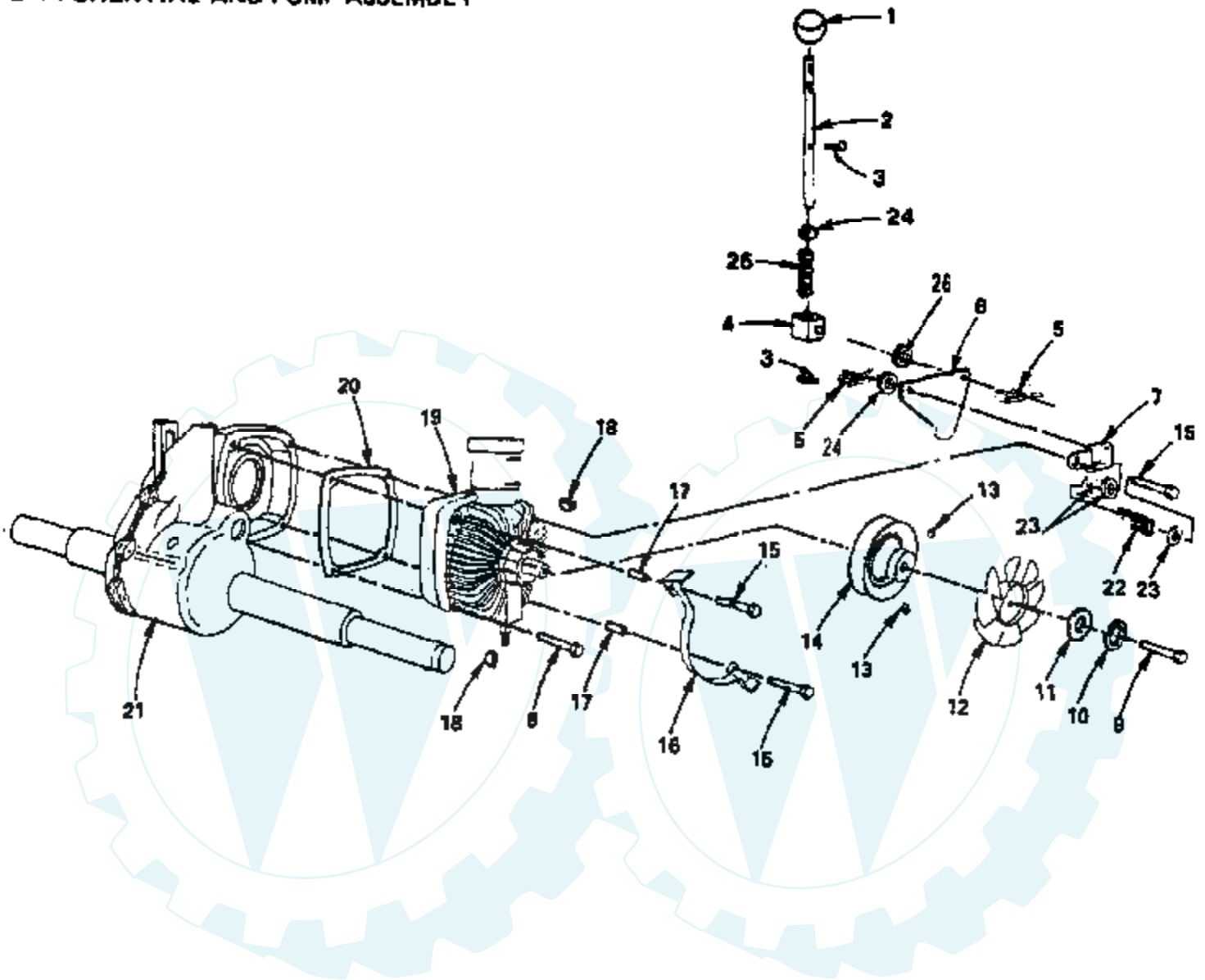

| Ref # | Part Number | Qty | Description |
|-------|-------------|-----|-------------------------|
| 1 | 106932X | | KNOB T(3/8 HOLE) |
| 2 | 120345X | | ROD YTH |
| 3 | 76020412 | | COTTER PIN |
| 4 | 108212X | | TRUNION HYT |
| 5 | 4921H | | SPRING.RETAINER |
| 6 | 108222X | | CONTROL COAST HYT |
| 7 | 108182X | | BRKT ASSEM HYT |
| 8 | 74760648 | | BOLT - HEX 3/8 - 16 X 3 |
| 9 | 74760412 | | BOLT LT |
| 10 | 10040400 | | LOCKWASHER |
| 11 | 19092016 | | WASHER |
| 12 | 108833X | | FAN HYDRO HYT |
| 13 | 23200506 | | SET SCREW |
| 14 | 108099X | | PULLEY HYT |
| 15 | 74760656 | | BOLT |
| 16 | 108085X | | KIT CENTERING Y |
| 17 | 5648R | | NLA |
| 18 | 2898J | | KEY T |
| 19 | 108180X | | PUMP HYDRO HYT |
| 20 | 108179X | | GASKET HYDRO HYT |
| 21 | | | REFER TO IMAGE |
| 22 | 104777X | | SUB= 140312 |
| 23 | 19131312 | | WASHER |
| 24 | 19131212 | | WASHER T |
| 25 | 102670X | | SPRING GTV |
| 26 | 19131614 | | WASHER |

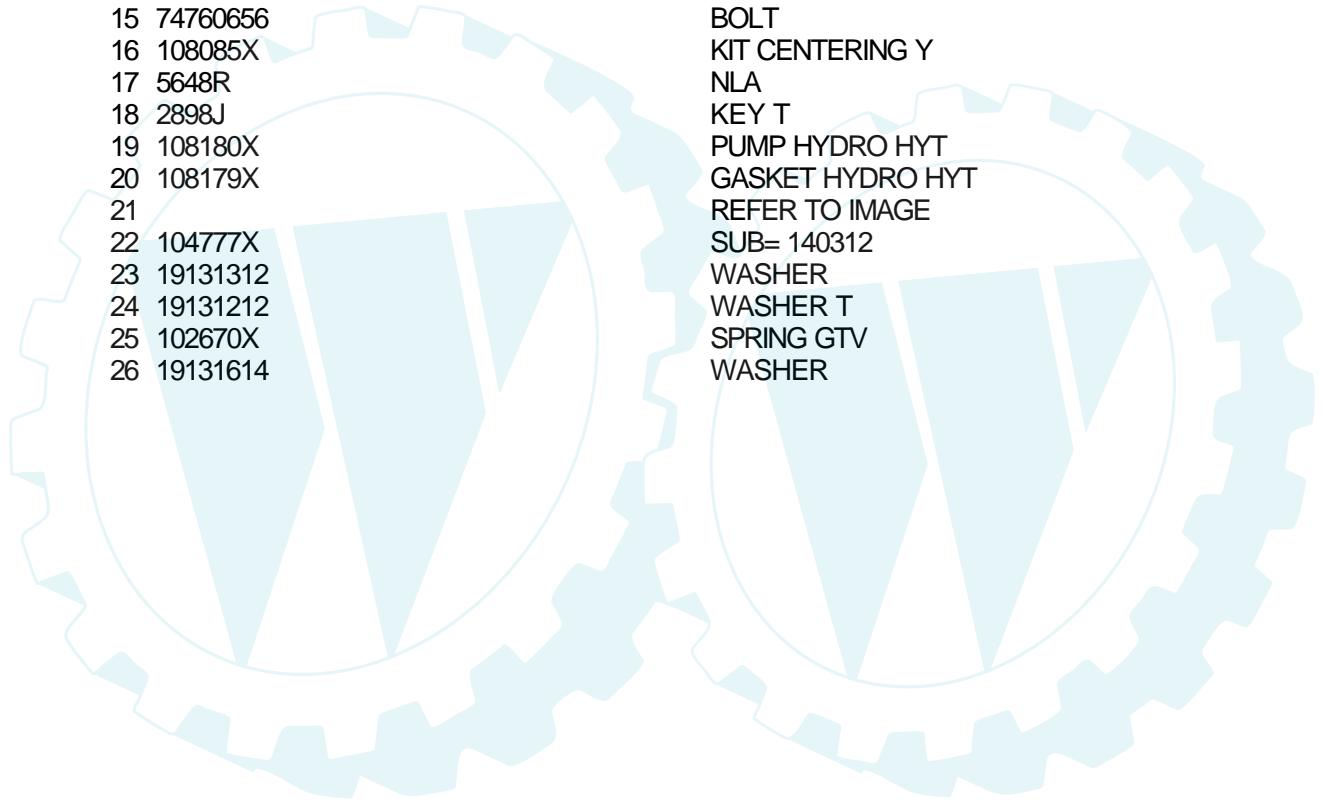

**ROPER LT 12 HYDROSTATIC LAWN TRACTOR--MODEL NUMBER LTH120AR
DRIVE**

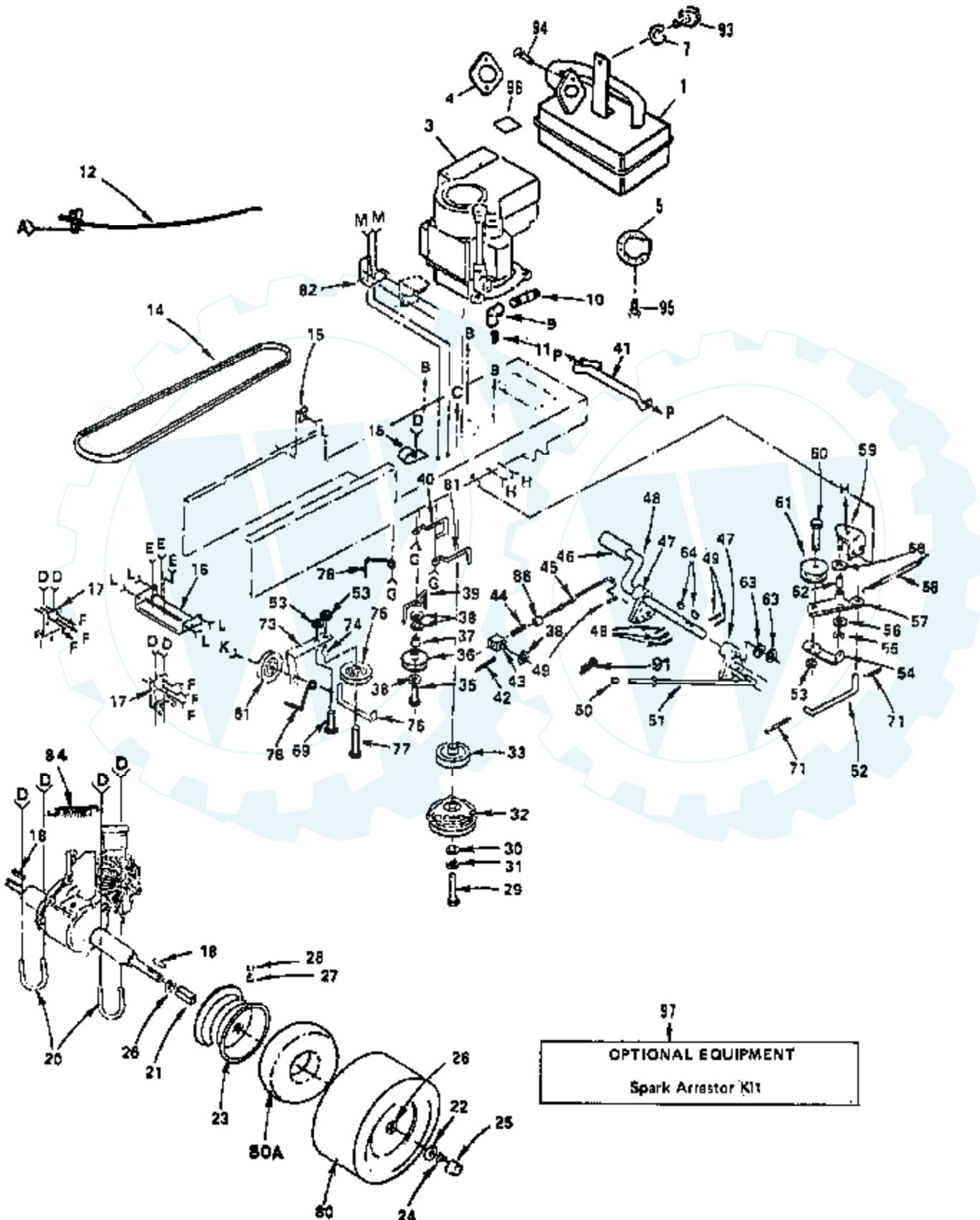

| Ref # | Part Number | Qty | Description |
|-------|-------------|-----|-----------------------------|
| 1 | 120330X | | MUFFLER LT |
| 3 | 281707 | | ENGINE 12 H.P. TYPE 0201-01 |
| 4 | 2949R | | SUB= 272293 |
| 5 | 101326L | | DEFLECTOR.222573 |
| 7 | 10040400 | | LOCKWASHER |
| 9 | 13200300 | | ELBOW |
| 10 | 13280336 | | PIPE NIPPLE LT |
| 11 | 91084 | | PLUG OIL DRAIN |
| 12 | 120583X | | SUB= 132764 |
| 14 | 120418X | | V BELT T |
| 15 | 2751R | | CLIP T |
| 16 | 108191X | | NLA |
| 17 | 108094X | | BRKT, TRANSAXLE |
| 18 | 9396E | | SQ KEY STD |
| 20 | 108093X | | U-BOLT HYT |
| 21 | 108097X | | SPACER HYT |
| 22 | 19332616 | | WASHER T |
| 23 | 108457X | | RIM HYD |
| 24 | 12000053 | | E RING HYT |
| 25 | 104757X | | HUB CAP |
| 26 | 19332416 | | WASHER |
| 27 | 65139 | | VALVE STEM LT |
| 28 | 59192 | | VALVE CAP |
| 29 | 74610764 | | SUB= 71130768 |
| 30 | 108252X | | WASHER T |
| 31 | 10040700 | | LOCKWASHER |
| 32 | 108218X | | SUB= 142600 |
| 33 | 109842X | | PULLEY YTH |
| 35 | 74760644 | | BOLT |
| 36 | 4859J | | SUB= 123674X |
| 37 | 4470J | | SPACER T |
| 38 | 19131312 | | WASHER |
| 39 | 109070X | | BELT KEEPER LT |
| 40 | 120136X | | KEEPER BELT HYT |
| 41 | 109169X | | SUB= 109172X |
| 42 | 76020412 | | COTTER PIN |
| 43 | 108212X | | TRUNION HYT |
| 44 | 108661X | | SPRING BRAKE HYT |
| 45 | 121091X | | BRAKE ROD HY |
| 46 | 8883R | | PEDAL COVER T |
| 47 | 106918X | | ARM BRAKE LT |
| 48 | 108096X | | SHAFT, FOOT PEDAL |
| 49 | 1572H | | SUB= 2882J |
| 50 | 71673 | | PLUNGER CAP T |
| 51 | 105844X | | SUB= 125637X |
| 52 | 105710X | | "LINK, CLUTCH T" |
| 53 | 73680600 | | SUB= 73690600 |
| 54 | 106499X | | SUB= 123205X |
| 55 | 12000039 | | KLIP RING |
| 56 | 110812X | | WASHER LT |
| 57 | 105705X | | SUB= 125829X |
| 58 | 105709X | | "SPRING, RETURN LT" |
| 59 | 105724X | | SUB= 123102X |
| 60 | 74760624 | | SUB= 74930624 |
| 61 | 106298X | | SUB= 139245 |
| 62 | 105706X | | "LY, BEARING" |
| 63 | 19252016 | | SUB= 121749X |
| 64 | 2228M | | SUB= 2228M1 |

| Ref # | Part Number | Qty | Description |
|-------|-------------|-----|-------------------------|
| 69 | 74760616 | | BOLT |
| 71 | 7602041273 | | |
| 73 | 108214X | | BRKT IDLER HYT |
| 74 | 101279K | | SPACER SPLIT LTV |
| 75 | 105307X | | IDLER.PULLEY.LT |
| 76 | 108216X | | KEEPER BELT HYT |
| 77 | 74760648 | | BOLT - HEX 3/8 - 16 X 3 |
| 78 | 105597X | | BELT RETAINER GT |
| 80 | 106268X | | SUB= 122074X |
| 80A | 7152J | | TUBE.18X9.5-8 |
| 81 | 120443X | | BELT KEEPER T |
| 82 | 108236X | | BRACKET LT |
| 84 | 110422X | | SUB= 146682 |
| 86 | 120622X004 | | |
| 91 | 4939M | | SUB= 85902 |
| 93 | 74780412 | | SUB= 74780414 |
| 94 | 71070510 | | SCREW LT |
| 95 | 17450808 | | SCREW LT |
| 96 | 120601X | | DECAL.ENG.271967 |
| 97 | 673A223 | | SCREEN |

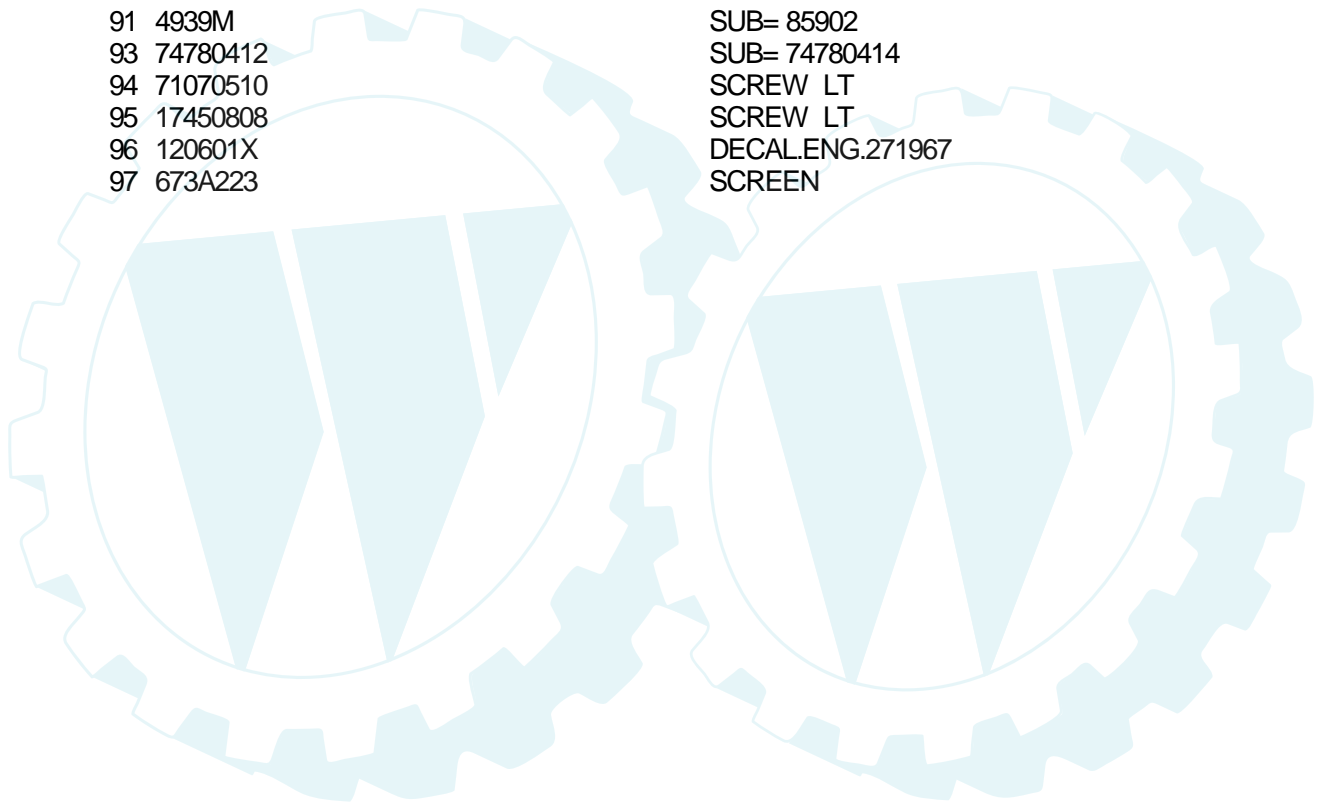

ROPER LT 12 HYDROSTATIC LAWN TRACTOR--MODEL NUMBER LTH120AR ELECTRICAL

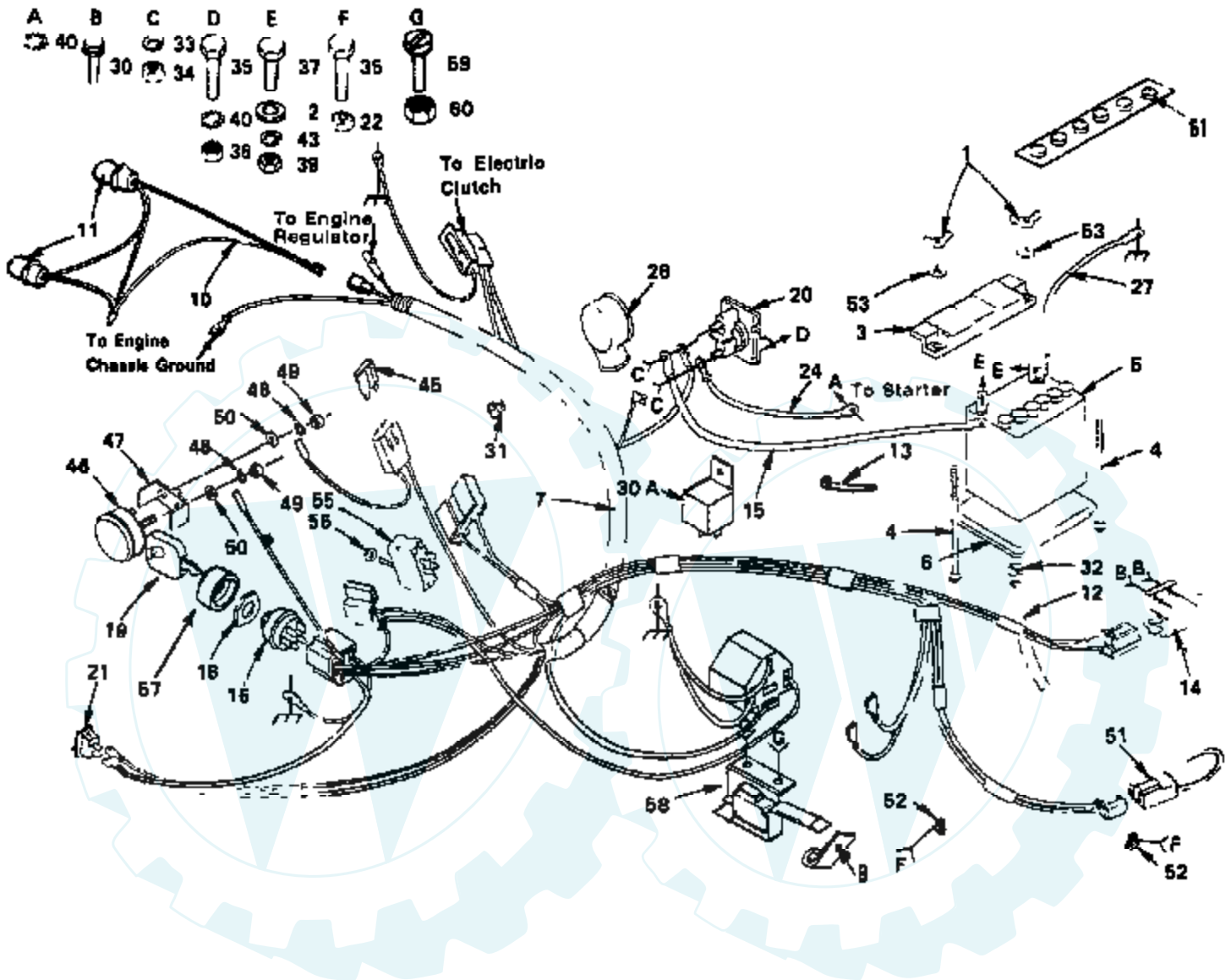



| Ref # | Part Number | Qty | Description |
|-------|-------------|-----|-------------------|
| 1 | 73490400 | | SUB= 146525 |
| 2 | 19091016 | | WASHER |
| 3 | 102476X | | SUB= 150109 |
| 4 | 72240460 | | BOLT |
| 5 | 227J | | SUB= 123899X |
| 6 | 7603J | | "TRAY T, BATTERY" |
| 7 | 120584X | | HARNESS T |
| 9 | 4171R | | CLIP T |
| 10 | 110859X | | HARNESS T |
| 11 | 7662J | | SUB= 4152J |
| 12 | 100541K | | SUB= 7697J |
| 13 | 7192J | | WIRE TIE |
| 14 | 104445X | | SWITCH-INTER. GT |
| 15 | 4206J | | CABLE-BATTERY T |
| 16 | 4406R | | SUB= STD365402 |
| 18 | 109788X | | SUB= 124211X |
| 19 | 109434X | | KEY MOLDED |
| 20 | 109081X | | SUB= 146154 |
| 21 | 110712X | | SWITCH LT |
| 22 | 73680400 | | SUB= 73690400 |
| 24 | 4206J | | CABLE-BATTERY T |
| 26 | 719J | | SUB= 154336 |
| 27 | 4207J | | CABLE T |
| 30 | 17021008 | | SCREW |
| 30A | 109748X | | RELAY ASSY T |
| 31 | 2751R | | CLIP T |
| 32 | 109596X | | HOSE CLAMP T |
| 33 | 10090400 | | SUB= 10040400 |
| 34 | 73350400 | | NUT |
| 35 | 74780408 | | BOLT |
| 36 | 73510400 | | NUT |
| 37 | 74760412 | | BOLT LT |
| 39 | 73220400 | | SUB= 50675 |
| 40 | 11050400 | | LOCKWASHER |
| 43 | 10040400 | | LOCKWASHER |
| 45 | 108824X | | FUSE HYT |
| 46 | 9433R | | AMMETER T |
| 47 | 6009J | | SUB= 532131708 |
| 48 | 10101000 | | SUB= 10071000 |
| 49 | 73911000 | | NUT |
| 50 | 19070818 | | WASHER |
| 51 | 102501X | | SUB= 141940 |
| 52 | 235R | | CLIPT |
| 53 | 11030400 | | LOCKWASHER GT |
| 55 | 4021J | | SWITCH.PTO.T |
| 56 | 4022J | | HEX NUT T |
| 57 | 109787X | | SUB= 147626 |
| 58 | 121064X | | SWITCH T |
| 59 | 74641008 | | SUB= 71031008 |
| 60 | 73951000 | | "NUT,KEPS" |
| 61 | 120353X | | BATTERY CAPS |
| | 101539X | | SHEET INSTR LT |
| | 120600X | | NLA |

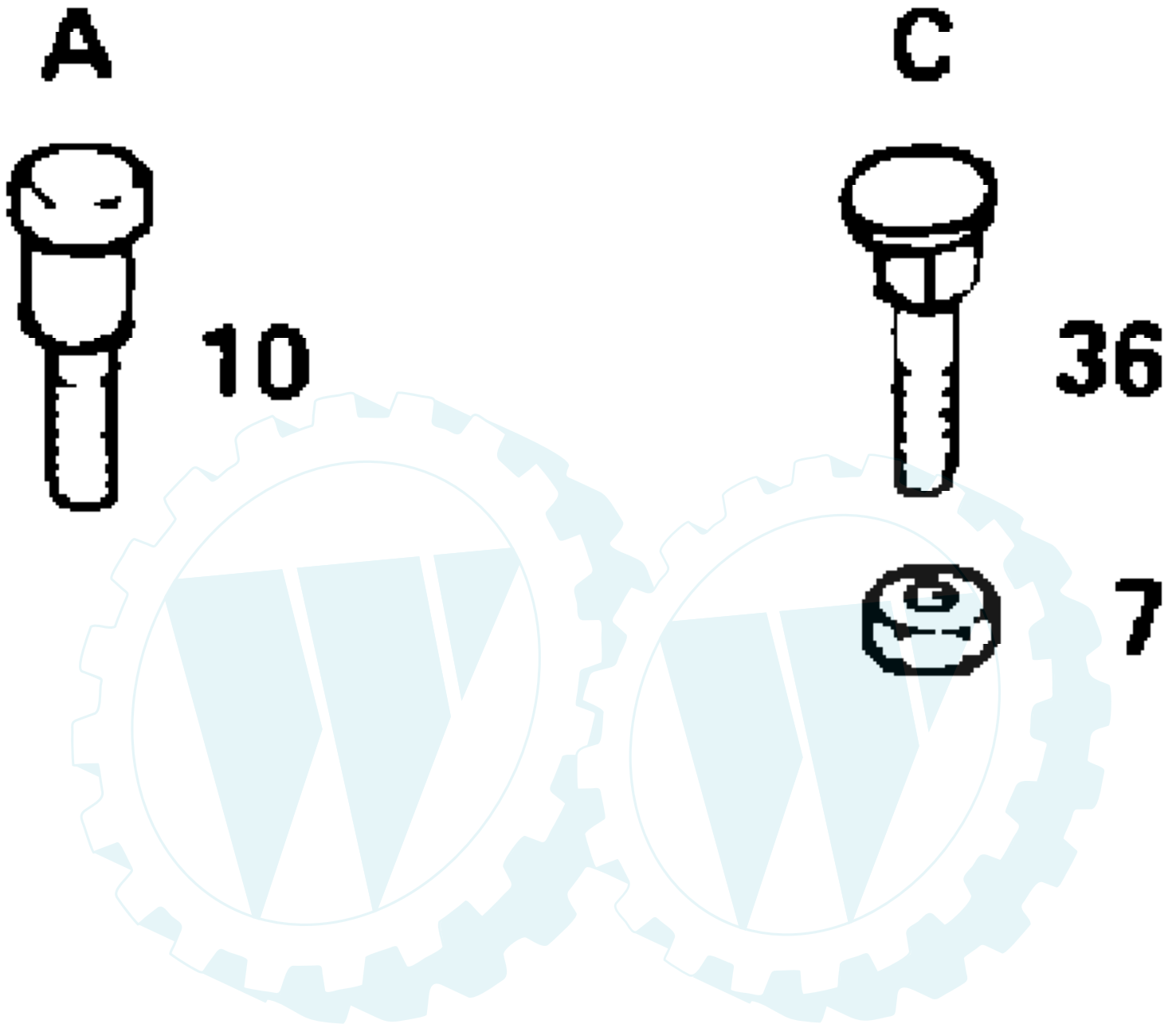

| Ref # | Part Number | Qty | Description |
|-------|-------------|-----|---------------------|
| 7 | 73680600 | | SUB= 73690600 |
| 10 | 105848X | | "BOLT, SHOULDER LT" |
| 36 | 72140606 | | BOLT |



E E



F F



G G



H H



I I

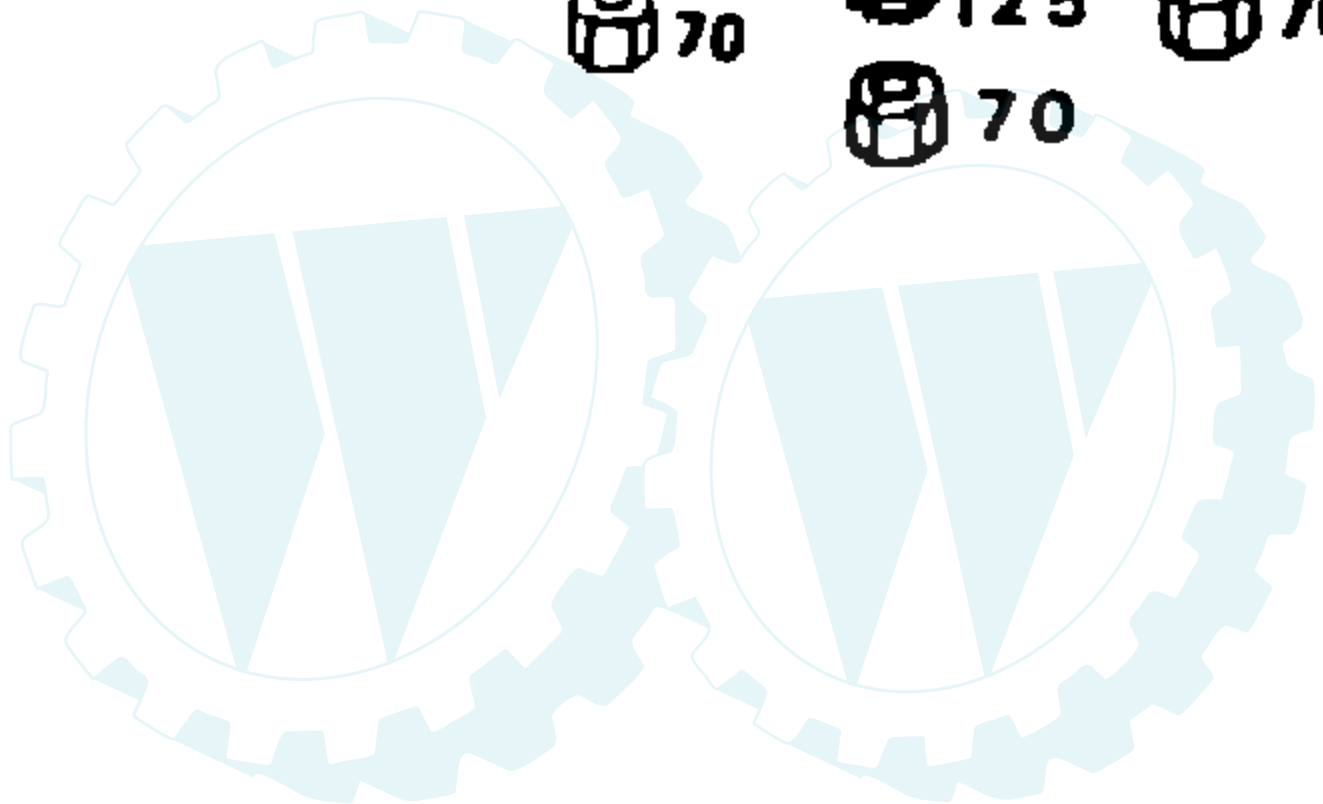
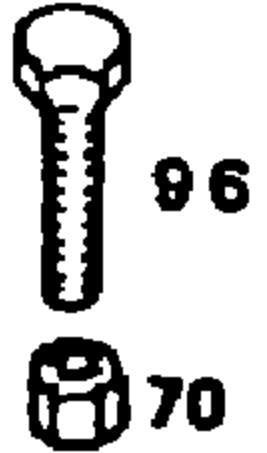

| Ref # | Part Number | Qty | Description |
|-------|-------------|-----|---------------|
| 67 | 74760612 | | SUB= 74780612 |
| 70 | 73680600 | | SUB= 73690600 |
| 73 | 19132012 | | WASHER |
| 76 | 74760616 | | BOLT |
| 96 | 74760612 | | SUB= 74780612 |
| 108 | 17490616 | | SCREW GTV |
| 125 | 11050600 | | LOCKWASHER |
| 129 | 11030400 | | LOCKWASHER GT |
| 130 | 73490400 | | SUB= 146525 |



A



70

B



71

C



33

















31



| Ref # | Part Number | Qty | Description |
|-------|-------------|-----|---------------|
| 31 | 73680600 | | SUB= 73690600 |
| 33 | 19131312 | | WASHER |
| 70 | 17490612 | | SCREW |
| 71 | 17490508 | | SCREW LT |



| A | B | C | E | H | L | M | N |
|---|--|--|--|--|--|--|--|
|  23 |  23 |  50 |  6 |  37 |  19 |  23 |  67 |
|  5 |  20 |  4 |  20 | |  4 | | |
|  20 | | | | | | | |

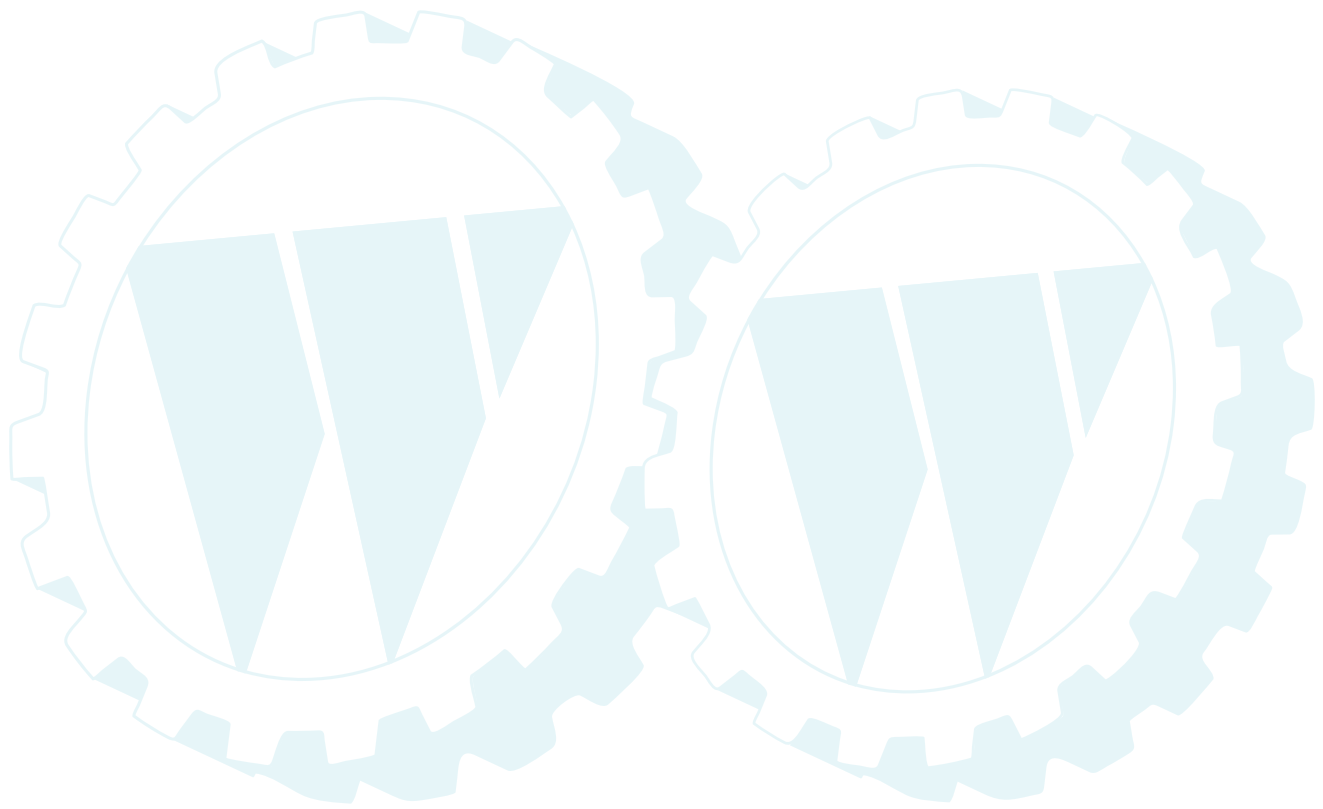

| Ref # | Part Number | Qty | Description |
|-------|-------------|-----|------------------|
| 4 | 73680600 | | SUB= 73690600 |
| 5 | 19111216 | | WASHER M |
| 6 | 72140505 | | BOLT |
| 19 | 74760612 | | SUB= 74780612 |
| 20 | 73680500 | | SUB= 73690500 |
| 23 | 72140506 | | BOLT |
| 37 | 17490612 | | SCREW |
| 50 | 72140606 | | BOLT |
| 67 | 72140610 | | BOLT.3/8-14X1.25 |



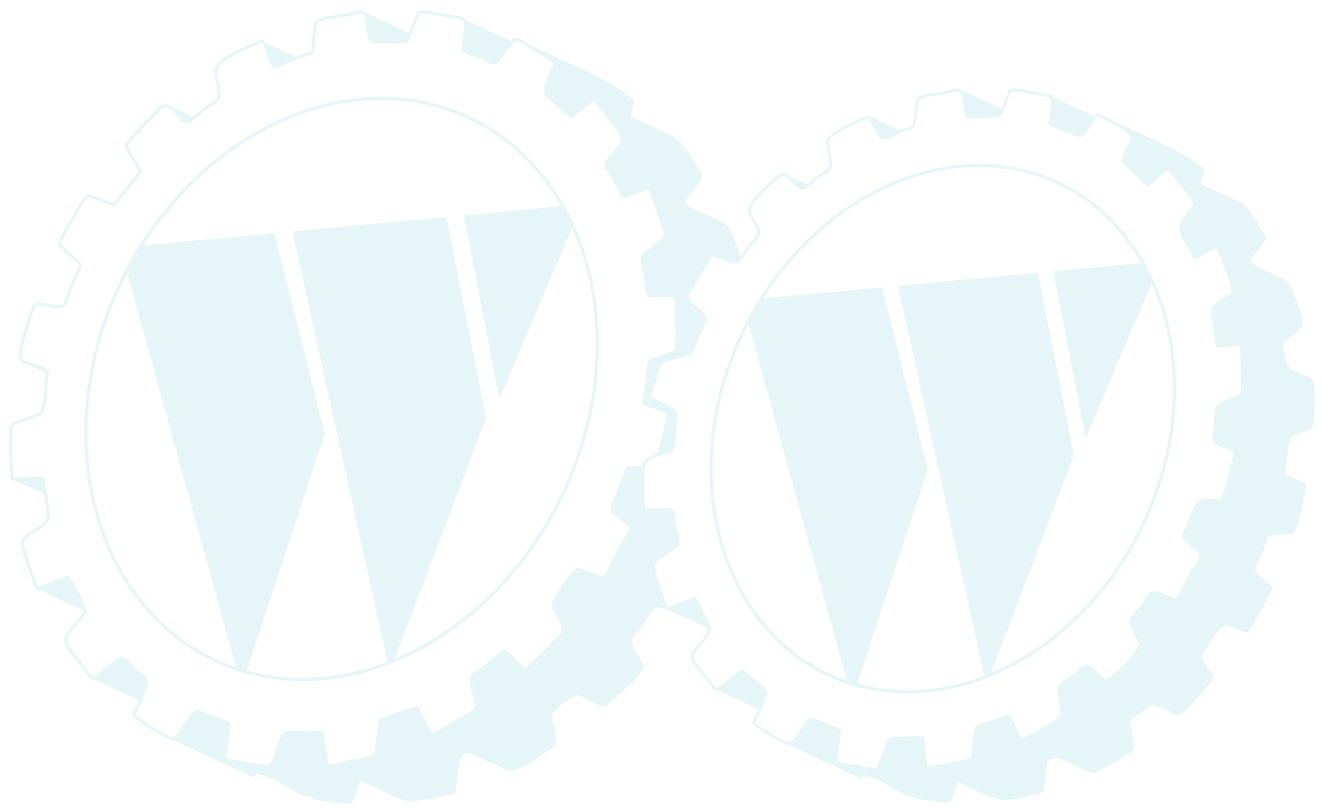
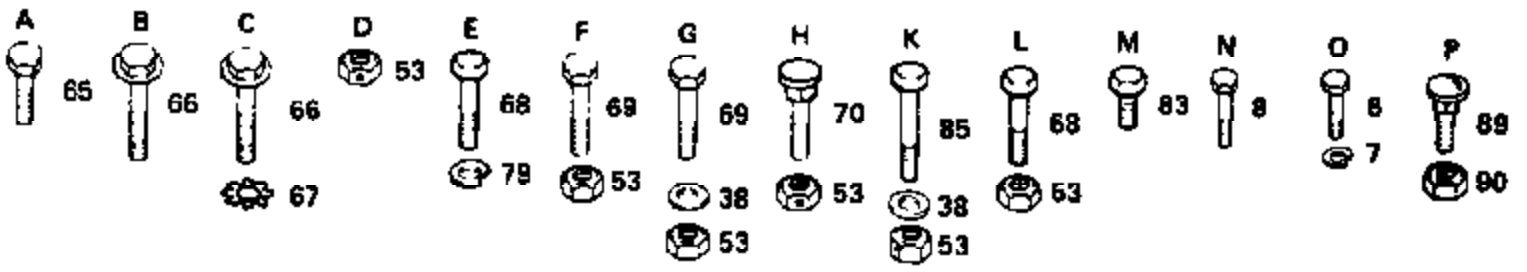

| Ref # | Part Number | Qty | Description |
|-------|-------------|-----|---------------|
| 6 | 74780408 | | BOLT |
| 7 | 10040400 | | LOCKWASHER |
| 8 | 17210806 | | SCREW |
| 38 | 19131312 | | WASHER |
| 53 | 73680600 | | SUB= 73690600 |
| 65 | 17720408 | | SCREW |
| 66 | 17490624 | | SCREW LT |
| 67 | 11050600 | | LOCKWASHER |
| 68 | 74760612 | | SUB= 74780612 |
| 69 | 74760616 | | BOLT |
| 70 | 72140606 | | BOLT |
| 79 | 10040600 | | LOCKWASHER |
| 83 | 17021008 | | SCREW |
| 85 | 74760636 | | BOLT |
| 89 | 72140506 | | BOLT |
| 90 | 73680500 | | SUB= 73690500 |

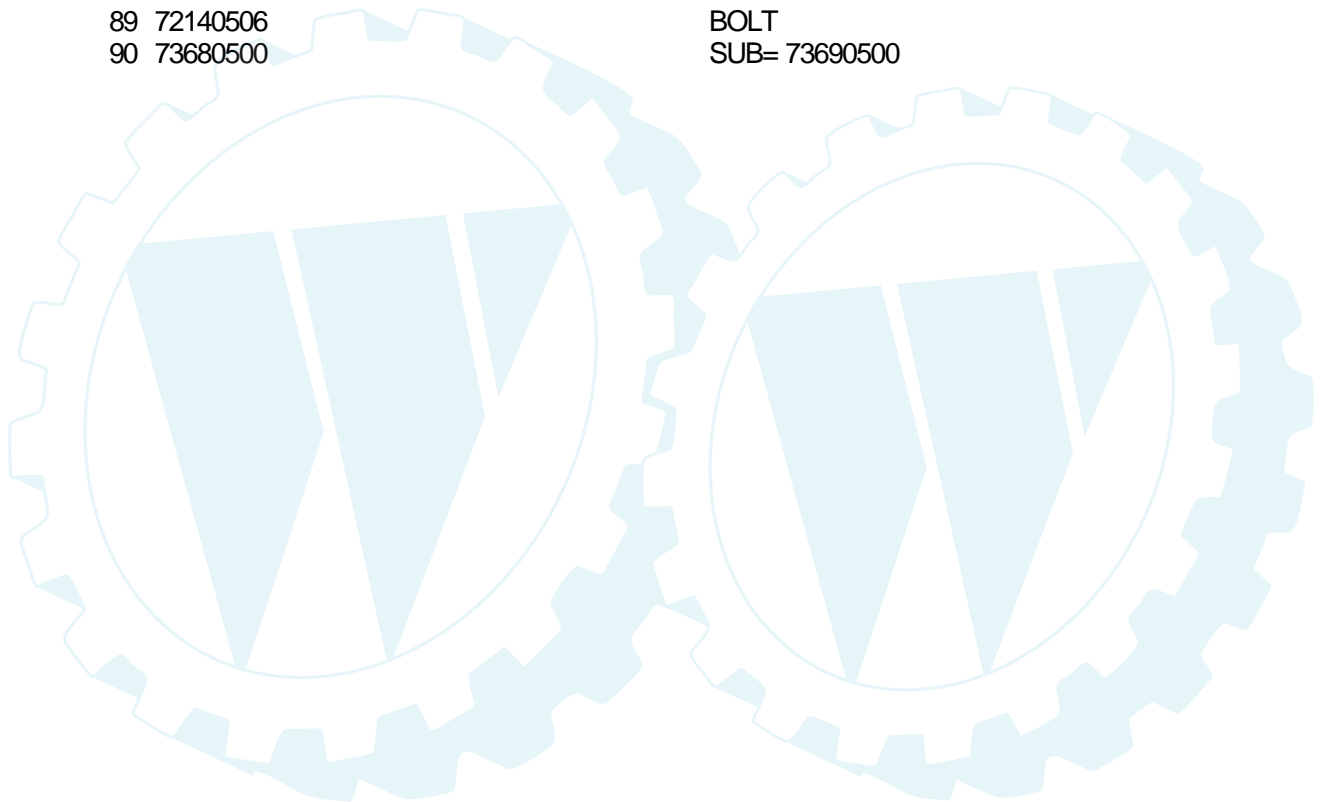

**ROPER LT 12 HYDROSTATIC LAWN TRACTOR--MODEL NUMBER LTH120AR
LIFT ADJUSTMENT**

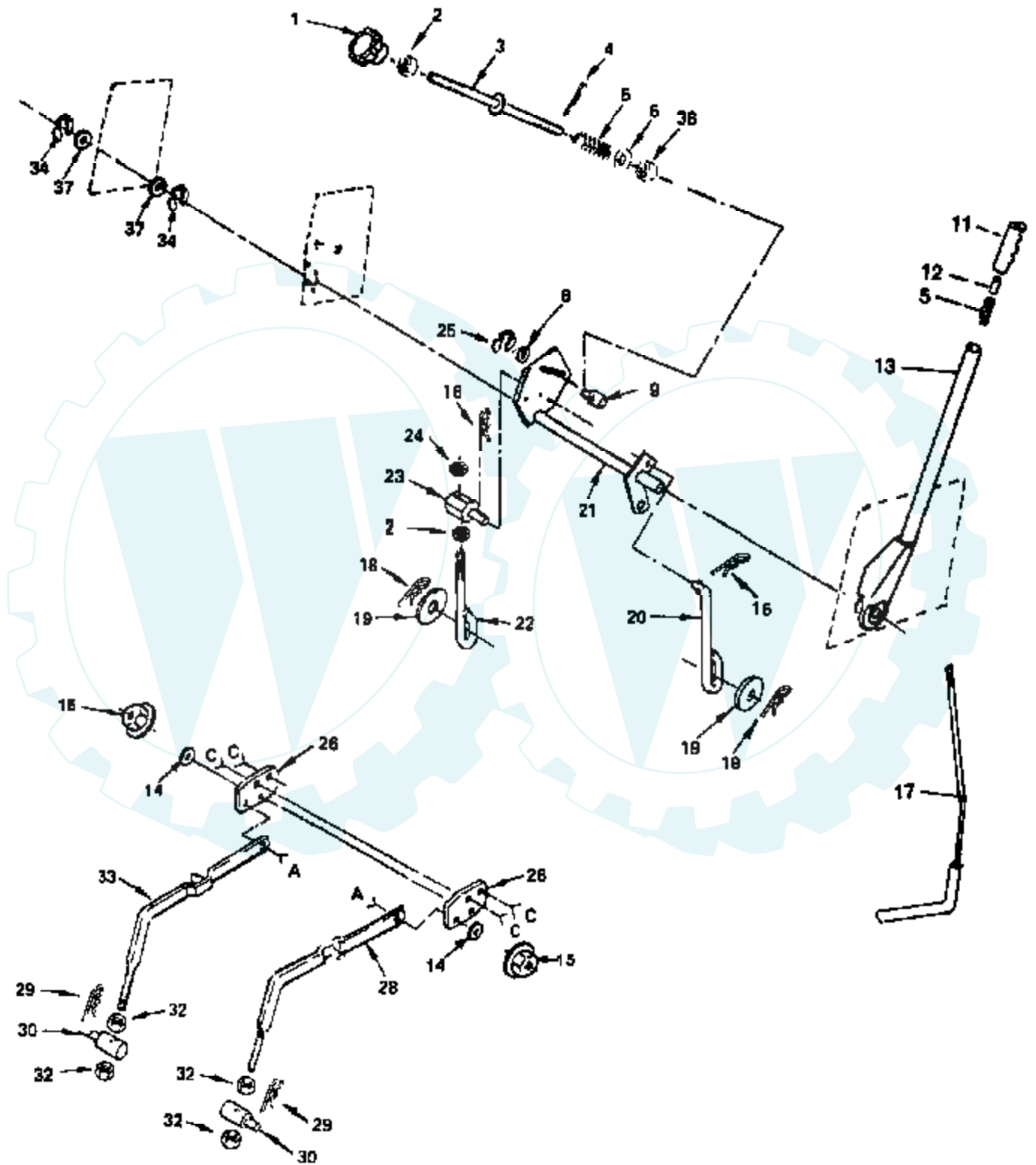

| Ref # | Part Number | Qty | Description |
|-------|-------------|-----|---------------------|
| 1 | 100734K | | SUB= 138057 |
| 2 | 73220600 | | NUT.HEX.3/8-16UNC |
| 3 | 110729X | | ROD LIFT LT |
| 4 | 76020308 | | SUB= 3145 |
| 5 | 2876H | | SPRING T |
| 6 | 19131016 | | WASHER |
| 7 | 73680600 | | SUB= 73690600 |
| 8 | 19151216 | | WASHER |
| 9 | 110810X | | TRUNION LT |
| 10 | 105848X | | "BOLT, SHOULDER LT" |
| 11 | 109413X | | GRIP |
| 12 | 105723X | | SUB= 125925X |
| 13 | 121002X | | SUB= 123096X |
| 14 | 110739X | | WASHER T |
| 15 | 73980600 | | NUT SPECIAL T |
| 16 | 4939M | | SUB= 85902 |
| 17 | 121006X | | LEVER ROD LT |
| 18 | 4921H | | SPRING.RETAINER |
| 19 | 19171516 | | WASHER T |
| 20 | 110029X | | LIFT LINK LT |
| 21 | 121031X | | SHAFT YTH |
| 22 | 105855X | | LINK LIFT LT |
| 23 | 106204X | | SUB= 132793 |
| 24 | 73680600 | | SUB= 73690600 |
| 25 | 12000037 | | KLIP RING |
| 26 | 105864X | | "BRACKET, SUSPE T" |
| 27 | 106854X | | SUB= 121252X |
| 28 | 105862X | | SUB= 121598X |
| 29 | 9135R | | SPRING H |
| 30 | 106308X | | SUB= 130171 |
| 32 | 73220800 | | NUT |
| 33 | 105863X | | SUB= 121599X |
| 34 | 12000022 | | E-RING |
| 35 | 72140608 | | SUB= 72110608 |
| 36 | 72140606 | | BOLT |
| 37 | 19292016 | | WASHER |
| 38 | 110807X | | NUT T |

**ROPER LT 12 HYDROSTATIC LAWN TRACTOR--MODEL NUMBER LTH120AR
MOWER**

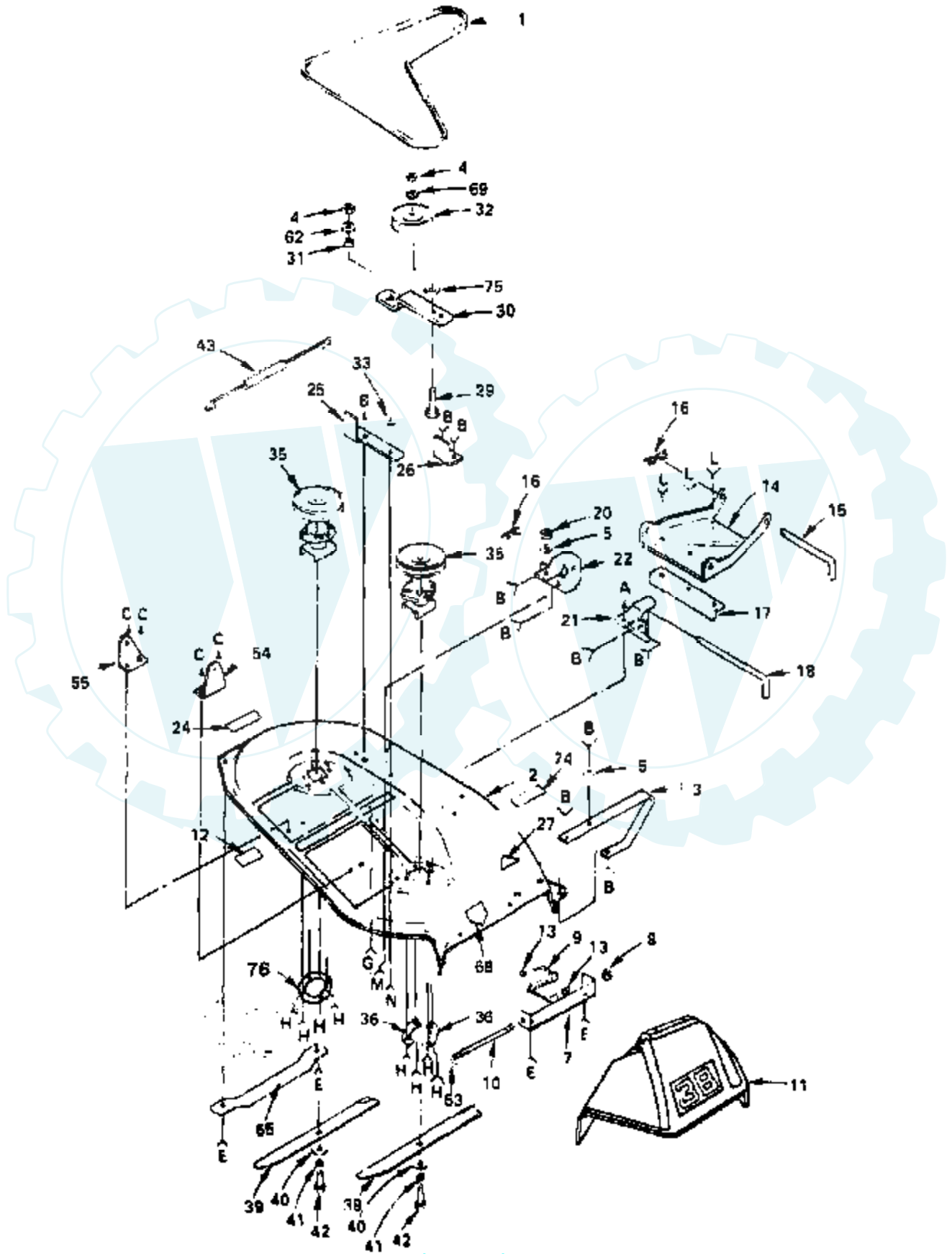

| Ref # | Part Number | Qty | Description |
|-------|-------------|-----|---------------------------|
| 1 | 106085X | | BELT-V.79.1.MWR |
| 2 | 108671X | | SUB= 144726 |
| 3 | 8417J | | SUB= 128772 |
| 4 | 73680600 | | SUB= 73690600 |
| 5 | 19111216 | | WASHER M |
| 7 | 105896X | | SUB= 137607 |
| 8 | 110452X | | NUT PUSH M |
| 9 | 106734X | | SUB= 123713X |
| 10 | 106735X | | ROD-HINGE T |
| 11 | 106736X | | DEFLECTOR-SHLD T |
| 12 | 108682X | | NLA |
| 13 | 105304X | | CAP-SLEEVE LT |
| 14 | 105662X | | LINK.PARALLEL |
| 15 | 105744X | | "ROD, FRT. PARAL T" |
| 16 | 4921H | | SPRING.RETAINER |
| 17 | 105872X | | LINK STOP |
| 18 | 109835X | | HINGE PIN T |
| 20 | 73680500 | | SUB= 73690500 |
| 21 | 109598X | | BRACKET RH LT |
| 22 | 109597X | | BRACKET LH T |
| 24 | 3713J | | DECAL INSTRUCTION CAUTION |
| 25 | 109503X | | SUPPORT ARM T |
| 26 | 109504X | | STOP T |
| 27 | | | REFER TO IMAGE |
| 29 | 74760632 | | SUB= 74930632 |
| 30 | 108674X | | SUB= 127162X |
| 31 | 106902X | | SPACER RETAINER |
| 32 | 102403X | | IDLER-FLAT T |
| 33 | 106513X | | "WASHER, WEAR LT" |
| 35 | 105891X | | SUB= 121687X |
| 36 | 100668L | | SUPPORT PLATE LT |
| 39 | 106634X | | SUB= 25036 |
| 40 | 19132012 | | WASHER |
| 41 | 10030600 | | SUB= 10040600 |
| 42 | 74610624 | | BOLT.3/8-24X1-1/2 |
| 43 | 102727X | | "SPRING.EXT.8.5"" |
| 54 | 105857X | | "BRKT,SUSP RH T" |
| 55 | 108673X | | "BRKT,SUSP REAR LH" |
| 62 | 106514X | | SUB= 106902X |
| 63 | 19111016 | | WASHER |
| 65 | 7631J | | RUNNER-LH M |
| 68 | 78850 | | SUB= 85463 |
| 69 | 19131316 | | WASHER |
| 74 | 106679X | | DECAL.WARNING.T |
| 75 | 19131210 | | WASHER |
| 76 | 110445X | | SUPPORT T |

ROPER LT 12 HYDROSTATIC LAWN TRACTOR--MODEL NUMBER LTH120AR

PUMP

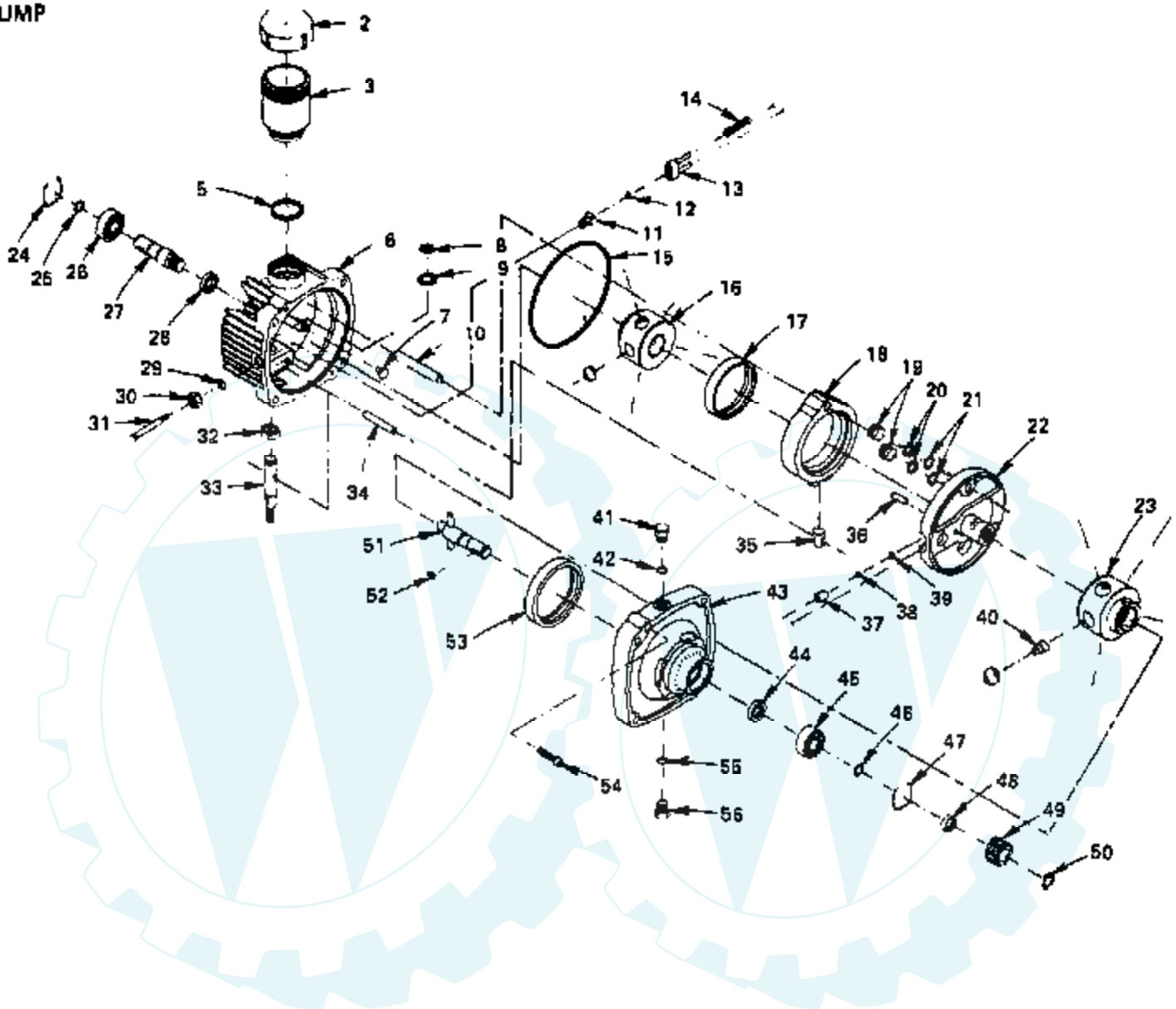

| Ref # | Part Number | Qty | Description |
|-------|-------------|-----|-------------------|
| 2 | 108907X | | RESERVOIR CVR HYT |
| 3 | 108908X | | RESERVOIR BDY HYT |
| 5 | 108910X | | SEAL RING HYT |
| 6 | 108911X | | COVER |
| 7 | 108912X | | PIN HYT |
| 8 | 108913X | | RETAINING RING |
| 9 | 108914X | | WASHER HYT |
| 10 | 108915X | | NLA |
| 11 | 108916X | | GUIDE FITTING HYT |
| 12 | 108917X | | NLA |
| 13 | 108918X | | NLA |
| 14 | 108919X | | SPRING HYT |
| 15 | 108920X | | SEAL RING HYT |
| 16 | 108921X | | PUMP ROTOR HYT |
| 17 | 108922X | | PUMP RACE HYT |
| 18 | 108923X | | NLA |
| 19 | 108924X | | PISTON HYT |
| 20 | 108925X | | NLA |
| 21 | 108926X | | O RING HYT |
| 22 | 108927X | | PINTLE |
| 23 | 108928X | | NLA |
| 24 | 108929X | | SUB= 108952X |
| 25 | 108930X | | SNAP RING |
| 26 | 108931X | | SUB= 108950X |
| 27 | 108932X | | INPUT SHAFT HYT |
| 28 | 108933X | | SUB= 108949X |
| 29 | 108934X | | O RING HYT |
| 30 | 108935X | | NUT&GASKET AS HYT |
| 31 | 108936X | | SHAFT DUMP HYT |
| 32 | 108937X | | SEAL HYT |
| 33 | 108938X | | CONTROL SHAFT |
| 34 | 108939X | | SUB= 108938X |
| 35 | 108940X | | NLA |
| 36 | 108941X | | NLA |
| 37 | 108942X | | VALVE BODY HYT |
| 38 | 108943X | | "HYT, BALL" |
| 39 | 108944X | | RETAINER RING HYT |
| 40 | 108945X | | SPRING HYT |
| 41 | 108946X | | SUB= 108961X |
| 42 | 108947X | | SUB= 108960X |
| 43 | 108948X | | BODY HYT |
| 44 | 108949X | | SEAL HYT |
| 45 | 108950X | | "HYT, BEARING" |
| 46 | 108951X | | SNAP RING |
| 47 | 108952X | | RETAINER RING HYT |
| 48 | 108953X | | NLA |
| 49 | 108954X | | NLA |
| 50 | 108955X | | RETAINER RING HYT |
| 51 | 108956X | | OUTPUT SHAFT |
| 52 | 108957X | | KEY HYT |
| 53 | 108958X | | MOTOR RACE HYT |
| 54 | 108959X | | CAP SCREW HYT |
| 55 | 108960X | | O RING HYT |
| 56 | 108961X | | PLUG HYT |

ROPER LT 12 HYDROSTATIC LAWN TRACTOR--MODEL NUMBER LTH120AR
STEERING ASSEMBLY

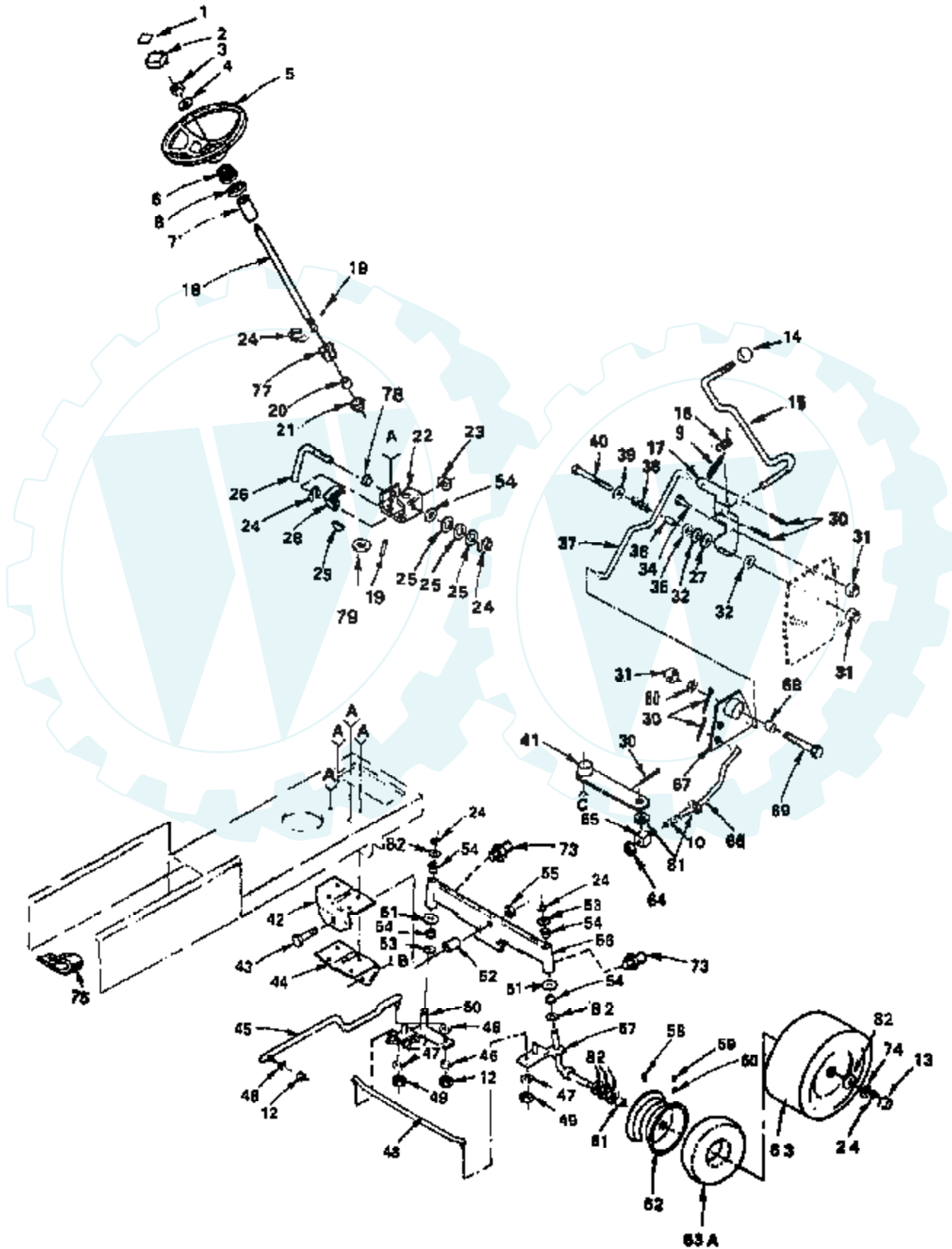

| Ref # | Part Number | Qty | Description |
|-------|-------------|-----|-------------------------|
| 1 | 104590X | | DECAL - STEERING WHEEL |
| 2 | 100710L | | INSERT-WHEEL LT |
| 3 | 73360800 | | NUT |
| 4 | 100712K | | WASHER |
| 5 | 100713N | | SUB= 150547 |
| 6 | 100711L | | ADAPTER LT |
| 7 | 106945X | | TUBE YT |
| 8 | 106943X | | SPACER LT |
| 9 | 4921H | | SPRING.RETAINER |
| 10 | 102670X | | SPRING GTV |
| 13 | 104757X | | HUB CAP |
| 14 | 106933X | | KNOB T (1/2-HOLE) |
| 15 | 110845X | | ROD.YTH |
| 16 | 108194X | | NLA |
| 17 | 108196X | | BRKT CONTROL HYT |
| 18 | 109557X | | STEERING SHAFT T |
| 19 | 2882J | | DRIVE PIN |
| 20 | 74580 | | SHAFT SPACER LT |
| 21 | 71208 | | BUSHING |
| 22 | 109432X | | SUB= 110150X |
| 23 | 19212016 | | WASHER D |
| 24 | 12000029 | | RING |
| 25 | 6266H | | WASHER .T |
| 26 | 108683X | | ROD STEERING T |
| 27 | 108672X | | SUB= 144726 |
| 28 | 108684X | | GEAR.SECTOR.HYT |
| 29 | 106126X | | KEY-WOODRUFF LT |
| 30 | 76020412 | | COTTER PIN |
| 31 | 73680600 | | SUB= 73690600 |
| 32 | 108200X | | WASHER FRIC HYT |
| 34 | 108518X | | BOLT HYT |
| 35 | 19212016 | | WASHER D |
| 36 | 108201X | | SPACER HYT |
| 37 | 108397X | | LINK CONTROL HY |
| 38 | 108844X | | SPRING HYT |
| 39 | 19132012 | | WASHER |
| 40 | 74760648 | | BOLT - HEX 3/8 - 16 X 3 |
| 41 | 108209X | | ARM ASSEM HYT |
| 42 | 105663X | | SUPPORT-SADDL T |
| 43 | 74761060 | | BOLT LT |
| 44 | 105664X | | SUPPORT.SADDLE.FT |
| 45 | 105727X | | LINK-DRAG LT |
| 46 | 10040600 | | LOCKWASHER |
| 47 | 10040500 | | LOCKWASHER |
| 48 | 108110X | | ROD TIE HYT |
| 49 | 73610500 | | NUT |
| 50 | 105655X | | SPINDLE LH YT |
| 51 | 19272016 | | WASHER |
| 52 | 110438X | | BEARING |
| 53 | 6266H | | WASHER .T |
| 54 | 3366R | | COL. SRTG. BEAR. |
| 55 | 73901000 | | "NUT-LOC,FLANGE LT" |
| 56 | 108075X | | FRONT AXLE |
| 57 | 105653X | | SUB= 130897 |
| 58 | 278H | | FITTING LT |
| 59 | 65139 | | VALVE STEM LT |
| 60 | 59192 | | VALVE CAP |
| 61 | 9040H | | "FLANGE, BEARING" |

| Ref # | Part Number | Qty | Description |
|-------|-------------|-----|------------------|
| 62 | 106732X | | SUB= 106732X417 |
| 63 | 106222X | | SUB= 122073X |
| 63A | 59904 | | TUBE.5.3/4.5/6 |
| 64 | 73350600 | | NUT |
| 65 | 108212X | | TRUNION HYT |
| 66 | 120131X | | NLA |
| 67 | 108205X | | "HYT, BELLCRANK" |
| 68 | 108198X | | SPACER HYT |
| 69 | 74760624 | | SUB= 74930624 |
| 73 | 6855M | | ZERK M |
| 74 | 19252616 | | SUB= 121748X |
| 75 | 5320R | | INSUL CLIP T |
| 77 | 108685X | | GEAR PINION T |
| 78 | 109816X | | NYLINER T |
| 79 | 109816X | | NYLINER T |
| 79 | 101930X | | WASHER YTV |
| 80 | 19131316 | | WASHER |
| 81 | 19131212 | | WASHER T |

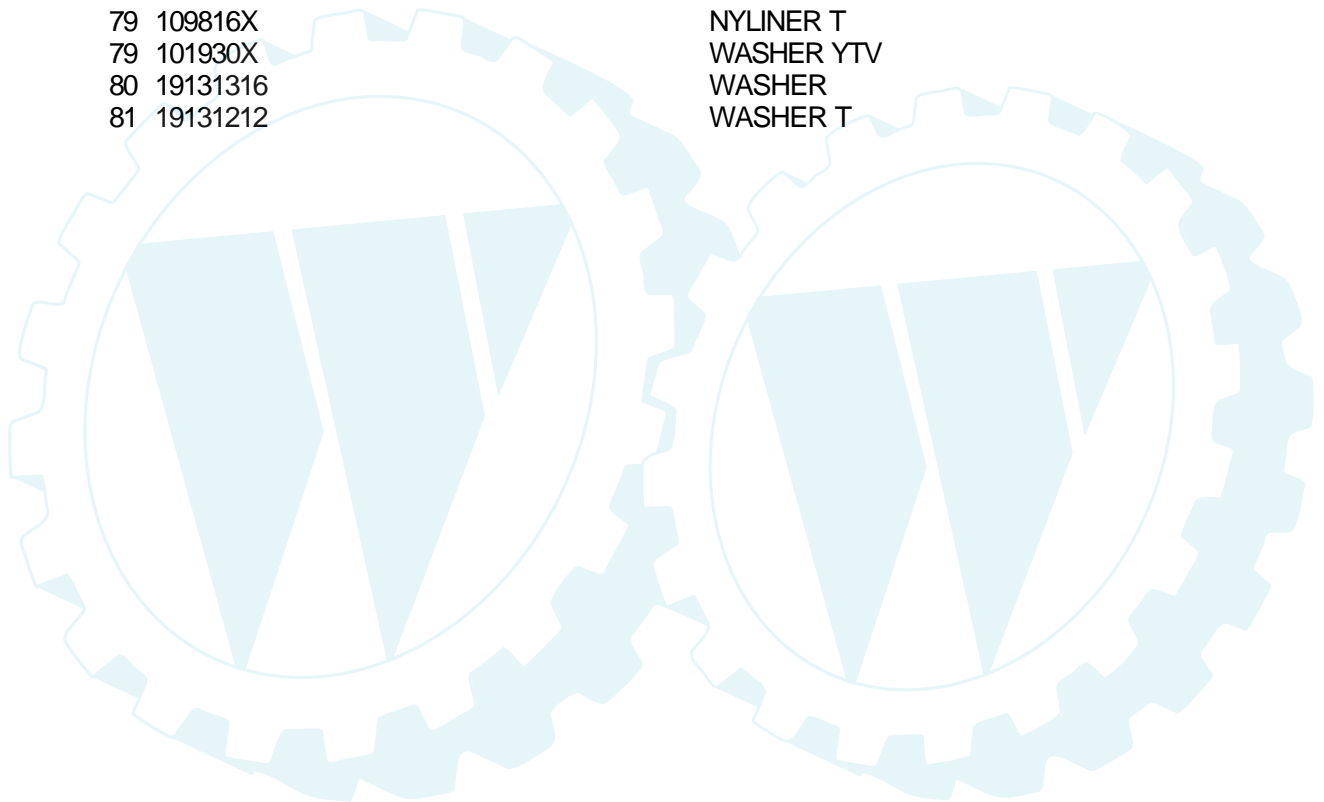

ROPER LT 12 HYDROSTATIC LAWN TRACTOR--MODEL NUMBER LTH120AR TRANSAXLE

ALL TRANSAXLE PARTS MUST BE PURCHASED THROUGH AND SERVICE PERFORMED BY YOUR LOCAL TECUMSEH DEALER.

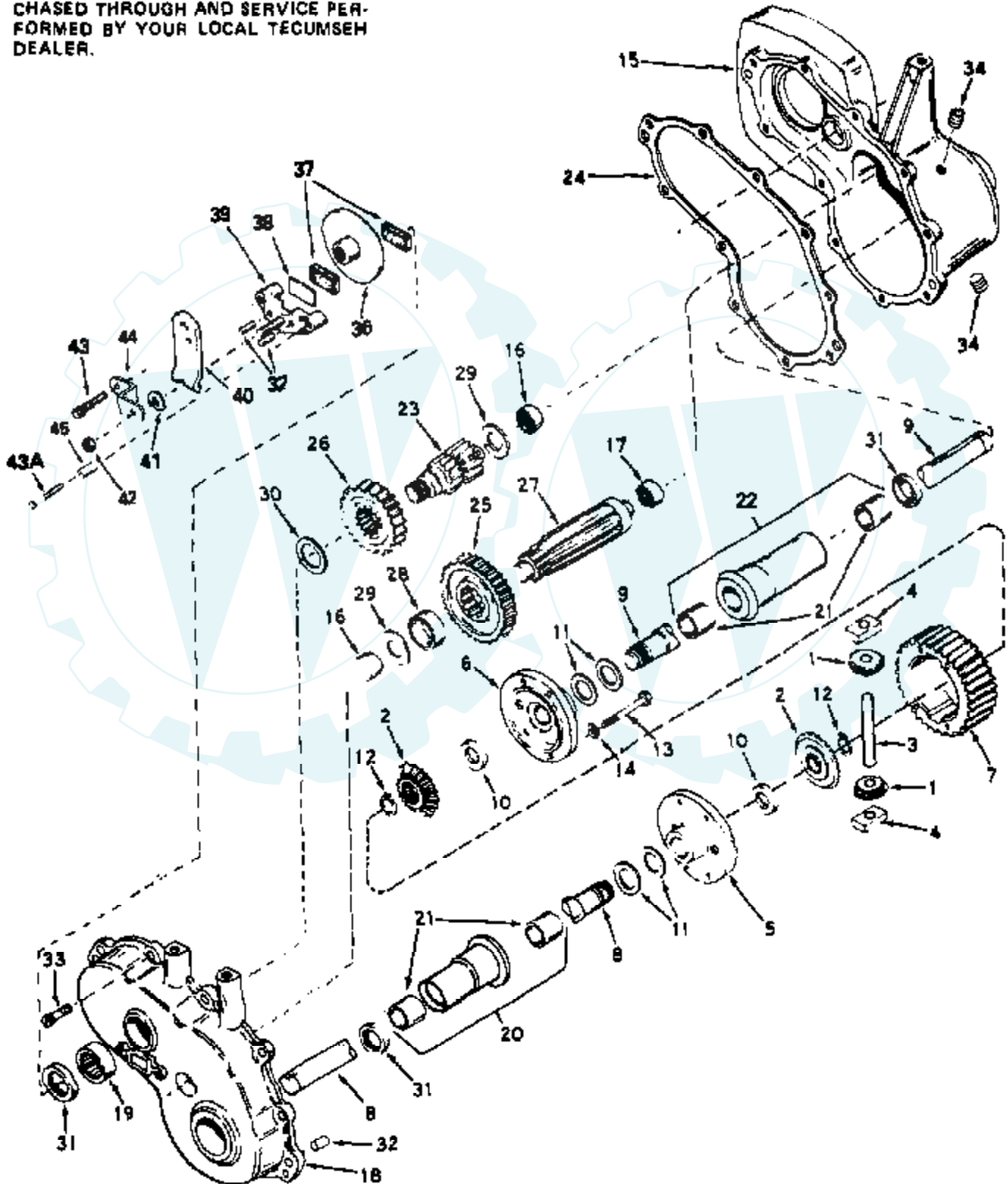

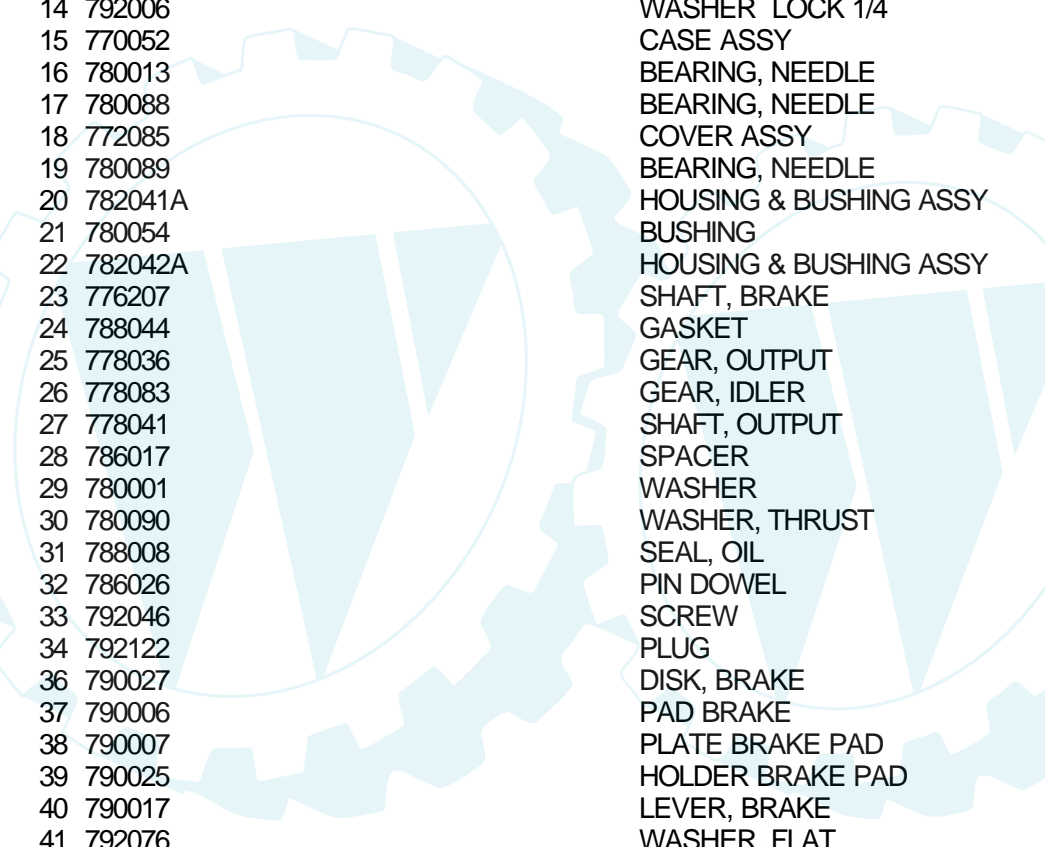

| Ref # | Part Number | Qty | Description |
|-------|-------------|-----|-------------------------------|
| 1 | 778197 | | PINION, 10T |
| 2 | 778198 | | GEAR BEVEL |
| 3 | 786019 | | PIN DRIVE |
| 4 | 786027 | | BLOCK DRIVE |
| 5 | 774028A | | CARRIER, DIFFERENTIAL |
| 6 | 774029A | | CARRIER, DIFFERENTIAL |
| 7 | 778033A | | GEAR, RING |
| 8 | 774526 | | AXLE |
| 9 | 774527 | | AXLE |
| 10 | 780107 | | WASHER |
| 11 | 780042 | | WASHER THRUST |
| 12 | 792018 | | RING STRAP |
| 13 | 792020 | | SCREW, 1/4-20 X 2-1/4 |
| 14 | 792006 | | WASHER LOCK 1/4 |
| 15 | 770052 | | CASE ASSY |
| 16 | 780013 | | BEARING, NEEDLE |
| 17 | 780088 | | BEARING, NEEDLE |
| 18 | 772085 | | COVER ASSY |
| 19 | 780089 | | BEARING, NEEDLE |
| 20 | 782041A | | HOUSING & BUSHING ASSY |
| 21 | 780054 | | BUSHING |
| 22 | 782042A | | HOUSING & BUSHING ASSY |
| 23 | 776207 | | SHAFT, BRAKE |
| 24 | 788044 | | GASKET |
| 25 | 778036 | | GEAR, OUTPUT |
| 26 | 778083 | | GEAR, IDLER |
| 27 | 778041 | | SHAFT, OUTPUT |
| 28 | 786017 | | SPACER |
| 29 | 780001 | | WASHER |
| 30 | 780090 | | WASHER, THRUST |
| 31 | 788008 | | SEAL, OIL |
| 32 | 786026 | | PIN DOWEL |
| 33 | 792046 | | SCREW |
| 34 | 792122 | | PLUG |
| 36 | 790027 | | DISK, BRAKE |
| 37 | 790006 | | PAD BRAKE |
| 38 | 790007 | | PLATE BRAKE PAD |
| 39 | 790025 | | HOLDER BRAKE PAD |
| 40 | 790017 | | LEVER, BRAKE |
| 41 | 792076 | | WASHER, FLAT |
| 42 | 792075 | | LOCKNUT 5/16-24 |
| 43 | 792073 | | SCREW, 1/4-20 X 1-1/4 |
| 43A | 792085 | | SCREW FLNG HEX 1/4-20 X 2-1/4 |
| 44 | 786086 | | BRKT BRAKE LEVER |
| 45 | 786066 | | SPACER |