

ROPER GT TRACTOR--MODEL NUMBERS GT180CR AND GT180CT

ELECTRICAL

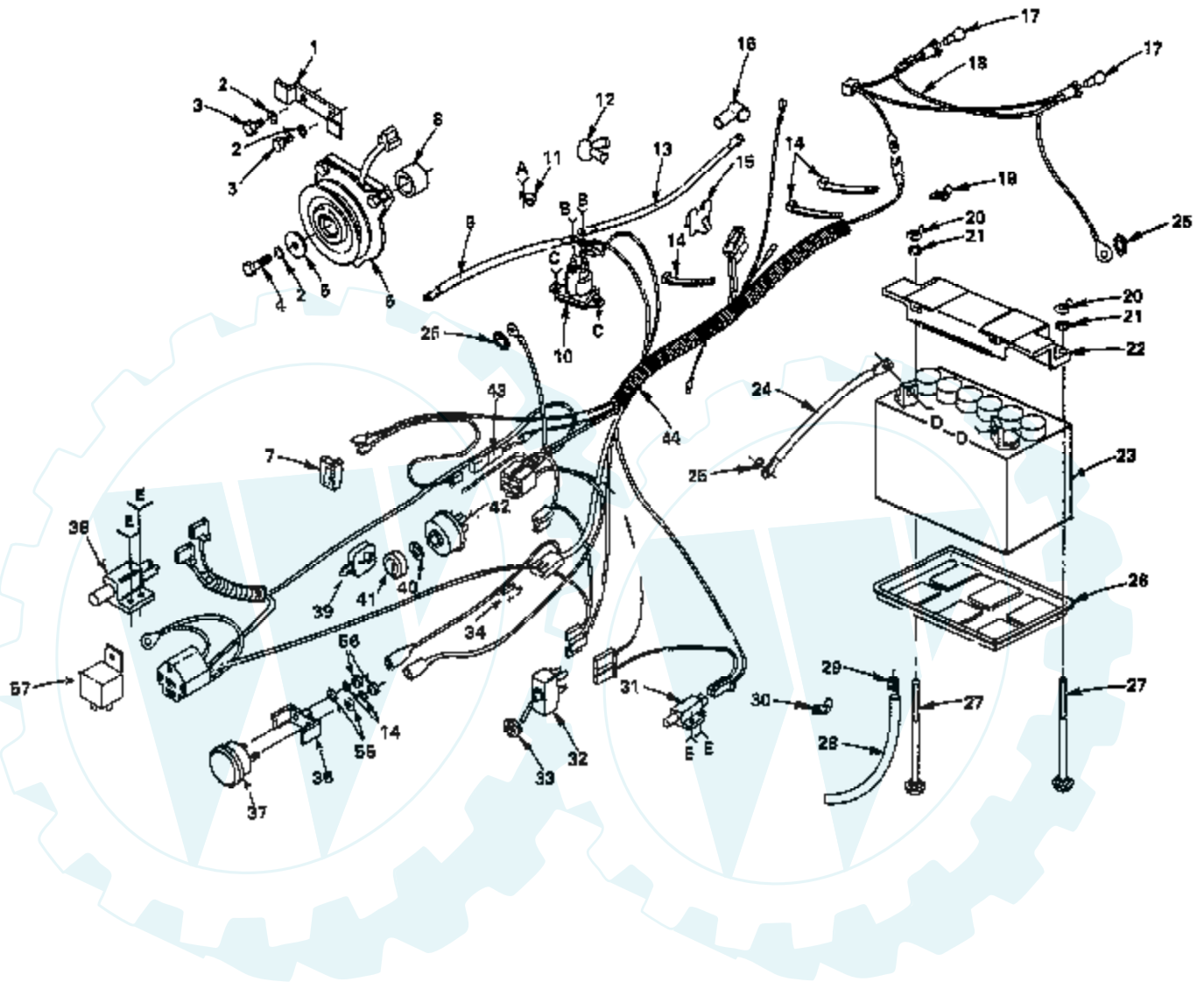

Ref #	Part Number	Qty	Description
1	108170X		STOP CLUTCH T
2	10040600		LOCKWASHER
3	74780612		BOLT
4	74610628		BOLT
5	19132203		WASHER GT
6	109550X		CLUTCH.ELECTRIC.T
7	105381X		SUB= 110712X
8	106367X		SPACER-CLUTCH GT
9	4206J		CABLE-BATTERY T
10	109081X		SUB= 146154
11	4171R		CLIP T
12	51J		TERM COVER DUAL
13	5115J		SUB= 5114J
14	10101000		SUB= 10071000
15	105035X		CLIP-HARNESS
16	719J		SUB= 154336
17	7662J		SUB= 4152J
18	7661J		HARNESS T
19	105034X		CLIP GT
20	73490400		SUB= 146525
21	11030400		LOCKWASHER GT
22	102476X		SUB= 150109
23	227J		SUB= 123899X
24	4207J		CABLE T
25	11050600		LOCKWASHER
26	7603J		"TRAY T, BATTERY"
27	72240460		BOLT
28	100541K		SUB= 7697J
29	109596X		HOSE CLAMP T
30	100207K		CLIP GTV
31	104445X		SWITCH-INTER. GT
32	4021J		SWITCH.PTO.T
33	4022J		HEX NUT T
34	6347R		FUSE-30 AMP
36	6009J		SUB= 532131708
37	9433R		AMMETER T
38	109869X		SWITCH T
39	109434X		KEY MOLDED
40	109788X		SUB= 124211X
41	109787X		SUB= 147626
42	4406R		SUB= STD365402
43	106315X		SUB= 135665
44	109441X		HARNESS-IGNITION
55	19070818		WASHER
56	73911000		NUT
57	109748X		RELAY ASSY T
	101539X		SHEET INSTR LT
	109619X		NLA

ROPER GT TRACTOR--MODEL NUMBERS GT180CR AND GT180CT

FRAME, FENDER AND DRAWBAR

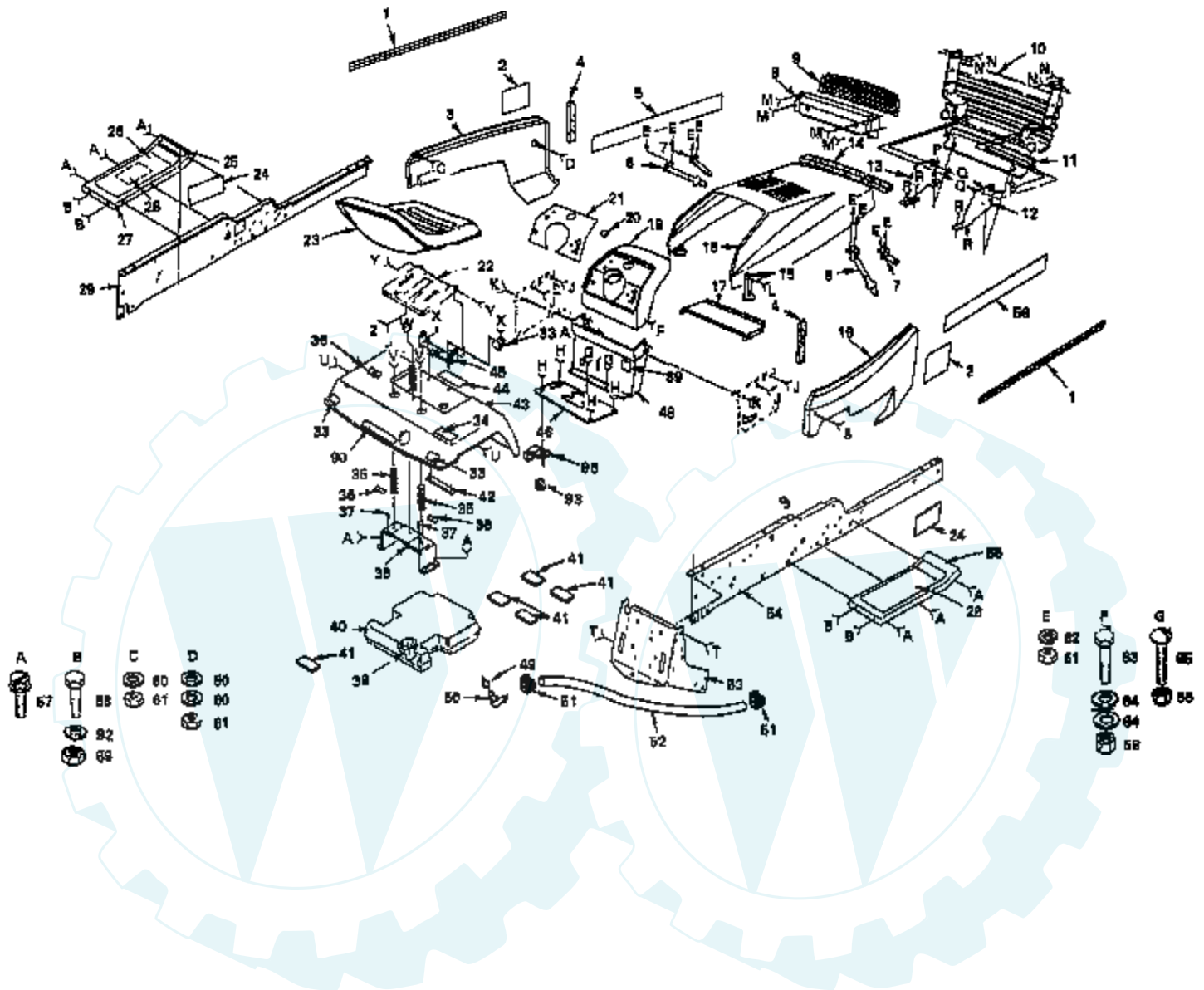

Ref #	Part Number	Qty	Description
1	104646X		NLA
2	104639X		NLA
3	108372X367		SUB= 150302X505
4	105036X		FOAM STRIP HYT
5	104643X		NLA
6	106784X		SUB= 155013
7	104618X		SUB= 155013
8	104613X		SUB= 147717
9	106395X		LENS LT
10	104628X		GRILL GT
11	104634X367		SUB= 105419X388
12	105288X		SUPPORT-GRILL
13	105287X		SUPPORT-GRILL
14	105037X		FOAM-STRIP LT
15	100225L		SUB= 109808X
16	108371X367		SUB= 140679X505
17	7985J		SUB= 140229
18	108370X367		SUB= 150301X505
19	106796X		DASHBOARD T
20	8022J		PLUG-DASH T
21	106797X		DECAL-DASHBOARD
21	108697X		DECAL-DASHBOARD
22	109866X		SEAT PAN T
23	110057X		SUB= 164945
24	104640X		NLA
25	4900J		DECAL T
25	101892X		DECAL T
26	109864X		SUB= 108256X
27	105465X367		SUB= 145244X428
28	106868X		DECAL T
29	105504X		SUB= 151630
32	74760816		SUB= 74780816
33	106202X		REFLECTOR-TAIL YT
33A	2751R		CLIP T
34	7178J		DECAL-CAUTION
34	101893X		NLA
35	105512X		SPRING LT
36	105514X		"CLAMP, SPRING LT"
37	105531X		NUT-PUSH YT
38	105509X		SUB= 137113
39	109462X		SUB= 158990
40	106020X		SUB= 151346
41	106082X		PAD-SPACER LT
42	105511X		SUB= 140675
43	109593X367		NLA
44	106974X		SUB= 133796
44	108658X		SUB= 120822X
45	110378X		BRACKET T
46	106042X		SUB= 106042X012
48	104608X		DASH ASSEMBLY
49	3645J		BUSHING OUTLET T
50	8710J		FUEL TANK STEM GT
51	6999R		SUB= 123487X
52	5277J		SUB= 8543R
53	7982J		SUB= 140506
54	105506X		SUB= 150383
55	105464X367		SUB= 145243X505
56	104644X		NLA

Ref #	Part Number	Qty	Description
57	17490612		SCREW
58	74760612		SUB= 74780612
59	73680600		SUB= 73690600
60	19091216		WASHER PM
61	73220400		SUB= 50675
62	10090400		SUB= 10040400
63	74760616		BOLT
64	19131316		WASHER
65	74180512		SCREW
66	73680500		SUB= 73690500
87	19131416		WASHER
89	8497J		DECAL, INSTRUCTION
89	101895X		NLA
90	104810X		NLA
91	109867X		SPRING T
92	19131312		WASHER
93	109641X		GROMMET T
94	17490616		SCREW GTV
95	4171R		CLIP T

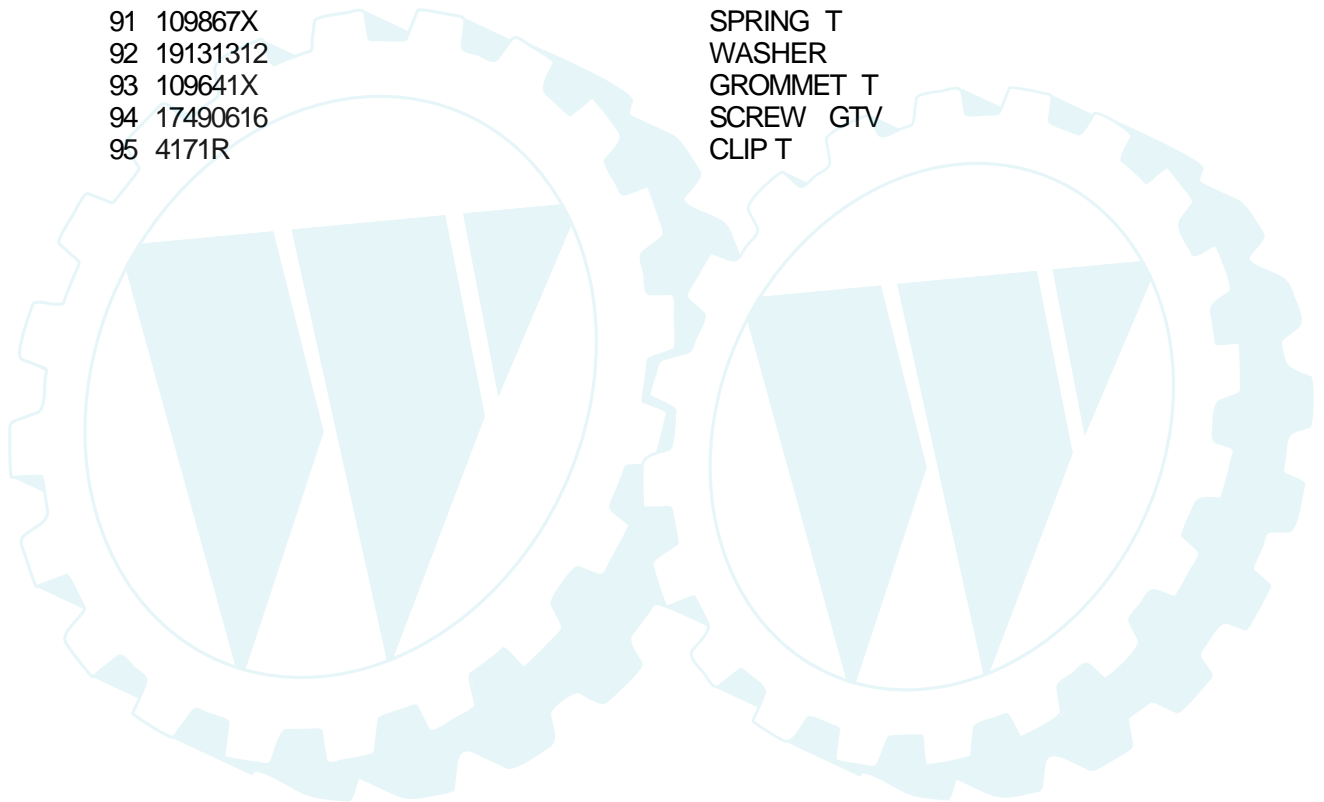

ROPER GT TRACTOR--MODEL NUMBERS GT180CR AND GT180CT

GROUND DRIVE

- | | | | | | | | | | | | |
|----------------------------------|----------------------------|----------------------------|----------------------|----------------------------|-----------------------|-----------------------|-----------------|------------------------|-----------------------|-----------------------|-----------------------|
| A
87
88
88
88 | B
87
88
89 | D
93
94
95 | E
86
87 | F
88
81
82 | G
100
45 | H
101
84 | J
102 | K
103
104 | L
108
88 | M
107
45 | N
101
45 |
|----------------------------------|----------------------------|----------------------------|----------------------|----------------------------|-----------------------|-----------------------|-----------------|------------------------|-----------------------|-----------------------|-----------------------|

- | | | | | | |
|------------------------------|------------------------|------------------------------|------------------------------------|------------------------|-----------------|
| O
107
108
45 | P
128
110 | Q
107
111
45 | R
112
17
94
113 | S
114
115 | T
118 |
|------------------------------|------------------------|------------------------------|------------------------------------|------------------------|-----------------|

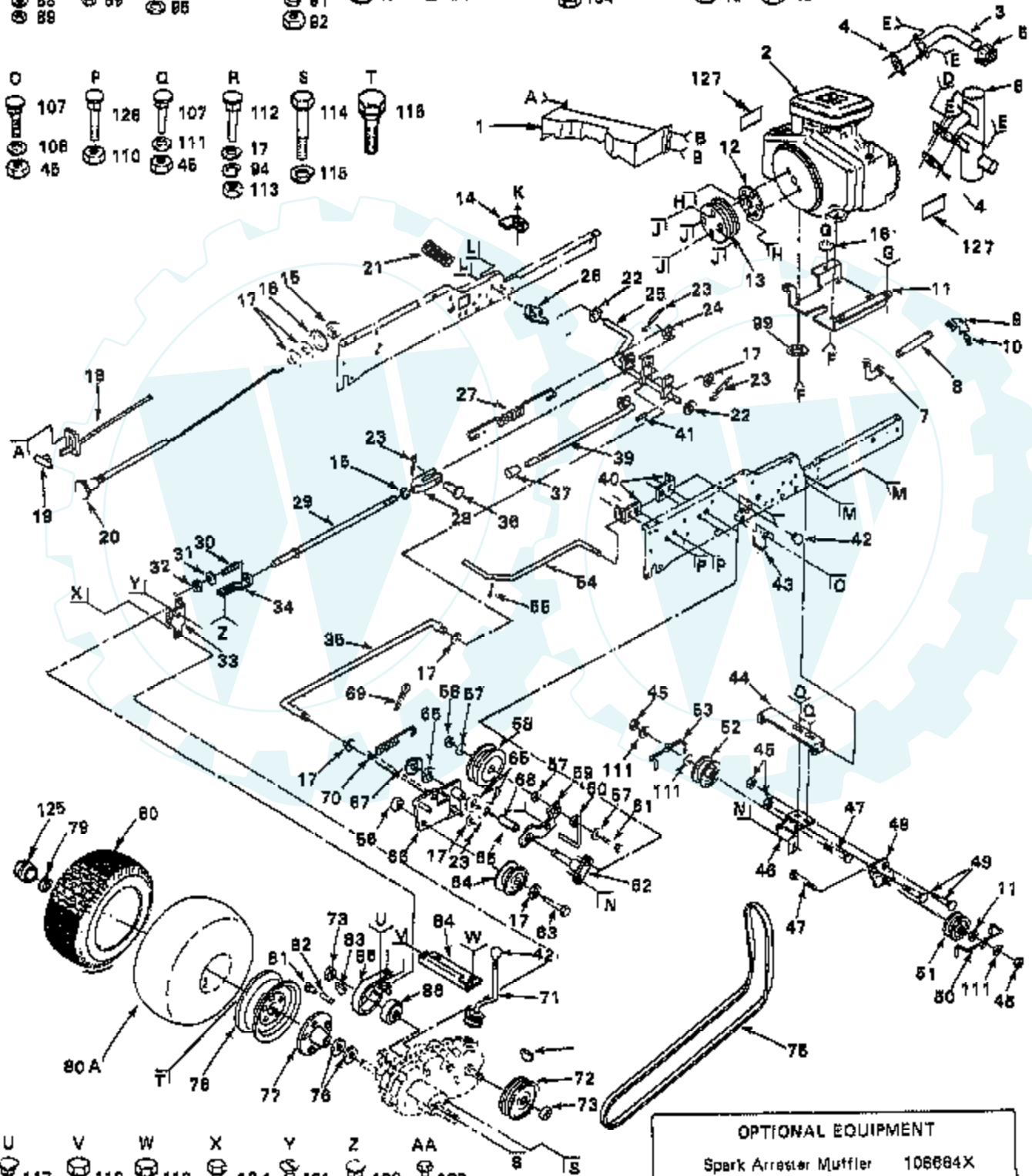

- | | | | | | | |
|------------------------------|------------------------|------------------------|-----------------------------|-----------------|------------------------|------------------------|
| U
117
87
118 | V
119
120 | W
118
115 | X
124
94
17 | Y
121 | Z
109
122 | AA
123
88 |
|------------------------------|------------------------|------------------------|-----------------------------|-----------------|------------------------|------------------------|

OPTIONAL EQUIPMENT
Spark Arrestor Muffler 106684X

Ref #	Part Number	Qty	Description
1	104993X		BAFFLE ASSY-ENGINE
2	108077X		ENGINE
3	100229L		EXHAUST TUBE T
4	8545J		SUB= 272250
5	100000K		CLAMP-TUBE GTV
6	100228N		MUFFLER T
7	13240200		ELBOW
8	13280220		NIPPLE-1/4
9	13200200		NLA
10	13020200		PIPE PLUG
11	5266J		"ENGINE GT, BASE"
12	104577X		ADAPTER T
13	101343L		PULLEY GTV
14	5304J		ACT-SWITCH T
15	73610600		SUB= 7810H
16	11050600		LOCKWASHER
17	19131316		WASHER
18	5693J		THRTL CONTROL T
19	61159		KNOB
20	104596X		SUB= 532132780
21	8883R		PEDAL COVER T
22	19252016		SUB= 121749X
23	76020312		SUB= 3145
24	19111216		WASHER M
25	104375X		SHAFT ASSY GT
26	104601X		BRKT SWITCH GT
27	106021X		EXT SPRING GT
28	100604K		YOKE GTV
29	5308J		BRAKE ROD T
30	7241J		SPRING T
31	19131614		WASHER
32	73530600		SUB= 7810H
33	677A637		BRAKE BRKT ASSY T
34	7229J		GUIDE ROD T
35	101356L		ROD CLUTCH GTV
36	5102J		CLEVIS PIN T
37	71673		PLUNGER CAP T
39	109767X		SUB= 136284
40	105598X		ROD BRACKET GT
41	5142H		ROLL PIN STD
42	100196K		SUB= 106932X
43	105500X		BELT RETAINER GT
44	105599X		BRACKET-DRIVE GT
45	73680600		SUB= 73690600
46	106000X		BRKT-V-PULLEY GT
47	72110616		BOLT
48	5255J		BRACKET
49	72140606		BOLT
50	106048X		NLA
51	102403X		IDLER-FLAT T
52	101344L		PULLEY V IDLR GTV
53	106023X		BELT GUARD GT
54	101345M		ROD SHIFT GTV
55	76020616		SUB= 76020624
56	73930600		LOCKNUT
57	19131413		WASHER
58	104360X		SUB= 131494
59	101347L		BRACKET GTV

Ref #	Part Number	Qty	Description
60	105597X		BELT RETAINER GT
61	74760632		SUB= 74930632
62	101358K		BRACKET ASSY GTV
63	74760624		SUB= 74930624
64	8846R		SUB= 110484X
65	207J		WASHER T
66	105592X		CLUTCH BRACKET GT
67	12000039		KLIP RING
68	101350K		"GTV, BEARING"
69			CHECK WITH SUPPLIER
70	101355X		SPRING GTV
71	633A109		GEAR SHFT LVR T
72	101341M		PULLEY GTV
73	9204H		NUT STD
74	9858M1		KEY
75	101342N		BELT-V.93.07
76	7563R		WASHER T
77	634A692		SUB= 149176X431
78	106277X		SUB= 106277X417
79	12000034		KLIP RING
80	4607R		SUB= 122077X
80A	7154J		TUBE.23X8/10-12
81	59192		VALVE CAP
82	65139		VALVE STEM LT
83	2228M		SUB= 2228M1
84	7952J		SUB= 156404
85	7920J		SUB= 101122M
86	214J		BRAKE DRUM T
87	74780412		SUB= 74780414
88	19091016		WASHER
89	73680400		SUB= 73690400
90	72010510		BOLT
91	10040500		LOCKWASHER
92	73220500		NUT.HEX.5/16-18
93	74780612		BOLT
94	10040600		LOCKWASHER
95	19131210		WASHER
96	74570412		SCREW GTV
97	10040400		LOCKWASHER
98	74780520		BOLT
99	11050500		LOCKWASHER.5/16.E
100	74760612		SUB= 74780612
101	74780616		BOLT
102	17190512		SCREW T
103	74321016		SCREW
104	73631000		SUB= 69180
105			CHECK WITH SUPPLIER
107	72110608		BOLT D
108	19131312		WASHER
109	72110506		SUB= 72270506
110	73680500		SUB= 73690500
111	19131612		WASHER GT
112	72140608		SUB= 72110608
113	73220600		NUT.HEX.3/8-16UNC
114	74760724		BOLT
115	10040700		LOCKWASHER
116	1304H		SUB= 140080
117	72140405		BOLT T

Ref #	Part Number	Qty	Description
118	73220400		SUB= 50675
119	74760716		BOLT
120	73680700		NUT GTV
121	74370612		SCREW
122	1685H		SUB= 68478
123	17720408		SCREW
124	74760614		SUB= 74760616
125	104758X		CAP-HUB GT
126	72140506		BOLT
127	110041X		NLA



ROPER GT TRACTOR--MODEL NUMBERS GT180CR AND GT180CT

ELECTRICAL

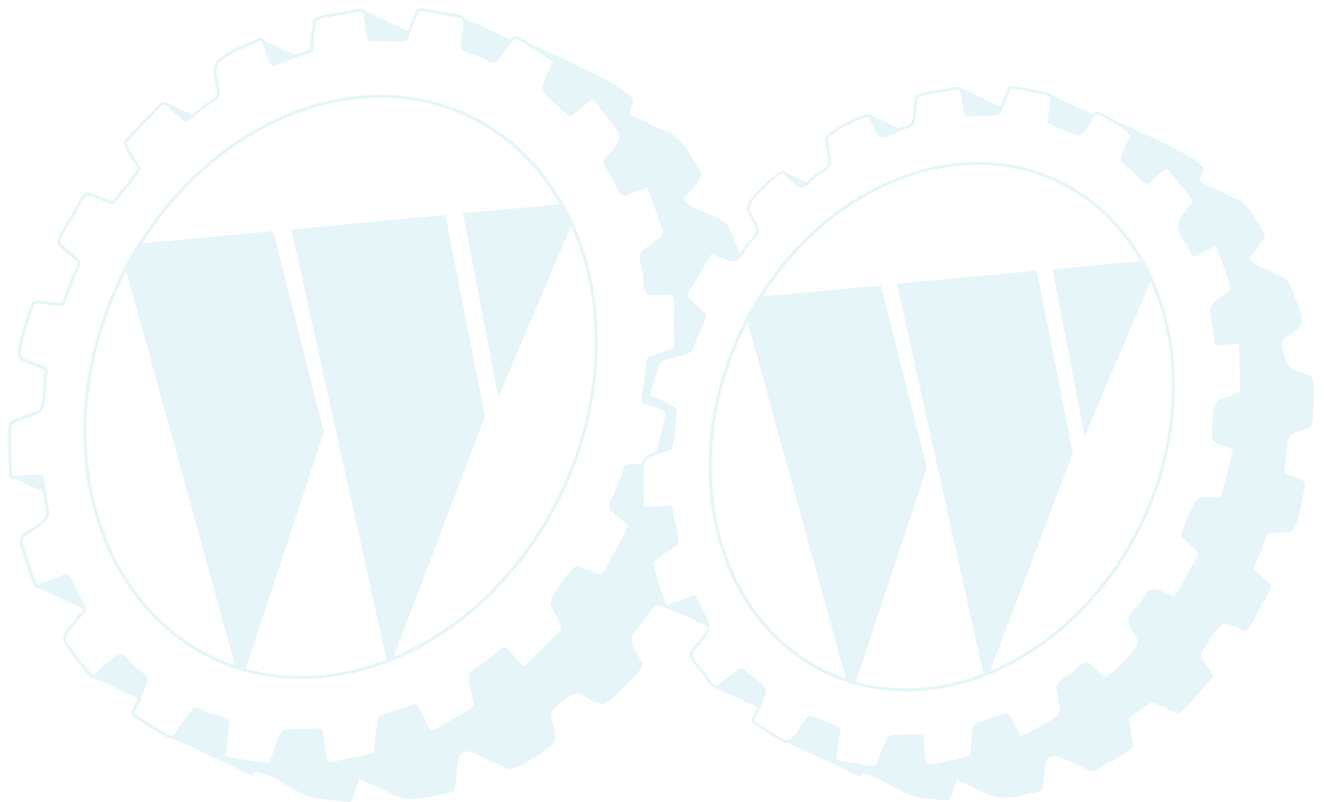
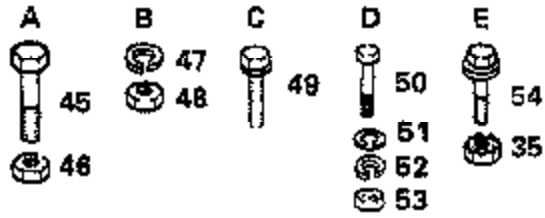

Ref #	Part Number	Qty	Description
11	4171R		CLIP T
35	73951000		"NUT,KEPS"
45	74760512		BOLT
46	73680500		SUB= 73690500
47	10090400		SUB= 10040400
48	73350400		NUT
49	17190408		SCREW ST
50			CHECK WITH SUPPLIER
51	19091016		WASHER
52	10040400		LOCKWASHER
53	73220400		SUB= 50675
54	71031008		SCREW
	101539X		SHEET INSTR LT
	109619X		NLA

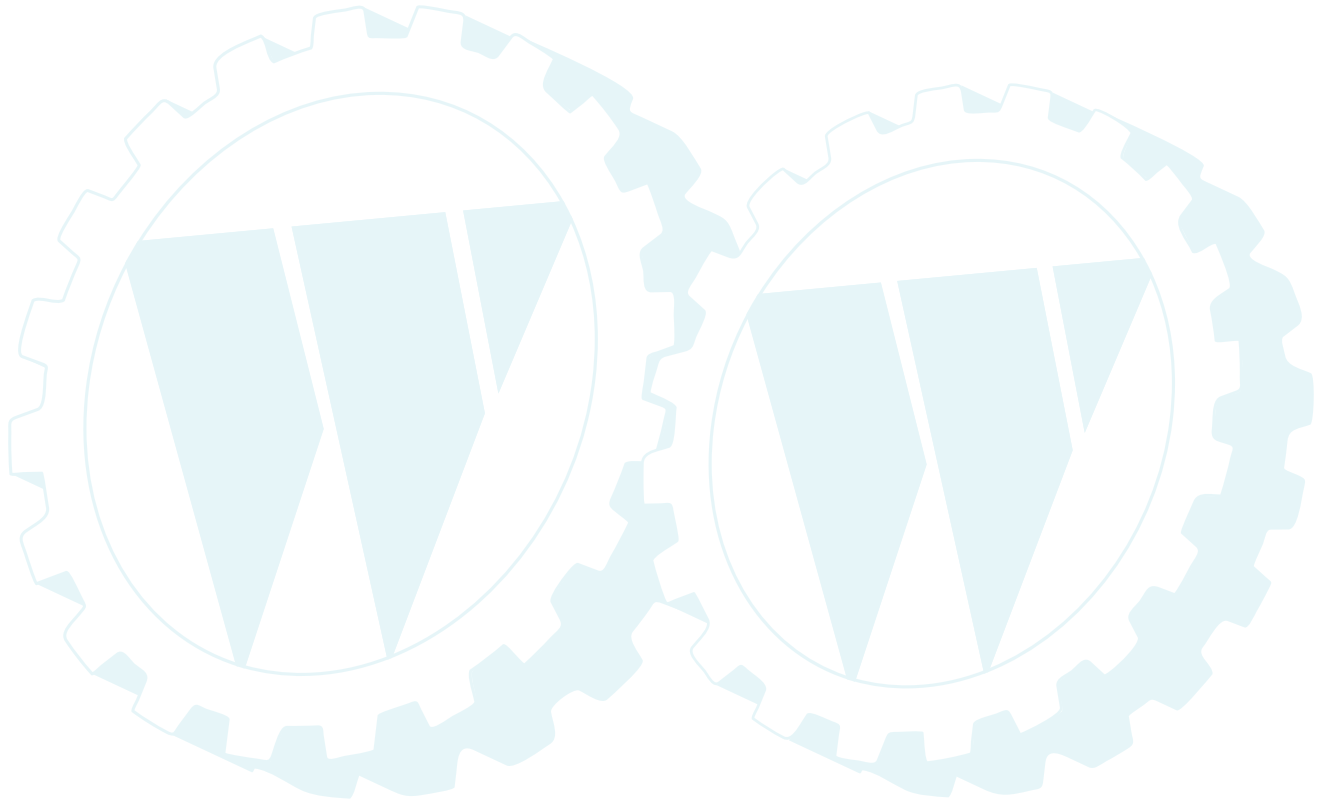

ROPER GT TRACTOR--MODEL NUMBERS GT180CR AND GT180CT

FRAME, FENDER AND DRAWBAR

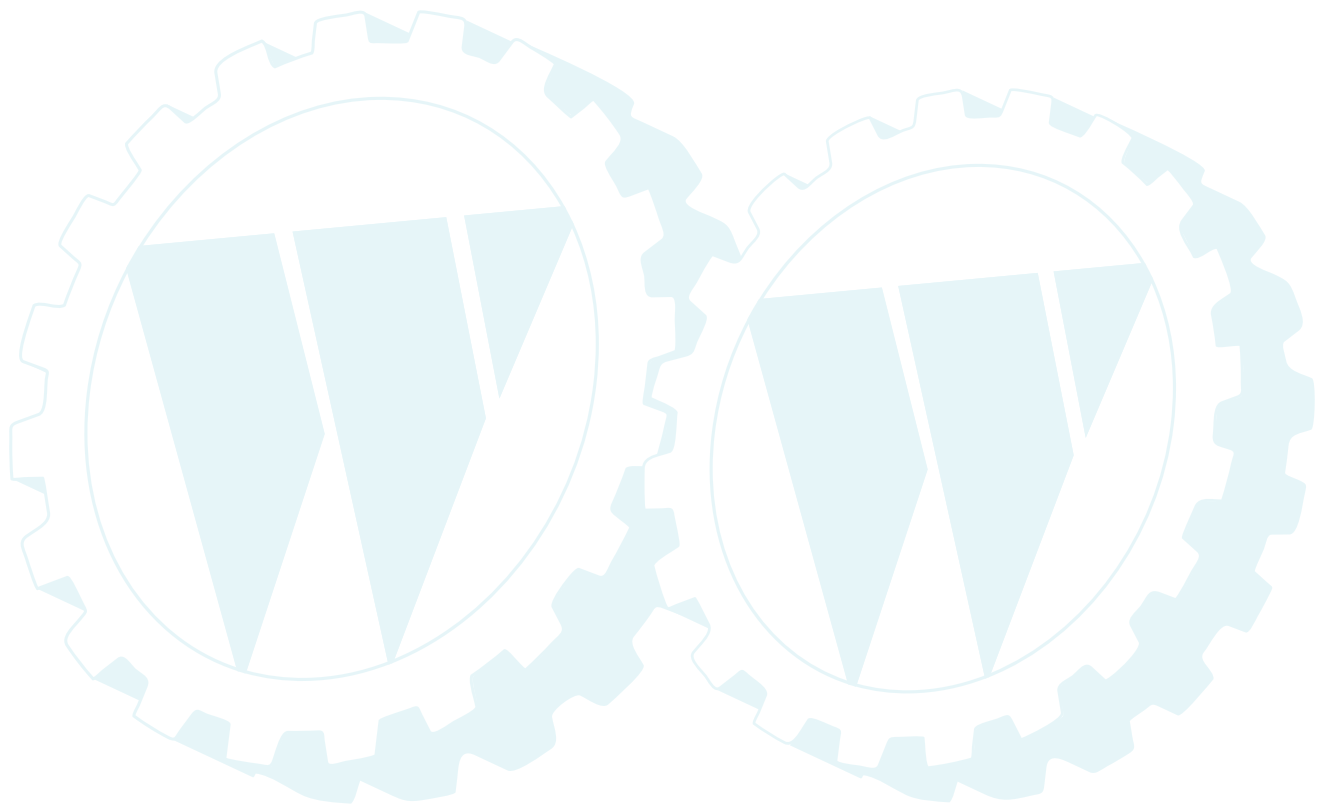
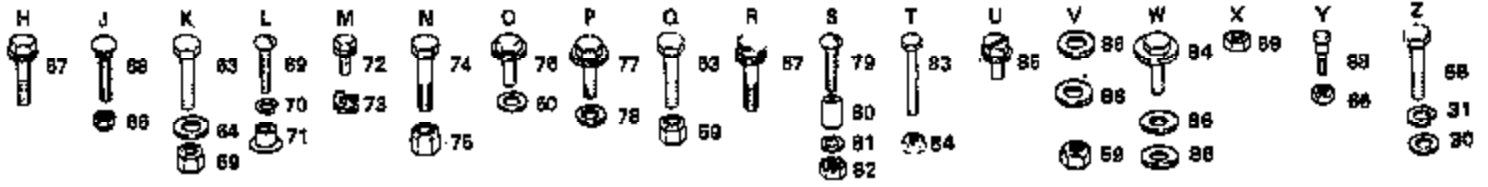

Ref #	Part Number	Qty	Description
30	19131312		WASHER
31	10040600		LOCKWASHER
57	17490612		SCREW
58	74760612		SUB= 74780612
59	73680600		SUB= 73690600
60	19091216		WASHER PM
63	74760616		BOLT
64	19131316		WASHER
66	73680500		SUB= 73690500
67	17240408		SUB= 17720408
68	72140506		BOLT
69	74191008		SCREW
70	10071000		LOCKWASHER
71	2029J		WELDNUT
72	17211010		SCREW LT
73	104755X		""J"" FASTENER LT"
74	7605J		BOLT T
75	73680400		SUB= 73690400
76	17490412		SCREW HEX CRT
77	17490512		SCREW
78	19111216		WASHER M
79	74981020		SCREW
80	7206J		SPACER LT
81	19070818		WASHER
82	73731000		NUT
83	74760716		BOLT
84	73680700		NUT GTV
85	17490608		SCREW LT
86	19132012		WASHER
88	105529X		SUB= 139888
94	17490616		SCREW GTV

ROPER GT TRACTOR--MODEL NUMBERS GT180CR AND GT180CT

MOWER LIFT

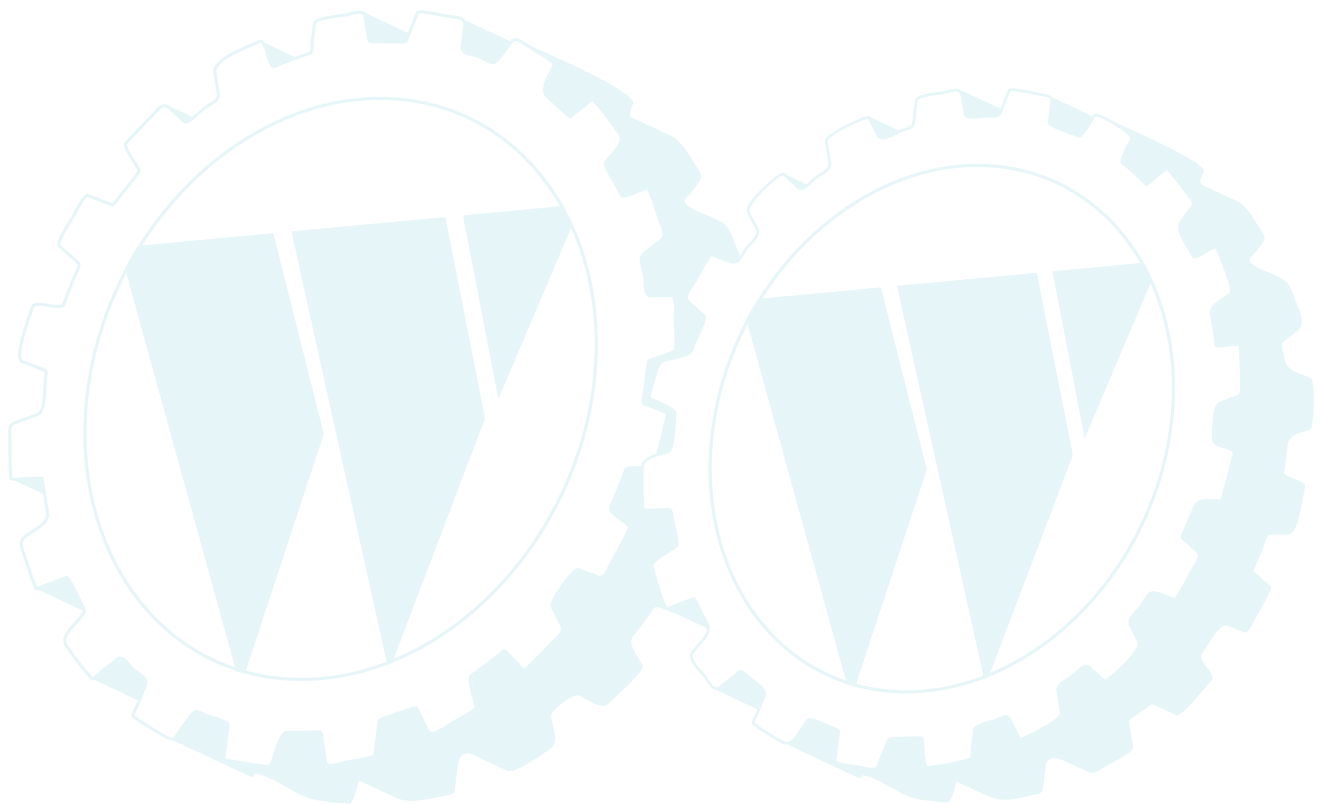
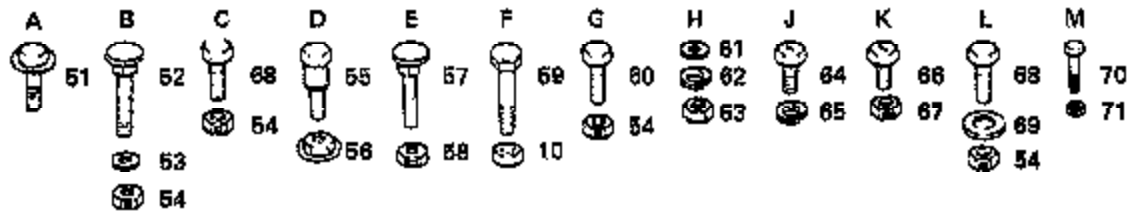

Ref #	Part Number	Qty	Description
10	73680600		SUB= 73690600
51	17490608		SCREW LT
52	72140508		BOLT
53	19111610		WASHER
54	73680500		SUB= 73690500
55	7901J		SHOULDER BOLT T
56	73900400		NUT T
57	72140606		BOLT
58	73930600		LOCKNUT
59	74760616		BOLT
60	74350512		BOLT LT
61	19091216		WASHER PM
62	10090400		SUB= 10040400
63	73220400		SUB= 50675
64	74750806		SCREW GT
65	10070800		NLA
66	74321008		NLA
67	73631000		SUB= 69180
68	74760512		BOLT
69	19111216		WASHER M
70	74780408		BOLT
71	73680400		SUB= 73690400

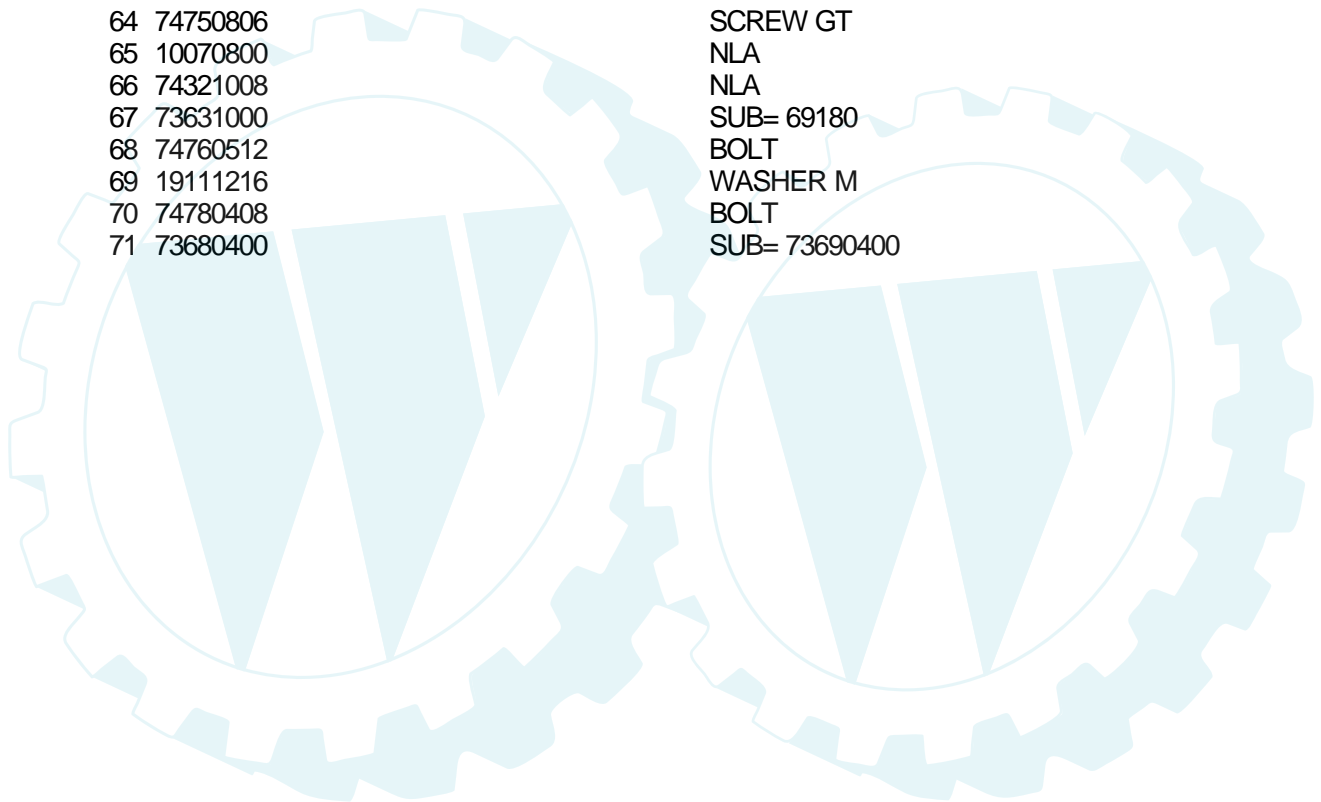

ROPER GT TRACTOR--MODEL NUMBERS GT180CR AND GT180CT

MOWER

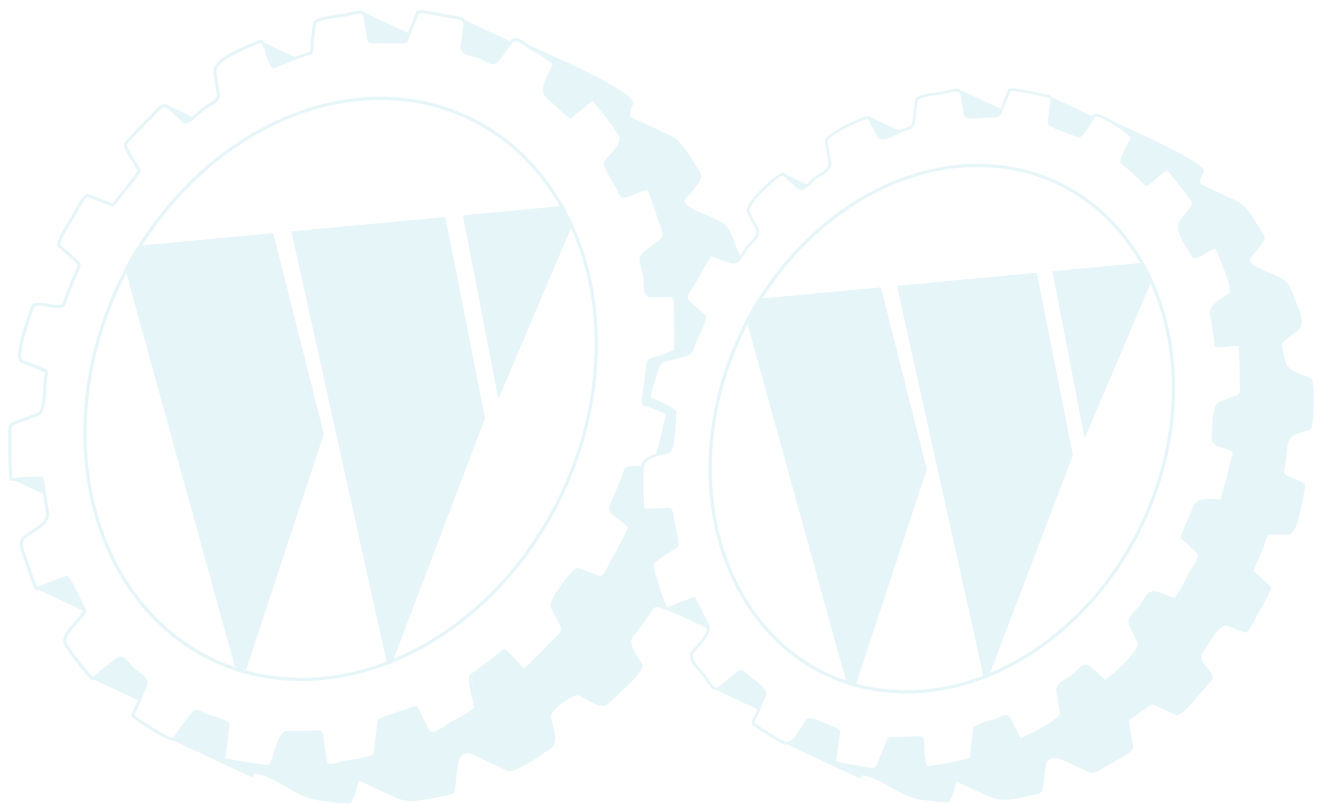
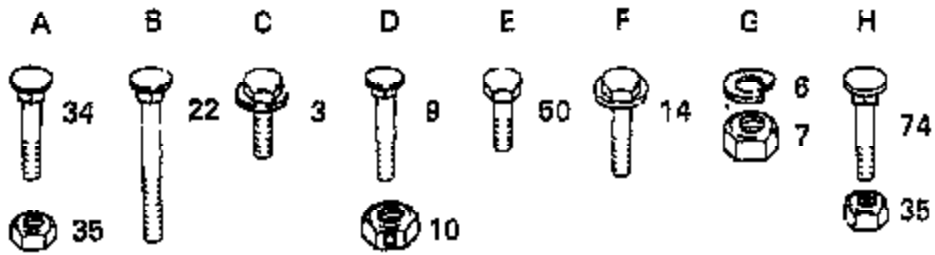

Ref #	Part Number	Qty	Description
3			CHECK WITH SUPPLIER
6	10040500		LOCKWASHER
7	73220500		NUT.HEX.5/16-18
9	72140506		BOLT
10	1685H		SUB= 68478
14	17490612		SCREW
22	72110522		BOLT
34	72240606		BOLT
35	73680600		SUB= 73690600
50	74760622		BOLT
74	72240608		BOLT



ROPER GT TRACTOR--MODEL NUMBERS GT180CR AND GT180CT

STEERING

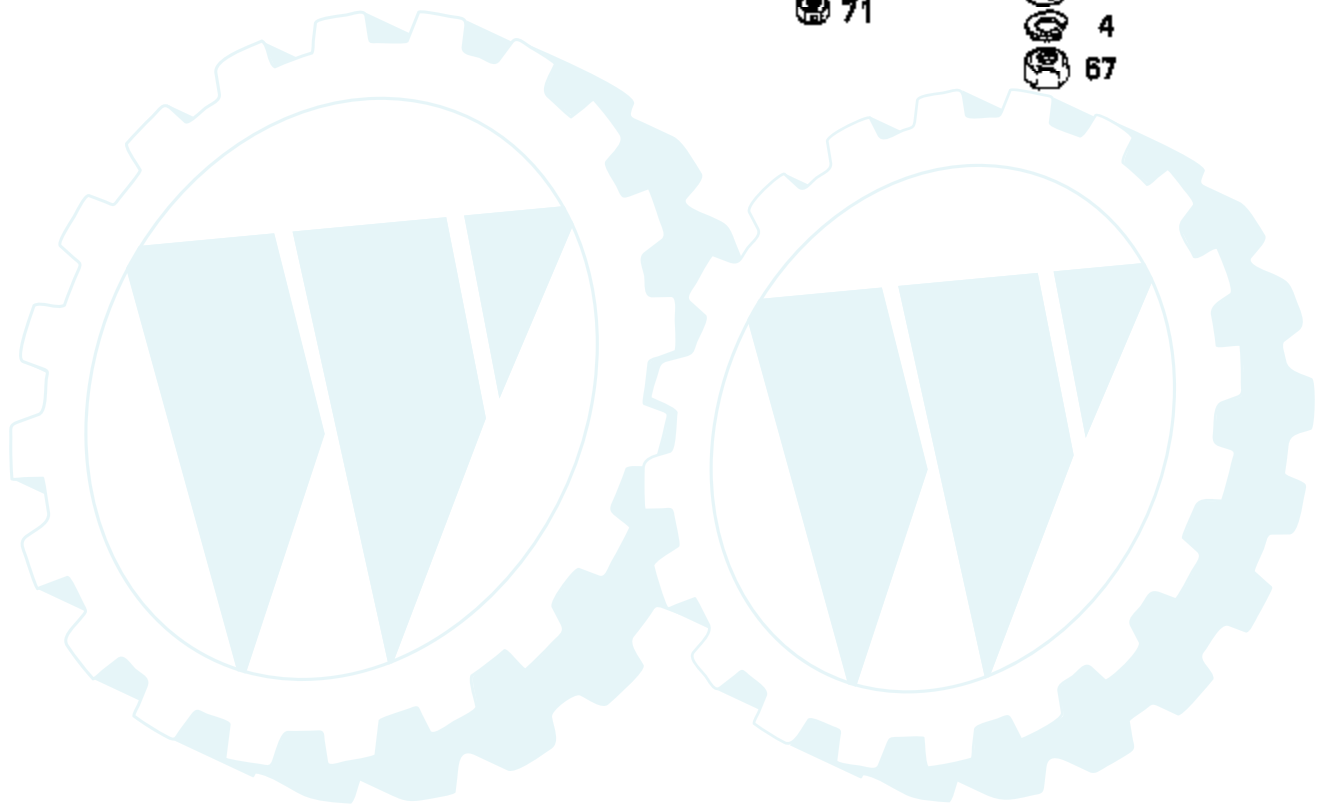
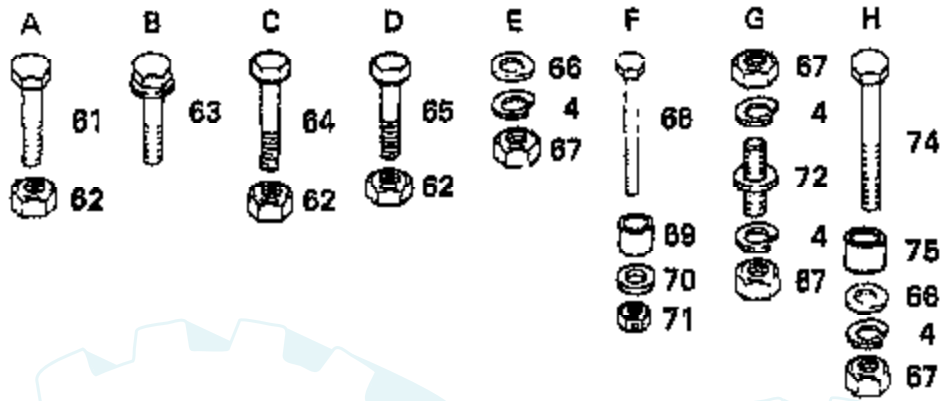

Ref #	Part Number	Qty	Description
4	10040600		LOCKWASHER
61	74760612		SUB= 74780612
62	73680600		SUB= 73690600
63	17490612		SCREW
64	74780616		BOLT
65	74760616		BOLT
66	19131413		WASHER
67	73220600		NUT.HEX.3/8-16UNC
68	74930516		BOLT GT
69	100644K		BUSHING LT
70	19111416		WASHER
71	73680500		SUB= 73690500
72	106615X		SUB= 677A928
74	74760632		SUB= 74930632
75	102933X		SPLIT SPACER YTV

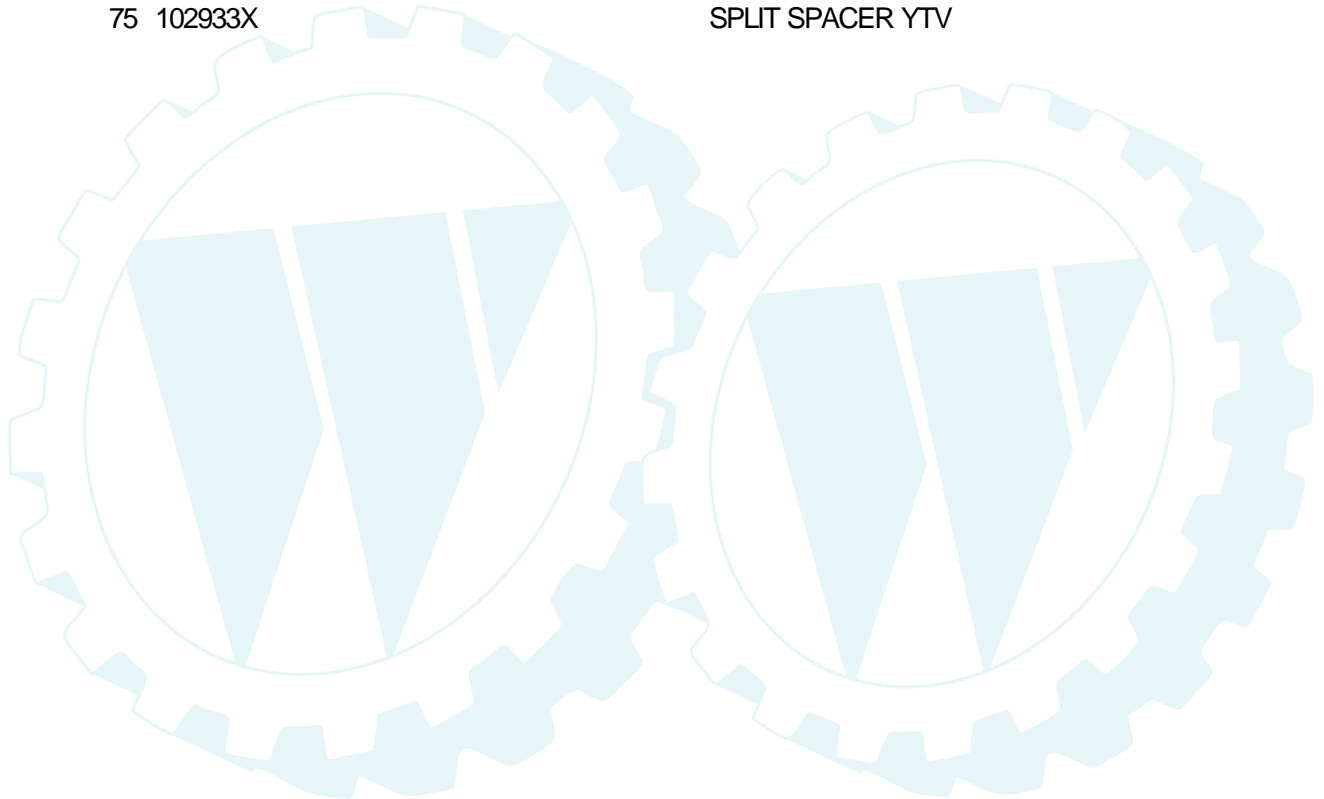

ROPER GT TRACTOR--MODEL NUMBERS GT180CR AND GT180CT

MOWER

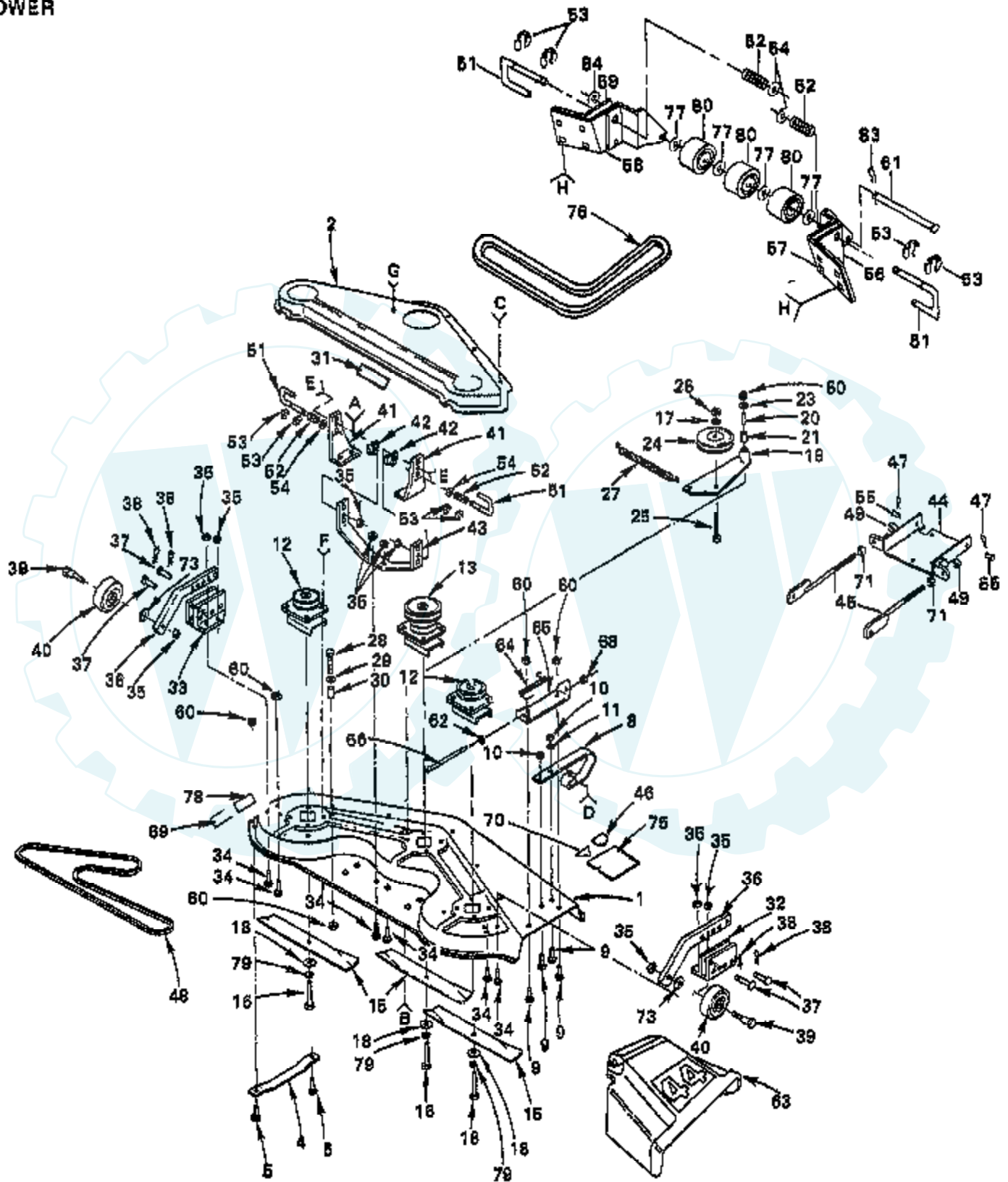

Ref #	Part Number	Qty	Description
1	105415X		SUB= 144730
2	106022X		DECK DRV COVE T
4	7631J		RUNNER-LH M
5	72110505		BOLT
8	8418J		SUB= 136321
9	72140506		BOLT
10	1685H		SUB= 68478
11	19111116		WASHER
12	105483X		SUB= 136819
13	106038X		SUB= 121657X
15	106635X		SUB= 25034
16	74610624		BOLT.3/8-24X1-1/2
17	10040600		LOCKWASHER
18	19132012		WASHER
19	674A213		ARM ASSY GT
20	7834J		SUB= 674A308
21	7835J		SUB= 674A308
23	19111610		WASHER
24	102403X		IDLER-FLAT T
25	74760624		SUB= 74930624
26	73220600		NUT.HEX.3/8-16UNC
27	104361X		SPRING T
28	74780520		BOLT
29	19111216		WASHER M
30	8438J		SPACER SPLIT LT
31	106224X		SUB= 139346
32	105448X		GUAGE WHL BRKT GT
33	105449X		GUAGE WHL BRKT GT
34	72240606		BOLT
35	73680600		SUB= 73690600
36	105453X		GUAGE WHL BAR GT
37	5565J		SUB= 139031
38	4939M		SUB= 85902
39	4898H		BOLT M
40	105455X		WHEEL.GAGE.BLK.PL
41	105433X		SUSP BRKT GT
42	110237X		SPACER GT
43	105434X		SUSP BRACE GT
44	109778X		SUB= 140741X431
45	109771X		BRACKET.SUSPEN.AS
46	78850		SUB= 85463
46	107339X		DECAL HYT
47	3146R		RETAINER.SPRING
48	106381X		V-BELT
49	73680800		NUT LTV
51	105435X		RELEASE PIN GT
52	3720R		SPRING M
53	12000039		KLIP RING
54	19171612		WASHER GT
55	105440X		CLEVIS PIN GT
56	105456X		OUTER BRKT RH GT
57	109773X		BRACKET T
58	109775X		BRACKET T
59	105457X		OUTER BRKT LH GT
60	73680500		SUB= 73690500
61	109776X		PIVOT PIN T
62	19111016		WASHER
63	109785X		DEFLECTOR SHIELD

Ref #	Part Number	Qty	Description
64	106734X		SUB= 123713X
65	109743X		SUB= 137607
66	106735X		ROD-HINGE T
68	5846R		SUB= 110452X
69	3713J		DECAL INSTRUCTION CAUTION
70	106975X		DECAL - SAFETY STANDARD
71	73220800		NUT
73	19171512		WASHER
75	109819X		NLA
76	106863X		SUB= 108597X
77	19151610		WASHER T
78	105185X		DECAL-INST YT
79	10030600		SUB= 10040600
80	109729X		ROLLER T
82	19151616		SUB= 19171616
83			CHECK WITH SUPPLIER
84	19151616		SUB= 19171616

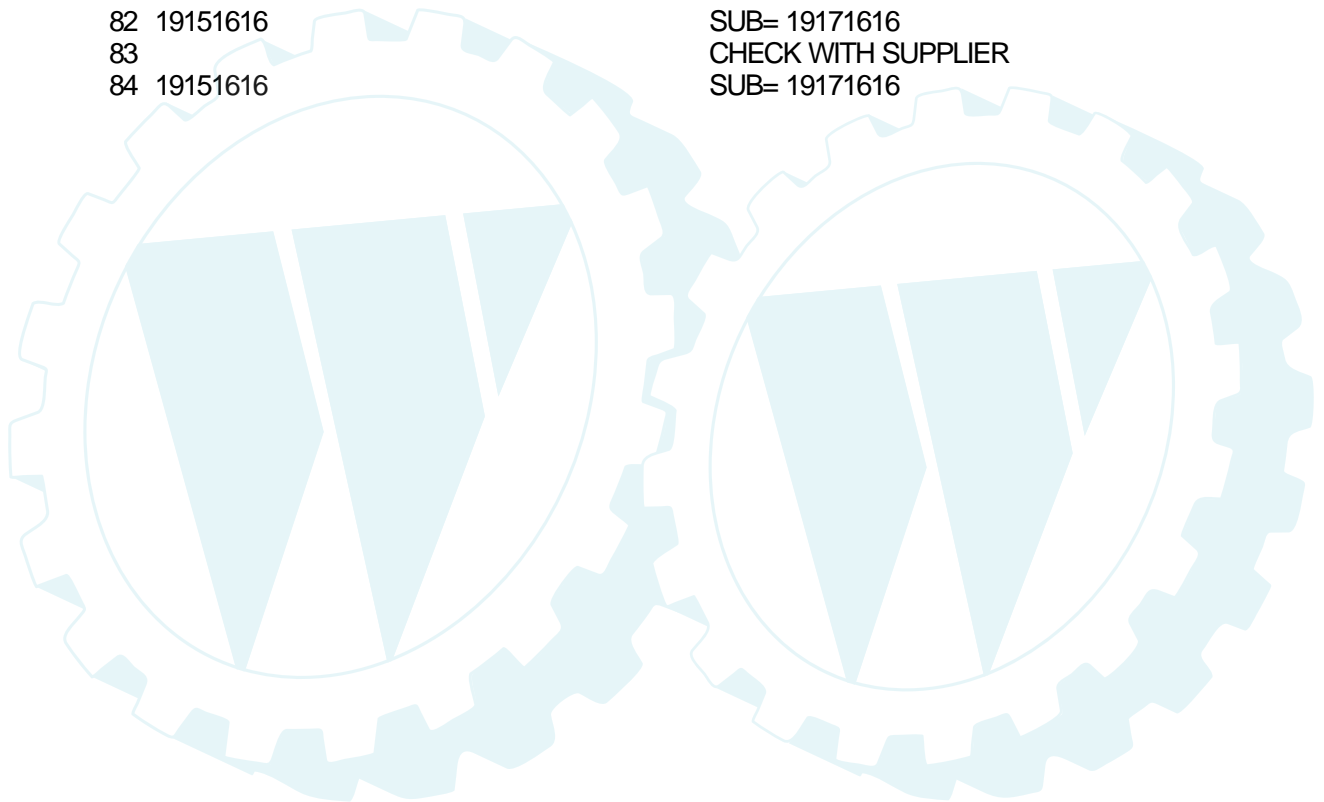

ROPER GT TRACTOR--MODEL NUMBERS GT180CR AND GT180CT

MOWER LIFT

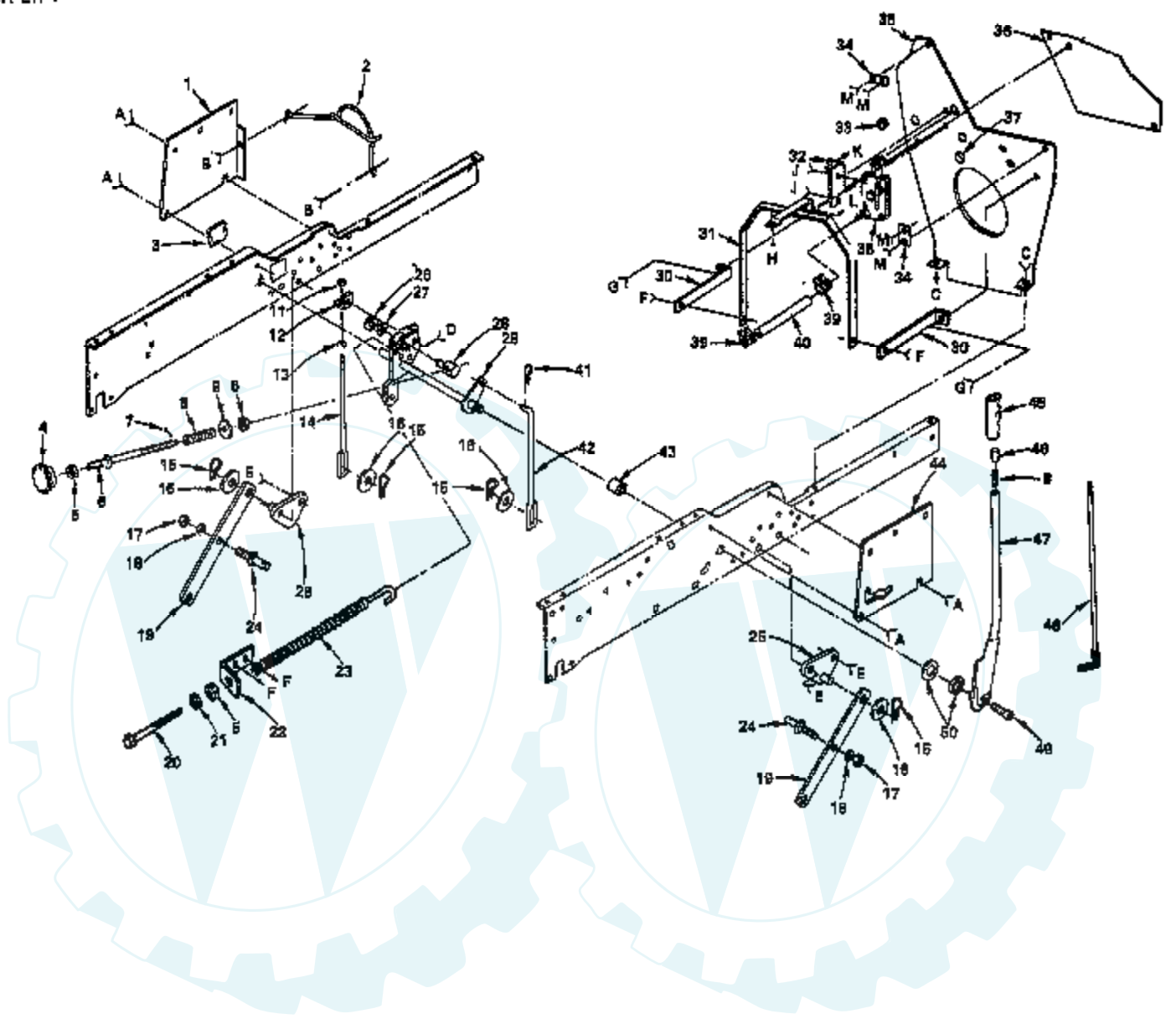

Ref #	Part Number	Qty	Description
1	106793X		SUB= 532121046
2	105589X		ENGINE BELT GUARD
3	105505X		SUB= 121794X
4	100734K		SUB= 138057
5	73350600		NUT
6	106318X		ADJ ROD GT
7	76020308		SUB= 3145
8	2876H		SPRING T
9	19131016		WASHER
11	73800600		NUT
12	7594J		BRACKET T
13	73220600		NUT.HEX.3/8-16UNC
14	7596J		LINK-LIFT MOW T
15	9135R		SPRING H
16	19171713		SUB= 146537
17	73220800		NUT
18	10040800		LOCKWASHER
19	105429X		SUSPENSION ARM GT
20	5328J		BOLT-ADJ SPRING T
21	19131316		WASHER
22	5329J		SUB= 143363
23	674A247		SUB= 918674A247
24	105413X		PIVOT STUD GT
25	105501X		SUSP BRACKET T
26	12000037		KLIP RING
27	19151216		WASHER
28	6519J		TRUNION T
29	105633X		LIFT SHAFT GT
30	104649X		BRKT-SHIELD, HEAT, SIDE
31	106872X		SUB= 532128141
32	105040X		BRACKET GT
33	9151R		SNAP BUSHING T
34	105105X		STRAP, TIE
35	106791X		NLA
36	108125X		PANEL-SHIELD, HEAT
37	106351X		PLUG GT
38	105041X		SUB= 129979
39	6999R		SUB= 123487X
40	3008J		SUB= 7833R
41	4939M		SUB= 85902
42	105503X		LIFT LINK RH T
43	106012X		SPACER GT
44	106792X		SUB= 532121045
45	109413X		GRIP
46	105723X		SUB= 125925X
47	109987X		SUB= 123096X
48	110026X		SUB= 121006X
49	74570632		SCREW LT
50	105630X		WASHER YT

HOPER GT TRACTOR--MODEL NUMBERS GT180CR AND GT180CT STEERING

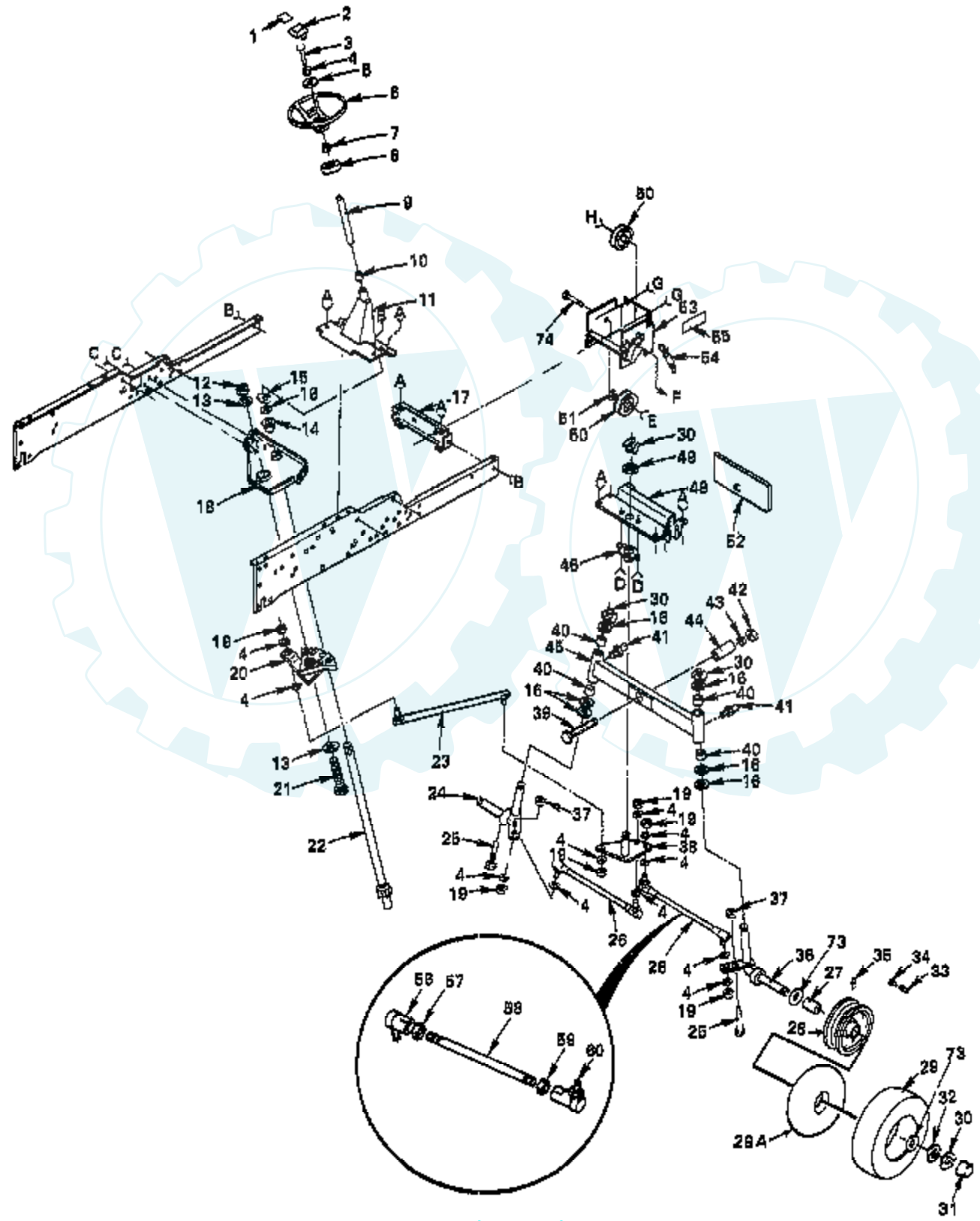

Ref #	Part Number	Qty	Description
1	104590X		DECAL - STEERING WHEEL
2	100710L		INSERT-WHEEL LT
3	74780616		BOLT
4	10040600		LOCKWASHER
5	19133808		WASHER T
6	100713N		SUB= 150547
7	100711L		ADAPTER LT
8	106943X		SPACER LT
9	108540X		TUBE
10	9038R		"T, BEARING"
11	101274N		SUPPORT ASSY T
12	73680800		NUT LTV
13	19172610		WASHER GT
14	104239X		"FLANGE GT, BEAR."
15	12000034		KLIP RING
16	6266H		WASHER .T
17	5213J		FRAME BRACKET GT
18	102439X		SUB= 144668
19	73610600		SUB= 7810H
20	108134X		SECTOR ASM
21	74760832		BOLT
22	104591X		SHAFT STEERING GT
23	108136X		SUB= 110497X
24	106046X		SPINDLE ASSY T
25	74520632		BOLT, HEX 3/8 - 16 X 2
26	7990J		SUB= 109849X
27	9040H		"FLANGE, BEARING"
28	106228X		SUB= 106228X417
29	3938R		SUB= 122075X
29A	8134H		TUBE.16X6.5/7.5-8
30	12000029		RING
31	104757X		HUB CAP
32	19252016		SUB= 121749X
33	59192		VALVE CAP
34	65139		VALVE STEM LT
35	278H		FITTING LT
36	106045X		SPINDLE RH T
37	73510600		NUT
38	108137X		"T, BELLCRANK"
39	74781044		BOLT
40	1309H		BRNG. T
41	6855M		ZERK M
42	73221000		NUT X
43	10041000		WASHER
44	5298J		SUB= 136518
45	674A243		AXLE ASSEMBLY
46	5292J		SUB= 140342
48	5284J		AXLE BRACKET T
49	19292016		WASHER
50	677A451		IDLER-INSIDE T
51	19132007		WASHER T
52	104989X		NLA
53	108253X		SUB= 120542X
54	7190J		SPRING
55	108367X		DECAL T
56	8922R		SUB= 109851X
57	73700600		NUT
58	7919J		SUB= 121159X

Ref #	Part Number	Qty	Description
59	73360600		NUT
60	8921R		SUB= 109850X
73	19252616		SUB= 121748X
74	74760632		SUB= 74930632



ROPER GT TRACTOR--MODEL NUMBERS GT180CR AND GT180CT

TRANSAXLE

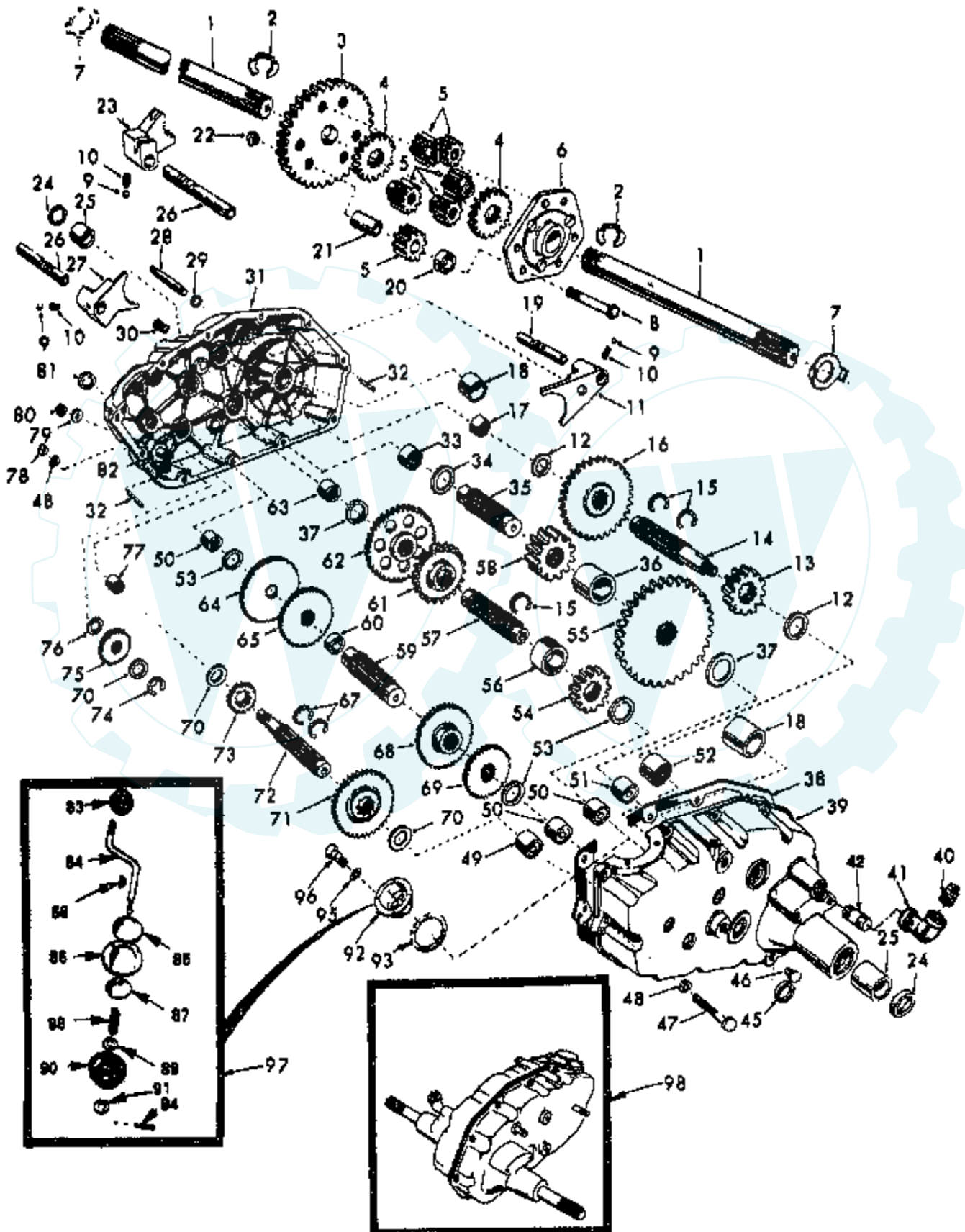

Ref #	Part Number	Qty	Description
1	4197R		SHAFT.AXLE.T
2	5845R		SUB= 12000034
3	4199R		FINAL GEAR T
4	4216R		DIFF GEAR T
5	4215R		DIFF PINION T
6	4217R		DIFF CARRIER T
7	6256H		WASHER T
8	74020652		BOLT
9	7392M		SUB= 100482K
10	6272H		SUB= 145359
11	4985R		SHIFT FORK T
12	6266H		WASHER .T
13	4212R		RED PINION T
14	4196R		GEAR SHAFT T
15	6276H		SNAP RING T
16	633A63		GEAR T
17	8118M		"T, BEARING"
18	8740H1		BEARING
19	6217H		SUB= 122238X
20	4218R		SPACER T
21	6252H1		PINION RS
22	7810H		GRIPCO NUT
23	4986R		SHIFT FORK T
24	7393R		OIL SEAL STD
25	992R1		BRNG. T
26	6216H		SHAFT T
27	6262H		FORK T
28	101416X		SHIFT SHAFT GTV
29	6269H		SEAL T
30	5855H		VALVE M
31	105406X		SUB= 122162X
32	6277H		PIN T
33	4225R		NEEDLE BRNG T
34	7396H		RACE T
35	4198R		GEAR SHAFT T
36	4200R		SUB= 532004200
37	7395H		RACE T
38	6275H		SUB= 121878X
39	105402X		SUB= 122163X
40	13060400		SUB= 13320400
41	13200400		NLA
42	13280424		NIPPLE
45	6271H		SEAL T
46	13060200		SUB= 13020200
47	74780524		HEX BOLT
48	10140500		SUB= 10040500
49	4895H		"TI, BEARING"
50	4222R		NEEDLE BRNG T
51	1529R		NEEDLE BRNG T
52	8119M		"STD, BEARING"
53	4220R		BRNG RACE
54	4209R		RED PINION T
55	4213R		RED GEAR T
56	4442R		PINION SPACER T
57	4195R		GEAR SHAFT T
58	4214R		FINAL PINION T
59	4194R		GEAR SHAFT T
60	7528R		SPACER T

Ref #	Part Number	Qty	Description
61	4208R		RED PINION T
62	4207R		RED GEAR T
63	7398H		RACE T
64	4203R		LOW SPEED GEA T
65	4204R		REVERSE GEAR T
66	2898J		KEY T
67	4926H		RING STD
68	4205R		INTERMED GEAR T
69	4206R		SUB= 532004206
70	1370H		"T, BEARING"
71	633A69		CLUSTER GEAR T
72	208J		INPUT SHAFT T
73	4201R		LO SPEED PINION T
74	12000002		SUB= 2225J
75	1153R		IDLER GEAR T
76	7392H		WASHER T
77	3990H		BRNG T
78	73220500		NUT.HEX.5/16-18
79	1167R		WASHER T
80	73360700		NUT
81	6270H		SEAL STD
82	7384H		SHAFT T
83	100196K		SUB= 106932X
84	5384J		GEAR SHIFT LVR T
85	2978J		CAP T
86	633A85		COVER AND PIN T
87	8739H1		GUIDE BALL T
88	4924H		SPRING TI
89	19151516		WASHER
90	8105R		SUB= 110542X
91	19181511		WASHER
92	75J		GEAR SHIFT GA T
93	6274H		GASKET T
94	76020412		COTTER PIN
95	10040500		LOCKWASHER
96	74760514		BOLT
97	633A109		GEAR SHFT LVR T
98	105474X		TRANSAXLE GTV